

8000/4 4T Art. 1497

- D** **Gebrauchsanweisung**  
Benzinmotorpumpe
- 
- GB** **Operating Instructions**  
Petrol-driven Motor Pump
- 
- F** **Mode d'emploi**  
Pompe thermique pour arrosage
- 
- NL** **Gebruiksaanwijzing**  
Benzinemotorpomp
- 
- S** **Bruksanvisning**  
Pump med bensinmotor
- 
- I** **Istruzioni per l'uso**  
Motopompa
- 
- E** **Manual de instrucciones**  
Bomba a motor de gasolina
- 
- P** **Instruções de utilização**  
Bomba com motor a gasolina
- 
- DK** **Brugsanvisning**  
Benzindreven pumpe

D

GB

F

NL

S

I

E

P

DK

# GARDENA Petrol-driven Motor Pump 8000/4 4T

Welcome to the Garden of GARDENA...



Please read and follow these operating instructions carefully. Use these instructions to use the Petrol-driven Motor Pump correctly and observe the safety information.



For safety reasons, children under 16 as well as persons not familiar with these operating instructions must not use the Petrol-driven Motor Pump.

→ Please keep these operating instructions in a safe place.

## Contents

1. Where to use Your GARDENA Petrol-driven Motor Pump ...	14
2. For Your Safety .....	15
3. Putting Into Operation .....	16
4. Operation .....	16
5. Maintenance .....	18
6. Trouble-Shooting .....	21
7. Putting Out of Operation .....	22
8. Accessories .....	22
9. Technical Data .....	23
10. Service .....	23

## 1. Where to Use Your GARDENA Petrol-driven Motor Pump

### Intended use

The GARDENA Petrol-driven Motor Pump is designed for private use around the house and garden and is not intended for operating watering equipment or irrigation systems in public gardens.

The GARDENA Petrol-driven Motor Pump can also be used for draining swimming pools, distributing water-soluble fertilisers and pesticides, or for pumping lime paints and water-soluble wood preservatives.

### Please note



**The GARDENA Petrol-driven Motor Pump is not designed for continuous operation (e.g. industrial applications, continuous circulating operation).**

**Do not use your GARDENA Petrol-driven Motor Pump to pump corrosive, easily combustible, aggressive, or explosive substances (such as petroleum, or nitro thinner), or food.**

**The temperature of the liquid pumped must not exceed 35 °C.**

## 2. For Your Safety



**Caution!**  
**Risk of fire and explosion**



→ Read the notes on safety on the Petrol-driven Motor Pump. The silencer and exhaust system become very hot during operation and remain hot for some time after turning off the motor.

→ Do not touch the silencer and exhaust system when hot.

**Petrol is combustible and explosive under certain conditions.**

→ Do not smoke or work with naked flames or sparks when pouring petrol into the fuel tank of your pump or in places where petrol is stored.

→ Keep all flammable substances (such a petrol) and flammable objects away from the pump during operation.

→ Do not overfill the fuel tank when filling your pump with petrol.

→ Close the fuel tank securely after filling your pump with petrol.

→ Wipe off any spilt petrol completely before starting the motor.

→ Do not stand anything on the motor. This could cause a fire.

**Caution!**  
**Risk of suffocation**



Exhaust emissions contain poisonous carbon monoxide.

→ Do not breathe in exhaust emissions.

→ Never operate the pump in a closed room.

**Risk of injury from scalding yourself with hot water**

If you operate your pump for longer periods of time (> 5 min) against the closed delivery side of the pump the water in the pump may heat up. There is a risk of injury from hot water scalding you.

→ Do not operate the pump for more than 5 minutes against the closed delivery side of the pump.

→ Turn off the pump immediately if the liquid fails to flow.

### Notes on use:

Allowing the pump to run dry increases the wear and should be avoided.

→ Switch off the pump immediately after all the liquid has been pumped.

Sand and other abrasive materials in the liquid you are pumping cause increased wear and reduce the performance of the pump.

→ Never operate the pump without the air filter.  
(This causes the motor to wear more quickly).

→ To prevent corrosion after pumping saltwater rinse the pump immediately with clean fresh water.

The minimum flow rate is 80 l/h (= 1.3 l/min). Do not connect equipment with a lower flow rate.

When using the pump to increase water pressure, ensure that the inner pressure does not exceed the maximum permissible inner pressure of 6 bar (delivery side of the pump).

Add together the water output pressure you want to increase and the pump pressure.

**Example:** Pressure at the tap 2 bar. Pump pressure 3.5 bar. Total pressure 5.5 bar.

### 3. Putting Into Operation

#### Connect the suction hose:

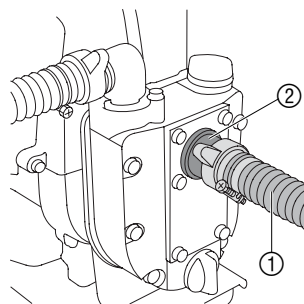

→ Position the pump at a safe distance from the liquid to be pumped.

The suction connection is equipped with a 33.3 mm (G 1) thread. A vacuum-resistant suction hose must be screwed airtight onto the suction side of the pump. Do not use garden hose connection system fittings

- e.g. GARDENA Suction Hose **Art. No. 1412**

→ Screw the vacuum-resistant suction hose (1) onto the suction connection (2) of the pump and ensure it is airtight.

To avoid blockages or damaging the turbine we recommend connecting a suction unit with suction filter between the hose and the suction connection.

- e.g. GARDENA Suction Unit with backflow preventer **Art. No. 1411 / 1418**

#### Connect the delivery hose:

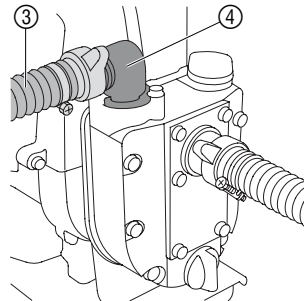

The delivery connection of the pump is fitted with a 33.3 mm (G 1) thread to which you can connect 13 mm (1/2"), 15 mm (5/8") or 19 mm (3/4") hoses using the GARDENA hose connection system fittings.

→ Connect the delivery hose (3) to the delivery connection (4) of the pump.

For the best delivery capacity, connect 19 mm (3/4") hoses together with GARDENA "Profi" System Fittings (e.g. **Art. 1752**) or 25 mm (1") hoses together with GARDENA Brass Connection Fittings (e.g. **Art. 7142**).

#### Connecting several pressure hoses in parallel:

When connecting several hoses or accessories in parallel we recommend using the GARDENA Twin-Tap Connector or Four Channel Water Distributor **Art. 1210/1194**.

→ Screw the Twin-Tap Connector or Four Channel Water Distributor directly onto the thread of the delivery connection (4).

### 4. Operation

#### Check the motor:

1. Set up the pump with the motor turned off.
2. Check the oil level (see 5. Maintenance).
3. Check the petrol level (see 5. Maintenance).
4. Check the air filter (see 5. Maintenance).

#### Fill the pump with the liquid to be pumped:

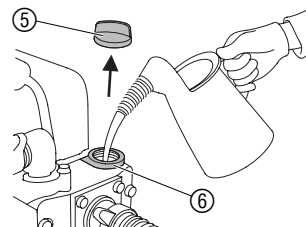

Fill the pump with approx. 1.5 litres of the liquid to be pumped before operating the pump.

1. Unscrew the cover (5) from the filler neck (6) for the liquid to be pumped.
2. Fill the pump chamber completely by pouring the liquid to be pumped into the filler neck (6) (approx. 1.5 litres).
3. Replace the cover (5) on the filler neck (6) and screw tight by hand.

#### Start the motor:

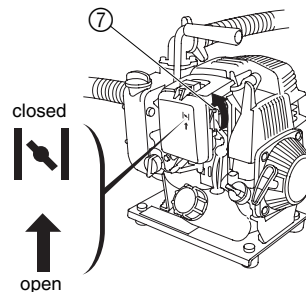

→ Before starting the motor, always inspect the motor and fill the pump with the liquid to be pumped.

1. If the motor is **cold**, push the choke lever (7) up to position **closed**.  
If the motor is warm, push the choke lever (7) down to position **open**.

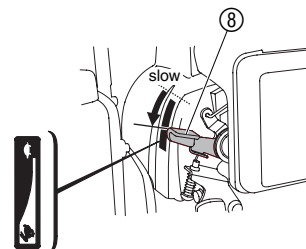

2. Move the throttle lever (8) to the middle position between

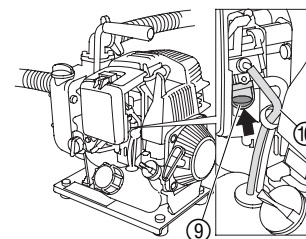

3. If the motor is cold or if you have just filled the tank with petrol press the starter ball pump (9) repeatedly until you can see petrol in the transparent petrol hose (10).

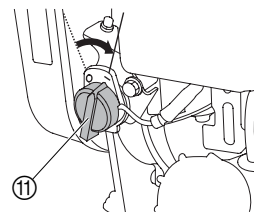

4. Turn the ignition switch (11) to „I“ (ON).

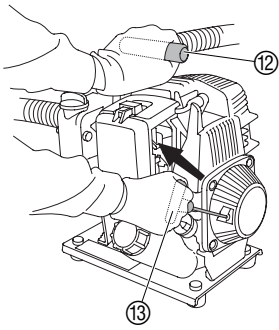

5. Hold the pump firmly by the handle ⑫ and pull the starter handle ⑬ until you feel a slight resistance. Then pull the starter handle ⑬ forcefully.  
*The motor starts.*
6. Slowly release the starter handle ⑬ and guide it back by hand to prevent damaging the starter (do not let the starter handle spring back).
7. When the motor is warm, gradually push the choke lever down to position **↑ (open)**.
8. Set the throttle lever ⑧ to the desired delivery capacity.

#### Turning off the motor:

1. Push the throttle lever ⑧ all the way down to the position.
2. Turn the ignition switch ⑪ to „0“ (OFF).

→ In case of an emergency shut off the motor by turning the ignition switch to „0“.

## 5. Maintenance



→ Turn off the motor and unplug the spark plug connector before carrying out all maintenance work.

#### Maintenance plan:

Regular maintenance and adjustments are important in order to keep the motor in perfect working order.

→ Maintain the pump and motor according to the following maintenance plan.

	After each use	After the first month or first 10 hours of operation	Every 3 months or 25 hours of operation	Every 6 months or 50 hours of operation	Each year or every 100 hours of operation
<b>Motor oil</b> — check oil level	X				
— change oil		X		X	
<b>Air filter</b> — check	X				
— clean			X <sup>1)</sup>		
<b>Clean/adjust spark plug</b>				X	
<b>Clean combustion chamber, valves, fuel tank and fuel filter</b>					X <sup>2)</sup>
<b>Check valve play, fuel hose, turbine, housing cover and backflow preventer (replace if necessary)</b>					X <sup>2)</sup>

1) Carry out maintenance more frequently if using the pump in a dusty environment.

2) This maintenance work must only be carried out at a GARDENA Service Centre.

#### Check oil level / pour in oil:

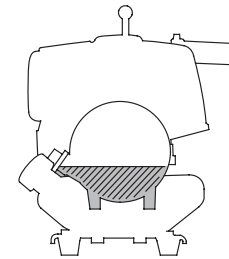
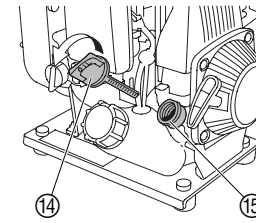

Only use oils labelled SE or SF.

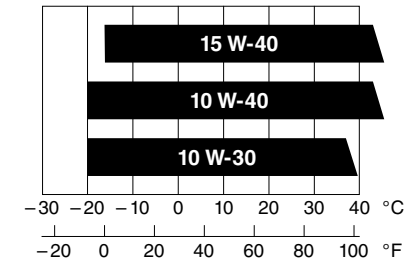

1. Unscrew the oil dipstick ⑭ from the oil filler neck ⑮, pull out and wipe clean.
2. Insert the oil dipstick ⑭ into the oil filler neck ⑮, do not screw in and remove again.
3. If there is no oil on the oil dipstick ⑭, pour in oil.
4. Select the appropriate oil from the table according to the average ambient temperature.
5. Pour in oil up to the upper edge of the oil filler neck ⑮ and screw the oil dipstick ⑭ back into the oil filler neck ⑮.

**Tip:** Drain the oil when the motor is still warm to ensure that the oil is drained quickly and completely. The oil tank holds 0.1 litres.

#### Changing the oil:

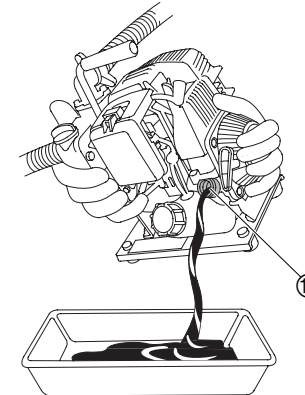

#### Checking the petrol level / pouring in petrol:

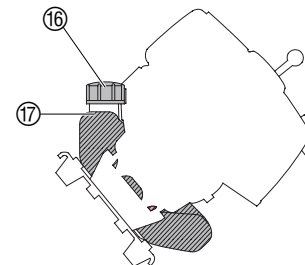

The motor is designed for the combustion of normal petrol (octane number 86 or higher). The petrol tank holds 0.65 litres.

1. Check the level of the petrol in the transparent petrol tank.
2. If the tank is empty or if there is only a small amount of petrol in the tank, pour in petrol.
3. Carefully tilt the pump to the side so that the petrol cap ⑯ faces upwards.
4. Unscrew the petrol cap ⑯ and pour in petrol up to the lower edge of the petrol filler neck ⑰.
5. Screw the petrol cap ⑯ back on and tighten by hand. Carefully tilt the pump back to the horizontal position.

### Checking / cleaning the air filter:

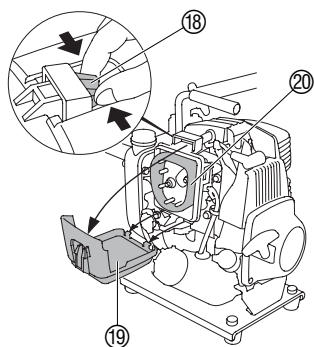

#### Risk of fire and explosion!

→ Never clean the air filter with petrol or solvent with a low fire point.

1. Press together the locking tabs 18 by hand and remove the air filter cover 19.
2. Remove the air filter 20, clean (e.g. using washing up liquid) and leave to dry.
3. Dip the air filter 20 into clean motor oil and press out the excess oil.
4. Reinsert the air filter 20 and fit the air filter cover 19.

### Cleaning / adjusting the spark plug:

The spark plug must be free of combustion residues to ensure that the motor functions correctly. We recommend only replacing an old spark plug with spark plugs with the designation BPM-4A or BPM R4A (NGK).

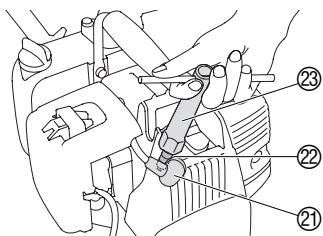

1. Unplug the spark plug connector 21.
2. Unscrew the spark plug 22 using the spark plug spanner 23 provided.
3. Clean the spark plug 22 and if necessary adjust the electrode gap to 0.6 - 0.7 mm by bending the electrode.
4. Screw in the spark plug 22 all the way in by hand.
5. Tighten the spark plug using the spark plug spanner:
  - 1/2 a turn for a new spark plug
  - 1/4 to 1/8 of a turn for an old spark plug

### Rinsing / cleaning the pump:

Use a mild cleaning agent (e.g. washing up liquid) to rinse the pump.

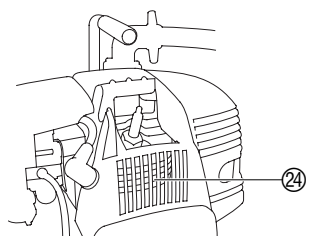

1. After pumping pesticides, lime paints, saltwater or fertilisers rinse the pump with warm water (max. 35 °C).
2. Dispose of residuals according to the guidelines of waste disposal laws.
3. Remove deposits and foreign bodies in the cooling fins 24 using a clean cloth.

Maintenance work is not covered by the guarantee. You may be charged for maintenance work performed by GARDENA.

## 6. Trouble-Shooting



→ Always turn off the motor and unplug the spark plug connector before trouble-shooting.

### Cleaning the turbine:

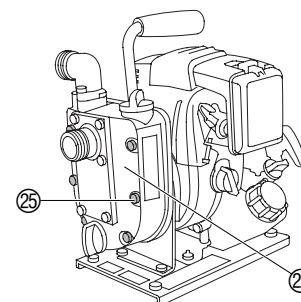

If the turbine clogs it must be cleaned.

1. Unscrew the 6 bolts 25 in the housing cover 26 using an open-end spanner (size 10).
2. Remove the housing cover 26.
3. Clean the turbine.
4. Mount the housing cover 26 in the reverse order.

Disassembly of the hydraulic unit other than removing the housing cover must only be carried out by GARDENA Service.

Problem	Possible Cause	Remedy
<b>The motor does not start.</b>	The ignition switch 11 is not set to position "I".	→ Set the ignition switch to "I".
	The fuel tank is empty.	→ Pour petrol into the fuel tank (see 5. Maintenance).
	The spark plug is defective.	→ Check the spark plug and install a new spark plug if necessary (see 5. Maintenance).
<b>The pump does not pump the liquid.</b>	The pump was not filled with the liquid to be pumped before it was switched on.	→ Fill the pump (see 4 Operation).
	Suction hose defective or leaking.	→ Fit a new suction hose.
	Housing cover 26 or turbine clogged.	→ Clean the turbine (see 5. Maintenance).
<b>The pump motor runs but the delivery capacity or the pressure suddenly decreases.</b>	Suction filter at suction hose is sucked free.	→ Reduce the flow rate at the delivery side with a regulator valve, e.g. GARDENA Regulator Valve Art. (2)977.
	Suction filter of suction hose is clogged.	→ Clean the suction filter.
	Air cannot escape during self-priming because the delivery side is closed or there is residual water in the delivery hose.	→ Open shut-off device (e.g. water stop) in the pressure line or drain the delivery hose.
	Suction height too high.	→ Reduce suction height (see 9. Technical Data).

If you have any other problems with your Petrol-driven Motor Pump, please contact GARDENA Service.

## 7. Putting Out of Operation



→ Always allow the motor to cool after operation.

### Storage:

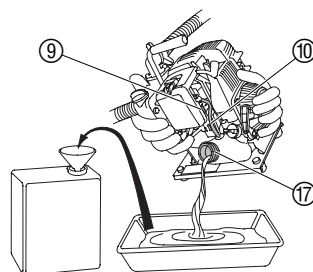
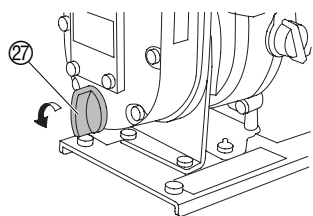

If storing the pump for longer periods (e.g. during the winter), drain the petrol and store the pump in a dry place protected from frost.

1. Maintain the pump according to the maintenance plan (see 5. Maintenance).
2. Unscrew the drain plug ⑳ and drain the water from the pump.
3. When all the water has drained out, replace the drain plug ⑳.
4. Unscrew the petrol cap.
5. Tilt the pump towards the petrol filler neck ⑰ and drain the petrol into a suitable container (and then empty into a canister).
6. Press the starter ball pump ⑨ several times until no more petrol can be seen in the transparent petrol hose ⑩.
7. Tilt the pump towards the petrol filler neck ⑰ again until the petrol tank is empty.
8. Replace the petrol cap.

## 8. Accessories

**GARDENA Suction Unit**  
(length 3.5 m / 7 m) Vacuum-resistant spiral hose. Ready for connection. With suction filter and backflow preventer. **Art. No. 1411 / 1418**

**GARDENA Suction Hoses**  
(19 mm (3/4") or 25 mm (1") in diameter) Bend and vacuum-resistant hoses, supplied by the metre without fittings or as a fixed length complete with fittings.

**GARDENA Suction Hose Fittings** **Art. No. 1723 / 1724**  
For suction hoses sold by the metre.

**GARDENA Suction Filter with Backflow Preventer** **Art. No. 1726 / 1727 / 1728**

**GARDENA Pump Preliminary Filter** **Art. No. 1730**  
Recommended when pumping liquids containing sand.

**GARDENA Bore Hole Suction Hose** **Art. No. 1729**  
For vacuum-resistant connection of the pump to boreholes or pipes. Length 0.5 m. With 33,3 mm (G 1) female thread at both hose ends.

## 9. Technical Data

<b>Petrol-driven Motor Pump</b>	<b>8000/4 4 T</b>
<b>Motor</b>	4-stroke / 1.1 kW (1.5 PS)
<b>Tank volume</b>	0.65 l (normal petrol)
<b>Max. delivery capacity</b>	8,000 l/h
<b>Max. pressure / delivery head</b>	3.5 bar / 35 m
<b>Max. suction height</b>	7.5 m
<b>Max. self-priming suction height</b>	7 m
<b>Weight</b>	6.8 kg
<b>Working area related emission characteristic value <math>L_{pA}^{1)}</math></b>	84 dB(A)
<b>Noise level <math>L_{WA}^{2)}</math></b>	98 dB(A)

Measuring method according to 1) DIN 45635-1 2) directive 2000/14/EC

### Performance characteristics

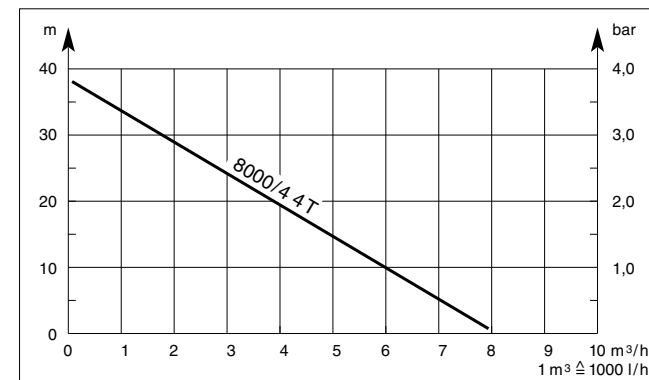

The performance data of the pump characteristics are measured with a suction height of 0.5 m and using a 25 mm (1") suction hose.

## 10. Service

### Warranty

GARDENA guarantees this product for 2 years (from date of purchase). This guarantee covers all serious defects of the unit that can be proved to be material or manufacturing faults. Under warranty we will either replace the unit or repair it free of charge if the following conditions apply:

- The unit must have been handled properly and in keeping with the requirements of the operating instructions.
- Neither the purchaser or a non-authorized third party have attempted to repair the unit.

The turbine is a wearing part and is not covered by the guarantee. This manufacturer's guarantee does not affect the user's existing warranty claims against the dealer/seller.

**Product Liability**

If you have any problems with your pump, please contact our Customer Service or return the defective unit together with a short description of the problem directly to one of the GARDENA Service Centres listed on the back of this leaflet.

We expressly point out that, in accordance with the product liability law, we are not liable for any damage caused by our units if it is due to improper repair or if parts exchanged are not original GARDENA parts or parts approved by us, and, if the repairs were not carried out by a GARDENA Service Centre or an authorised specialist. The same applies to spare parts and accessories.

**EU Certificate of Conformity**

The undersigned

GARDENA International GmbH · Hans-Lorensen-Str. 40 · D-89079 Ulm

hereby certifies that, when leaving our factory, the unit indicated below is in accordance with the harmonised EU guidelines, EU standards of safety and product specific standards.

This certificate becomes void if the unit is modified without our approval.

<b>Description of the unit:</b>	Petrol-driven Motor Pump
<b>Typ:</b>	8000/4 4 T
<b>Art. No.:</b>	1497
<b>EU directives:</b>	Machinery Directive 98/37/EC Electromagnetic Compatibility 89/336/EC Directive 93/68/EC Directive 2000/14/EC
<b>Harmonisierte EN:</b>	EN 292-1 EN 292-2 EN 809
<b>Noise level:</b>	measured 98 dB (A) guaranteed 101 dB (A)
<b>Year of CE marking:</b>	2002

Ulm, 22.07.2002



Thomas Heintl  
Technical Dept. Manager

**Deutschland**

GARDENA International GmbH  
Service Center  
Hans-Lorenser-Str. 40  
89079 Ulm  
Produktfragen: (07 31) 490-123  
Reparaturen: (07 31) 490-290

**Argentina**

Argensem S.A.  
Calle Colonia Japonesa s/n  
(1625) Loma Verde  
Escobar, Buenos Aires

**Australia**

NYLEX Consumer Division  
76-88 Mills Road  
P.O. Box 722  
Braeside 3195  
Melbourne, Victoria

**Austria**

GARDENA Österreich Ges. m.b.H.  
Stettnerweg 11-15  
2100 Korneuburg

**Belgium**

MARKT (Belgium) NV/SA  
Sterrebeekstraat 163  
1930 Zaventem

**Brazil**

RGS Comercial Ltda  
Av. Marginal do Rio Pinheiros, 5200  
Edifício Montreal - Bloco e - Terreo  
05693-000 - Sao Paulo - SP

**Bulgaria / България**

ДЕНЕКС ООД  
Бул. "Г.М.Димитров" 16 ет.4  
София 1797

**Canada**

GARDENA Canada Ltd.  
100 Summerlea Road  
Brampton, Ontario  
Canada L6T 4X3

**Chile**

Antonio Martinic Y CIA. LTDA.  
Gilberto Fuenzalida 185 Loc.  
Las Condes - Santiago de Chile

**Costa Rica**

Compania Exim  
Euroiberoamericana S.A.  
Av. 12 bis Calle 16 y 18,  
Bodegas Keith y Ramirez  
San José

**Cyprus**

FARMOKIPIKI LTD  
P.O. Box 7098  
74, Digeni Akrita Ave.  
1641 Nicosia

**Czech Republic**

GARDENA spol. s.r.o.  
Řípská 20a, č.p. 1153  
62700 Brno

**Denmark**

GARDENA Danmark A/S  
Naverland 8  
2600 Glostrup

**Finland**

Habitec Oy  
Martinkyläntie 52  
01720 Vantaa

**France**

GARDENA France  
Service Après-Vente  
BP 50080  
95948 ROISSY CDG Cedex

**Great Britain**

GARDENA UK Ltd.  
27-28 Brenkley Way  
Blezard Business Park  
Seaton Burn  
Newcastle upon Tyne NE13 6DS

**Greece**

Agrokip G. Psomadopoulos & Co.  
33 A, Ifestou str. – 194 00  
Industrial Area Koropi  
Athens

**Hungary**

GARDENA Magyarország Kft.  
Késmárk utca 22  
1158 Budapest

**Iceland**

Heimilistaeki hf  
Saetun 8  
P.O. Box 5340  
125 Reykjavik

**Republic of Ireland**

Michael McLoughlin & Sons  
Hardware Limited  
Long Mile Road  
Dublin 12

**Italy**

GARDENA Italia S.p.A.  
Via Donizetti 22  
20020 Lainate (Mi)

**Japan**

KAKUDAI Mfg. Co. Ltd.  
1-4-4, Itachibori Nishi-ku  
Osaka 550

**Luxembourg**

Magasins Jules Neuberg  
Grand Rue 30  
Case Postale No. 12  
Luxembourg 2010

**Netherlands**

GARDENA Nederland B.V.  
Postbus 50176  
1305 AD ALMERE  
**Neth. Antilles**  
Jonka Enterprises N.V.  
Sta. Rosa Weg 196  
P.O. Box 8200  
Curaçao

**New Zealand**

NYLEX New Zealand Limited  
Private Bag 94001  
South Auckland Mail Centre  
10 Offenhauser Drive  
East Tamaki, Manukau

**Norway**

GARDENA Norge A/S  
Postboks 214  
2013 Skjetten

**Poland**

GARDENA Polska Sp. z o.o.  
Szymanów 9 d  
05-532 Baniocza

**Portugal**

GARDENA Portugal Lda.  
Recta da Granja do Marquês  
Edif. GARDENA  
Algueirão  
2725-596 Mem Martins

**Russia / Россия**

АО АМИДА ТТЦ  
ул. Мосфильмовская 66  
117330 Москва

**Singapore**

Hy - Ray Enterprises  
Block 1002 Toa Payoh  
Industrial Park  
#07-1433/1435/1451  
Singapore 319074

**Slovenia / Croatia**

Silk d.o.o. Trgovina  
Brodišče 15  
1236 Trzin

**South Africa**

GARDENA South Africa (Pty.) Ltd.  
P.O. Box 11534  
Vorna Valley 1686

**Spain**

GARDENA IBÉRICA S.L.U.  
C/ Basauri, nº 6  
La Florida  
28023 Madrid

**Sweden**

GARDENA Norden AB  
Box 9003  
20039 Malmö

**Switzerland**

GARDENA AG  
Bitziberg 1  
8184 Bachenbülach

**Ukraine / Украина**

АОЗТ АЛЬЦЕСТ  
ул. Гайдара 50  
г. Киев 01033

**Turkey**

GARDENA/Dost Diş Ticaret  
Mümessillik A.Ş.  
Yeşilbağlar Mah. Başkent  
Cad. No. 26  
Pendik - İstanbul

**USA**

GARDENA  
3085 Shawnee Drive  
Winchester, VA 22604

1497-20.960.02/0031  
© GARDENA Manufacturing GmbH  
D-89070 Ulm  
<http://www.gardena.com>