

Art. 7940

Art. 7941

D Betriebsanleitung

Teichschlammsauger-Set / Teichschlammsauger-Vorsatz

GB Operating Instructions

Pond Silt Remover Set / Pond Silt Remover Adapter

F Mode d'emploi

Aspirateur de bassin – kit complet

NL Instructies voor gebruik

Vijvervuilzuigerset / Vijvervuilzuiger-voorzetunit

S Bruksanvisning

Slamsugarset för Damm / Slamsugardelar

I Istruzioni per l'uso

Set pulitore per laghetti / Aspiratore per laghetti

E Manual de instrucciones

Set de aspiración de lodos para estanque / Adaptador

P Instruções de utilização

Conjunto de aspirador de limpeza para lago e bomba

DK Brugsanvisning

Bassinstøvsuger komplet / Adapter

GARDENA Pond Silt Remover Set / Pond Silt Remover Adapter

Welcome to GARDENA aquamation ...



Translation of the original instructions from German. Please read these operating instructions carefully and observe the notes given. Use the instructions to familiarise yourself with the Pond Vac, its correct use, and the notes on safety.



For safety reasons, children under 16 as well as persons not familiar with these operating instructions should not use this Pond Vac.

→ Please keep these operating instructions in a safe place.

Contents

1. Where to Use Your GARDENA Pond Silt Remover	11
2. Safety instructions	11
3. Function	12
4. Assembly	13
5. Before and During Operation	14
6. Cleaning	16
7. Trouble-Shooting	16
8. Accessories	17
9. Technical Data	17
10. Service	18

1. Where to Use Your GARDENA Pond Silt Remover

Intended Use

The Pond Silt Remover is intended for use in domestic gardens and allotments. It is designed for removing particles of dirt up to 30 mm in diameter, algae, leaves, and silt from garden ponds. The Pond Silt Remover can also be used to remove large particles of dirt from swimming pools.

Attention



The GARDENA Pond Silt Remover is not suitable for continuous use (e.g. industrial use, continuous suction).

2. Safety instructions



→ Please read the pump operating instructions carefully and observe the notes on safety.

Stability

→ When working next to the pond, always ensure that you position the pump on firm and solid ground.

→ Do not pull the hoses.

Pond Water / Swimming Pool Water

→ Avoid drawing in particles of dirt that may block the Pond Silt Remover.

You must not block the dirty water hose.

3. Function

- ❶ Suction unit (grey)
- ❷ Pump
- ❸ Motive water hose (red)
- ❹ Nozzle housing
- ❺ Filter trough
- ❻ Dirty water float hose (transparent)
- ❼ Adapter nozzles
– for cleaning surfaces
– for narrow places
- ❽ Collecting basket
- ❾ Filter sieves
- ❿ combisystem handle
- ⓫ Collecting bag

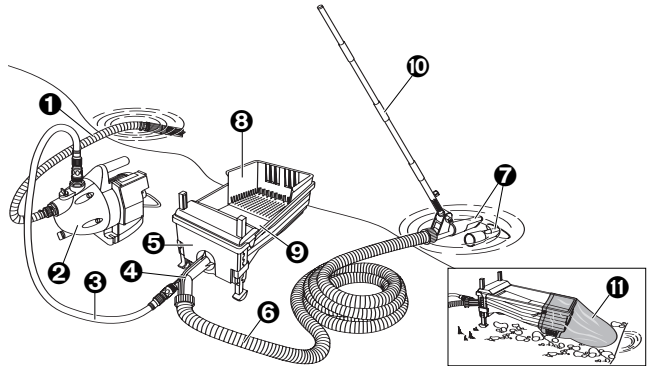

The pump ❷ draws in the pond water via the suction unit ❶ and pumps it via the motive water hose ❸ through the nozzle housing ❹ into the filter trough ❺. The jet of motive water streaming through the nozzle housing ❹ creates a vacuum in the dirty water hose ❻.

The dirty water is sucked up with the adapter nozzles ❼ and pumped via the dirty water hose ❻ and nozzle housing ❹ onto the filter sieves ❾ and collecting basket ❽ or collecting bag ⓫.

The dirt is then filtered out of the water.
(The cleaned water is not drinking water.)

The cleaned water is returned directly to the pond so that you do not lose any pond water. The biological balance of the pond is therefore maintained.

The slow suction speed not only ensures optimum cleaning results, but also ensures that flora and fauna in the pond remain unharmed, and prevents stones and plants from being drawn into the Silt Remover by accident.

Note:

The water that is returned to the pond contains (biologically active) floating particles. The cloudy appearance of your pond caused by these particles may last for several days.

If you accidentally suck up small creatures into the Pond Silt Remover (e.g. water snails, beetles) you can remove them from the open collecting basket ❽ and return them to the pond.

You can then dispose of the dirt and silt on your compost heap or with other garden refuse.

4. Assembly

Attach the filter trough:

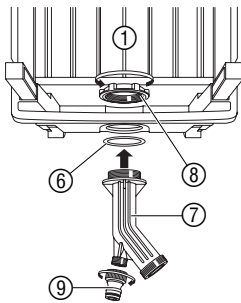
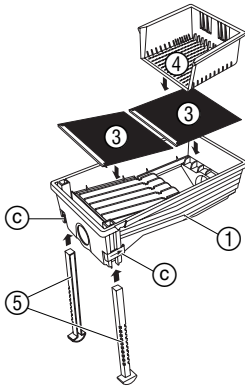

Attach the motive water hose (only for set 7940):

1. Pull the side clips (a) slightly away from the filter trough (1) and remove the splashguard (2).
2. Insert the filter sieves (3) into the filter trough (1) with the ridges facing (b) downwards.
3. Install the collecting basket (4) in the filter trough (1).
4. Push the red adjuster (c) in the direction of the arrow and push the feet (5) (with the side notches facing outwards) into the filter trough (1) from below.
5. Push the sealing ring (6) onto the nozzle housing (7).
6. Push the nozzle housing (7) into the filter trough (1) from the front.
7. Screw the threaded ring (8) onto the nozzle housing (7) from the inside.
8. Screw the small threaded connector (9) onto the nozzle housing (7).
9. Push the splashguard (2) onto the feet (5) from above until the clips (a) lock into place.

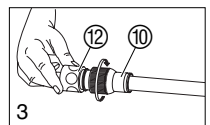
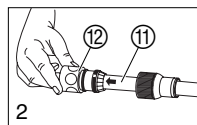
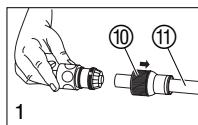
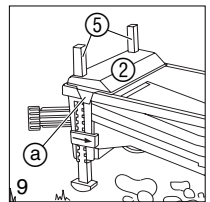
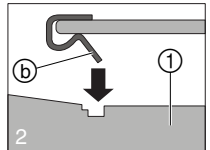
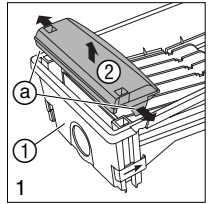

1. Push the union nut (10) over the motive water hose (11).
2. Push the motive water hose (11) all the way into the universal adaptor (12).
3. Screw the union nut (10) onto the universal adaptor (12) and tighten by hand.
4. Repeat for the other end of the hose.

**Attach the handle
(only for set 7940):**

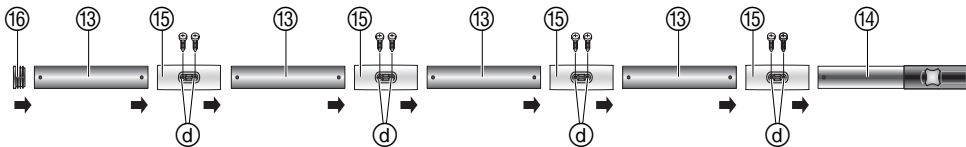

1. Push the 4 tubes ⑬ and the tube with the locking screw ⑭ into the connecting sleeves ⑮ so that the holes ④ are in alignment.
2. Fasten the connecting sleeves ⑮ to the tubes ⑬ / ⑭ with 2 screws each.
3. Press the end cap ⑯ onto the open end of the tube ⑬.

**Connect the hoses
to the filter trough:**

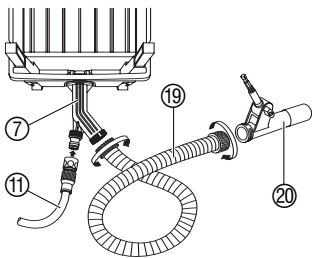

1. Push the motive water hose ⑪ of the pump onto the nozzle housing ⑦.
2. Ensure that the seals ⑱ in the union nuts of the transparent dirty hose ⑲ exist.
3. Screw the dirty water hose ⑲ onto the nozzle housing ⑦.
4. Screw the handle/nozzle holder ⑳ into the dirty water hose ⑲.

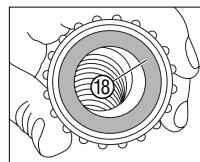

5. Before and During Operation

**Setting up your
Pump:**



The pump may only be used near swimming pools, garden ponds and similar places if the pump is operated via a residual-current-operated circuit breaker (DIN VDE 0100-702 and 0100-738).

→ Position the pump on solid, even ground, protected from flooding, and connect it to a 230 V mains socket.

Lay the 230 V mains connection on dry ground, protected from carrying off into water. Take care that the pump cannot fall into water.

**Connect the suction unit
and motive water hose
to the pump:**

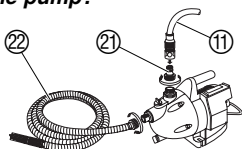

! → Please read the operating instructions for the pump and observe the notes on safety.

1. Screw the large threaded connector ⑳ onto the delivery connection (G 1) of the pump.
2. Connect the suction unit ㉒ and the motive water hose ⑪.
(Please read the information provided in the pump operating instructions.)

Position the filter trough:

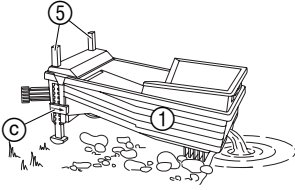

Operation:

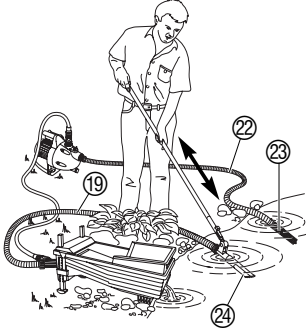

3. Position the filter trough ① at the edge of the pond with the water outlet facing the water.

The filter trough must not be more than 50 cm above the surface of the water.

The best suction results are achieved when the filter trough is at exactly the same height as the surface of the water.

4. Press the red adjuster ③ in the direction of the arrow and adjust the feet ⑤ so that the filter trough ① is tilted slightly towards the surface of the water.
5. Immerse the suction filter ②③ of the suction unit ② **completely** in a calm part of the pond (**clear water**).
6. Push the nozzle attachment ②④ you require onto the handle/nozzle holder ②① turning slightly.
 - a) Adapter nozzle for cleaning surfaces
 - b) Adapter nozzle for narrow places
7. Push the combisystem handle ②⑤ onto the handle/nozzle holder ②① and tighten the locking screw ②④.
Adjust the working angle to suit the pond you are working on.
8. Fill the GARDENA Garden Pump **Art. 1426** provided in the Pond Silt Remover Set with 2 litres of water. (Operate other pumps according to their operating instructions.)
9. Switch on the pump.

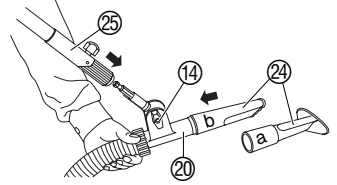

10. Hold the adapter nozzle ②④ **completely** under water at the place you want to begin drawing in water, so that the dirty water hose ②⑨ lies **flat** along the bottom of the pond.
To prevent blockages, move the adapter nozzle in small, lifting movements.

The best cleaning results are achieved from the Pond Silt Remover once the pockets of air in the dirty water hose have dispersed.

If the water level rises in the collecting basket ④, remove and empty the basket and clean the filter (see 6. Cleaning).

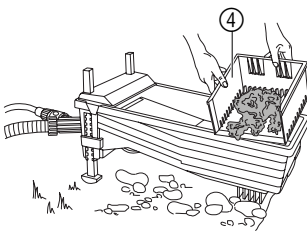

Draw off pond silt:

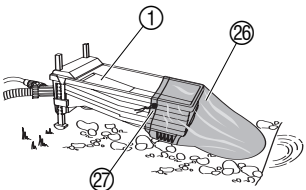

The collecting bag ②⑥ should be used when drawing off pond silt, in order to achieve a better filter performance.

1. Remove the collecting basket and if necessary the filter sieves of the filter tub ①.
2. Pull up the collecting bag ②⑥ from the rear on the filter trough ① and stretch with the elastic strip cord ②⑦.
3. When a build up of water occurs in the filter trough, loosen the collecting bag ②⑥ from the filter trough ① and empty it.

Depending on the degree of pollution and the pond size, the collecting bag ②⑥ must be emptied several times.

6. Cleaning

Clean the dirty water hose:

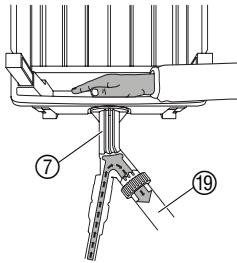

Clean all dirty parts after use.

- **Switch on** the pump and hold the nozzle housing ⑦ closed with your hand.
The motive water is then directed into the dirty water hose ⑱ and cleans it from the inside.
- Remove silt from the outside of the dirty water hose ⑱ and rinse under running water.

Clean the collecting basket and filter sieves or collecting bag:

- Remove the collecting basket and filter sieves from the filter trough or loosen collecting bag from the filter trough, remove any silt and rinse under running water.
Take care not to bend the filter sieves.

Clean the accessories:

- Remove silt from the suction unit, hose attachments, combi-system handle, and hoses and rinse under running water.

Clean the pump:



→ Please read the pump operating instructions carefully and observe the notes on maintenance.

7. Trouble-Shooting



→ Always switch off the pump before trouble-shooting.

Fault	Possible Cause	Remedy
The priming time is considerably longer than 30 seconds.	The dirty water hose is not positioned flat along the bottom of the pond, or air is drawn into the dirty water hose.	→ Check the seals and connections and ensure that the dirty water hose is positioned flat on the bottom of the pond.
The dirty water is not drawn into the pump.	The filter trough is more than 50 cm above the surface of the water.	→ Position the filter trough at the same level as the water.
	Hose connections are leaking.	→ Check seals and screw suction and dirty water hoses on tightly.
	Adapter nozzle or dirty water hose are blocked.	→ Clean adapter nozzle and dirty water hose (see 6. Cleaning).
The pump is turned on, but does not pump water.	The water you pour into the pump escapes through the motive water hose during the self-priming phase.	→ Fill pump again.
		→ Hold up pressure hose approx. 1 m and vertically until the pump begins to pump.

	Suction filter ② is blocked.	→ Clean suction unit and immerse in a calm, clear part of the pond.
Water runs over the edge of the Pond Silt Remover.	The filter sieves are blocked.	→ Empty the collecting basket and clean the filter sieves.
	The collecting bag is full.	→ Empty the collecting bag.
Pump is not working.	Pump is defective.	→ See pump operating instructions.

If other faults occur, please contact GARDENA Customer Service.

8. Accessories

GARDENA combisystem Telescopic Handles	Recommended Accessories: For reaching distances of up to 3.90 m	Art. 3711/3712
	Accessories required for the Pond Silt Remover Adapter (Art. 7941):	
Garden Pump	With at least 3300 l/h and 4 bar pressure	e.g. GARDENA Garden Pump Art. 1429
3/4"-Garden Hose	Approx. 5 m long	e.g. GARDENA Cord Hose Art. 4572
GARDENA combisystem Handle	For connection to the handle/nozzle holder of the dirty water hose	combisystem Ergoline Aluminium Handles Art. 3745/3735 combisystem Aluminium Handles Art. 3713/3715 combisystem Wooden Handles Art. 3703/3705/3708
Universal adapter for garden hose	For connecting the motive water hose	e.g. GARDENA Threaded Tap Connector Art. 2802
Suction unit	With suction filter for drawing in pond water	e.g. GARDENA Suction Unit Art. 1411
Connection for motive water hose	For connecting the motive water hose to the pump and filter trough	e.g. GARDENA Profi-System 2 x Standard Hose Connector Art. 2817

9. Technical Data

Maximum height above level of pond water:	50 cm
Maximum delivery capacity of dirty water:	3000 l/h (for Art. 1426)
Maximum size of particles of dirt in pond water:	30 mm
Motive water hose connection of filter trough:	G 3/4 thread
Dirty water hose connection of filter trough:	G 1 1/2 thread

10. Service

Warranty

GARDENA guarantees this product for 2 years (from date of purchase). This guarantee covers all serious defects of the unit that can be proved to be material or manufacturing faults. Under warranty we will either replace the unit or repair it free of charge if the following conditions apply:

- The unit must have been handled properly and in keeping with the requirements of the operating instructions.
- Neither the purchaser or a non-authorised third party have attempted to repair the unit.

This manufacturer's guarantee does not affect the user's existing warranty claims against the dealer/seller.

If you have any problems with your Pond Silt Remover Set, please contact our Customer Service or return the defective unit together with a short description of the problem directly to one of the GARDENA Service Centres listed on the back of this leaflet.

Product Liability

We expressly point out that, in accordance with the product liability law, we are not liable for any damage caused by our units if it is due to improper repair or if parts exchanged are not original GARDENA parts or parts approved by us, and, if the repairs were not carried out by a GARDENA Service Centre or an authorised specialist. The same applies to spare parts and accessories.

Deutschland / Germany

GARDENA
Manufacturing GmbH
Service Center
Hans-Lorenser-Straße 40
D-89079 Ulm
Produktfragen:
(+49) 731 490-123
Reparaturen:
(+49) 731 490-290
service@gardena.com

Argentina

Argensem® S.A.
Calle Colonia Japonesa s/n
(1625) Loma Verde
Escobar, Buenos Aires
Phone: (+54) 34 88 49 40 40
info@argensem.com.ar

Australia

Nylex Consumer Products
50-70 Stanley Drive
Somerton, Victoria, 3062
Phone: (+61) 1800 658 276
spare.parts@nylex.com.au

Austria / Österreich

GARDENA
Österreich Ges.m.b.H.
Stettnerweg 11-15
2100 Korneuburg
Tel.: (+43) 22 62 7 45 45 36
kundendienst@gardena.at

Belgium

GARDENA Belgium NV/SA
Sterrebeekstraat 163
1930 Zaventem
Phone: (+32) 2 7 20 92 12
Mail: info@gardena.be

Brazil

Palash Comércio e
Importação Ltda.
Rua São João do Araguaia,
338 – Jardim Califórnia –
Barueri – SP – Brasil –
CEP 06409-060
Phone: (+55) 11 4198-9777
eduardo@palash.com.br

Bulgaria

Хускварна България ЕООД
1799 София
Бул. „Андрей Ляпчев“ № 72
Тел.: 02/ 8755148, 9753076
www.husqvarna.bg

Canada

GARDENA Canada Ltd.
100 Summerlea Road
Brampton, Ontario L6T 4X3
Phone: (+1) 905 792 9330
info@gardenacanada.com

Chile

Antonio Martinic y Cia Ltda.
Cassillas 272
Centro de Cassillas
Santiago de Chile
Phone: (+56) 2 20 10 708
garfar_cl@yahoo.com

Costa Rica

Compania Exim
Euroberoamericana S.A.
Los Colegios, Moravia,
200 metros al Sur del Colegio
Saint Francis - San José
Phone: (+506) 297 68 83
exim_euro@racsa.co.cr

Croatia

KLIS d.o.o.
Stanciceva 79
10419 Vukovina
Phone: (+385) 1 622 777 0
gardena@klis-trgovina.hr

Cyprus

FARMOKIPIKI LTD
P.O. Box 7098
74, Digeni Akritia Ave.
1641 Nicosia
Phone: (+357) 2275 47 62
condam@spidernet.com.cy

Czech Republic

GARDENA spol. s r.o.
Tuřanka 115
627 00 Brno
Phone: (+420) 800 100 425
gardena@gardenabrnno.cz

Denmark

GARDENA Norden AB
Salgsafdeling Danmark
Box 9003
S-200 39 Malmö
info@gardena.dk

Finland

Oy Husqvarna Ab
Lautatarhankatu 8b/ PL 3
FI-00581 HELSINKI

France

GARDENA
PARIS NORD 2
69, rue de la Belle Etoile
BP 57080
ROISSY EN FRANCE
95948 ROISSY CDG CEDEX
Tél. (+33) 0826 101 455
service.consommateurs@
gardena.fr

Great Britain

Husqvarna UK Ltd
Preston Road
Aycliffe Industrial Park
Newton Aycliffe
County Durham
DL5 6UP
info.gardena@husqvarna.co.uk

Greece

Agrokip
Psoamadopoulos S.A.
Ifaistou 33A
Industrial Area Koropi
194 00 Athens Greece
V.A.T. EL093474846
Phone: (+30) 210 6620 225
service@agrokip.gr

Hungary

GARDENA
Magyarország Kft.
Késmárk utca 22
1158 Budapest
Phone: (+36) 80 20 40 33
gardena@gardena.hu

Iceland

Ó. Johnson & Kaaber
Tunguhalsi 1
110 Reykjavik
ooj@ojk.is

Ireland

Michael McLoughlin & Sons
Hardware Limited
Long Mile Road
Dublin 12

Italy

GARDENA Italia S.p.A.
Via Donizetti 22
20020 Lainate (Mi)
Phone: (+39) 02.93.94.79.1
info@gardenaitalia.it

Japan

KAKUICHI Co. Ltd.
Sumitomo Realty &
Development Kojimachi
BLDG., 8F
5-1 Nibanncyo, Chiyoda-ku
Tokyo 102-0084
Phone: (+81) 33 264 4721
m_ishihara@kaku-ichi.co.jp

Luxembourg

Magasins Jules Neuberg
39, rue Jacques Stas
Luxembourg-Gasperich 2549
Case Postale No. 12
Luxembourg 2010
Phone: (+352) 40 14 01
api@neuberg.lu

Netherlands

GARDENA Nederland B.V.
Postbus 50176
1305 AD ALMERE
Phone: (+31) 36 521 00 00
info@gardena.nl

Neth. Antilles

Jonka Enterprises N.V.
Sta. Rosa Weg 196
P.O. Box 8200, Curaçao
Phone: (+599) 9 767 66 55
pgm@jonka.com

New Zealand

NYLEX New Zealand Limited
Building 2, 118 Savill Drive
Mangere, Auckland
Phone: (+64) 0800 22 00 88
spare.parts@nylex.com.au

Norway

GARDENA Norden AB
Salgskontor Norge
Kleverveien 6
1540 Vestby
info@gardena.no

Poland

GARDENA Polska Sp. z o.o.
Szymanów 9 d
05-532 Baniocza
Phone: (+48) 22 727 56 90
gardena@gardena.pl

Portugal

GARDENA Portugal Lda.
Sintra Business Park
Edifício 1, Fração 0-G
2710-089 Sintra
Phone: (+351) 21 922 85 30
info@gardena.pt

Romania

MADEX INTERNATIONAL SRL
Soseaua Odaii 117-123,
Sector 1,
București, RO 013603
Phone: (+40) 21 352 76 03
madex@ines.ro

Russia / Россия

ООО ГАРДЕНА РУС
123007, г. Москва
Хорошевское шоссе, д. 32А
Тел.: (+7) 495 540 99 57
info@gardena-rus.ru

Singapore

Hy-Ray PRIVATE LIMITED
40 Jalan Pemimpin
#02-08 Tat Ann Building
Singapore 577185
Phone: (+65) 6253 2277
hyray@singnet.com.sg

Slovak Republic

GARDENA Slovensko, s.r.o.
Panónska cesta 17
851 04 Bratislava
Phone: (+421) 263 453 722
info@gardena.sk

Slovenia

GARDENA d.o.o.
Brodšče 15
1236 Trzin
Phone: (+386) 1 580 93 32
servis@gardena.si

South Africa

GARDENA
South Africa (Pty.) Ltd.
P.O. Box 11534
Vorna Valley 1686
Phone: (+27) 11 315 02 23
sales@gardena.co.za

Spain

GARDENA IBÉRICA S.L.U.
C/ Basauri, nº 6
La Florida
28023 Madrid
Phone: (+34) 91 708 05 00
atencioncliente@gardena.es

Sweden

GARDENA Norden AB
Försäljningskontor Sverige
Box 9003
200 39 Malmö
info@gardena.se

Switzerland / Schweiz

GARDENA (Schweiz) AG
Bitzberg 1
8184 Bächenbülach
Phone: (+41) 848 800 464
info@gardena.ch

Turkey

GARDENA / Dost Diş Ticaret
Mümesillik A.Ş. Sanayi
Çad. Adil Sokak No. 1
Kartal - İstanbul
Phone: (+90) 216 38 93 939
info@gardena-dost.com.tr

Ukraine / Україна

ALTSEST JSC
4 Petropavlivska Street
Petropavlivska
Borschahivka Town
Kyivo Svyatoshyn Region
08130, Ukraine
Phone: (+380) 44 459 57 03
uprr@altsest.kiev.ua

USA

Melnor Inc.
3085 Shawnee Drive
Winchester, VA 22604
Phone: (+1) 540 722-9080
service_us@melnor.com

7940-20.960.05/0208

© GARDENA
Manufacturing GmbH
D-89070 Ulm
http://www.gardena.com