

HiCut Art. 4019

**GB Operating Instructions**  
Cylinder Lawnmower

---

**F Mode d'emploi**  
Tondeuse hélicoïdale

---

**E Manual de instrucciones**  
Cortacésped helicoidal

---

**D Betriebsanleitung**  
Spindelmäher

---

# GARDENA Cylinder Lawnmower HiCut

Welcome to the Garden of GARDENA...



Translation of the original instructions from German. Please read these operating instructions carefully and observe the notes given. Use these instructions to familiarise yourself with the cylinder lawnmower, its correct use and the notes on safety.



For safety reasons, children under the age of 16 as well as persons not familiar with these operating instructions should not use this cylinder lawnmower.

→ Please keep these operating instructions in a safe place.

## Contents

- 1. Where to Use Your GARDENA Cylinder Mower..... 2
- 2. Safety instructions ..... 2
- 3. Assembly ..... 3
- 4. Function ..... 4
- 5. Operation ..... 4
- 6. Putting into Storage ..... 4
- 7. Maintenance ..... 5
- 8. Troubleshooting ..... 5
- 9. Available accessories ..... 6
- 10. Technical Data ..... 7
- 11. Service / Warranty ..... 7

## 1. Where to Use Your GARDENA Cylinder Lawnmower

### Intended use

The GARDENA Cylinder Mower has been designed for cutting lawn and grass areas (ca. 200 m<sup>2</sup>) of private houses.

Compliance with these instructions provided by GARDENA is a prerequisite for using the cylinder lawnmower correctly.

### Please note



To prevent injury, the GARDENA Cylinder Lawnmower must not be used for cutting and pruning of climbers or grass on roofs.

## 2. Safety instructions

→ Please read the notes on safety on the Cylinder Lawnmower.



**WARNING !**  
→ Please read the operating instructions before using the mower!



**WARNING !**  
Sharp blades!



**DANGER !**  
Risk of injury!  
→ Keep bystanders away!

**Checks before each operation :**

Before use, an inspection is always to be performed in order to determine that all nuts, bolts and working tools are not worn down or damaged.

Worn down or damaged blades are to be replaced in sets.

Inspect the surface on which the lawn mower is to be used beforehand. Stones, pieces of wood and wires as well as other solid matter must be removed.

*Objects, which are contacted by the cutting tools, could be thrown out uncontrollably or damage the cutting mechanism.*

**Proper use / Responsibility :**



**DANGER !**

**Take note that the rotating blade cylinder could cause injuries.**

**→ Never place your hands or feet on or under moving parts.**

Do not use the lawnmower while people, especially children or animals, are directly nearby.

The operator is liable for damages.

The safety distance between the blade cylinder and the operator that is created by the guiding spar is to be always maintained.

When mowing embankments and slopes, special care must be taken:

Make sure you always keep a safe distance and wear shoes with a nonslip sole and long trousers.

Always cut diagonally to the slope.

→ Do not mow on excessively steep gradients.

Take special care when moving backwards and when pulling the lawn mower. Danger of stumbling!

Should you hit an obstruction when working, remove the obstruction, check the mower for any damage and have it repaired if necessary.

→ Only work when visibility is good.

Never leave the lawnmower unattended.

If your work is interrupted, store the mower in a safe place.

**3. Assembly**

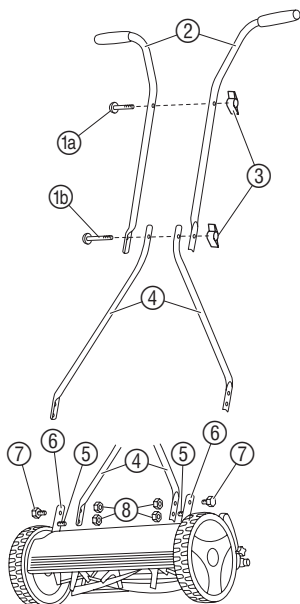

1. Insert the short screw ①a (45 mm) from the top through the upper part of the upright ②. Insert the long screw ①b (55 mm) from below through the upper part of the upright ② and the lower part ④.
2. Screw the wing nuts ③ onto the screws ①a / ①b.
3. Push the lower parts of the upright ④ together gently until they click into the bolts ⑤ on the upright supports ⑥.
4. Insert the hexagonal screws ⑦ (12 mm) through the upright supports ⑥ and the lower part of the upright ④.
5. Screw the 4 nuts ⑧ onto the bolts ⑤ and hexagonal screws ⑦ (e.g. with 2 SW 10 mm open ended spanners).
6. Undo the retaining screws ⑨ and insert one at the highest cut level and the other at the lowest cut level without screwing them up tight.
7. Insert the roller ⑩ diagonally into the roller supports ⑪.
8. Adjust both retaining screws ⑨ to the same height.

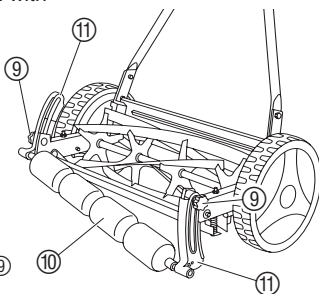

## 4. Function

### Mowing correctly:

To produce a well-maintained lawn we recommend cutting the lawn regularly once a week if possible. The lawn becomes thicker if cut frequently.

Relatively long cut grass (> 1 cm) must be removed so that the lawn does not become yellow and matted.

After relatively long intervals between mowing (**e.g. holiday**), first of all cut in one direction with the cutting height as high as possible, then cut in the crosswise direction at the cutting height required.

Wherever possible, only mow dry lawns. Damp lawns may lead to uneven cutting.

With very dense grass, we recommend thatching the lawn. For example with the GARDENA Lawn Aerator **art. 4068**.

## 5. Operation

### Adjusting the cutting height:

The cutting height can be set to any position between 12 mm and 56 mm (0,5" - 2,2").

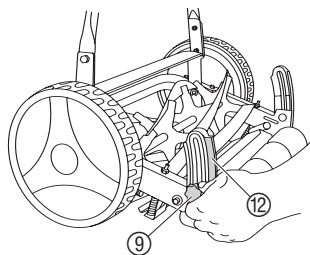

1. Slacken the two locking screws ⑨ and set to the height required on the scale ⑫.
2. Tighten the two locking screws ⑨ on both sides to the same height.

**The locking screws ⑨ must always be set to the same height on both sides.**

The mower may only be adjusted to a depth in which the lower blade does not touch the ground when it is uneven.

### Mowing with the Grass Catcher (accessory):

→ Fit the Grass Catcher **art. 964.90.10-30** in accordance with the instructions for the Grass Catcher and hook onto the Hand Cylinder Lawnmower.

## 6. Putting into storage

### Storage:

The storage location must be inaccessible to children.

1. Clean mower before storage.
2. Store mower in a dry place.

To save space the upper part of the upright can be folded up by removing the wing nuts.

## 7. Maintenance

### Cleaning the mower:



**DANGER !**  
Cutting tool can cause injuries!  
→ Wear suitable work gloves when undertaking maintenance.



**WARNING !**  
Damage to cylinder lawnmower.  
→ Never clean your cylinder mower with running water, in particular with water under high pressure.

Deposits affect the cutting result as well as discharge of grass clippings. Residual dirt and grass is easily removed immediately after mowing.

1. Remove grass deposits with a brush and a cloth.
2. Oil the red cutting mechanism lightly with low viscosity oil (e.g. sprayed oil).

## 8. Troubleshooting



**DANGER !**  
Danger of injury from the cutting tool!  
→ Wear suitable work gloves when rectifying faults.

Fault	Possible Cause	Rectification
<b>Abnormal Noises</b>	Screws / components loose.	→ Tighten screws.
	Foreign bodies on the blade.	→ Remove foreign bodies.
	Notch in the blade.	→ Remove notches with grindstone.
<b>Lawn is not cleanly cut</b>	Blade adjustment incorrect.	→ Adjust cutting mechanism.
	Cutting mechanism blunt.	Recommendation: → Have cutting mechanism reground or replaced by GARDENA Service.
	Lawn too long or damp.	→ See 4. Function "Mowing Tips".
<b>Wheels slip on the earth / Very difficult to push</b>	Grass too long or too damp.	→ Raise cutting height.
	Blades strike each other too hard.	→ Adjust cutting mechanism.

### Readjusting the cutting mechanism:

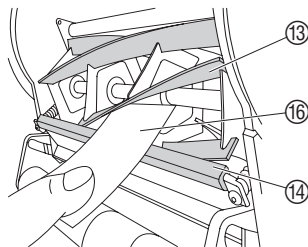
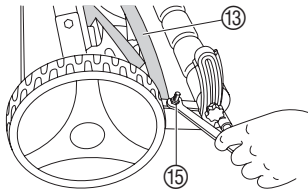

The cutting gear of your cylinder mower was optimally adjusted before leaving our company. If, after longer use, a clean cut of the grass is no longer possible or the blade roller contacts the lower blade, then the lower blade should be adjusted as follows:

1. Clean cylinder mower.
2. Check the cylinder ⑬ and lower blade ⑭ for notches and remove these if necessary with a grinding stone.
3. Unscrew the hexagonal nuts ⑮ anticlockwise (e.g. with an SW 10 mm hexagonal wrench) until the cylinder ⑬ turns freely.
4. Turn the hexagonal nut ⑮ clockwise alternately left and right gradually until the cylinder ⑬ and the lower blade ⑭ can hardly be heard touching each other.
5. **Cutting test:**  
Place a strip of paper ⑯ on the lower blade ⑭ in such a way that it points towards the spindle of the cylinder ⑬.
6. Turn cylinder ⑬ carefully.  
*if the lower blade ⑭ is adjusted properly the paper will be cut off as if with scissors.*
7. Repeat the cutting test on the other blades ⑬.
8. If the mower only cuts in the middle, each blade ⑬ must be adjusted separately.



**On safety grounds, only original GARDENA spares may be used.**

### Repairs:

Please contact GARDENA Service if it is necessary to replace the cutting tool, which will only become blunt after several years use if well-maintained.

Have the cylinder mower checked over in the autumn if possible so that it is ready for use immediately when the next lawn-mowing season starts.



**In the event of other faults please contact GARDENA Service. Repairs should only be carried out by GARDENA service centres or dealers authorised by GARDENA.**

## 9. Available accessories

**GARDENA Grass Catcher**

Saves raking up the cut grass.

**Art. 964.90.10-30**

## 10. Technical data

	<b>HiCut (Art. 4019)</b>
<b>Cutting height</b>	12 mm - 56 mm (0.5" - 2.2")
<b>Cutting width</b>	40 cm / 15.75"
<b>Cutting height adjustment</b>	infinitely variable
<b>Weight</b>	8.5 kg / 19 lbs
<b>Lawn area</b>	Approx. 200 m <sup>2</sup> / 2152 sqft

## 11. Service /Warranty

GARDENA guarantees this product for 2 years (starting from the date of purchase). This guarantee covers all serious defects of the unit that can be proved to be material or manufacturing faults. Under warranty we will either replace the unit or repair it free of charge if the following conditions apply:

- The unit must have been handled properly and in keeping with the requirements of the operating instructions.
- Neither the purchaser or a non-authorized third party have attempted to repair the unit.

The wearing parts blade cylinder (complete) and lower blade are excluded from the warranty.

This manufacturer's guarantee does not affect the user's existing warranty claims against the dealer/seller.

If a fault occurs with your GARDENA Cylinder Lawnmower, please return the faulty unit together with a copy of the receipt and a description of the fault, with postage paid to one of the GARDENA Service Centres listed on the back of these operating instructions.

<p><b>GB</b> <i>Product Liability</i></p>	<p>We expressly point out that, in accordance with the product liability law, we are not liable for any damage caused by our units if it is due to improper repair or if parts exchanged are not original GARDENA parts or parts approved by us, and, if the repairs were not carried out by a GARDENA Service Centre or an authorised specialist. The same applies to spare parts and accessories.</p>
<p><b>F</b> <i>Responsabilité</i></p>	<p>Nous vous signalons expressément que GARDENA n'est pas responsable des dommages causés par ses appareils, dans la mesure où ces dommages seraient causés suite à une réparation non conforme, dans la mesure où, lors d'un échange de pièces, les pièces d'origine GARDENA n'auraient pas été utilisées, ou si la réparation n'a pas été effectuée par le Service Après-Vente GARDENA ou l'un des Centres SAV agréés GARDENA. Ceci est également valable pour tout ajout de pièces et d'accessoires autres que ceux préconisés par GARDENA.</p>
<p><b>E</b> <i>Responsabilidad de productos</i></p>	<p>Advertimos que conforme a la ley de responsabilidad de productos no nos responsabilizamos de daños causados por nuestros aparatos, siempre y cuando dichos daños hayan sido originados por arreglos o reparaciones indebidas, por recambios con piezas que no sean piezas originales GARDENA o bien piezas autorizadas por nosotros, así como en aquellos casos en que la reparación no haya sido efectuada por un Servicio Técnico GARDENA o por un técnico autorizado. Lo mismo es aplicable para las piezas complementarias y accesorios.</p>
<p><b>D</b> <i>Produkthaftung</i></p>	<p>Wir weisen ausdrücklich darauf hin, dass wir nach dem Produkthaftungsgesetz nicht für durch unsere Geräte hervorgerufene Schäden einzustehen haben, sofern diese durch unsachgemäße Reparatur verursacht oder bei einem Teileaustausch nicht unsere Original GARDENA Teile oder von uns freigegebene Teile verwendet werden und die Reparatur nicht vom GARDENA Service oder dem autorisierten Fachmann durchgeführt wird. Entsprechendes gilt für Ergänzungsteile und Zubehör.</p>



**Deutschland / Germany**

GARDENA  
Manufacturing GmbH  
Central Service  
Hans-Lorenser-Straße 40  
D-89079 Ulm  
Produktfragen:  
(+49) 731 490-123  
Reparaturen:  
(+49) 731 490-290  
service@gardena.com

**Argentina**

Husqvarna Argentina S.A.  
Vera 745  
(C1414AOO) Buenos Aires  
Phone: (+54) 11 4858-5000  
diego.poggi@ar.husqvarna.com

**Australia**

Husqvarna Australia Pty. Ltd.  
Locked Bag 5  
Central Coast BC  
NSW 2250  
Phone: (+61) 1800 802831  
customer.service@  
husqvarna.com.au

**Austria / Österreich**

Husqvarna Austria GmbH  
Consumer Products  
Industriezeile 36  
4010 Linz  
Tel.: (+43) 732 77 01 01 - 90  
consumer.service@husqvarna.at

**Belgium**

GARDENA Belgium NV/SA  
Sterrebeekstraat 163  
1930 Zaventem  
Phone: (+32) 2 720 92 12  
Mail: info@gardena.be

**Brazil**

Palash Comércio e  
Importação Ltda.  
Rua São João do Araguaia, 338  
- Jardim Califórnia -  
Barueri - SP - Brasil -  
CEP 06409-060  
Phone: (+55) 11 4198-9777  
eduardo@palash.com.br

**Bulgaria**

Хускварна България ЕООД  
1799 София  
Бул. „Андрей Ляпчев“ № 72  
Тел.: (+359) 2 80 99 424  
www.husqvarna.bg

**Canada**

GARDENA Canada Ltd.  
100 Summerlea Road  
Brampton, Ontario L6T 4X3  
Phone: (+1) 905 792 93 30  
info@gardenacanada.com

**Chile**

Antonio Martinic y Cia Ltda.  
Cassillas 272  
Centro de Cassillas  
Santiago de Chile  
Phone: (+56) 2 20 10 708  
garfar\_cl@yahoo.com

**Costa Rica**

Compania Exim  
Euroberoamericana S.A.  
Los Colegios, Moravia,  
200 metros al Sur del Colegio  
Saint Francis - San José  
Phone: (+506) 297 68 83  
exim\_euro@racsa.co.cr

**Croatia**

KLIS d.o.o.  
Stanceva 79  
10419 Vukovina  
Phone: (+385) 1 622 777 0  
gardena@klis-trgovina.hr

**Cyprus**

FARMOKIPIKI LTD  
P.O. Box 7098  
74, Digeni Akritas Ave.  
1641 Nicosia  
Phone: (+357) 22 75 47 62  
condam@spidernet.com.cy

**Czech Republic**

GARDENA spol. s r.o.  
Tuřanka 115  
627 00 Brno  
Phone: (+420) 548 217 777  
gardena@gardenabrno.cz

**Denmark**

GARDENA  
Husqvarna Consumer Outdoor  
Products  
Salgsafdelning Danmark  
Box 9003  
S-200 39 Malmö  
info@gardena.dk

**Estonia**

Husqvarna Eesti OÜ  
Consumer Outdoor Products  
Kesk tee 10, Aaviku küla  
Rae vald, Harju maakond  
75305  
kontakt.etj@husqvarna.ee

**Finland**

Oy Husqvarna Ab  
Consumer Outdoor Products  
Lautatarhanki 8 B / PL 3  
00581 HELSINKI  
info@gardena.fi

**France**

GARDENA France  
Immeuble Exposial  
9 - 11 allée des Pierres Mayettes  
ZAC des Barbanniers, B.P. 99  
-F- 92232 GENNEVILLIERS  
cedex  
Tél. (+33) 01 40 85 30 40  
service.consommateurs@  
gardena.fr

**Great Britain**

Husqvarna UK Ltd  
Preston Road  
Aycliffe Industrial Park  
Newton Aycliffe  
County Durham  
DL5 6UP  
info.gardena@  
husqvarna.co.uk

**Greece**

HUSQVARNA GREECE S.A.  
Branch of Koropi  
Ifestou 33A  
Industrial Area Koropi  
194 00 Athens - Greece  
V.A.T. EL094094640  
Phone: (+30) 210 66 20 225  
info@husqvarna-consumer.gr

**Hungary**

Husqvarna  
Magyarország Kft.  
Ezred u. 1 - 3  
1044 Budapest  
Phone: (+36) 80 20 40 33  
gardena@gardena.hu

**Iceland**

Ó. Johnson & Kaaber  
Tunguhalsi 1  
110 Reykjavik  
ooj@ojk.is

**Ireland**

Michael McLoughlin & Sons  
Hardware Limited  
Long Mile Road  
Dublin 12

**Italy**

GARDENA Italia S.p.A.  
Via Donizetti 22  
20020 Lainate (Mi)  
Phone: (+39) 02.93.94.79.1  
info@gardenaitalia.it

**Japan**

KAKUICHI Co. Ltd.  
Sumitomo Realty &  
Development Kojimachi  
BLDG. 8F, 5-1 Nibanbany,  
Chiyoda-ku, Tokyo 102-0084  
Phone: (+81) 33 264 4721  
m\_ishihara@kaku-ichi.co.jp

**Latvia**

SIA „Husqvarna Latvija“  
Consumer Outdoor Products  
Bākūžu iela 6, Rīga, LV-1024  
info@husqvarna.lv

**Lithuania**

UAB Husqvarna Lietuva  
Consumer Outdoor Products  
Ateities pl. 77C  
LT-52104 Kaunas  
centras@husqvarna.lt

**Luxembourg**

Magasins Jules Neuberg  
39, rue Jacques Stas  
Luxembourg-Gasperich 2549  
Case Postale No. 12  
Luxembourg 2010  
Phone: (+352) 40 14 01  
api@neuberg.lu

**Netherlands**

GARDENA Nederland B.V.  
Postbus 50176  
1305 AD ALMERE  
Phone: (+31) 36 521 00 00  
info@gardena.nl

**Neth. Antilles**

Jonka Enterprises N.V.  
Sta. Rosa Weg 196  
P.O. Box 8200, Curaçao  
Phone: (+599) 9 767 66 55  
pgm@jonka.com

**New Zealand**

Husqvarna New Zealand Ltd.  
PO Box 76437  
Manukau City 2241  
Phone: (+64) 09 9202410

**Norway**

GARDENA  
Husqvarna Consumer Outdoor  
Products  
Salgskontor Norge  
Kleiveveien 6  
1540 Vestby  
info@gardena.no

**Poland**

Husqvarna Poland Spółka z o.o.  
Oddział w Szymanowie  
Szymanów 9 d  
05-532 Baniocha  
Phone: (+48) 22 727 56 90  
gardena@gardena.pl

**Portugal**

GARDENA Portugal Lda.  
Sintra Business Park  
Edifício 1, Fração 0-G  
2710-089 Sintra  
Phone: (+351) 21 922 85 30  
info@gardena.pt

**Romania**

MADEX INTERNATIONAL SRL  
Soseaua Odaii 117-123,  
Sector 1,  
București, RO 013603  
Phone: (+40) 21 352 76 03  
madox@ines.ro

**Russia**

ООО ГАРДЕНА РУС  
123007, г. Москва  
Хорошевское шоссе, д. 32А  
Тел.: (+7) 495 380 31 92  
info@gardena-rus.ru

**Singapore**

Hy - Ray PRIVATE LIMITED  
40 Jalan Pemimpin  
#02-08 Tat Ann Building  
Singapore 577185  
Phone: (+65) 6253 2277  
shiyang@hyray.com.sg

**Slovak Republic**

GARDENA spol. s r.o.  
Tuřanka 115  
627 00 Brno  
Phone: (+420) 548 217 777  
gardena@gardenabrno.cz

**Slovenia**

GARDENA d.o.o.  
Brodšče 15  
1236 Trzin  
Phone: (+386) 1 580 93 32  
servis@gardena.si

**South Africa**

GARDENA  
South Africa (Pty.) Ltd.  
P.O. Box 11534  
Vorna Valley 1686  
Phone: (+27) 11 315 02 23  
sales@gardena.co.za

**Spain**

GARDENA IBÉRICA S.L.U.  
C/ Basauri, nº 6  
La Florida  
28023 Madrid  
Phone: (+34) 91 708 05 00  
atencioncliente@gardena.es

**Sweden**

GARDENA  
Husqvarna Consumer Outdoor  
Products  
Försäljningskontor Sverige  
Box 9003  
200 39 Malmö  
info@gardena.se

**Switzerland / Schweiz**

GARDENA Schweiz AG  
Consumer Products  
Industriestrasse 10  
5506 Mägenwil  
Phone: (+41) (0) 848 800 464  
info@gardena.ch

**Turkey**

GARDENA / Dost Diş Ticaret  
Müessesilik A.Ş. Sanayi  
Çad. Adil Sokak No. 1  
Kartal - Istanbul  
Phone: (+90) 216 38 93 939  
info@gardena-dost.com.tr

**Ukraine / Україна**

ТОВ «ГАРДЕНА УКРАЇНА»  
Васильківська, 34, 204-Г  
03022, Київ  
Тел. (+38 044) 498 39 02  
info@gardena.ua

4019-2960.01/1108  
© GARDENA  
Manufacturing GmbH  
D-89070 Ulm  
http://www.gardena.com