

PowerMax 34 E
Art. 4031-20

D	Betriebsanleitung Elektro-Rasenmäher
GB	Operating Instructions Electric Lawnmower
F	Mode d'emploi Tondeuse électrique
NL	Instructies voor gebruik Elektrische grasmaaier
S	Bruksanvisning Elektrisk Gräsklippare
DK	Bruksanvisning Elektrisk Plæneklipper
N	Bruksanvisning Elektrisk Gressklipper
FIN	Käyttöohje Tehokas sähköleikkuri
I	Istruzioni per l'uso Rasaerba elettrico
E	Manual de instrucciones Cortacésped eléctrico
P	Instruções de utilização Máquina de cortar relva eléctrica
PL	Instrukcja obsługi Elektryczna kosiarka
H	Vevőútjékoztató Elektromos fűnyíró
CZ	Návod k obsluze Elektrická sekačka

SK	Návod na používanie Elektrická kosačka
GR	Οδηγίες χρήσεως Ηλεκτρική χλοοκοπτική μηχανή
RUS	Инструкция по эксплуатации Электрические газонокосилки
SLO	Navodila za uporabo Električna kosiλnica
HR	Uputstva za upotrebu Električna kosilica
SRB	Uputstvo za rad
BIH	Električna kosilica
UA	Інструкція з експлуатації Електрична газонокосарка
RO	Instrucțiuni de utilizare Masina electrica de tuns gazonul
TR	Kullanma Talimatı Elektrikli Çim Bıçme Makinesi
BG	Инструкция за експлоатация Електрокосачка
AL	Manual përdorimi Prerëse bari elektrike
EST	Kasutusjuhend Elektriline muruniiduk
LT	Eksploatavimo instrukcija Elektrinė vejapjovė
LV	Lietošanas instrukcija Elektriskā zāles pļaujmašina

D
GB
F
NL
DK
S
FIN
N
I
E
P
PL
H
CZ
SK
GR
SRB
SLO
HR
UA
SRB
RO
TR
BG
AL
EST
LT
LV

- D** **WICHTIGE INFORMATION**
Übersetzung englischen Originalbetriebsanleitung. Bitte vor dem Benutzen des Gerätes durchlesen und gut aufbewahren.
- GB** **IMPORTANT INFORMATION**
Original instructions. Read before use and retain for future reference.
- F** **RENSEIGNEMENTS IMPORTANTS**
Instructions d'origine. A lire avant usage et à conserver pour référence ultérieure.
- NL** **BELANGRIJKE INFORMATIE**
Oorspronkelijke instructies. Leest u deze informatie voor het gebruik en bewaar ze voor toekomstige raadpleging.
- S** **VIKTIG INFORMATION**
Originalinstruktioner. Läs anvisningarna före användningen och spara dem för framtida behov.
- DK** **VIGTIGE OPLYSNINGER**
Originale instruktioner. Du bør læse brugsanvisningen før brug og gemme til senere henvisning.
- N** **VIKTIG INFORMASJON**
Originalinstrukser. Les bruksanvisningen nøye før bruk og oppbevar den for senere bruk.
- FIN** **VIGTIGE OPLYSNINGER**
Alkuperäiset ohjeet. Du bør læse brugsanvisningen før brug og gemme til senere henvisning.
- I** **INFORMAZIONI IMPORTANTI**
Istruzioni originali. Leggere prima dell'uso e conservare per ulteriores consultazione.
- E** **INFORMACIÓN IMPORTANTE**
Instrucciones originales. Léase antes de utilizar y consérvela como referencia en el futuro
- P** **INFORMAÇÕES IMPORTANTES**
Instruções Originais. Leia antes de utilizar e guarde para consulta futura
- PL** **UWAGA**
Oryginalne Instrukcje. Zapoznać się z treścią niniejszej instrukcji przed użyciem i zachować ją do dalszego użytkowania urządzenia.
- H** **FONTOS INFORMÁCIÓ**
Eredeti Utasítás. Használat előtt olvassa el, és tartsa meg későbbi felhasználásra.
- CZ** **DŮLEŽITÁ INFORMACE**
Originální pokyny. Než začnete stroj používat, přečtěte si pozorně tento návod a uschovejte jej pro další použití v budoucnu.
- SK** **DÔLEŽITÉ INFORMÁCIE**
Pôvodné pokyny. Pred použitím si prečítajte nasledovné informácie a odložte si ich pre budúcu potrebu.
- GR** **ΣΗΜΑΝΤΙΚΕΣ ΠΛΗΡΟΦΟΡΙΕΣ**
Αρχικές οδηγίες. Διαβάστε αυτό το φυλλάδιο πριν από τη χρήση της συσκευής και φυλάξτε το για μελλοντική αναφορά.
- RUS** **ВАЖНАЯ ИНФОРМАЦИЯ**
Исходные инструкции. Прочитайте перед тем, как включить триммер, и сохраните для дальнейшего использования.
- SLO** **POMEMBNA INFORMACIJA**
Originalna navodila. Preberite pred uporabo in shranite za prihodnjo uporabo.
- HR** **VAŽNE INFORMACIJE**
Originalne upute. Pročitati prije upotrebe i sačuvati za buduće osvrte.
- SRB** **VAŽNE INFORMACIJE**
Originalna uputstva. Pročitajte pre upotrebe i sačuvajte kao podsetnik u budućnosti
- BIH**
- UA** **ВАЖЛИВА ІНФОРМАЦІЯ**
Оригінальні інструкції. Прочитайте перед початком роботи і збережіть для подальшого використання.
- RO** **MANUAL DE INSTRUCȚIUNI**
Instrucțiuni originale. Înainte să folosiți mașina de tuns pentru prima oară, citiți cu atenție manualul de instrucțiuni pentru a-i înțelege conținutul.
- TR** **ÖNEMLİ BİLGİLER**
Original Talimatlar. Kullanmadan önce okuyunuz ve ileride başvurmak üzere saklayınız.
- BG** **ВАЖНА ИНФОРМАЦИЯ**
Оригиналните инструкции. очетете преди употреба и запазете за бъдещи справки
- AL** **INFORMACION I RËNDËSISHËM**
Udhëzimet originale. Lexojini përpara se ta përdorni pajisjen dhe ruajini për t'ju referuar në të ardhmen.
- EST** **OLULINE TEAVE**
Algsed juhised. Enne seadme kasutuselevõtmist lugege kasutusjuhend läbi ning säilitage see tuleviku tarbeks.
- LT** **OPERATORIAUS INSTRUKCIJŲ RINKINYS**
Pagrindinės instrukcijos. Perskaitykite šį instrukcijų rinkinį labai atidžiai, kad pilnai suprastumėte turinį, prieš pradėdami naudoti vejos/žolės pjovėją.
- LV** **SVARĪGA INFORMĀCIJA**
Sākotnējās instrukcijas. Pirms lietošanas izlasiet un saglabāiet turpmākām uzziņām.

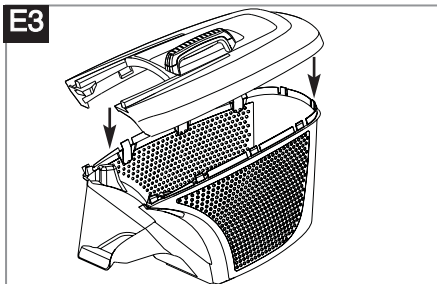
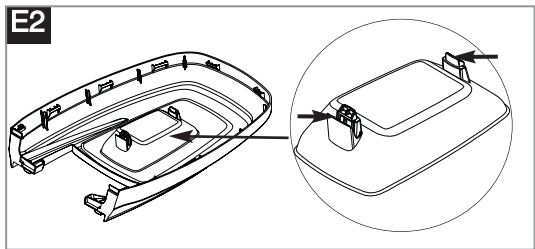
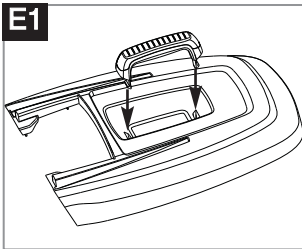
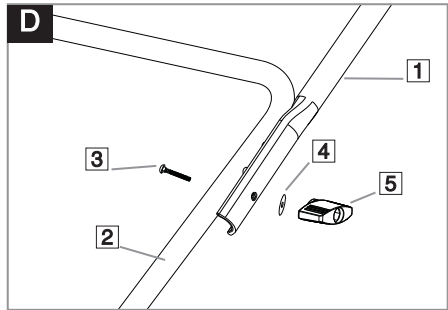
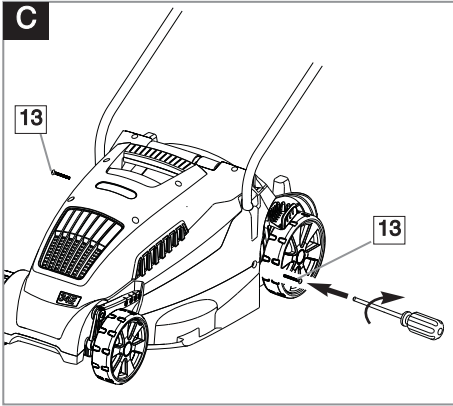
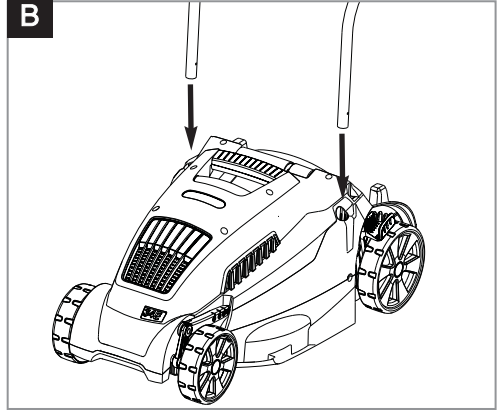
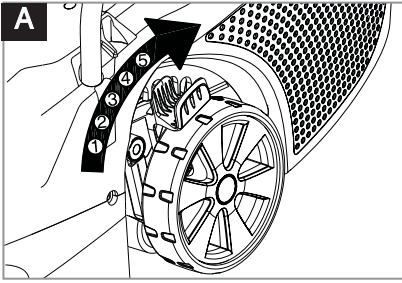

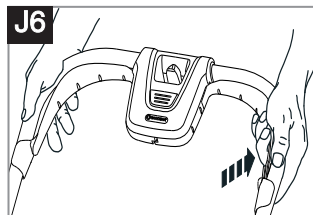
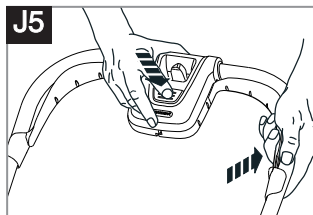
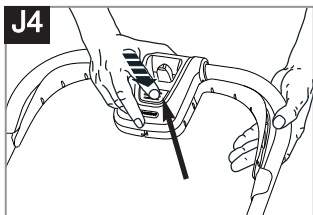
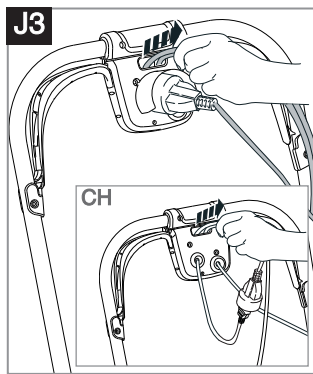
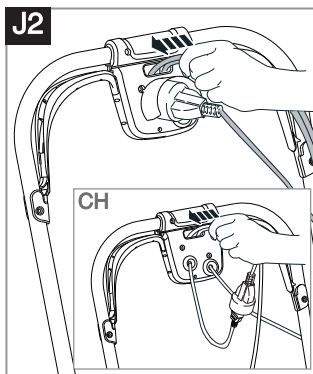
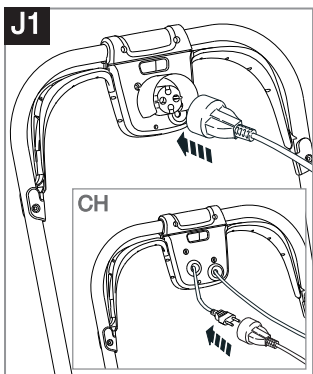
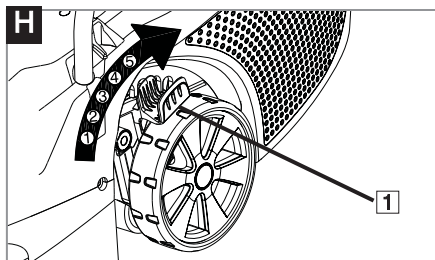
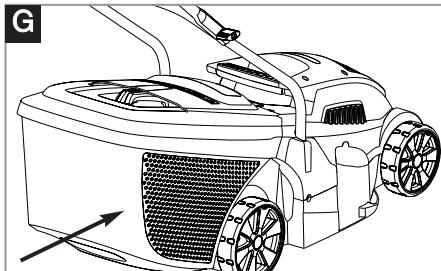
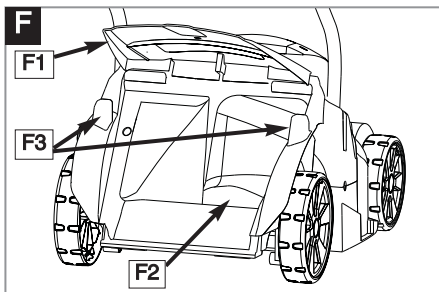

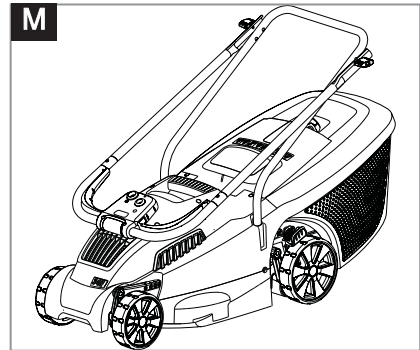
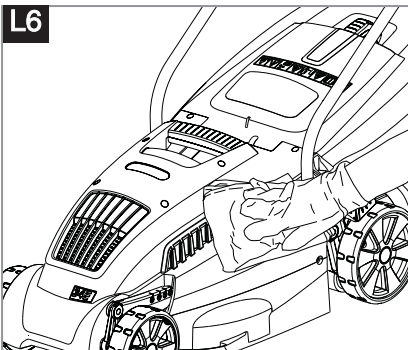
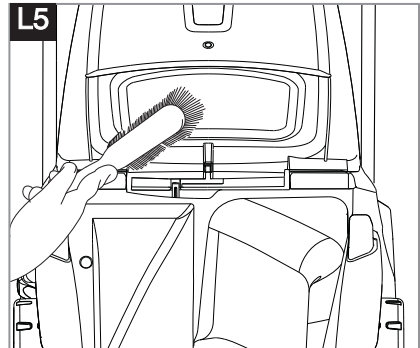
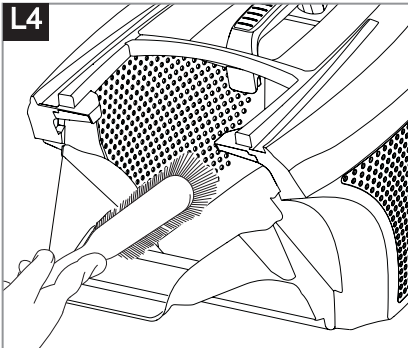
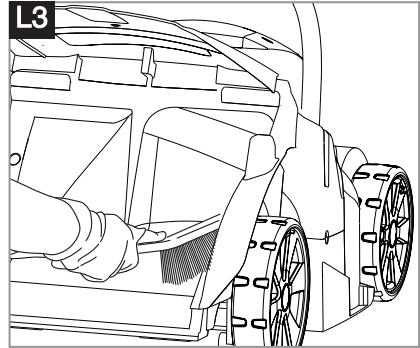
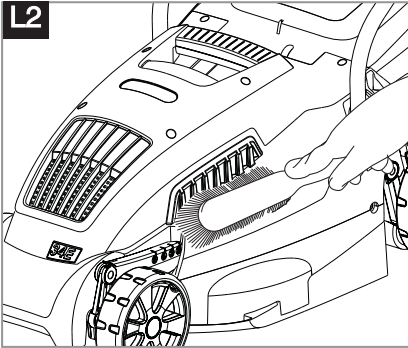
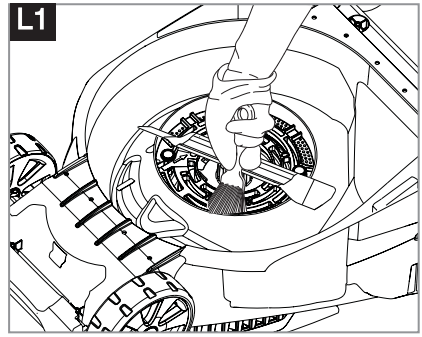
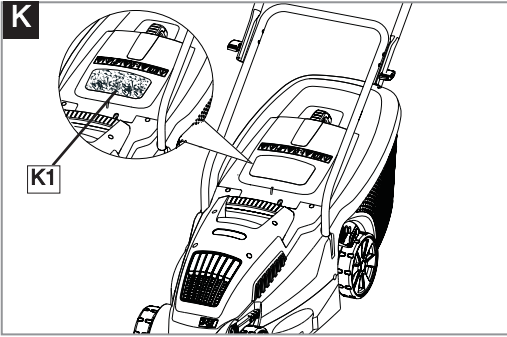

D	Verwenden Sie keine Flüssigkeiten zur Reinigung.	P	NÃO use líquidos para limpar.	UA	Для очищення НЕ ВИКОРИСТОВУЙТЕ рідину.
GB	DO NOT use liquids for cleaning.	PL	NIE używać płynów do czyszczenia.	RO	NU utilizați pentru curățire lichide.
F	NE PAS utiliser de produit liquide pour le nettoyage.	H	NE használjon folyadékot tisztításra.	TR	Temizleme için sıvılar KULLANMAYIN .
NL	Voor het reinigen NOOIT vloeistoffen gebruiken.	CZ	K čistění NEPOUŽÍVEJTE kapalinu.	BG	НЕ използвайте течности за почистване
S	ANVÄND INTE vätskor för rengöring.	SK	NEPOUŽÍVAJTE na čistenie tekuté materiály.	AL	MOS përdorni lëngje për pastrim.
DK	BRUG IKKE væske til rengøring.	GR	MHN καθαρίζετε με υγρά.	EST	ÄRGE kasutage puhastamiseks vedelikke.
N	Flytende midler MÅ IKKE brukes til rengjøring.	RUS	НЕ используйте жидкости для очистки.	LT	Nenaudokite skysčių valymui.
FIN	ÄLÄ käytä nesteitä puhdistamiseen.	SLO	NE uporabljajte raznih tekočin za čiščenje.	LV	Trišānai NEIZMANTOJĒT šķidrumus.
I	NON usare liquidi per la pulizia.	HR	NEMOJTE koristiti tekućine za čišćenje.		
E	NO utilice líquidos para la limpieza.	SRB	NEMOJTE koristiti tečnosti za čišćenje.		
		BIH	čišćenje.		

D	Reparaturen dürfen nur von GARDENA Servicestellen oder von GARDENA autorisierten Fachhändlern durchgeführt werden.	E	Las reparaciones solo pueden hacerlas los centros de servicio de GARDENA o los distribuidores autorizados por GARDENA.	HR	Popravak mogu izvršiti GARDENA servisi centri ili prodajna mjesta koje je GARDENA za to ovlastila.
GB	Repairs may only be carried out by GARDENA service centres or dealers authorised by GARDENA.	P	As reparações podem não ser feitas nos centros de serviço ou concessionários autorizados da GARDENA.	SRB	Popravke smeju da obavljanju samo GARDENA servisi centri ili distributeri koje je ovlastila kompanija GARDENA.
F	Pour des raisons de sécurité, les réparations ne doivent être effectuées que par le Service Après-Vente de GARDENA France ou l'un des Centres SAV agréés GARDENA.	PL	Naprawy mogą być wykonywane tylko w placówkach serwisowych GARDENA lub u dealerów autoryzowanych przez GARDENA.	UA	Ремонт може здійснюватися винятково в сервісних центрах GARDENA, або дилерами, які авторизовані GARDENA.
NL	Reparaties mogen alleen door de GARDENA technische dienst of door GARDENA geautoriseerde vakhandels uitgevoerd worden.	H	Javítást csak a GARDENA szervizközpontok vagy a GARDENA által meghatalmazott márkakereskedők végezhetnek.	RO	Reparațiile se vor efectua doar de către centrele de service GARDENA sau de către dealerii autorizati de către GARDENA.
S	Reparationer får endast utföras av GARDENA service eller av återförsäljares service auktoriserad av GARDENA.	CZ	Opravy mohou provádět pouze servisní střediska firmy GARDENA nebo prodejci schválení firmou GARDENA.	TR	Onarım çalışmalarını yalnızca GARDENA servis merkezleri veya GARDENA tarafından onaylanan satıcılar tarafından yürütülebilir.
DK	Reparationer må kun udføres af GARDENA service centre eller forhandlere, der er autoriseret af GARDENA.	SK	Opravy môžu byť prevedené iba v servisnom stredisku GARDENA alebo u predajcov autorizovaných spoločnosťou GARDENA.	BG	Ремонти могат да се извършват единствено от центровете по поддръжката на GARDENA или упълномощени от нея представители.
N	Reparasjon vil muligens kun bli utført av GARDENA servicestener eller autoriserte GARDENA-forhandlere.	GR	Οι επισκευές διεξάγονται μόνο από τα κέντρα σέρβις της GARDENA ή από εξουσιοδοτημένους αντιπροσώπους της GARDENA.	AL	Riparimet mund të bëhen vetëm nga qendrat e shërbimit të GARDENA-s ose nga shitësit e autorizuar nga GARDENA.
FIN	Korjaukset voidaan ainoastaan suorittaa GARDENA:n huoltokeskusten tai GARDENA:n valtuuttamien myyjien toimesta.	RUS	Починка устройства может быть выполнена только сервис-центрами компании GARDENA или официальными посредниками GARDENA.	EST	Parandustööd tohivad teha vaid GARDENA teeninduskeskused või GARDENA volitatud edasimüüjad.
I	Le riparazioni possono essere eseguite solo dai centri assistenza GARDENA o da personale specializzato autorizzato GARDENA.	SLO	Popravila lahko opravijo samo servisni centri GARDENA ali prodajalci, ki jih je pooblastilo podjetje GARDENA.	LT	Remontuoti prietaisą galima tik GARDENA techninės priežiūros centruose arba pas įgaliotą GARDENA atstovą.
				LV	Remontu drīkst veikt tikai GARDENA klientu apkalpošanas centri vai GARDENA apstiprināti tirgotāji.

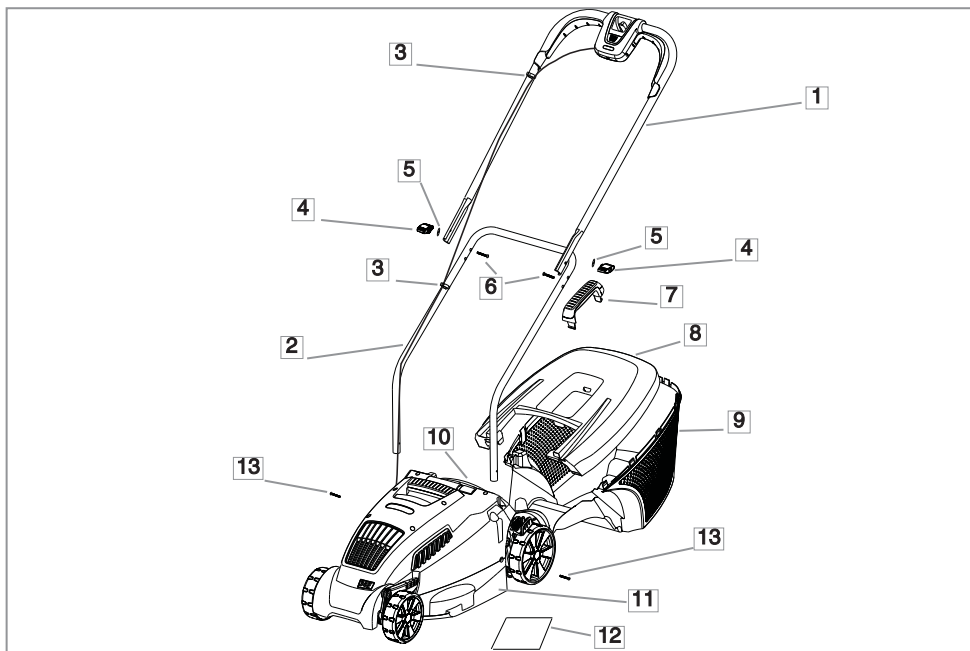

D - INHALT

1. Holm-Oberteil
2. Holm-Unterteil
3. Kabelclips x 2
4. Flügelschraube orange x 2
5. Unterlegscheibe x 2
6. Schraube x 2
7. Tragegriff
8. Oberteil Fangbox
9. Unterteil Fangbox
10. Warnsymbole
11. Produkttypenschild
12. Betriebsanleitung
13. Schraube x 2 (Holm)

GB - CONTENTS

1. Upper handle
2. Lower handle
3. Cable clip x2
4. Handle knob x 2
5. Washer x 2
6. Bolt x 2
7. Grassbox handle
8. Grassbox Upper
9. Grassbox lower
10. Warning Symbols
11. Product rating label
12. Instruction Manual
13. Screw x 2 (Handle)

F - TABLE DES MATIÈRES

1. Guidon supérieur
2. Guidon inférieur
3. Attache câble x 2
4. Bouton de Guidon x 2
5. Rondelles x 2
6. Boulons x 2
7. Poignée du bac
8. Partie supérieure du bac

9. Partie inférieure du bac
10. Etiquette de précautions d'emploi
11. Plaquette des Caractéristiques du Produit
12. Manuel d'Instructions
13. Vis x 2 (Guidon)

NL - INHOUD

1. Bovenstuk van duwboom
2. Onderstuk van duwboom
3. Snoerklem x 2
4. Knop voor duwboom x 2
5. Pakkingring x 2
6. Bout x 2
7. Handgreep grasbak
8. Bovenste deel grasvangbak
9. Onderste deel grasvangbak
10. Waarschuwingssymbolen
11. Product-informatielabel
12. Handleiding
13. Schroef x 2 (Duwboom)

S - INNEHÅLL

1. Övre handtag
2. Nedre handtag
3. Kabelklämma 2 st
4. Vingmutter 2 st
5. Bricka 2 st
6. Bult 2 st
7. Handtag för gräsopsamlare
8. Gräsopsamlare överdel
9. Gräsopsamlare underdel
10. Varningssymboler
11. Produktmärkning
12. Bruksanvisning
13. Skruv 2 st (Handtag)

DK - INDHOLD

1. Øvre håndtag
2. Nedre håndtag
3. Kabelklemme x 2
4. Håndtagsknop x 2
5. Spændeskive x 2
6. Bolt x 2
7. Opsamlerhåndtag
8. Øverste del af græsboksen
9. Nederste del af græsboksen
10. Advarselssymboler
11. Produktets mærkeskilt
12. Brugsvejledning
13. Skruer x 2 (Håndtag)

N - INNHOLD

1. Øvr håndtak
2. Nedre håndtak
3. Kabelklemme x 2
4. Vingemutter x 2
5. Skive x 2
6. Bolt x 2
7. Håndtak til gressoppsamler
8. Øvre del av gressoppsamleren
9. Nedre del av gressoppsamleren
10. Waarschuwingssymbolen
11. Produktmerking
12. Bruksanvisning
13. Skruer x 2 (Håndtak)

FIN - SISÄLTÖ

1. Ylempi kahva
2. Alempi kahva
3. Johdon pidike x 2
4. Kahvan nuppi x 2
5. Tiivistysrenkas x 2
6. Pultti x 2

Safety



If not used properly this product can be dangerous! This product can cause serious injury to the operator and others, the warnings and safety instructions must be followed to ensure reasonable safety and efficiency in using this product. The operator is responsible for following the warning and safety instructions in this manual and on the product.

Explanation of Symbols on the product



Warning



Read the user instructions carefully to make sure you understand all the controls and what they do.



Always keep the product on the ground when operating. Tilting or lifting the product may cause stones to be thrown out.



Keep bystanders away. Do not operate whilst people especially children or pets are in the area.



Beware of sharp blades - remove plug from mains before maintenance or if cable is damaged.



Blades continue to rotate after the machine is switched off.



Keep the supply cable away from the blade.



General

1. This product is not intended for use by persons (including children) with reduced physical, sensory or mental capabilities, or lack of experience and knowledge, unless they have been given supervision or instruction concerning the use of the product by a person responsible for their safety. Children should be supervised to ensure that they do not play with the product. For safety reasons, children under the age of 16 or people who are not familiar with these operating instructions should not use this product.
2. Never allow children or people unfamiliar with the instructions to use the machine.
3. Stop using the machine while people, especially children, or pets are nearby.
4. Only use the product in the manner and for the functions described in these instructions.
5. Never operate the product when you are tired, ill or under the influence of alcohol, drugs or medicine.
6. The operator or user is responsible for accidents or hazards occurring to other people or their property.

Electrical

1. The use of a Residual Current Device (R.C.D.) with a tripping current of not more than 30mA is recommended. Even with a R.C.D. installed 100% safety cannot be guaranteed and safe working practice must be followed at all times. Check your R.C.D. every time you use it.
2. Before use, examine cable for damage, replace it if there are signs of damage or ageing.
3. Do not use the product if the electric cables are damaged or worn
4. Immediately disconnect from the mains electricity supply if the cable is cut, or the insulation is damaged. Do not touch the electric cable until the electrical supply has been disconnected. Do not repair a cut or damaged cable. Replace it with a new one.
5. Your extension cable must be uncoiled, coiled cables can overheat and reduce the efficiency of your mower.
6. Keep cable away from product, always work away from the power point mowing up and down, never in circles.
7. Do not pull cable around sharp objects.
8. Always switch off at the mains before disconnecting any plug, cable connector or extension cable.
9. Switch off, remove plug from mains and examine electric supply cable for damage or ageing **before** winding cable for

storage. Do not repair a damaged cable, replace it with a new one. Use only genuine replacement cable.

10. Always wind cable carefully, avoiding kinking.
11. Never carry the product by the cable.
12. Never pull on the cable to disconnect any of the plugs.
13. Use only on AC mains supply voltage shown on the product rating label.
14. Our products are double insulated to EN60335. Under no circumstances should an earth be connected to any part of the product.

Cables

If extension cables are used, these must comply with the minimum cross-sections in the table below:

Voltage	Cable length	Cross section
220-240V/ 50Hz	Up to 20 m	1.5 mm ²
220-240V/ 50Hz	20 - 50 m	2.5 mm ²

1. Only use extension cables specifically designed for outdoor use and which conform to one of the following specifications: Ordinary rubber (60245 IEC 53), Ordinary PVC (60227 IEC 53) or Ordinary PCP (60245 IEC 57)

Preparation

1. While using your product always wear substantial footwear and long trousers. Do not operate the equipment when barefoot or wearing open sandals.
2. Make sure the lawn is clear of sticks, stones, bones, wire and debris; they could be thrown by the blade.
3. Before using the machine and after any impact, check for signs of wear or damage and repair as necessary.
4. Replace worn or damaged blades together with their fixings in sets to preserve balance.

Use

1. Use the product only in daylight or good artificial light.
2. Avoid operating your product in wet grass, where feasible.
3. Take care in wet grass, you may lose your footing.
4. On slopes, be extra careful of your footing and wear non-slip footwear.
5. Operate your product across the face of slopes, never up and down.
6. Exercise extreme caution when changing direction on slopes. Walk never run.
7. Make sure you always take up a safe and stable stance whilst working, especially on slopes. Do not use the mower close to swimming pools or garden ponds.
8. Do not walk backwards when operating, you could trip.
9. Never cut grass by pulling the product towards you.
10. Switch off before pushing the product over surfaces other than grass.
11. Never operate the product with damaged guards or without guards in place.
12. Keep hands and feet away from the cutting means at all times and especially when switching on the motor.
13. Do not tilt product when the motor is running.
14. Do not put hands near the grass discharge chute.
15. Never pick up or carry a product when it is operating or still connected to the mains supply.
16. Remove the plug from the mains :
 - before leaving the product unattended for any period;
 - before clearing a blockage;
 - before checking, cleaning or working on the appliance;
 - if you hit an object. Do not use your product until you are sure that the entire product is in a safe operating condition.;
 - if the product starts to vibrate abnormally. Check immediately. Excessive vibration can cause injury.

Maintenance and storage

1. Caution: Do not touch rotating blade(s)
2. Keep all nuts, bolts and screws tight to be sure the product is in safe working condition.
3. Check the grassbox frequently for wear or deterioration.
4. Replace worn or damaged parts for safety.
5. Only use the replacement parts specified for this product.
6. Be careful during adjustment of the product to prevent entrapment of the fingers between moving blades and fixed parts of the machine.
7. Store in a cool dry place and out of reach of children. Do not store outdoors.

Where to Use Your GARDENA PowerMax 34E Mower

The GARDENA mower is designed for cutting lawns in and around the garden.
Do not use the mower on a slope steeper than 20° maximum.

To prevent injury, the mower must not be used for trimming bushes, hedges, shrubs, for cutting and pruning of climbers or grass on roofs or in balcony boxes. In addition, the mower must not be used for chopping up branches, twigs or for levelling irregularities in the soil.

IMPORTANT INFORMATION

When received from the Manufacturer, the wheels are in a raised position. **Do not switch on the product before removing from the raised position into position 5. (See fig A)**

Assembly of Lower Handles to Lawnmower

1. Insert lower handles into the deck and push down **(B)**
2. Using a pozi drive screwdriver insert the screws into the deck and handles and fully tighten **(C)**

Assembly of Upper Handles to Lower Handles

1. Ensure the upper handle is located correctly with the lock-off button on the switchbox uppermost.
2. Ensure the upper handle **(D1)** and the lower handle **(D2)** are aligned correctly. There are two holes for upper handle height adjustment.
3. Fit the bolt **(D3)**, washer **(D4)** and wing knob **(D5)**. Tighten the wing knob.
4. Repeat on the other side.
5. Fit the cable to the handles with the clips provided. See Contents page for position. Make sure the cable is not trapped between the upper and lower handles.

Grassbox Assembly

Grassbox Handle Assembly

1. Locate the grassbox handle into the slots in the grassbox upper and push until it clicks into position. **(E1)**
2. Looking at the underside of the lid **(E2)**, ensure the clips of the grassbox handle are securely located.

Grassbox Assembly

1. Locate the grassbox lid onto the grassbox by aligning the clips. Ensure all clips are correctly located before clicking into position **(E3)**

Fitting Fully Assembled Grassbox to Lawnmower.

1. Lift safety flap **(F1)**
2. Make sure the discharge chute is clean and free from debris **(F2)**
3. Locate fully assembled grassbox onto 2 location points **(F3)** at the rear of the deck as illustrated in **pic. G**

4. Locate safety flap onto the top of the grassbox. Ensure the grassbox is securely located.

- **IMPORTANT ! AFTER FITTING ENSURE NO GAP REMAINS BETWEEN THE SAFETY FLAP AND THE GRASSBOX.**
- Removal is the reverse procedure.
- For larger areas of grass where grass collection is not required you can use your lawnmower without the grassbox. Ensure the Safety Flap is fully closed. The design of the safety flap permits the cut grass to be discharged downward behind the machine.

Cutting Height Adjustment

- Height of cut is adjusted by raising or lowering the wheels using the height adjustment lever **(H1)**
- There are five heights of cut on this product (20 - 60 mm).

Heights of cut:-

1 & 2 - low, 3 - medium, 4 & 5 - high

- **NOTE**

A medium height of cut is recommended for most lawns. The quality of your lawn will suffer and collection will be poor if you cut too low.

Starting and Stopping

To Start your Lawnmower

1. Attach the extension cable to the back of the switchbox **(J1)**
2. Form a loop in the cable and push the loop through the slot. **(J2)**
3. To secure, position the loop over the hook and pull the cable back through the slot **(J3)**.
4. Connect the plug to the mains and switch on.
The switchbox is provided with a lock-off button (J4) to prevent accidental starting.
5. Press and hold the lock-off button **(J4)** on the

switchbox, then squeeze one of the Start/Stop levers towards the upper handle **(J5)**.

6. Continue to squeeze the start/stop lever towards the upper handle and release the lock-off button **(J6)**.
- **NOTE - There are two start/stop levers fitted. Either one can be used for starting the lawnmower.**

To Stop your Lawnmower

1. Release the pressure on the Start/Stop lever.

CH (Schweiz)

To ensure you have a secure connection between the lawnmower and the extension cable we strongly recommend you use the following method of attaching the cable:

1. Plug the short connection lead into the socket of the extension cable. (**J1**).
2. Form a loop in the end of the extension cable near to

the socket and secure this in the strain relief feature at the top of the switchbox (**J2, J3**) This will cause the socket to hang in a downward direction.

If the short connection lead is damaged, it must be replaced by the manufacturer, its service agent or similarly qualified persons in order to avoid a hazard.

Grassbox Full Window

- As the grassbox fills up, grass will be visible through the window (**K1**).
- When the window/grassbox is full it is time to empty the grassbox.

How to Mow

How to Mow

1. Start mowing the edge of the lawn nearest to the power point so the cable is laid out on the lawn you have already cut.
2. Mow twice a week during the growing season, your lawn will suffer if more than a third of its length is cut at one time.

Do Not Overload Your Mower

Mowing long thick grass may cause the motor speed to drop, you will hear a change in the motor sound. If the motor speed drops you may overload your lawnmower which may cause damage. When mowing in long thick grass a first cut with the cutting height set higher will help reduce the load. See Cutting Height Adjustment.

Caring for your Lawnmower

Cleaning

• USE GLOVES

• **IMPORTANT:-** It is very important that you keep your lawnmower clean. Grass clippings left in any of the air intakes or under the deck could become a potential fire hazard.

1. Remove grass from under the deck with brush. (**L1**)
2. Using a soft brush - remove grass clippings from all air intakes (**L2**), the discharge chute (**L3**) and the grass box (**L4**).
3. Using a soft brush, remove grass clippings from the vision window (**L5**).
4. Wipe over the surface of your lawnmower with a dry cloth (**L6**).

- **IMPORTANT:-** Never use water for cleaning your lawnmower. Do not clean with chemicals, including petrol, or solvents - some can destroy critical plastic parts.

Storing your Lawnmower:

- Loosen the wing knobs to enable the handles to be folded over the product (**M**).
- Store in a dry place where your lawnmower is protected from damage

At the End of the Mowing Season

1. Replace bolts, nuts or screws, if necessary.
2. Clean your lawnmower thoroughly.
3. Make sure that the electric cable is stored correctly to prevent damage.

Fault Finding Hints

Fails to Operate

1. Is the correct Starting procedure being followed? See 'To Start your Lawnmower'
2. Is the Power Turned On?
3. Check the fuse in the plug, if blown replace.
4. Fuse continues to blow?

Immediately disconnect from the mains electricity supply and consult your GARDENA Service Centre.

Poor Grass Collection

1. Disconnect from the mains electricity supply.
2. Clean the outside of the air intakes, the discharge chute and the underside of the deck.
3. Raise to a higher height of cut. See Cutting Height Adjustment.
4. **If poor collection persists.**
Immediately disconnect from the mains electricity supply and consult your GARDENA Service Centre.

Excessive Vibration

1. Disconnect from the mains electricity supply.
2. Check that the blade is fitted correctly?
3. If the blade is damaged or worn, replace it with a new one.
4. If vibration persists?

Immediately disconnect from the mains electricity supply and consult your GARDENA Service Centre. Lawnmower becomes heavy to push

1. Disconnect from the mains electricity supply.
2. In long grass or uneven ground, the height of cut should be raised to a higher position. See Cutting Height Adjustment.
3. Check that the wheels can rotate freely.
4. If problem persists?
Immediately disconnect from the mains electricity supply and consult your GARDENA Service Centre.

Environmental Information

GARDENA products are manufactured under an Environmental Management System (ISO 14001) using, where practical, components manufactured in the most environmentally responsible manner, according to company procedures, and with the potential for recycling at the end of the products' life.

- Packaging is recyclable and plastic components have been labelled (where practical) for categorised recycling.
- Awareness of the environment must be considered when disposing of 'end-of-life' product.
- If necessary, contact your local authority for disposal information.

The symbol  on the product or on its packaging indicates that this product may not be treated as household waste. Instead it shall be handed over to the applicable collection point for the recycling of electrical and electronic equipment. By ensuring this product is disposed of correctly, you will help prevent potential negative consequences for the environment and human health, which could otherwise be caused by inappropriate waste handling of this product. For more detailed information about recycling of this product, please contact your local council office, your household waste disposal service or the shop where you purchased the product.

Warranty / Service

GARDENA guarantees this product for 2 years (starting from the date of purchase). This guarantee covers all serious defects of the unit that can be proved to be material or manufacturing faults.

Under warranty we will either replace the unit or repair it free of charge if the following conditions apply:

- The unit must have been handled properly and in keeping with the requirements of the operating instructions.
- Neither the purchaser or a non-authorised third party have attempted to repair the unit.

The blade is a wearing part and is not covered by the guarantee.

This manufacturer's guarantee does not affect the user's existing warranty claims against the dealer/ seller.

If a fault occurs with your Powermax 34E Lawnmower, please return the faulty unit together with a copy of the receipt and a description of the fault, with postage paid to one of the GARDENA Service Centres listed on the back of these operating instructions.

EU Certificate of Conformity

The undersigned Husqvarna AB, 561 82, Huskvarna, Sweden, hereby certifies that, when leaving our factory, the units indicated below are in accordance with the harmonised EU guidelines, EU standards of safety and product specific standards. This certificate becomes void if the units are modified without our approval.

Designation.....**Electric Rotary Lawnmower** represented by the code **PM340E, PM = Powermax, 340 =**

Cutting width, **E = Electric Rotary Lawnmower**

Designation of type(s).....**PM340E**

Year of CE marking.....**2011**

EU Directives:

2006/42/EC, 2004/108/EC, 2000/14/EC

Harmonised EN:

EN60335-1, EN60335-2-77, EN50366, EN55014-1, EN61000-3-2, EN61000-3-3

Working area related emission characteristic **Level L_{pA}** according to EN60335-2-77 given in the table.

Vibrations **Value a_{vhw}** according to EN ISO 20643 given in the table.

The Noise Level L_{WA} values according to 2000/14/EC are given in the table.

Conformity Assessment Procedure..... Annex VI

Notified Body..... Intertek, Cleeve Road
Leatherhead, Surrey
KT22 7SB, England

Newton Aycliffe 10/10/2011

Mike Bowden

Global R&D Director - Walk behind

Keeper of technical documentation



Type	PM340E
Width of Cut (cm)	34
Speed of rotation cutting device (rpm)	3800
Power (kW)	1.4
Measured Sound Power L _{WA} (dB(A))	92
Guaranteed Sound Power L _{WA} (dB(A))	96
Level L_{pA} (dB(A))	84.4
Uncertainty K _{pA} (dB(A))	2.5
Value a_{vhw} (m/s²)	1.87
Uncertainty K _{shw} (m/s ²)	1.5
Weight (Kg)	10.9

Deutschland / Germany

GARDENA GmbH
Central Service
Hans-Lorenser-Straße 40
D-89079 Ulm
Produktfragen:
(+49) 731 490-123
Reparaturen:
(+49) 731 490-290
service@gardena.com

Albania

ELG Sh.p.k - Rruga. Siri Kodra
Blloku i Magazinave
Frigoriferi Metalik Blu
4000 Tirana

Argentina

Husqvarna Argentina S.A.
Vera 745
(C1414AOO) Buenos Aires
Phone: (+54) 11 4858-5000
diego.poggi@ar.husqvarna.com

Australia

Husqvarna Australia Pty. Ltd.
Locked Bag 5
Central Coast BC, NSW 2252
Phone: (+61) (0) 2 4352 7400
customer.service
husqvarna.com.au

Austria / Österreich

Husqvarna Austria GmbH
Consumer Products
Industriezeile 36
4010 Linz
Tel.: (+43) 732 77 01 01- 90
consumer.service@husqvarna.at

Belgium

GARDENA Belgium NV/SA
Sterrebeekstraat 163
1930 Zaventem
Phone: (+32) 2 7 20 92 12
Mail: info@gardena.be

Bosnia / Herzegovina

SILK TRADE d.o.o.
Industrijska zona Bukva bb
74260 Tešanj

Brazil

Palash Comércio e
Importação Ltda.
Rua São João do Araguaia, 338
- Jardim Califórnia -
Barueri - SP - Brasil -
CEP 06409-060
Phone: (+55) 11 4198-9777
eduardo@palash.com.br

Bulgaria

Хускварна България ЕООД
Бул. „Андрей Ляпчев“ № 72
1799 София
Тел.: (+359) 02/9753076
www.husqvarna.bg

Canada / USA

GARDENA Canada Ltd.
100 Summerlea Road
Brampton, Ontario L6T 4X3
Phone: (+1) 905 792 93 30
info@gardenacanada.com

Chile

Antonio Martinic y Cia Ltda.
Cassillas 272
Centro de Cassillas
Santiago de Chile
Phone: (+56) 2 20 10 708
garfar_cl@yahoo.com

Costa Rica

Compania Exim
Euroiberoamericana S.A.
Los Colegios, Moravia,
200 metros al Sur del Colegio
Saint Francis - San José
Phone: (+506) 297 68 83
exim_euro@racsa.co.cr

Croatia

SILK ADRIA d.o.o.
Josipa Lončara 3
10090 Zagreb
Phone: (+385) 1 3794 580
silk.adria@zg.t-com.hr

Cyprus

FARMOKIPIKI LTD
P.O. Box 7098
74, Digeni Akrita Ave.
1641 Nicosia
Phone: (+357) 22 75 47 62
condam@spidernet.com.cy

Czech Republic / Slovak Republic

Husqvarna Česko s.r.o.
odštěpný zčvov GARDENA
Tuřanka 1222 /115
627 00 Brno
Phone: (+420) 548 217 777
gardena@gardenabrno.cz

Denmark

GARDENA / Husqvarna
Consumer Outdoor Products
Salgsafdelning Danmark
Box 9003
S-200 39 Malmö
info@gardena.dk

Estonia

Husqvarna Eesti OÜ
Consumer Outdoor Products
Kesk tee 10, Aaviku küla
Rae vald, Harju maakond
75305 Estoni
kontakt.etj@husqvarna.ee

Finland

Oy Husqvarna Ab
Consumer Outdoor Products
Lautatarhankatu 8 B / PL 3
00581 HELSINKI
info@gardena.fi

France

GARDENA France
Immeuble Exposial
9-11 allée des Pierres Mayettes
ZAC des Barbannières, B.P. 99
-F- 92233 GENNEVILLIERS
cedex
Tél. (+33) 01 40 85 30 40
service.consommateurs@
gardena.fr

Great Britain

Husqvarna UK Ltd
Preston Road
Aycliffe Industrial Park
Newton Aycliffe
County Durham, DL5 6UP
info.gardena@husqvarna.co.uk

Greece

HUSQVARNA ΕΛΛΑΣ Α.Ε.Β.Ε.
Υπ /µα Ηφαίστου 33Α
Βι. Πε. Κρωπίτι
194 00 Κρωπί Αττικής
V.A.T. EL094094640
Phone: (+30) 210 66 20 225
info@husqvarna-consumer.gr

Hungary

Husqvarna Magyarország Kft.
Ezred u. 1- 3
1044 Budapest
Phone: (+36) 80 20 40 33
gardena@gardena.hu

Iceland

Ó. Johnson & Kaaber
Tunguhalsi 1, 110 Reykjavik
ooj@ojk.is

Ireland

McLoughlin's RS
Unit 5,
Northern Cross Business Park
North Road, Finglas
Dublin 11

Italy

GARDENA Italia S.p.A.
Via Santa Vecchia 15
23868 VALMADRERA (LC)
Phone: (+39) 0341.203.111
info@gardenaitalia.it

Japan

KAKUICHI Co. Ltd.
Sumitomo Realty &
Development Kojimachi
BLDG., 8F, 5-1 Nibannayo,
Chiyoda-ku, Tokyo 102-0084
Phone: (+81) 33 264 4721
m_ishihara@kaku-ichi.co.jp

Latvia

Husqvarna Latvija
Consumer Outdoor Products
Bakužu iela 6
LV-1024 Riga
info@husqvarna.lv

Lithuania

UAB Husqvarna Lietuva
Consumer Outdoor Products
Ateities pl. 77C
LT-52104 Kaunas
centras@husqvarna.lt

Luxembourg

Magasins Jules Neuberg
39, rue Jacques Stas
Luxembourg-Gasperich 2549
Case Postale No. 12
Luxembourg 2010
Phone: (+352) 40 14 01
api@neuberg.lu

Netherlands

GARDENA Nederland B.V.
Postbus 50176
1305 AD ALMERE
Phone: (+31) 36 521 00 00
info@gardena.nl

Neth. Antilles

Jonka Enterprises N.V.
Sta. Rosa Weg 196
P.O. Box 8200, Curaçao
Phone: (+599) 9 767 66 55
pgm@jonka.com

New Zealand

Husqvarna New Zealand Ltd.
PO Box 76437
Manukau City 2241
Phone: (+64) (0) 9 9202410
support.nz@husqvarna.co.nz

Norway

GARDENA / Husqvarna
Consumer Outdoor Products
Salgskontor Norge
Klevertveien 6
1540 Vestby
info@gardena.no

Poland

Husqvarna Poland Spółka z o.o.
ul. Wysociego 15 b
03-371 Warszawa
Oddział w Szymanowie
Szymanów 9 d
05-532 Baniocha
Phone: (+48) 22 727 56 90
gardena@gardena.pl

Portugal

GARDENA Portugal Lda.
Sintra Business Park
Edifício 1, Fracção 0-G
2710-089 Sintra
Phone: (+351) 21 922 85 30
info@gardena.pt

Romania

Madex International Srl
Soseaua Odaii 117- 123,
RO 013603, Bucuresti, S1
Phone: (+40) 21 352.76.03
madex@ines.ro

Russia

ООО „Хускварна“
141400, Московская обл.,
г. Химки,
улица Ленинградская,
владение 39,
Химки Бизнес Парк,
Здание II, 4 этаж.

Serbia

Domel d.o.o.
Savski nasip 7
11070 Novi Beograd
Phone: (+381) 11 2772 204
miroslav.jejina@domel.co.yu

Singapore

Hy-Ray PRIVATE LIMITED
40 Jalan Pemimpin
#02-08 Tat Ann Building
Singapore 577185
Phone: (+65) 6253 2277
shiyang@hyray.com.sg

Slovenia

GARDENA d.o.o.
Brodilje 15
1236 Trzin
Phone: (+386) 1 580 93 32
servis@gardena.si

South Africa

GARDENA
South Africa (Pty.) Ltd.
P.O. Box 11534
Vorna Valley 1686
Phone: (+27) 11 315 02 23
sales@gardena.co.za

Spain

GARDENA IBÉRICA S.L.U.
C/ Basauri, nº 6
La Florida
28023 Madrid
Phone: (+34) 91 708 05 00
atencioncliente@gardena.es

Sweden

GARDENA / Husqvarna
Consumer Outdoor Products
Försäljningskontor Sverige
Box 9003
200 39 Malmö
info@gardena.se

Switzerland / Schweiz

Husqvarna Schweiz AG
Consumer Products
Industriestrasse 10
5506 Mägenwil
Phone: (+41) (0) 848 800 464
info@gardena.ch

Turkey

GARDENA Dost Diş Ticaret
Müessesilik A.Ş.
Sanayi Çad. Adil Sokak
No: 1/B Kartal
34873 Istanbul
Phone: (+90) 216 38 93 939
info@gardena-dost.com.tr

Ukraine / Україна

ТОВ «Хусварна Україна»
вул. Васильківська, 34,
офіс 204-г
03022, Київ
Тел. (+38) 044 498 39 02
info@gardena.ua

4031-20.960.01 / 1011
Husqvarna AB
561 82
Husqvarna
Sweden