

INSTALLATION INSTRUCTIONS

HEADLIGHT KIT - 539 131805

1. Remove existing colored lens plates and trim rings (rim) from each fender.
2. Locate the accessory wiring harness from parts box. Place the harness between the rear side of the battery, in front of the rear cross member, with the plug in connector to right rear corner of the battery.
3. Connect the male end of the plug on the accessory harness into the female end of the main wiring harness located near the right rear corner of the battery.
4. Route the shorter, right hand light socket through the rubber grommet where the original harness and cable pass through.
5. Route the longer, left side of accessory harness over the top of the vertical chassis side, between the inside edge of left fender, just behind the front inner most fender mounting screw. See illustration.
6. Install the new trim ring (rim) into either fender with the third snap facing inward. The entire ring should be fully seated against the fender.
7. Slide the reflector into the opening in the trim ring (rim). Install the light socket / light bulb assembly into the rear hole of the reflector. Rotate the light socket approximately $\frac{1}{4}$ turn clockwise to secure.

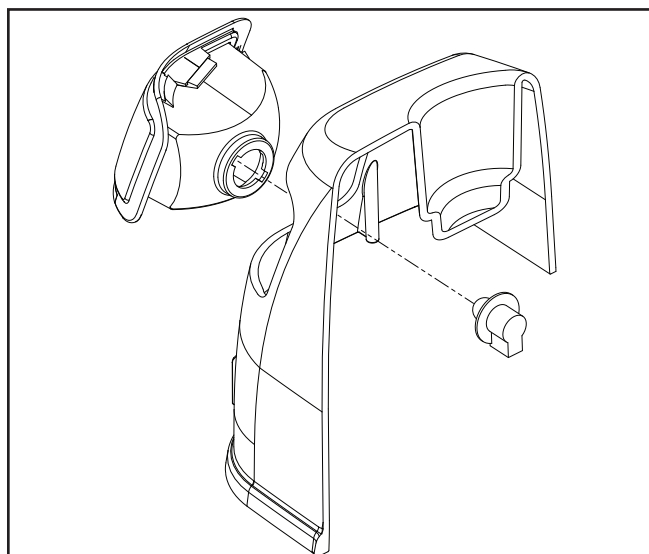
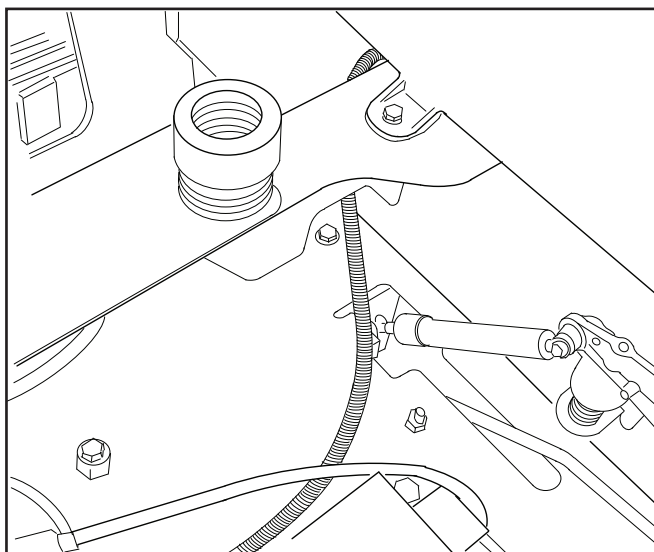

8. Snap the clear lens in place to secure the reflector.
9. Repeat on the other fender.
10. Turn the ignition key to the ACCESSORY position to test the newly installed lights. Check the connector to the accessory harness and the light bulb installation if necessary.
11. Turn the ignition key off when completed.