

Operator's manual
Rider 213 C Rider 216
Rider 216 AWD

Please read the operator's manual carefully and make sure you understand the instructions before using the machine.

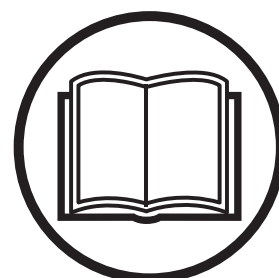

English

KEY TO SYMBOLS

Symbols

These symbols are on the machine and in the instructions.

WARNING! Careless or incorrect use can result in serious or fatal injury to the operator or others.



Please read the operator's manual carefully and make sure you understand the instructions before using the machine.



Always wear:

- Approved hearing protection



This product is in accordance with applicable EC directives.



Neutral



Fast



Slow



Stop the engine.



Battery



Choke.



Fuel



Oil level



Cutting height



Backwards



Forwards



Ignition



Hydrostatic freewheel

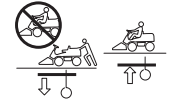

Watch your hands and other body parts so they do not get caught and crushed between the belt and belt pulley.



Warning: rotating parts. Keep hands and feet clear.



Parking brake



Brake



Noise emission to the environment according to the European Community's Directive. The machine's emission is specified in the Technical data chapter and on the label.



Rotary blades Keep hands and feet away from under the hood when the engine is running



Never drive across a slope



Never use the machine if persons, especially children, or animals, are in the vicinity



Never carry passengers on the machine or equipment



Drive very slowly if no cutting unit is fitted



Before and during reversing procedures, look behind you.



KEY TO SYMBOLS

Starting instructions

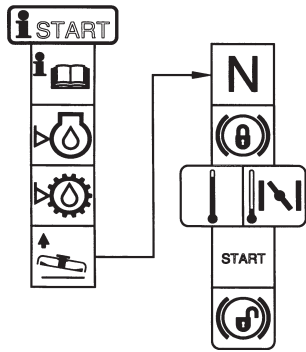

Check the engine's oil level



Check the hydrostat's oil level

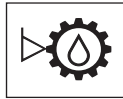

Lift up the cutting unit



Apply and lock the parking brake.



If the engine is cold, use the choke

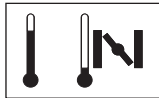

Release the parking brake before driving



Explanation of warning levels

The warnings are graded in three levels.

WARNING!



WARNING! Used if there is a risk of serious injury or death for the operator or damage to the surroundings if the instructions in the manual are not followed.

IMPORTANT!

IMPORTANT! Used if there is a risk of injury to the operator or damage to the surroundings if the instructions in the manual are not followed.

CAUTION!

CAUTION! Used if there is a risk of damage to materials or the machine if the instructions in the manual are not followed.

CONTENTS

Contents

KEY TO SYMBOLS

Symbols	2
Explanation of warning levels	3

CONTENTS

Contents	4
----------------	---

Service journal

Pre-delivery service	5
After the first 8 hours	5

PRESENTATION

Dear Customer,	6
Driving and transport on public roads	6
Towing	6
Use	6
Insure your Rider	6
Good service	7

WHAT IS WHAT?

Location of the controls	8
--------------------------------	---

MACHINE'S SAFETY EQUIPMENT

General	9
Ignition key	9
Safety circuit	9
Speed limiter	9
Parking brake	10
Muffler	10
Protective covers	10

ASSEMBLING AND ADJUSTMENTS

Safety when assembling and settings	11
Cutting unit	11
Removing the cutting unit	11
Seat adjustment	12
Steering wheel height adjustment	12

FUEL HANDLING

General	13
Fuel	13
Fueling	13
Transport and storage	13

OPERATING

General safety precautions	14
Personal protective equipment	14
Work safety	14
Cutting height	15
Throttle and choke controls	15
Lifting lever for the cutting unit	15
Release lever	16
Driving the Rider	16
Driving on slopes	17
Transport and storage	18
Transport with engine off	18
Winter storage	18
Guard	18

STARTING AND STOPPING

Before starting	19
Start the engine	19
Starting the engine with a weak battery	20
Turn off the motor.	20

MAINTENANCE AND SERVICE

Maintenance schedule	21
General	22
Cleaning	22
Removing of the machine hoods	22
Checking and adjusting the steering wires	23
Adjusting the parking brake	23
Adjusting the throttle wire	24
Replacing the air filter	24
Replacement of fuel filter	24
Checking the fuel pump's air filter	24
Checking the tyre pressure	25
Ignition system	25
Fuses	25
Checking the engine's cooling air intake	25
Checking and adjustment of the cutting unit's ground pressure	26
Adjusting the cutting height	26
Checking the cutting unit's parallelism	26
Adjusting the parallelism of the cutting unit	26
Service position for the cutting unit	27
Removing the BioClip plug	28
Checking the blades	28
Replacing the blades	28
Checking the engine's oil level.	29
Replacing the engine oil	29
Changing the oil filter	30
Checking the transmission oil level	30
Lubricating the belt adjuster	30
General lubrication	30
Troubleshooting schedule	
TECHNICAL DATA	
EC Declaration of Conformity	34

Service journal

Pre-delivery service

- 1 Charge the battery for 4 hours at max. 5 amp.
- 2 Fit steering wheel, seat and any optional equipment.
- 3 Check and adjust tyre pressure. (60 kPa, 0.6 bar, 9 psi).
- 4 Adjust cutting unit:

Adjust lift springs (effective weight of cutting unit should be 12-15kg / 26.5-33 lb).

Adjust cutting unit so that rear edge is about 2-4 mm / 1/8" higher than front edge.

Adjust the cutting unit's cutting height setting so that the connection rod is tensed at the lowest cutting height.
- 5 Check that the right amount of oil is in the engine.
- 6 Check that there is oil in the transmission's oil tank.
- 7 Connect battery.
- 8 Fill with fuel and start engine.
- 9 Check that machine does not move in neutral.
- 10 Check:

Forward drive.

Reverse drive.

Operation of blades.

Seat safety switch.

Lif lever safety switch.

The safety switch for the hydrostat pedals.
- 11 Check the engine speed See the Technical data section.

12 Tell customer about:

- Needs and benefits of following the service schedule.
- Servicing and the influence of this journal on the second-hand value of the machine.
- Range of applications for BioClip function.
- Complete proof of sale etc.

Pre-delivery service carried out. No outstanding problems. Certified:

Date, mileage, stamp, signature

After the first 8 hours

- 1 Change engine oil
- 2 Check the oil level in the transmission, top up if necessary. (Only AWD-machines)
- 3 Check front and rear wheel rotation speed according to the service schedule. (Only AWD-machines) See the workshop manual.

PRESENTATION

Dear Customer,

Thank you for choosing a Husqvarna Rider. Husqvarna Riders are built to a unique design with a front-mounted cutting unit and a patented articulated steering. Riders are designed for maximum efficiency even in small or confined areas. The closely grouped controls and pedal-operated hydrostatic transmission also contribute to the performance of this machine.

This operator's manual is a valuable document. By following its instructions (on operation, service, maintenance, etc.) you will significantly extend the life of the machine and even its second-hand value.

When you sell your Rider, make sure you pass on the operator's manual to the new owner.

A service journal accompanies the operator's manual. Ensure that service and repair work is documented. A well-documented service history reduces the costs of seasonal maintenance and influences the second-hand value of the machine. Bring the service journal when bringing the machine to a workshop for a service.

Driving and transport on public roads

Check the relevant road traffic regulations before driving the machine on a public road. If transporting the machine on another vehicle always use approved securing devices and make sure that the machine is securely held.

Towing

When your machine is equipped with a hydrostatic transmission you should only tow the machine over short distances and at a low speed, otherwise there is a risk of damaging the transmission.

The transmission must be disengaged when towing, see instructions under the heading Bypass valves.

Use

This ride-on mower is designed to mow grass on open and level ground surfaces. In addition, there is a number of accessories recommended by the manufacturer that broadens the application area. Please contact your dealer for more information about which accessories are available. The machine may only be used with the equipment recommended by the manufacturer. All other types of use are incorrect. Compliance with and strict adherence to the conditions of operation, service and repair as specified by the manufacturer also constitute essential elements of the intended use.

IMPORTANT! The transmission warranty is only valid if front and rear wheel rotation speed has been checked in accordance with the service schedule. Adjust if necessary according to the table values specified in the workshop manual. Performed by authorized servicing dealer. The system will be damaged if this adjustment is not carried out.

This machine should be operated, serviced and repaired only by persons who are familiar with its particular characteristics and who are acquainted with the relevant safety procedures.

Accident prevention regulations, all other generally recognised regulations on safety and occupational medicine, and all road traffic regulations must be observed at all times.

Any arbitrary modifications carried out to this machine may relieve the manufacturer of liability for any resulting damage or injury.

Insure your Rider

Check the insurance coverage for your new Rider.

- Contact your insurance company.
- You should have fully comprehensive insurance including: third party, fire, damage, theft and liability

PRESENTATION

Good service

Husqvarna products are sold all over the world and ensures that you, the customer, get the best support and service. For example, before this machine was delivered it was inspected and adjusted by your dealer. See the certificate in the Service Journal in this manual.

IMPORTANT! All service intervals are described in the service journal. Ensure service is carried out at the right time.

When you need spare parts or advice on service issues, warranty terms, etc., contact:

Name:	Dealer:
This operator's manual belongs to the machine with the manufacturing number (serial number):	Transmission
PNC:	Engine

On the machine's rating plate you will find the following information:

- The machine's type designation.
- The manufacturer's type number.
- The machine's serial number.

State the type designation and serial number when ordering spare parts.

WHAT IS WHAT?

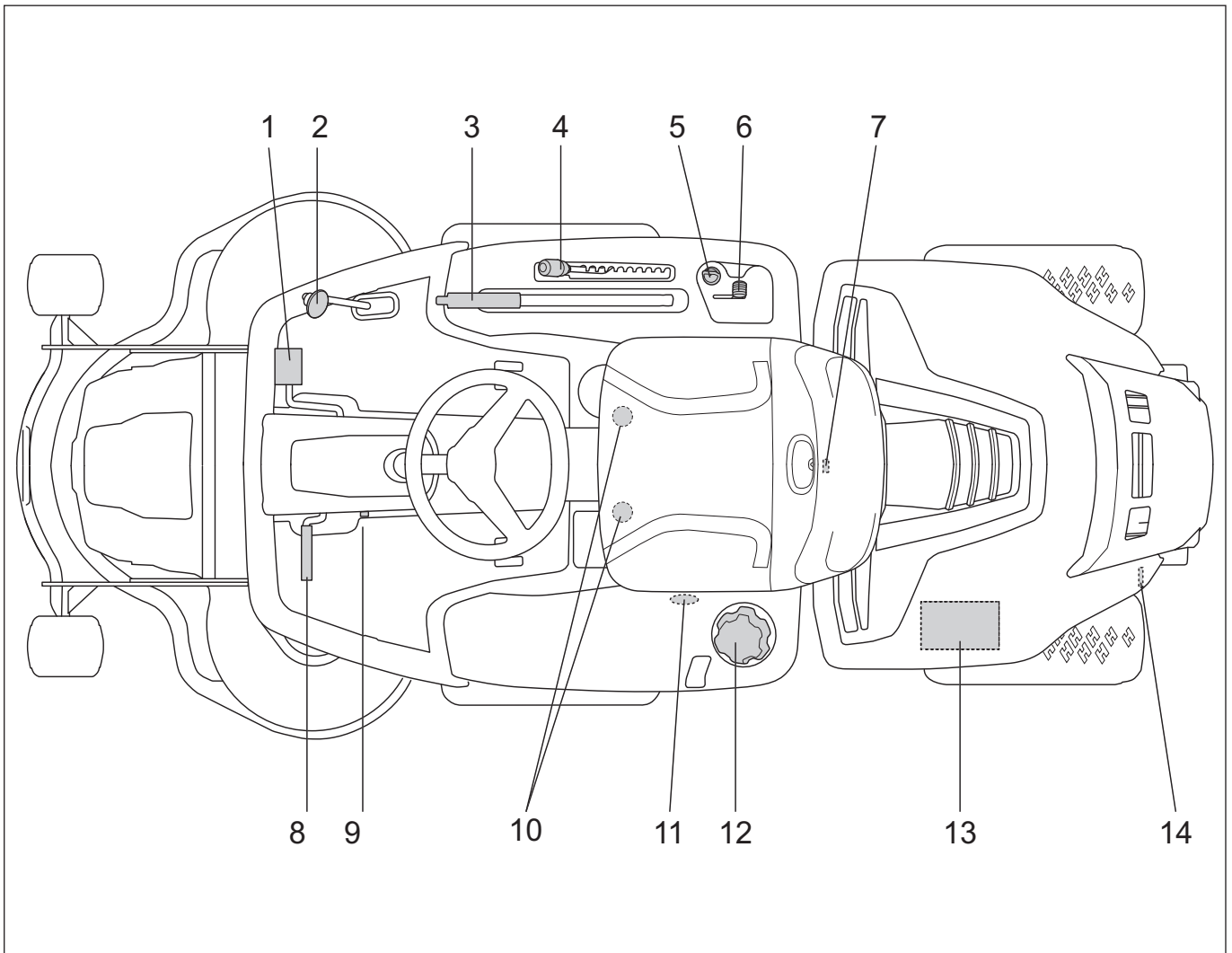

Location of the controls

- | | |
|--------------------------------------|--|
| 1 Speed limiter for driving forward | 8 Parking brake |
| 2 Speed limiter for reversing | 9 Lock button for parking brake |
| 3 Lifting lever for the cutting unit | 10 Seat adjustment. |
| 4 Cutting height adjustment lever | 11 Lever to disengage the driving front axle, 216 AWD |
| 5 Ignition lock | 12 Fuel cap |
| 6 Throttle control/choke control | 13 Battery |
| 7 Cover lock | 14 Lever to disengage the drive, 213 C and 216 Lever to disengage the driving rear axle, 216 AWD |

MACHINE'S SAFETY EQUIPMENT

General



WARNING! Never use a machine that has faulty safety equipment!

If your machine fails any checks contact your service agent to get it repaired.

Ignition key

The ignition key is used to turn the engine on and off together with all electrical functions.

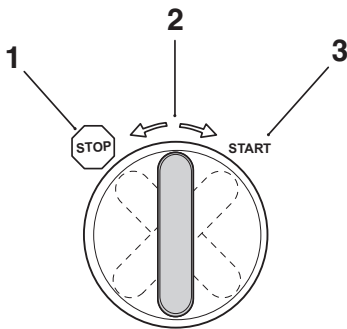

- 1 STOP - the machine is powered down
- 2 - Neutral
- 3 START - spring-back ignition position

Ignition key check

- Check the ignition key by starting and stopping the engine. See instructions under the heading Starting and stopping.
- The engine should start when the ignition key is turned to START (3).
- The engine should stop immediately when the ignition key is turned to STOP (1).

Safety circuit

The machine has a safety circuit that triggers whenever the driver gets off the seat while the blades are engaged. The safety circuit is also tripped when the parking brake has not been applied and the driver rises from the seat.

Drive to the blades is stopped when the safety circuit is tripped. There is a short delay to prevent stopping if the driver bounces on the seat.

The engine can only be started when:

- The cutting deck is raised and the parking brake is applied.

The engine should stop when:

- The cutting deck is lowered and the driver rises from the seat.
- The cutting deck is in its raised position, the parking brake is not applied and the driver rises from the seat.

Safety circuit check

- Check daily to ensure that the safety system works by attempting to start the engine when one of the conditions above is not met. Change the conditions and try again.

Speed limiter

The speed of the machine is steplessly regulated with two pedals. Pedal (1) is used to drive forwards, and pedal (2) to drive backwards.

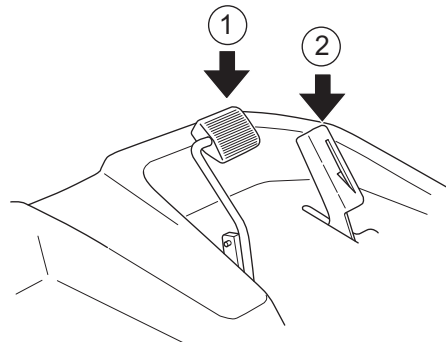

The machine is braked when the forward pedal is released. The reverse pedal can also be used if additional braking power is required.

Accelerator check

- Ensure the forward and reverse pedals can be operated freely.
- Ensure the machine brakes when the forward pedal is released.

MACHINE'S SAFETY EQUIPMENT

Parking brake

The parking brake is applied as follows:

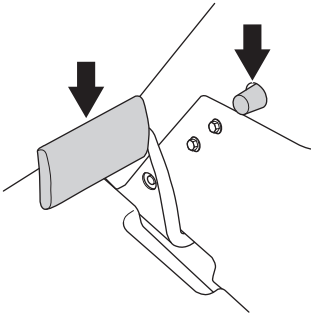

- 1 Press down the parking brake pedal.
- 2 Press in the lock button on the steering column.
- 3 Release the parking brake pedal while keeping the button pressed in.

The parking brake lock disengages automatically when the brake pedal is pressed.

Checking the parking brake

Make sure the parking brake is properly adjusted by placing the machine on a slope.

- Apply the parking brake.
- When the machine does not stand still, the parking brake should be adjusted.

Muffler

The muffler is designed to keep noise levels to a minimum and to direct exhaust fumes away from the user.



WARNING! Never use a machine without a muffler, or with a faulty muffler. A damaged muffler may substantially increase the noise level and the fire hazard. Keep fire fighting equipment handy.



WARNING! The inside of the muffler contain chemicals that may be carcinogenic. Avoid contact with these elements in the event of a damaged muffler.

The muffler gets very hot during and after use as well as when idling. Be aware of the fire hazard, especially when working near flammable substances and/or vapours.

Inspecting the muffler

- Check that the muffler is securely attached and not damaged.

Protective covers



WARNING! Always check that the protection covers are correctly fitted before starting the machine.

Protective covers on the machine protects the user from the cooling fan, belt drives and hot surfaces.

Checking the protective covers

- Check the protective covers for cracks or other damages. Replace damaged covers.

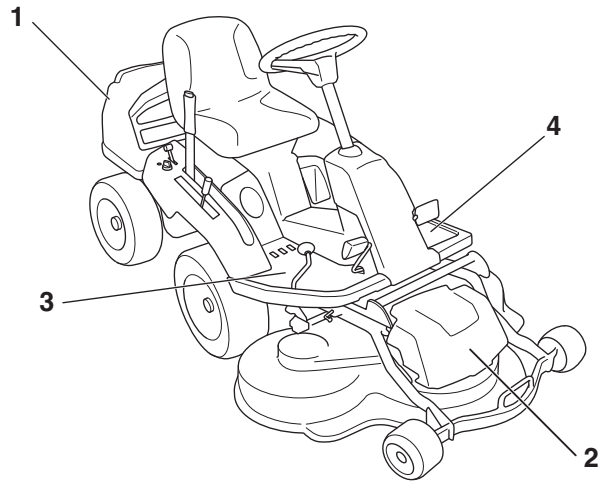

- 1 Engine cover
- 2 Front cover
- 3 Right-hand fender
- 4 Left-hand fender

ASSEMBLING AND ADJUSTMENTS

Safety when assembling and settings



WARNING! The engine emits carbon monoxide, which is a colourless, poisonous gas. Do not use the machine in enclosed spaces.

- Never leave the machine unsupervised with the motor running.
- Never allow children or other persons not trained in the use of the machine to use or service it. Local laws may regulate the age of the user.
- Electrical shocks can cause injuries. Do not touch cables when the engine is running. Do not test the ignition system with your fingers.



WARNING! The engine and the exhaust system become very hot during operation. Risk of burn injuries if touched.

- The machine is tested and approved only with the equipment originally provided or recommended by the manufacturer.

Cutting unit

Rider 213 C is equipped with a 3-blade Combi-deck.

- Combi 94

Rider 216 and 216 AWD can be equipped with two different cutting units.

- Combi 94
- Combi 103

The Combi-unit, equipped with a BioClip-plug, finely chops the cuttings to fertiliser. Without the BioClip-plug the unit works in the same way as a rear ejection unit.

Removing the cutting unit



WARNING! Wear protective glasses when dismantling the cutting unit. The spring which tensions up the belt may break and cause personal injury.

- 1 Place the machine on a flat surface and apply the parking brake. Set the cutting height control in the lowest position and lift up the cutting unit.

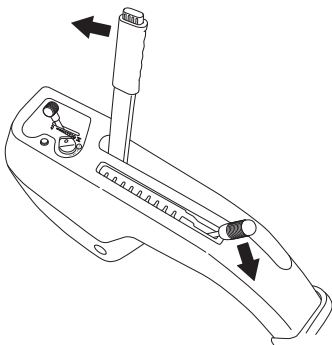

- 2 Release the clip on the front hood and lift off the fender.

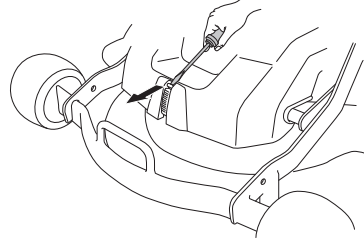

- 3 Loosen on the cutting height stay and place in the holder.

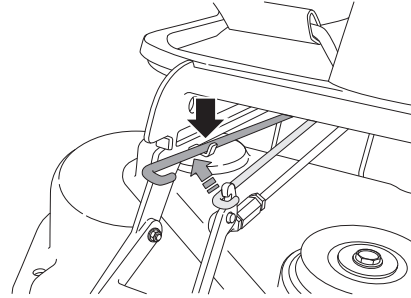

- 4 Loosen the spring on the drive belt's belt idler by pulling the spring eye.

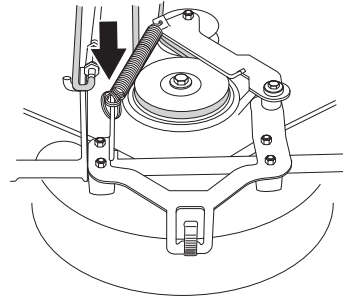

- 5 Place the spring eye in the holder.

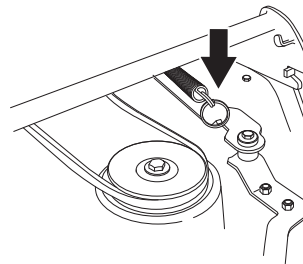

- 6 Lift off the drive belt and hang on the load-relieving hook.

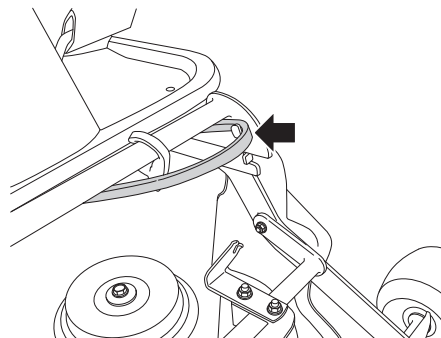

ASSEMBLING AND ADJUSTMENTS

- 7 To secure the cutting deck from spring back, place a wooden block between equipment frame and chassis.

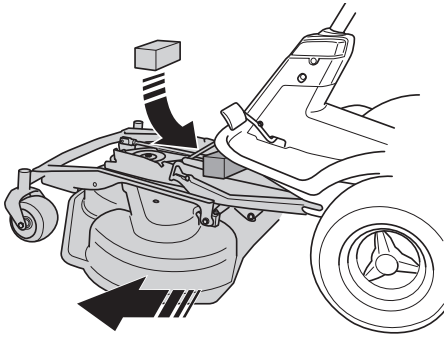

WARNING! Observe caution to avoid trapping your hand.

- 8 Remove the two screws on the equipment frame.

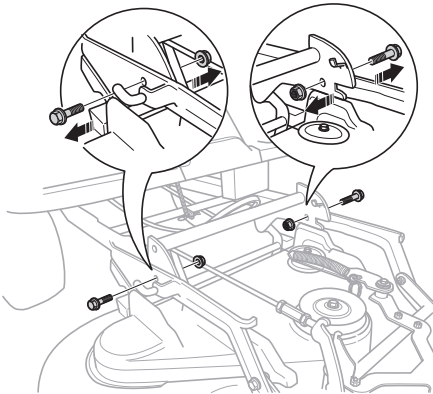

- 9 Pull out the cutting unit.

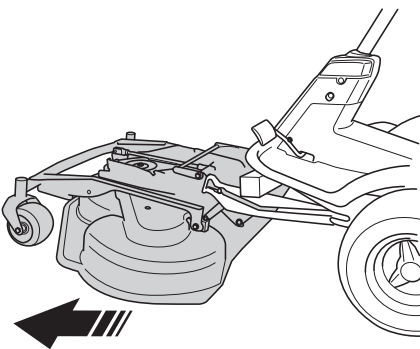

- 10 Remove the wooden block.

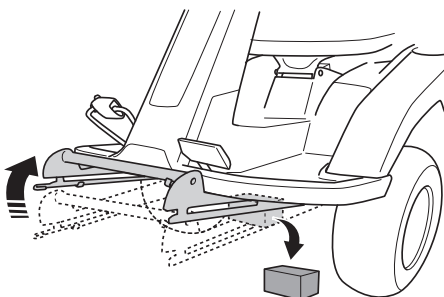

Assemble the parts in the reverse order.

Seat adjustment



WARNING! Take care so that hands are not trapped or injured by the locking hooks when the seat is folded back.



WARNING! Do not adjust seat settings while driving. Risk of unsafe manoeuvring.

The seat has a jointed attachment on the front edge and can be tipped forward.

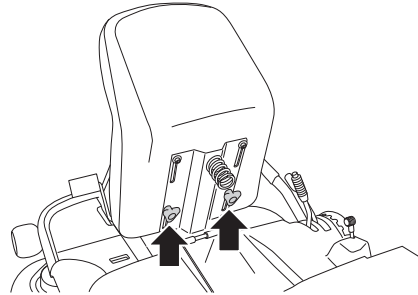

The seat can also be adjusted lengthways.

Loosen the handles under the seat and adjust it forwards or backwards to the desired position.

Steering wheel height adjustment

- 1 Remove the cover.

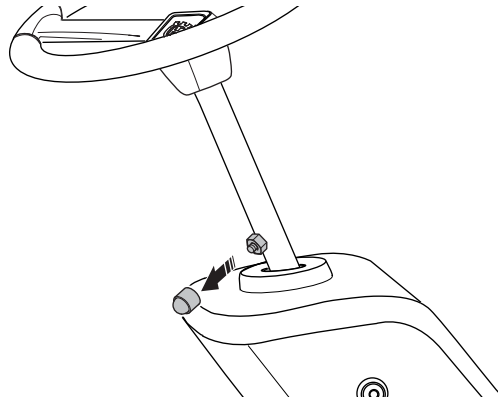

- 2 Loosen the nut.



- 3 Loosening the locking screw with a 4 mm hex key.

- 4 Adjust the height. The height can be adjusted approx. 40 mm.

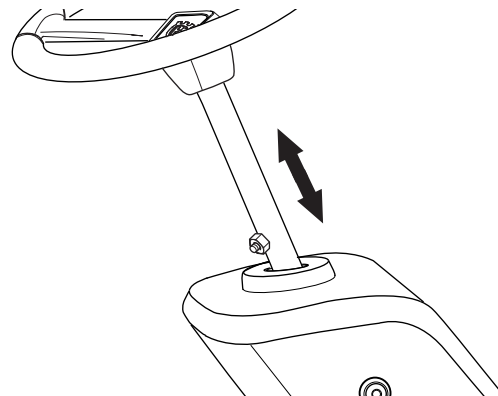

- 5 Tighten the lock screw and nut. Refit the cover.

FUEL HANDLING

General



WARNING! Running an engine in a confined or badly ventilated area can result in death due to asphyxiation or carbon monoxide poisoning. Do not use the machine in enclosed spaces.

Fuel and fuel fumes are flammable and can cause serious injury when inhaled or allowed to come in contact with the skin. For this reason observe caution when handling fuel and make sure there is adequate ventilation.

The exhaust fumes from the engine are hot and may contain sparks which can start a fire. Never start the machine indoors or near combustible material!

Do not smoke and do not place any hot objects in the vicinity of fuel.

Fuel

- The engine runs on unleaded petrol with a minimum octane rating of 85 (not mixed with oil). We recommend the use of biodegradable alkylate petrol. Do not use petrol that contains methanol.

Fueling



WARNING! Petrol and petrol fumes are poisonous and extremely flammable. Exercise care and refuel outdoors.

Clean the area around the fuel cap.

Tighten the fuel cap carefully after refuelling. If the cap is not properly tightened the cap might vibrate lose and fuel may escape from the fuel tank creating a fire hazard.

Move the machine at least 3 m from the refuelling point before starting it.

- Do not fill the tank completely, leave an expansion area of at least 2.5 cm (1").
- Allow the engine to cool before refuelling.
- Check the fuel level before each use and leave space for the fuel to expand, because the heat from the engine and the sun may otherwise cause the fuel to expand and overflow.
- Clean the area around the fuel cap. Contamination in the tank can cause operating problems.
- When refuelling, open the fuel cap slowly so that any excess pressure is released gently.
- Wipe up any spillage. Materials contaminated by fuel must be moved to a safe location.
- Handle oil, oil filters, fuel and the battery carefully, of environmental considerations. Follow the local recycling requirements.

Never start the machine:

- If you have spilled fuel on yourself or your clothes, change your clothes. Wash any part of your body that has come in contact with fuel. Use soap and water.
- If you have spilled fuel or engine oil on the machine. Wipe off the spill and allow the remaining fuel to evaporate.
- If the machine is leaking fuel. Check regularly for leaks from the fuel cap and fuel lines.
- Unless the fuel cap is securely tightened after refueling.

Transport and storage

- Store and transport the machine and fuel so that there is no risk of any leakage or fumes coming into contact with sparks or open flames, for example, from electrical machinery, electric motors, electrical relays/switches or boilers.
- When storing and transporting fuel always use approved containers intended for this purpose.
- Store the machine and fuel in such a way that there is no risk that leaking fuel or fumes can cause any damage.

Fuel which is left to stand for long periods (30 days or more) can leave sticky deposits and interfere with the engine function. Fuel stabiliser is an acceptable alternative to avoid tacky deposits during storage.

- Add stabiliser to the fuel in the tank or the storage container.
- Always use the mixing ratios indicated by the manufacturer.
- Run the engine for at least 10 minutes after adding the stabiliser so that it will reach the carburettor.

If alkylate petrol (Aspen) is used stabiliser is not necessary since this fuel is stable. However, one should avoid changing from standard to alkylate petrol since sensitive rubber parts can harden. Do not empty the fuel tank and carburettor if stabiliser has been added.



WARNING! Never store a machine with fuel in the tank indoors or in poorly ventilated spaces where fuel vapour can come in contact with open flames, sparks, or a pilot light such as in a boiler, hot water tank, clothes drier, etc.

Exercise caution when handling fuel. It is highly inflammable, and careless use can cause serious injury and damage to property.

OPERATING

General safety precautions

Read all the instructions in this operator's manual and on the machine before you start it. Ensure you understand them and then observe them.

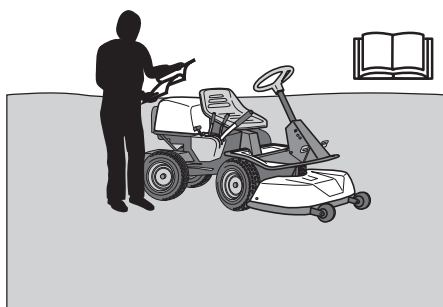

WARNING! This machine produces an electromagnetic field during operation. This field may under some circumstances interfere with active or passive medical implants. To reduce the risk of serious or fatal injury, we recommend persons with medical implants to consult their physician and the medical implant manufacturer before operating this machine.



WARNING! This machine can sever hands and feet as well as throw objects. Failure to observe the safety instructions can result in serious injuries.

- Learn how to use the machine and its controls safely and learn to how to stop quickly. Also learn to recognize the safety decals.
- Only allow the machine to be used by adults who are familiar with its use. Never allow children to operate the machine.
- Never carry passengers. The machine is only intended to be used by one person.



- Serious accidents may occur if you fail to be on your guard for children in the vicinity of the machine. Children are often attracted to the machine and mowing. Never assume that children will remain where you last saw them.
- Keep an eye out and shut off the machine if children enter the work area.
- Remember that the driver is responsible for dangers or accidents.

Personal protective equipment



WARNING! You must use approved personal protective equipment whenever you use the machine. Personal protective equipment cannot eliminate the risk of injury but it will reduce the degree of injury if an accident does happen. Ask your dealer for help in choosing the right equipment.

- Use hearing protection to minimise the risk of hearing impairment.

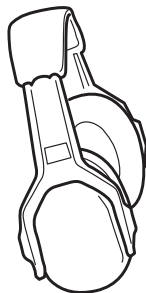

- Never wear loose-fitting clothing, jewellery or similar that can get caught in moving parts.
- Never use the machine when barefoot. Always wear protective shoes or protective boots, preferably with steel toes.



Other protective equipment

- Make sure that you have first aid equipment close at hand when using the machine.
- Fire Extinguisher

Work safety

- Make sure nobody else is in the vicinity of the machine when you start the engine, engage the drive or drive off.
- Clear the area of objects such as stones, toys, wires, etc. that may become caught in the blades and be thrown out.



- Look out for the ejector and do not direct it towards anyone.
- Always look downwards and backwards before and while reversing. Keep watch for both large and small obstacles.

OPERATING

- Slow before cornering.
- Switch off the blades when you are not mowing.
- Take care when rounding a fixed object, so that the blades do not hit it. Never run the machine over foreign objects.
- Only use the machine in daylight or in other well-lit conditions. Keep the machine at a safe distance from holes or other irregularities in the ground. Pay attention to other possible risks.
- Never use the machine if you are tired, if you have consumed alcohol, if you are taking other drugs or medication that can affect your vision, judgement or co-ordination.
- Never use the machine in bad weather, for instance in fog, in rain, damp or in wet locations, strong winds, intense cold, risk of lightning, etc.
- Keep an eye on the traffic when working close to a road or when crossing it.

Cutting height

The cutting height can be adjusted to 10 different positions with the cutting height lever. Select the required cutting height (1-10) with the cutting height lever.

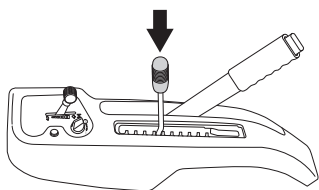

See directions in 'Setting the cutting height'.

Throttle and choke controls

The throttle control regulates the engine speed, and thereby also the rotation speed of the blades.

The control is also used to activate the choke.

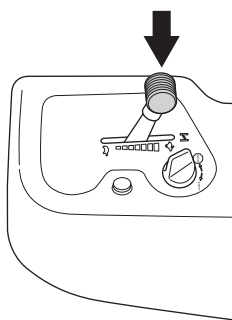

When the choke is engaged a richer fuel and air mixture is fed to the engine, which facilitates starting in the cold.

Lifting lever for the cutting unit

The lift lever is used to set the cutting unit in transport or mowing position.

The lever can also be used to temporarily regulate the cutting height, e.g. for a small mound in the lawn.

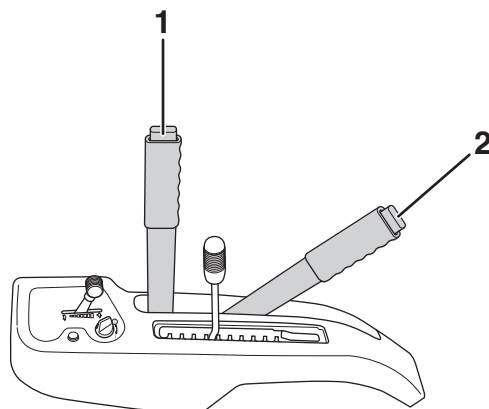

1 Transport position

2 Mowing Position

Transport position

If the lever is pulled backwards the unit is raised and the blades automatically stop rotating (transport position).

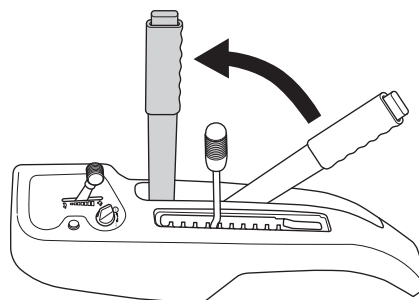

Mowing Position

If the lock button is pressed in and the lever is moved forwards the unit will be lowered and the blades will automatically start to rotate (mowing position).

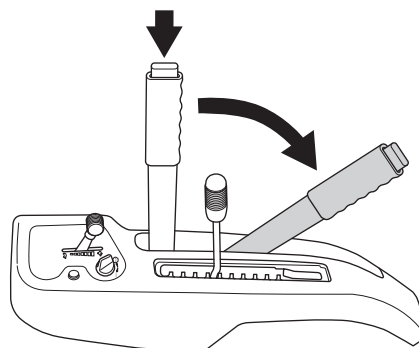

OPERATING

Release lever

Rider 213 C, Rider 216

The release control must be pulled out in order for the machine to be moved when the engine is shutoff.

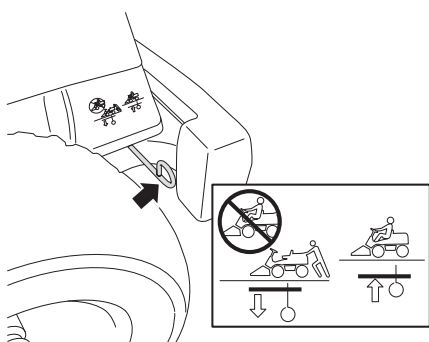

- Pull the controls to the end positions, do not use an intermediate position.
- Pull out the control to disengage the drive system.
- Push in the control to engage to the drive system.

Rider 216 AWD

Rider 216 AWD has one control for the front axle and one control for the rear axle.

Should you attempt to drive the machine with the clutch controls pulled out it will not move. The drive on the axle is disengaged when one of the controls is pulled out.

CAUTION! Always drive the machine with both clutch controls pressed in.

Clutch control, rear axle

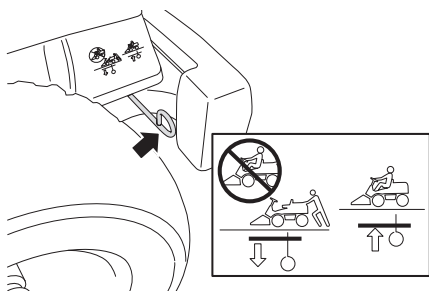

- Control drawn out, drive system disengaged.
- Control depressed, drive system engaged.

Clutch control, front axle

The control is positioned on the inside of the left front wheel.

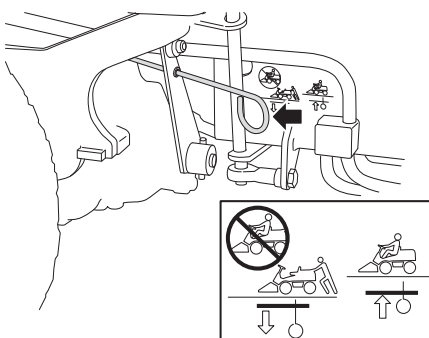

- Control drawn out, drive system disengaged.
- Control depressed, drive system engaged.

Driving the Rider



WARNING! Make sure that branches do not obstruct the pedals when mowing under bushes.

Localise and mark stones and other fixed objects to avoid collision.

- 1 Release the parking brake by first pressing down the parking brake pedal and then releasing it.

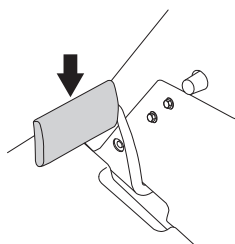

- 2 Carefully press down one of the pedals until the required speed is obtained. Pedal (1) is used to drive forwards, and pedal (2) to drive backwards.

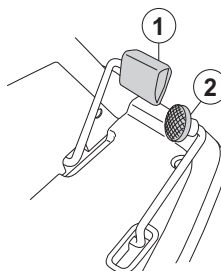

- 3 Select the required cutting height (1-10) with the cutting height lever.

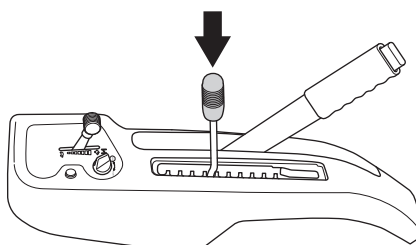

- 4 Lower the cutting unit.

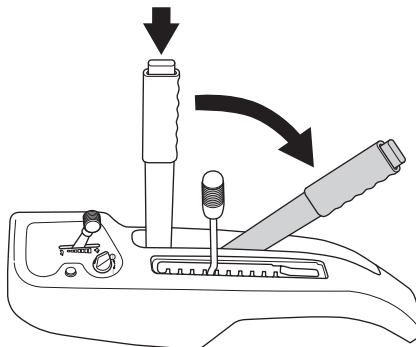

OPERATING

Driving on slopes

Driving on slopes is one of the operations where the risk of the driver losing control of the machine or of it overturning is the greatest; this can result in serious injury or death. All slopes demand extra care. If you cannot reverse up a slope or if you feel unsure, do not mow it.



WARNING! Do not drive down slopes with the cutting deck raised.

This is what you do

- Remove obstacles such as stones, branches, etc.
- Mow upwards and downwards, not sideways.

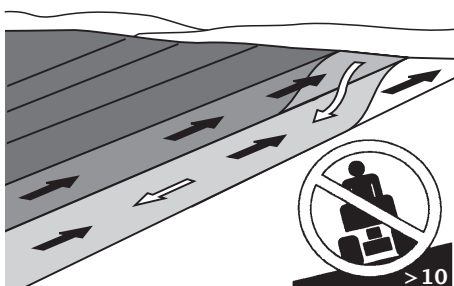

- Do not use the machine on ground that slopes more than 10°.
- Take extra care if any attachments are fitted that can change the stability of the machine.
- Avoid starting or stopping on a slope. If the tyres start to slip, stop the blades and drive slowly down the slope.
- Always drive smoothly and slowly on slopes.
- Do not make any sudden changes in speed or direction.
- Avoid unnecessary turns on slopes, if necessary, turn slowly and gradually downwards if possible.

- Watch out for and avoid driving over furrows, holes and bumps. It is easier for the machine to overturn on uneven ground. Tall grass can hide obstacles.



- Do not mow too close to edges, ditches or banks. The machine can suddenly overturn if one wheel comes over the edge of a steep slope or a ditch, or if an edge gives way.
- Do not mow wet grass. It is slippery, and tyres can lose their grip so that the machine skids.
- Do not try to stabilize the machine by putting your foot on the ground.
- When mowing, keep away from bushes and other objects.
- When cleaning the chassis the machine must never be driven close to an edge or ditch.
- Follow the manufacturer's recommendations regarding wheel weights or counterbalance weights to increase machine stability.

IMPORTANT! Wheel weights fitted on the rear wheels are recommended when driving on slopes for safer steering and improved manoeuvrability. Consult your dealer concerning the use of wheel weights if you are unsure.

Wheel weights can not be used on AWD-machines. Use counterweights.

OPERATING

Transport and storage

IMPORTANT! The parking brake is not sufficient to lock the machine during transport. Ensure you secure the machine firmly to the transporting vehicle.

- The machine is heavy and can cause serious crush injuries.
- Take extra care when loading it onto or off a vehicle or trailer.
- Use an approved trailer to transport the machine.
- To secure the machine on the trailer, two approved tension belts and four wedge shaped wheel blocks should be used.
 - Engage the parking brake and tie the tension belts around stable parts on the machine, e.g. frame or rear wagon.
 - Secure the machine by tensioning the belts towards the back and the front of the trailer respectively.
 - Place the wheel blocks in front of and behind the rear wheels.
- Check and observe local road traffic regulations before transporting or driving the machine on roads.

Transport with engine off

The release control must be pulled out in order for the machine to be moved when the engine is shutoff.

See instructions under the heading "Release lever".

Winter storage

At the end of the season, or if the machine is going to stand idle for more than 30 days, it should immediately be made ready for storage.

For transport and storage of fuel, see the section "Fuel handling".

To prepare the machine for storage follow these instructions:

- 1 Carefully clean the machine, especially under the cutting unit. Touch-up paint damage to avoid rust.
- 2 Inspect the machine for worn or damaged parts and tighten loose screws and nuts.
- 3 Change the engine oil, and take care of the waste oil.
- 4 Empty the fuel tank. Start the engine and run it until the carburettor is emptied of fuel.
- 5 Remove the plugs and pour about a tablespoon of engine oil into each cylinder. Pull round the engine to distribute the oil and screw the plugs back on.
- 6 Grease all grease nipples, joints and axles.
- 7 Remove the battery. Clean it, charge it, and store it in a cool place.
- 8 Store the machine in a clean and dry place and cover it over for extra protection.

Guard

There is a cover to protect your machine during storage or transport. Contact your dealer for a demonstration

STARTING AND STOPPING

Before starting

- Read the safety instructions and information concerning the placement of controls and functions before starting.
- Perform daily maintenance before starting as set out in the Maintenance schedule.
- Adjust the seat to the required position.

IMPORTANT!

The air intake grille in the engine cover behind the driver's seat must not be blocked by, for example, clothing, leaves, grass or dirt.

Impaired cooling of the engine. Risk of major engine damage.

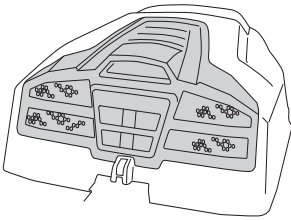

WARNING! Do not modify the machine's safety devices and check regularly that they are working properly.

- Localise and mark stones and other fixed objects to avoid collision.
- Avoid mowing a wet lawn. The mowing results will then be poorer.
- Start with a high cutting height and reduce down until the required mowing results are obtained.
- The mowing result will be best with the highest permitted engine speed, see technical data, (the blades rotate rapidly) and low speed (the Mower moves slowly). If the grass is not too high and thick, the driving speed can be increased without noticeably depreciating the mowing result.
- The best lawns are achieved if the grass is cut often. Mowing becomes more uniform and the grass cuttings become more evenly distributed over the surface. The total time consumption is not greater since it is possible to select a higher driving speed without inferior mowing results.
- When the BioClip function is used, it is very important that the mowing interval is not too long.
- Hose down the cutting unit with water underneath each time it is used, avoid using a high pressure washer. The cutting unit should then be put in the service position. Put the unit in the service position, see Service position for the cutting unit.

Start the engine

- 1 Make sure that the clutch control is depressed. (Run position) Rider 216 AWD has one control for the front axle and one control for the rear axle.

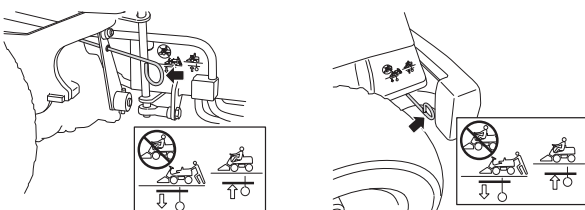

- 2 Lift up the cutting unit by pulling the lever backwards to its locked position.

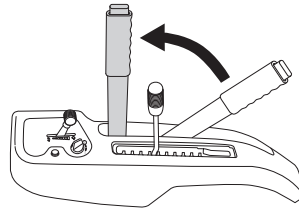

- 3 Activate the parking brake. This is done as follows:

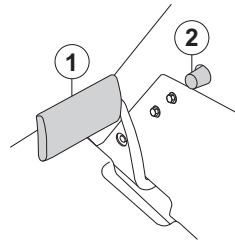

- Press down the parking brake pedal (1).
- Press in the lock button (2) on the steering column.
- Release the brake pedal while holding the button pressed.

The parking brake lock disengages automatically when the brake pedal is pressed.

The engine can not be started if the parking brake is not pressed down.

With a cold engine:

- 4 Move the throttle to position 3 (choke position). In this position the engine is fed with a richer mixture, which means the engine is easier to start.

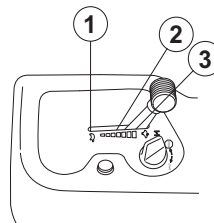

With a warm engine:

- 5 Move the throttle in between positions 1 and 2.

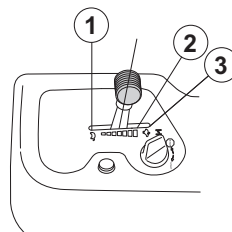

STARTING AND STOPPING

- 6 Turn the ignition key to the start position.

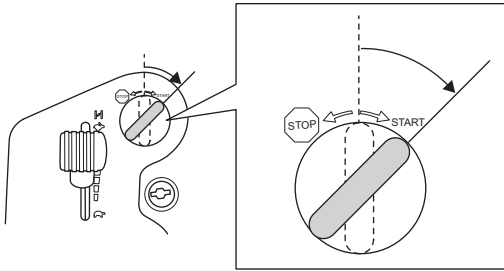

CAUTION!

If the engine does not start, wait about 15 seconds before trying again. If the engine does not start wait about 1 minute before trying again.

- 7 When the engine starts release the ignition key immediately back to neutral position.

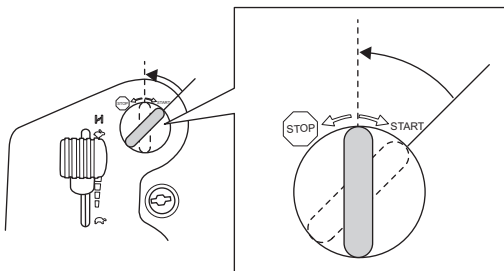

- 8 Move the throttle backwards gradually once the engine has started. Let the engine run at moderate speed or half throttle for 3-5 minutes before subjecting it to heavy load.
- 9 Set the required engine speed with the throttle control.



WARNING! Never run the engine indoors, in enclosed or poorly ventilated areas. The exhaust fumes contain toxic carbon monoxide.

Starting the engine with a weak battery



WARNING! Lead-acid batteries produce explosive gases. Avoid sparks, open flames and smoking close to batteries. Always wear protective glasses in the vicinity of batteries.

If the battery is too weak to start the engine, it should be recharged.

When jump leads are used for emergency starting, follow the procedure below:



IMPORTANT! Your Rider is equipped with a 12-volt system with negative earth. The other vehicle must also have a 12-volt system with negative earth. Do not use your Rider battery to start other vehicles.

Connecting the jump leads

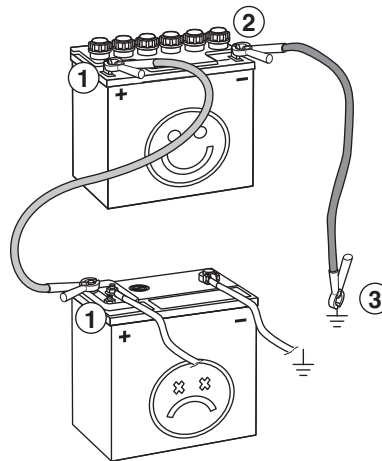

WARNING! Never connect the negative terminal of the fully-charged battery to, or in the vicinity of, the negative terminal of the discharged battery. Hydrogen gas may be present with risk of explosion.

- 1 Connect each end of the red cable to the POSITIVE pole (+) on each battery, exercise care not to short circuit any of the ends against the chassis.
- 2 Connect one end of the black cable to the NEGATIVE pole (-) on the fully charged battery.
- 3 Connect the other end of the black cable to a good CHASSIS EARTH, away from the fuel tank and the battery.

Remove the cables in the reverse order

- The BLACK cable is removed from the chassis and then the fully charged battery.
- Finally the RED cable from both batteries.



IMPORTANT! Never use a boost charger/start booster. Use only conventional battery chargers. Always disconnect the charger before starting the engine. So called boost chargers/start boosters must never be used. These will often increase the voltage (instead of the current) to generate the power needed to start the engine. This increase in voltage will damage the electrical system.

Turn off the motor.

- 1 Lift up the cutting unit by pulling the lever backwards to its locked position.

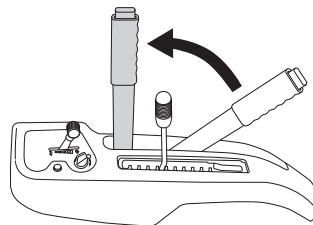

- 2 Pull back the throttle and turn the ignition key to the "STOP" position.

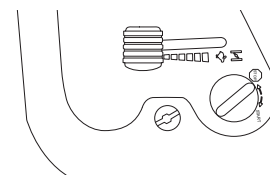

- 3 When the Rider is at a standstill, press down the parking brake and push in the locking button.

MAINTENANCE AND SERVICE

Maintenance schedule



WARNING! No service procedures must be conducted on the engine or cutting unit unless:

The engine is switched off.

The ignition key is removed.

The ignition cable has been removed from the spark plug.

The parking brake is applied.

The cutting unit is disengaged.

The following is a list of the maintenance which should be conducted on the machine. For those points not described in this manual, visit an authorised service workshop.

Maintenance	Daily maintenance before starting	At least once a year	Maintenance interval in hours			
			25	50	100	200
Cleaning	X					
Clean the cutting deck, under the belt covers and under the cutting deck.			X			
Clean around the silencer	O					
Clean the engine cooling air intake and transmission air intake ^{2, 6)}				O	O	O
Check/adjust front and rear wheel rotation speed ^{6,8)}			O		O	O
Checking the engine's cooling air intake	X					
Check the engine's oil level	X					
Check the fuel pump air filter	X					
Check the steering wires	X					
Check the battery	X					
Check the safety system	X					
Check nuts and screws	O					
Check for fuel and oil leakage.	O					
Check the cutters in the cutting deck			X			
Checking the tyre pressure			X	X	X	X
Check/adjust parking brake	X			X	X	X
Check the V-belts			O	O	O	O
Check the oil level in the transmission, top up if necessary.	O		O	O		
Checking and adjusting of throttle wire				X	X	X
Check the fuel hose. Replace if necessary ⁶⁾		O				
Change the oil in the gearbox ⁷⁾		O		O		O
Change the engine oil ^{3, 4)}					X	X
Replace the air filter's prefilter and paper filter ^{2, 5)}		X	X	X	X	X
Replace the fuel filter.					X	X
Change the oil filter					X	X
Change filter in the transmission ⁷⁾				O		O
Replace the spark plug.					X	X
Lubricate the belt adjuster ¹⁾			X	X	X	X
Lubricate joints and shafts ¹⁾			X	X	X	X

¹⁾If the machine is used daily it should be lubricated twice a week. ²⁾ Maintenance and replacement are required more often in dusty conditions. ³⁾First change after 8 hours. When operating with a heavy load or at high ambient temperatures, replace every 50 hours. ⁴⁾Replace the oil filter every 200 hours. ⁵⁾Replace the paper filter annually or every 200 hours. ⁶⁾Conducted by authorised service workshop. ⁷⁾ After the first 50 h then every 200 h, or at least once a year. ⁸⁾Only AWD-machines

X = Described in this operator's manual

O = Not described in this operator's manual

IMPORTANT! When the machine is in operation the hoses are under high pressure. Do not try to connect or disconnect the hoses when the hydraulic system is operational. This can result in serious personal injuries.

MAINTENANCE AND SERVICE

General

Service

Low season is the most suitable time to perform a service or overhaul of the machine in order to ensure high function safety during high season.

When ordering spare parts state your machine's purchase year, model, type, and serial number.

Always use genuine parts.

An annual check-up by an authorised servicing dealer is a good way to ensure that your ride-on mower performs at its best the following season. Ensure that all service steps are documented.

Cleaning

Clean the machine directly after use. It is much easier to wash off grass cuttings before they dry.



IMPORTANT! Always park the machine on a level surface with the engine OFF before performing any maintenance.

Oily dirt can be removed using a cold degreasing agent. Spray on a thin layer.

Rinse at normal water pressure.

Do not direct the jet towards electrical components or bearings.

Do not rinse hot surfaces such as the engine and exhaust system.

Put the cutting unit in the service position first. Hose down the cutting unit with water underneath each time it is used, avoid using a high pressure washer.

It is recommended that you start the engine and run the mower for a short period after cleaning, so that any remaining water is blown off.

Lubricate the machine if necessary after cleaning. Carry out extra lubrication when the bearings have been exposed to a degreaser or a water jet.

IMPORTANT! Avoid using a high pressure washer or a steam cleaner.

There is a major risk of water penetrating into bearings and electrical connections. Corrosion attack can result, which will lead to running problems. Cleaning additives generally aggravate the damage.

Removing of the machine hoods

Engine cover

The engine becomes accessible for service when the engine cover is opened.

Fold the seat forward, loosen the snap lock under the seat and fold the cover backwards.

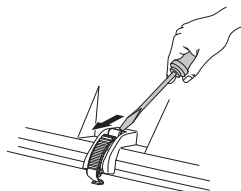

Front cover

Release the clip on the front hood and lift off the fender.

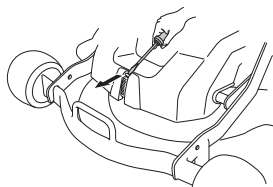

Right-hand fender

Remove the accelerator knob (1), screws (2), and remove the cover.

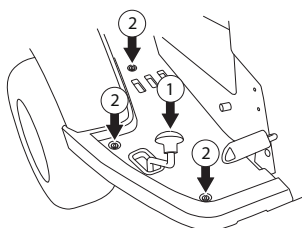

Left-hand fender

Loosen the screws holding the wing cover and lift off the cover.

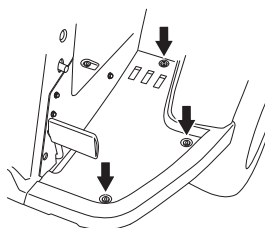

MAINTENANCE AND SERVICE

Checking and adjusting the steering wires

The steering is controlled by means of wires. These can in time become slack, which implies that the adjustment of the steering becomes altered.

Check and adjust the steering as follows:

- 1 Remove the frame plate by loosening the screws (2) and lift the frame plate by the rear edge.

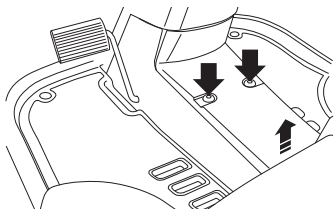

- 2 Check the tension of the steering wires by squeezing them together by the arrows as illustrated. It should be possible to push them together so that the distance between them is half as much, without using unnecessary force.

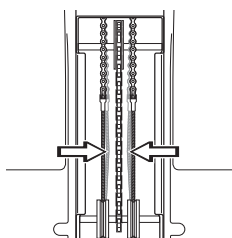

- 3 If necessary, the wires can be adjusted by tightening the adjuster nuts on each side of the steering collar. Do not over tighten the cables; they should only be drawn in towards the steering collar.

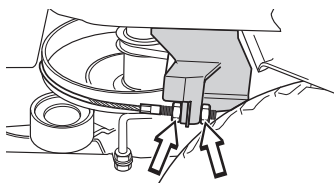

- 4 Unscrew the belt shields and the side protectors. The protectors are fitted on both sides of the machine.

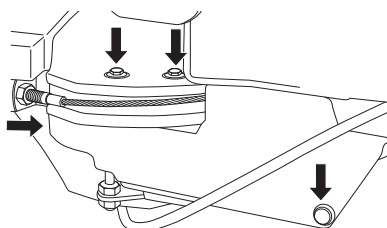

- 5 Hold the cable, for example using an adjustable wrench, so that it does not twist.

If you only tension one side the steering wheel's centre position may change.

- 6 Check the wire tension on completion of the adjustment as per item 2.
- 7 Screw on the belt shields and the side protectors. Remember to use the right screws in each mounting.

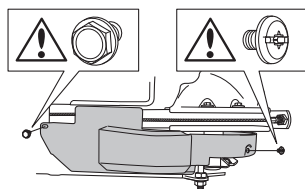
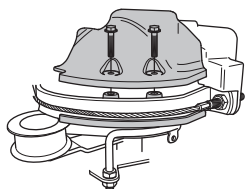

Adjusting the parking brake Rider 213 C, Rider 216

Check that the brake is correctly adjusted by placing the machine on a slight downhill slope with the clutch disengaged and activating the brake.

When the machine does not stand still, the brake should be adjusted according to the following.

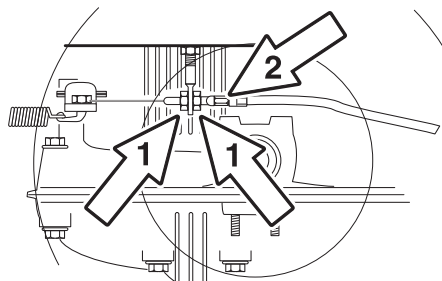

- 1 Loosen the locking nuts (1).
- 2 Tension the cable using the adjuster screw (2) until the play in the cable is taken up.
- 3 Tighten the locking nuts (1).
- 4 The brake should be checked again after adjustment



WARNING! A poorly adjusted brake can result in reduced braking ability.

Rider 216 AWD

Check that the parking brake is adjusted correctly by placing the machine on a slope with the front and rear axles disengaged. Apply and lock the parking brake. When the machine does not stand still, the parking brake should be adjusted according to the following.

- 1 Remove the left-hand wing cover.

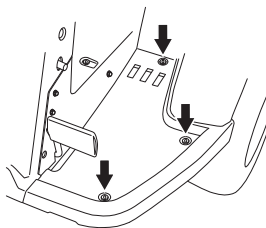

- 2 Loosen the locking nuts (1).

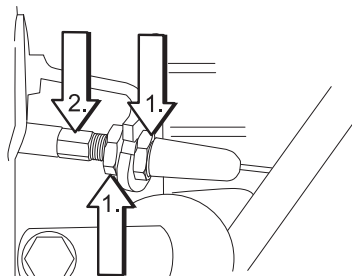

- 3 Tension the cable using the adjuster screw (2) until the play in the cable is taken up.
- 4 Tighten the locking nuts (1).
- 5 The brake should be checked again after adjustment
- 6 Assemble the left-hand wing cover.



WARNING! A poorly adjusted parking brake can result in reduced braking ability.

MAINTENANCE AND SERVICE

Adjusting the throttle wire

The throttle cable may need to be adjusted, if the engine does not respond as it should when accelerating, if it produces black smoke or maximum revs are not reached.

- 1 Release the clamping screw that secures the wire casing and set the choke control to maximum choke.

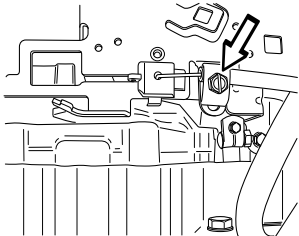

- 2 Pull the choke wire casing to the far right and tighten the clamping screw.

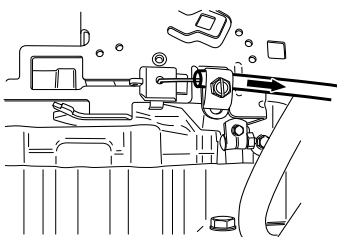

- 3 Pull back the throttle to the full throttle position and check that the choke is no longer actuated.

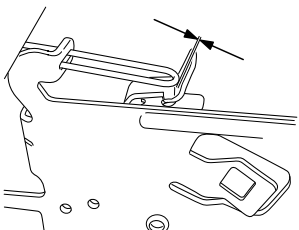

Replacing the air filter

If the engine seems to lack power or does not run smoothly this may be because the air filter is clogged. It is therefore important to replace the air filter at regular intervals (see Maintenance/Maintenance Schedule for the correct service interval).

Replace the air filter as follows:

- 1 Open the engine cover.
- 2 Loosen the knobs holding the filter cover in place and remove it.

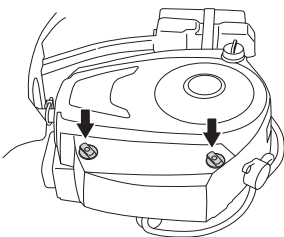

- 3 Remove the filter cartridge from the filter housing.

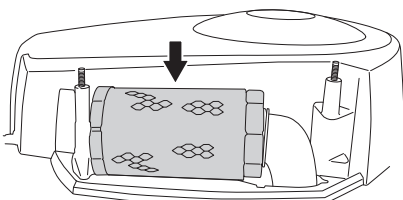

IMPORTANT! Do not use compressed air to clean the paper filter.

Do not oil the paper filter. They must be fitted dry.

- 4 Remove the foam rubber prefilter which is placed around the filter cartridge and clean using a mild detergent.
- 5 Dry the pre-filter properly.
- 6 Refit the prefilter on the filter cartridge.
- 7 Slide the filter onto the air hose.

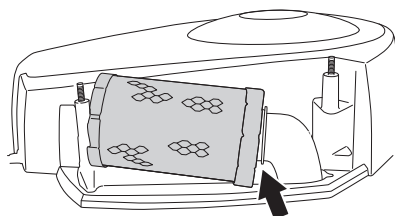

- 8 Push the filter cartridge in place.

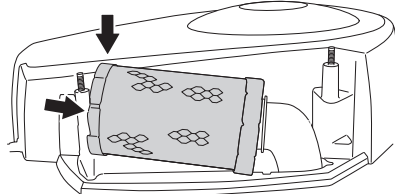

- 9 Refit the air filter cover.

Replacement of fuel filter

Replace the fuel filter every 100 running hours (once per season) or more frequently if it is clogged.

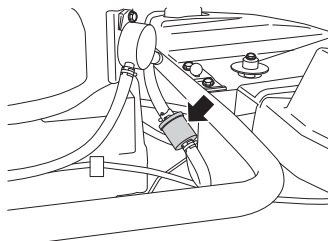

Replace the filter as follows:

- 1 Open the engine cover.
- 2 Move the hose clips away from the filter. Use a pair of flat pliers.
- 3 Pull off the filter from the hose ends.
- 4 Press the new filter into the ends of the hoses. If necessary apply liquid detergent to the ends of the filter to facilitate connection.
- 5 Push the hose clips back on the filter and tighten.

Checking the fuel pump's air filter

Check regularly that the fuel pump's air filter is free from dirt.

The filter can when necessary be cleaned with a brush.

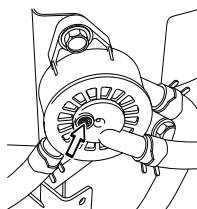

MAINTENANCE AND SERVICE

Checking the tyre pressure

The tyre pressure should be 60 kPa / 0.6 bar / 8,7 PSI on all wheels. In order to improve drive power, the pressure in the rear tyres can be reduced to 40 kPa / 0.4 bar / 6 PSI.

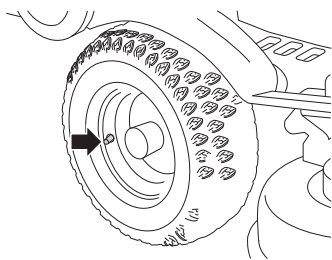

CAUTION! Different tyre pressures on the front tyres will result in the blades cutting the grass at different heights. Having the same air pressure in the tyres is important in order to achieve the best possible performance as well as to avoid damage to the machine

Ignition system

The engine is equipped with an electronic ignition system. Only the spark plug requires maintenance.

For recommended spark plug, see Technical data.

CAUTION! Fitting the wrong spark plug type can damage the engine.

Replacing the spark plug

- 1 Remove the ignition cable shoe and clean around the spark plug.
- 2 Remove the spark plug with a 5/8" (16 mm) spark plug socket wrench.
- 3 Check the spark plug. Replace the spark plug if the electrodes are burned or if the insulation is cracked or damaged. Clean the spark plug with a steel brush if it is to be reused.
- 4 Measure the electrode gap with a gapping tool. The gap should be 0.75 mm/0.030". Adjust as necessary by bending the side electrode.
- 5 Reinsert the spark plug, turning by hand to avoid damaging the threads.

CAUTION! Inadequately tightened spark plugs can cause overheating and damage the engine. Tightening the spark plug too much can damage the threads in the cylinder head.

- 6 Tighten the spark plug, once it touches the seating, with the spark plug spanner. Tighten the spark plug so that the washer is compressed. A used spark plug should be turned 1/8 of a turn from the seated position. A new spark plug should be turned a 1/4 turn from the seated position.
- 7 Replace the ignition cable shoe.

CAUTION!

Do not turn over the engine if the spark plug or ignition cable has been removed.

Fuses

The main fuse is placed in a detachable holder under the battery case's cover, in front of the battery.

Type: Flat pin, 15 A.

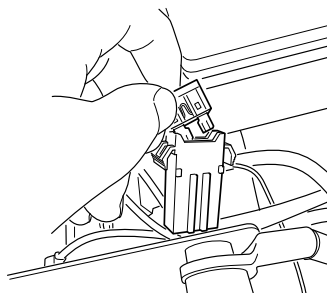

Do not use any other type of fuse when replacing.

A blown fuse is indicated by a burnt connector. Pull the fuse from the holder when replacing.

The fuse is there to protect the electrical system. If it blows again shortly after replacement, it is due to a short circuit, which must be fixed before the machine can be put into operation again.

Checking the engine's cooling air intake

Clean the air intake grille in the engine cover behind the driver's seat.

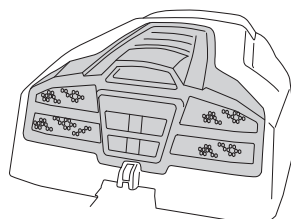

Open the engine cover.

Check that the cooling intake is free from leaves, grass and dirt.

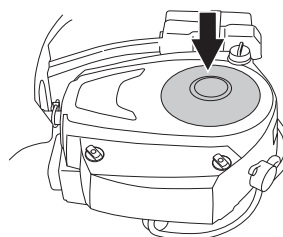

Check the air duct, located on the inside of the engine cover, ensure it is clean and does not rub against the cooling air intake.

A blocked cooling intake will interfere with the cooling of the engine, which can damage the engine.



WARNING! The cooling air intake rotates when the engine is running. Mind your fingers.

MAINTENANCE AND SERVICE

Checking and adjustment of the cutting unit's ground pressure

To achieve the best cutting results the cutting unit should follow the underlying surface without pressing too hard against it. Pressure is adjusted using a screw and spring on each side of the Rider.

- 1 Check the air pressure in the tyres 60 kPa / 0.6 bar / 9 PSI.
- 2 Place a set of bathroom scales under the cutting unit's frame (front edge) so that it rests on the scales. If necessary a block can be placed between the frame and scales so that the support wheels do not bear any weight.

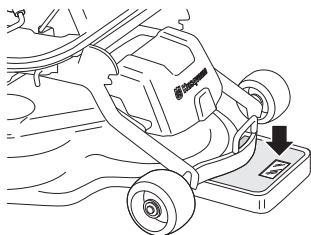

- 3 Adjust the cutting unit's ground pressure by screwing the adjuster screws, which are located behind the front wheels on both sides, in or out. The ground pressure should be between 12 and 15 kg and the springs evenly tensioned.

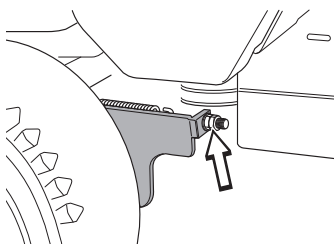

Adjusting the cutting height

The cutting height can be adjusted to 10 different positions with the cutting height lever.

- Move the lever to the back for higher cutting height and to the front for lower cutting height.

Height intervals are between 25-75 mm.

Checking the cutting unit's parallelism

Check the cutting unit's parallelism as follows:

- 1 Check the air pressure in the tyres 60 kPa / 0.6 bar / 9 PSI.
- 2 Place the machine on a flat surface.
- 3 Measure the distance between the ground and cutting unit's edge at the front of the cover.

The cutting unit should have a slight slant, with the rear edge 2-4 mm (1/8") higher than the front edge.

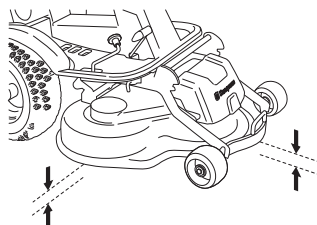

Adjusting the parallelism of the cutting unit

- 1 Remove the front cover.
- 2 Unscrew the belt shield.

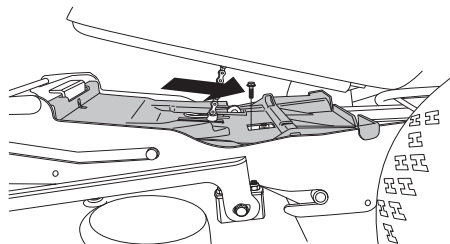

- 3 Loosen the parallelism stay's nuts, the inner nut has a left-hand thread.

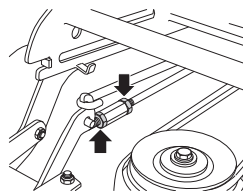

- 4 Screw out (extend) the stay to raise the rear edge of the cover. Screw in (shorten) the stay to lower the rear edge of the cover.

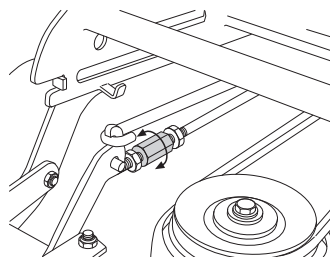

- 5 Tighten the nuts after adjustment.
- 6 On completion of the adjustment the unit's parallelism should be re-checked.
- 7 Screw on the belt shield.

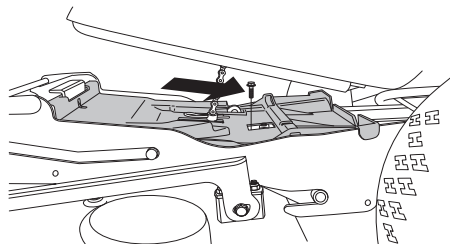

- 8 Fit the front cover.

MAINTENANCE AND SERVICE

Service position for the cutting unit

The cutting head can be placed in the service position to provide easy access for cleaning, repairs and servicing. In the service position the cutting unit is raised and locked in the vertical position.

Placing in the service position

- 1 Position the machine on flat ground. Apply and lock the parking brake. Set the cutting height control in the lowest position and lift up the cutting unit.

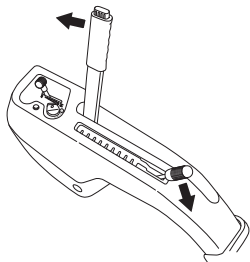

- 2 Release the clip on the front hood and lift off the fender.

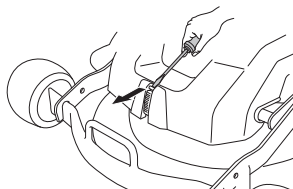

- 3 Loosen the spring on the drive belt's belt idler by pulling the spring eye.

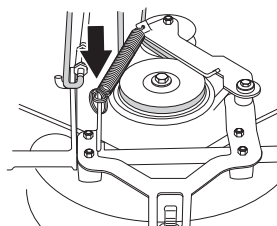

- 4 Place the spring eye in the holder.

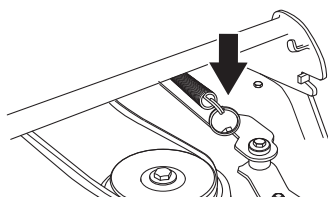

- 5 Lift off the drive belt and hang on the load-relieving hook.

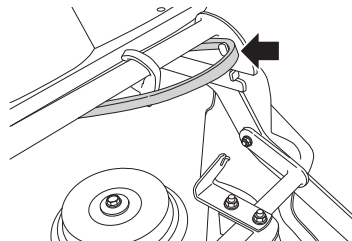

- 6 Loosen on the cutting height stay and place in the holder.

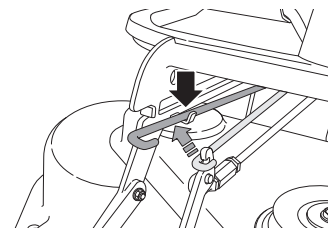

- 7 Grip the front edge of the unit and pull forwards until it stops.

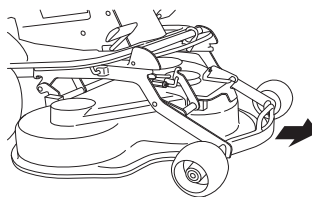

- 8 Lift the unit until it stops and a clicking sound is heard.

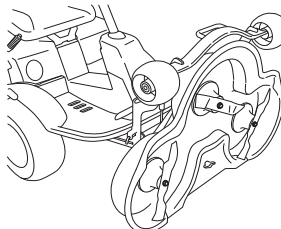

- 9 The unit locks automatically in the vertical position.

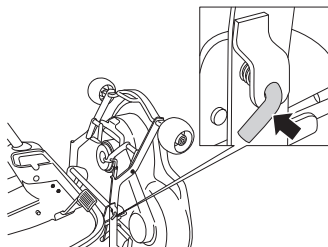

Restoring from service position

- 1 Grip the front edge of the unit and loosen the lock, fold down and slide in the unit.

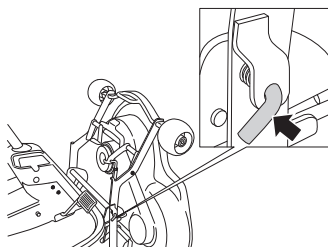

- 2 Replace the cutting height stay and the belt. Tension the belt with the belt adjuster.

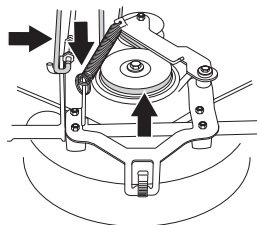

- 3 Fit the front cover.

- 4 Set the cutting height control to one of the positions 1-10

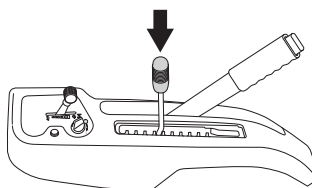

MAINTENANCE AND SERVICE

Removing the BioClip plug

To change a Combi deck from the BioClip function to a cutting deck with rear ejection, remove the BioClip plug, which is located under the unit.

- Put the unit in the service position, see Placing in the service position.

Combi 94

- Loosen the knob and the bolts holding the BioClip plug and remove the plug.

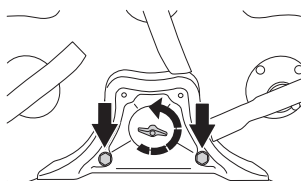

- Replace the unit in normal position.
Fit the BioClip plug in the reverse order.

Combi 103

- Remove the three screws holding the BioClip plug, and remove the plug.

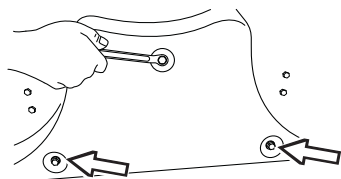

- Tip: Fit three full-thread screws M8x15 mm in the screw holes to protect the threads.
- Replace the unit in normal position.
Fit the BioClip plug in the reverse order.

Checking the blades

To achieve the best mowing results it is important that the blades are undamaged and well-sharpened.

Check that the blades' attachment screws are tight.

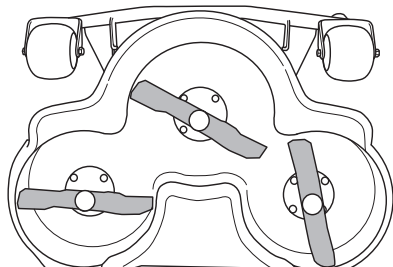

IMPORTANT! One or more unbalanced blades, caused by damage or poor balancing after sharpening, can cause vibrations in the machine.

The blades should be balanced after sharpening.

Damaged blades should be replaced when hitting obstacles that result in a breakdown.

Replacing the blades

- Put the unit in the service position, see Service position for the cutting unit.
- Lock the blade with a wooden block. Loosen the blade bolt and remove the blade bolt, the washers and the blade.

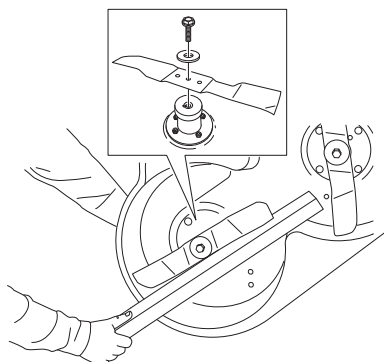

- Assemble the parts in the reverse order.
- The blade must be mounted with the angled ends pointing up towards the cover.

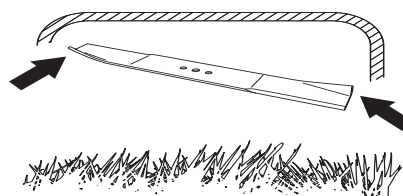

- Tightening torque 45-50 Nm (4.5-5 kpm/32-36 lbft).



WARNING! Wear gloves to protect your hands when working with the blades.

IMPORTANT!

Always exercise care and use your common sense. Avoid all situations which you consider to be beyond your capability. If you still feel uncertain about operating procedures after reading these instructions, you should consult an expert before continuing. Contact an authorised service workshop.

Always use genuine parts. For more information, see the "Technical data" section.

MAINTENANCE AND SERVICE

Checking the engine's oil level.

Check the oil level in the engine when the Rider stands horizontal with the engine switched off. Do not check the oil with the engine running.

Open the engine cover.

Loosen the dipstick, pull it up and wipe it off.

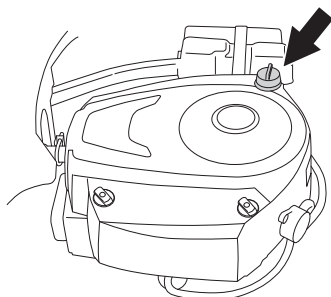

The dipstick should be **completely screwed down**

Pull the dipstick out again and read the oil level.

The oil level should be between the markings on the dipstick. If the level is approaching the ADD mark, top up the oil to the FULL mark on the dipstick.

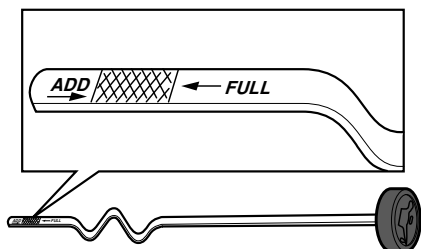

The oil is topped up through the hole the dipstick sits in.

Fill the oil slowly. Tighten the dipstick correctly before starting the engine. Start and run the engine at idling speed for approx. 30 seconds. Turn off the motor. Wait 30 seconds and check the oil level. If necessary fill so that the oil comes up to the FULL mark on the dipstick.

First and foremost use synthetic engine oil class SJ-CF 5W/30 or 10W/30 for all temperature ranges. Mineral oil SAE30, class SF-CC can be used at temperatures $> +5\text{ }^{\circ}\text{C}$ ($40\text{ }^{\circ}\text{F}$)

Do not mix different types of oil.

Replacing the engine oil

The engine oil should be changed the first time after 5 hours running time. It should then be changed after every 50 hours of running time.

When operating with a heavy load or at high ambient temperatures, replace every 25 hours.



WARNING! Engine oil can be very hot if it is drained directly after stopping the engine. Allow the engine to cool somewhat first.

- 1 Place a container underneath the engine's left oil drain plug.
- 2 Remove the dipstick. Remove the drain plug from the engine's left side.

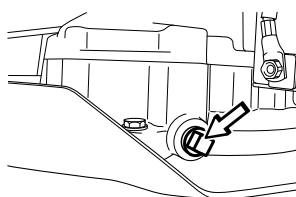

- 3 Let the oil run out into the container.
- 4 Fit the drain plug and tighten it.
- 5 Fill with oil up to the "FULL" mark on the dipstick. The oil is topped up through the hole the dipstick sits in. See Checking the engine's oil level for filling instructions.
- 6 Run the engine warm, then check that there is no leakage from the oil plug.

IMPORTANT INFORMATION

Used engine oil, antifreeze etc. is a health hazard and must not be disposed of on the ground or in nature; it should always be disposed of at a workshop or appropriate disposal location.

Avoid skin contact; wash with soap and water in case of spills.

MAINTENANCE AND SERVICE

Changing the oil filter

The oil filter must be replaced after every 200 hours running time. Turn the old oil filter anti-clockwise to remove. If necessary, use a filter remover.

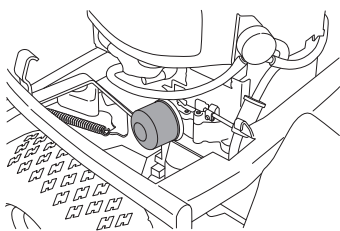

Lightly lubricate the rubber seal on the new oil filter using new oil. Fit the oil filter by turning clockwise. Turn by hand until the rubber seal is seated. Now tighten a further half turn.

Fill with new oil according to Checking the engine's oil level. Start the engine and let it idle for about 3 minutes. Now stop it and check for signs of leakage. Fill with oil to compensate for the oil held in the new oil filter.

Checking the transmission oil level

- 1 Remove the transmission cover. Undo the two screws (one on each side) and lift off the transmission cover.

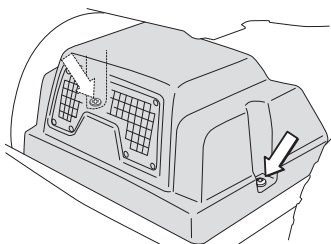

- 2 **Rider 213 C, Rider 216** Check that there is oil in the transmission's oil tank. Fill if necessary with engine oil SAE 10W/40 (class SF-CC).

Rider 216 AWD

Check that there is oil in the transmission's oil tank. Fill if necessary with oil Synthetic 10W/50

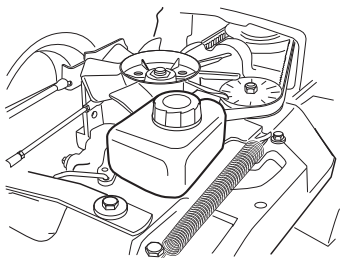

The oil and filter should be changed by an authorised service representative, as described in the Workshop Manual.

Work on the system entails particular demands on cleanliness and the system must be vented before the machine is used.

Lubricating the belt adjuster

The belt adjuster should be lubricated regularly using good quality molybdenum disulphide grease*.

- 1 Unscrew the belt shield.

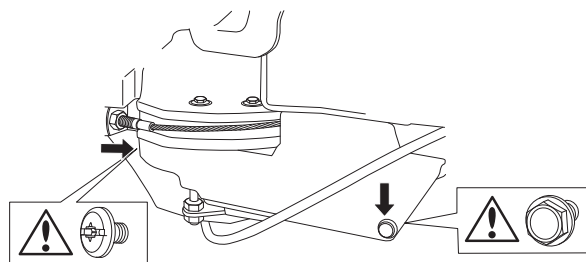

- 2 Lubricate using a grease gun, 1 nipple from the right-hand side under the engine's lower belt pulley, until grease is forced out.

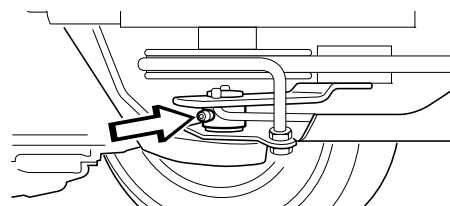

- 3 Screw on the belt shields and the side protectors. Remember to use the right screws in each mounting.

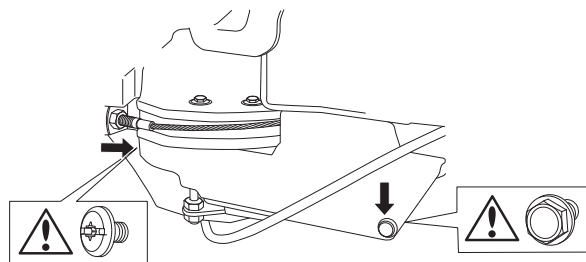

With daily use, lubrication should be carried out twice weekly.

General lubrication

All joints and bearings are lubricated using molybdenum disulphide grease during manufacture. Continue to lubricate using the same type of grease *. Lubricate the steering and control wires using engine oil.

Carry out this lubrication regularly; with daily use, the machine should be lubricated twice weekly.

*Grease from well-known brand names (petrochemical companies, etc.) usually maintains a good quality. The most important property is that the grease provides good protection against corrosion.

Troubleshooting schedule

Problem	Cause
Engine does not start	There is no fuel in the fuel tank
	Faulty spark plug.
	Defective ignition cable.
	Dirt in the carburettor or fuel line
	Starter motor does not turn over the engine
	Defect safety switch
Starter motor does not turn over the engine	Battery flat
	Bad contact between the cable and battery
	Lift lever for cutting unit in wrong position
	Main fuse blown.
	Ignition lock faulty
	Brake not activated.
	Faulty starter motor
Engine does not run smoothly	Faulty spark plug.
	Carburettor incorrectly set
	Air filter clogged
	Fuel tank vent blocked
	Ignition key defective
	Dirt in the carburettor or fuel line
	Choking or incorrectly adjusted throttle cable
Engine seems to have no power	Air filter clogged
	Faulty spark plug.
	Dirt in the carburettor or fuel line
	Carburettor incorrectly set
	Choking or incorrectly adjusted throttle cable
Engine overheats	Engine overloaded
	Faulty spark plug.
	Air intake or cooling flanges blocked
	Fan damaged
	Too little or no oil in engine
	Ignition defective
Battery does not charge	One or more battery cells faulty
	Poor contact on the battery terminal cable connectors
Machine vibrates	Blades are loose
	Engine is loose
	One or more blades unbalanced, caused by damage or poor balancing after sharpening
Uneven mowing	Blades blunt
	Long or wet grass
	Cutting unit skew
	Grass blockage under hood
	Different tyre pressures on right and left sides
	Over-speeding
	Engine speed too low
	Drive belt slipping

TECHNICAL DATA

	Rider 213 C	Rider 216	Rider 216 AWD
Dimensions			
Length with cutting unit, mm/ft	223 / 7,32	223 / 7,32	223 / 7,32
Length without cutting unit, mm/ft	190 / 6,23	190 / 6,23	190 / 6,23
Width with cutting unit, mm/ft	100 / 3,29	100-108 / 32,8-35.4	100-108 / 32,8-35.4
Width without cutting unit, mm/ft	89 / 2,92	89 / 2,92	89 / 2,92
Height, mm/ft	1070/3,52	1070/3,52	1070/3,52
Machine without cutting unit, with empty tanks, kg/lb	185/408	189/416	208/458
Wheel base, mm/ft	887/2,9	887/2,9	887/2,9
Track width, front, mm/ft	712/2,34	712/2,34	712/2,34
Track width, rear, mm/ft	627/2,06	627/2,06	627/2,06
Tyre dimensions	165/60-8	165/60-8	165/60-8
Air pressure, rear - front, kPa / bar / PSI	60 (0,6/8,5)	60 (0,6/8,5)	60 (0,6/8,5)
Engine			
Brand / Model	Briggs & Stratton/Intek 3125	Briggs & Stratton/Intek 4155	Briggs & Stratton/Intek 4155
Nominal engine output, kW (see note 1)	6,7	9,6	9,6
Displacement, cm ³ /cu.in	344	500	500
Max. motor speed, r/min	3000 ± 100	2900 ± 100	2900 ± 100
Fuel, minimum octane grade lead-free	85	85	85
Fuel tank capacity, litre	12	12	12
Oil synthetic, class SJ-CF	SAE 5W/30 or SAE 10W/30	SAE 5W/30 or SAE 10W/30	SAE 5W/30 or SAE 10W/30
Oil volume incl. filter	1,6/1,7	1,6/1,7	1,6/1,7
Oil volume excl. filter, litres/USqt	1,4/1,5	1,4/1,5	1,4/1,5
Starting	Electric starter	Electric starter	Electric starter
Electrical system			
Type	12 V, negative earthed	12 V, negative earthed	12 V, negative earthed
Battery	12 V, 24 Ah	12 V, 24 Ah	12 V, 24 Ah
Spark plug	Champion QC12YC	Champion QC12YC	Champion QC12YC
Electrode gap, mm/inch	0,75/0,030	0,75/0,030	0,75/0,030
Main fuse	Spade connector, 7.5 A	Spade connector, 7.5 A	Spade connector, 7.5 A
Noise emissions and cutting width (see note 2)			
Sound power level, measured dB (A)	98	99	99
Guaranteed noise level	100	100	100
Cutting width, cm/inch	94/37	94-103 / 37-41	94-103 / 37-41
Sound level (see note 3)			
Sound pressure level at the operators ear, dB(A)	84	84	84
Vibration levels (see note 4)			
Vibration level on the steering wheel, m/s ²	2,5	2,5	2,5
Vibration level in the seat, m/s ²	0,7	0,7	0,7
Transmission			
Brand	Tuff Torq	Tuff Torq	K 574 KTM 10L
Lubricant	SAE 10W/40	SAE 10W/40	SAE 10W/50 Synthetic
Forward speed, km/h.	0-9	0-9	0-9
Reverse speed, km/h	0-6	0-6	0-6
Cutting unit			
Type	Combi 94	Combi 94 Combi 103	Combi 94 Combi 103

TECHNICAL DATA

Note 1: The power rating of the engine indicated is the average net output (at specified rpm) of a typical production engine for the engine model measured to SAE standard J1349/ISO1585. Mass production engines may differ from this value. Actual power output for the engine installed on the final machine will depend on the operating speed, environmental conditions and other values.

Note 2: Noise emissions in the environment measured as sound power (L_{WA}) in conformity with EC directive 2000/14/EC.

Note 3: Noise pressure level according to ISO 5395. Reported data for noise pressure level has a typical statistical dispersion (standard deviation) of 1.2 dB(A).

Note 4: Vibration level according to ISO 5395. Reported data for vibration level has a typical statistical dispersion (standard deviation) of 0.2 m/s² (steering wheel) and 0.8 m/s² (seat).

Cutting unit	Combi 94	Combi 103
Cutting width, cm/inch	94/37	103 / 41
Cutting heights, 7 positions, mm/inch	25-75/0.98-2.95	25-75/0.98-2.95
Blade length, mm/inch	358/14.09	388/15.28
Weight	35/77	43/95
Cutter		
Article number	5796525-10	5041882-10

IMPORTANT INFORMATION When the service life of this product has been served and it is no longer used it should be returned to the dealer or to an applicable station for recycling.

IMPORTANT INFORMATION We reserve the right to change specifications and designs without prior notice so as to implement improvements. Note that no legal claims are valid on the basis of information in this manual. Use only genuine parts for repairs. The warranty is not valid if non genuine parts are used.

TECHNICAL DATA

EC Declaration of Conformity (Applies to Europe only)

Husqvarna AB, SE-561 82 Huskvarna, Sweden, tel.: +46-36-146500, hereby declares that Husqvarna Rider 213 C, Rider 216 and Rider 216 AWD from 2014's serial numbers and onwards (the year is clearly stated in plain text on the rating plate with subsequent serial number), complies with the requirements of the COUNCIL'S DIRECTIVE:

of May 17, 2006 "relating to machinery" **2006/42/EC**.

of February 26, 2014 "relating to electromagnetic compatibility" **2014/30/EU**.

of May 8, 2000 "relating to the noise emissions in the environment" **2000/14/EC**.

The following harmonised standards have been applied: **EN ISO 12100-2, ISO 5395-3:2013**

Notified body: **0404, SMP Svensk Maskinprovning AB**, Box 7035, SE-750 07 Uppsala, has issued reports regarding the assessment of conformity according to annex VI of the COUNCIL'S DIRECTIVE of May 8, 2000 "relating to the noise emissions in the environment" 2000/14/EC.

The certificates have the numbers: **01/901/143, 01/901/144**

Huskvarna 19 may 2014



Claes Losdal, Development Manager/Garden Products

(Authorized representative for Husqvarna AB and responsible for technical documentation.)

Original instructions



1156983-26

**2016-01-13
Rev.2**