

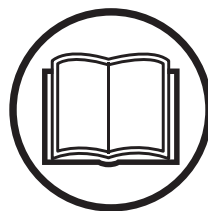

操作手册 Operator's manual
543RS



Please read the operator's manual carefully and make sure you understand the instructions before using the machine.
请认真阅读本操作手册，确保在充分理解各项说明之后再使用机器。

GB (2-24)
CN (26-49)

KEY TO SYMBOLS

Symbols

WARNING! A clearing saw, brushcutter or trimmer can be dangerous if used incorrectly or carelessly, and can cause serious or fatal injury to the operator or others. It is extremely important that you read and understand the contents of this operator's manual.

Please read the operator's manual carefully and make sure you understand the instructions before using the machine.

Always wear:

- Wear a protective helmet where there is a risk of falling objects
- Approved hearing protection
- Approved eye protection

Max. speed of output shaft, rpm

Watch out for thrown objects and ricochets.

The operator of the machine must ensure, while working, that no persons or animals come closer than 15 meters.

Machines fitted with saw blades or grass blades can be thrown violently to the side when the blade comes into contact with a fixed object. This is called blade thrust. The blade is capable of amputating an arm or leg. Always keep people and animals at least 15 meters from the machine.

Arrows which show limits for handle positioning.

Always wear approved protective gloves.

Wear sturdy, non-slip boots.



Choke: Set the choke control in the choke position.



Air purge

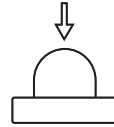

Other symbols/decals on the machine refer to special certification requirements for certain markets.

Switch off the engine by moving the stop switch to the STOP position before carrying out any checks or maintenance.

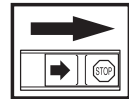

Always wear approved protective gloves.

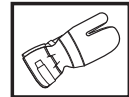

Regular cleaning is required.

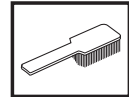

Visual check.



Approved eye protection must always be used.



CONTENTS

Contents

KEY TO SYMBOLS

Symbols 2

CONTENTS

Contents 3

INTRODUCTION

Dear Customer, 4

WHAT IS WHAT?

What is what on the brush cutter? 5

GENERAL SAFETY PRECAUTIONS

Note the following before starting: 6

Important 6

Personal protective equipment 7

Machine's safety equipment 7

Cutting equipment 10

ASSEMBLY

Assembling the handlebar and throttle 12

Fitting blades and trimmer heads 12

FUEL HANDLING

Fuel safety 14

Fuel 14

Fueling 15

STARTING AND STOPPING

Check before starting 16

Starting and stopping 16

WORKING TECHNIQUES

General working instructions 18

MAINTENANCE

Carburettor 22

Air filter 22

Fuel filter 23

Bevel gear 23

Spark plug 23

Maintenance schedule 24

TECHNICAL DATA

Technical data 25

INTRODUCTION

Dear Customer,

Congratulations on your choice to buy a Husqvarna product! Husqvarna is based on a tradition that dates back to 1689, when the Swedish King Karl XI ordered the construction of a factory on the banks of the Husqvarna River, for production of muskets. The location was logical, since water power was harnessed from the Huskvarna River to create the water-powered plant. During the more than 300 years in existence, the Husqvarna factory has produced a lot of different products, from wood stoves to modern kitchen appliances, sewing machines, bicycles, motorcycles etc. In 1956, the first motor driven lawn mowers appeared, followed by chain saws in 1959, and it is within this area Husqvarna is working today.

Today Husqvarna is one of the leading manufacturers in the world of forest and garden products, with quality as our highest priority. The business concept is to develop, manufacture and market motor-driven products for forestry and gardening, as well as for the building and construction industry. Husqvarna's aim is also to be at the front edge for ergonomics, usability, security and environmental protection. That is the reason why we have developed many different features to add to our products within these areas.

We are convinced that you will appreciate with great satisfaction the quality and performance of our product for a very long time to come. The purchase of one of our products gives you access to professional help with repairs and service whenever this may be necessary. If the retailer who sells your machine is not one of our authorised dealers, ask for the address of your nearest service workshop.

It is our wish that you will be satisfied with your product and that it will be your companion for a long time. Think of this operator's manual as a valuable document. By following its content (usage, service, maintenance, etc), the life span and the second-hand value of the machine can be extended. If you sell this machine, make sure that the operator's manual is passed on to the buyer.

Thank you for using a Husqvarna product.

Husqvarna AB has a policy of continuous product development and therefore reserves the right to modify the design and appearance of products without prior notice.

WHAT IS WHAT?

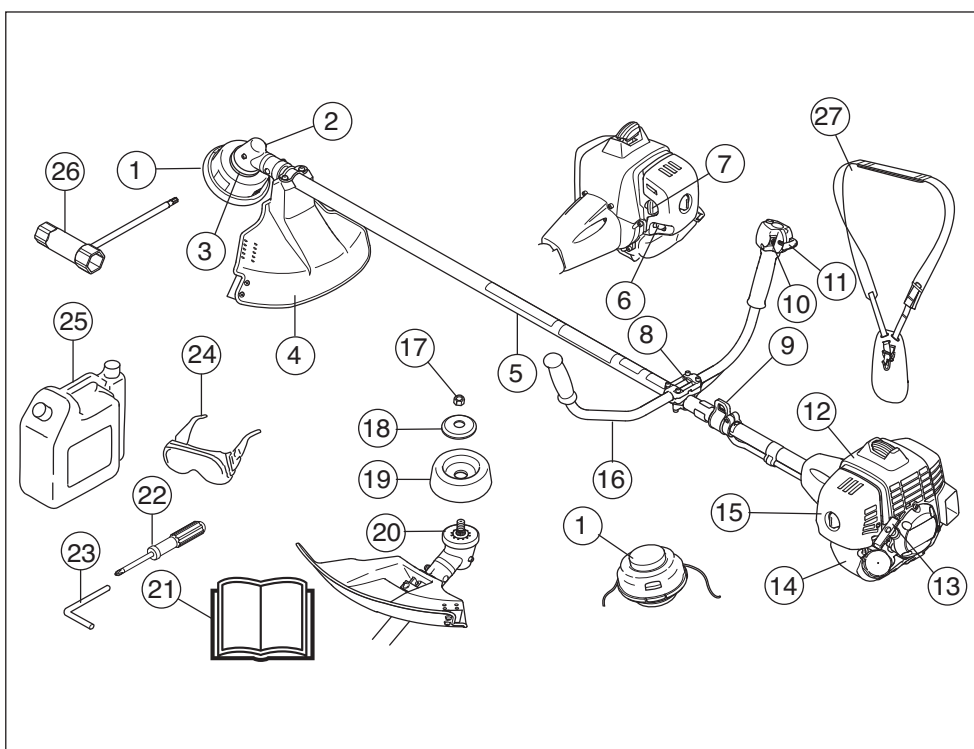

What is what on the brush cutter?

- | | | | |
|----|-------------------------------|----|-------------------------|
| 1 | Trimmer head | 15 | Air filter cover |
| 2 | Grease filler cap, bevel gear | 16 | Handlebar |
| 3 | Bevel gear | 17 | Locking nut |
| 4 | Cutting attachment guard | 18 | Support flange |
| 5 | Shaft | 19 | Support cup |
| 6 | Air purge | 20 | Drive disc |
| 7 | Choke control | 21 | Operator's manual |
| 8 | Handlebar clamp | 22 | Screwdriver |
| 9 | Suspension ring | 23 | Locking pin |
| 10 | Stop switch | 24 | Approved eye protection |
| 11 | Throttle trigger | 25 | Tank |
| 12 | Cylinder cover | 26 | Socket spanner |
| 13 | Starter handle | 27 | Harness |
| 14 | Fuel tank | | |

GENERAL SAFETY PRECAUTIONS

Note the following before starting:

Please read the operator's manual carefully.



WARNING! Long-term exposure to noise can result in permanent hearing impairment. So always use approved hearing protection.



WARNING! Under no circumstances may the design of the machine be modified without the permission of the manufacturer. Always use original accessories. Non-authorized modifications and/or accessories can result in serious personal injury or the death of the operator or others.



WARNING! A clearing saw, brushcutter or trimmer can be dangerous if used incorrectly or carelessly, and can cause serious or fatal injury to the operator or others. It is extremely important that you read and understand the contents of this operator's manual.



WARNING! This machine produces an electromagnetic field during operation. This field may under some circumstances interfere with active or passive medical implants. To reduce the risk of serious or fatal injury, we recommend persons with medical implants to consult their physician and the medical implant manufacturer before operating this machine.



WARNING! Running an engine in a confined or badly ventilated area can result in death due to asphyxiation or carbon monoxide poisoning.



WARNING! Never allow children to use or be in the vicinity of the machine. As the machine is equipped with a spring-loaded stop switch and can be started by low speed and force on the starter handle, even small children under some circumstances can produce the force necessary to start the machine. This can mean a risk of serious personal injury. Therefore remove the spark plug cap when the machine is not under close supervision.

Important

IMPORTANT!

The machine is only designed for trimming grass.
The only accessories you can operate with this engine unit are the cutting attachments we recommend in the chapter on Technical data.
National or local regulations may regulate the use. Comply to given regulations.
Never use the machine if you are tired, if you have drunk alcohol, or if you are taking medication that could affect your vision, your judgement or your co-ordination.
Wear personal protective equipment. See instructions under the "Personal protective equipment" heading.
Never use a machine that has been modified in any way from its original specification.
Never use a machine that is faulty. Carry out the safety checks, maintenance and service instructions described in this manual. Some maintenance and service measures must be carried out by trained and qualified specialists. See instructions under the Maintenance heading.
All covers, guards and handles must be fitted before starting. Ensure that the spark plug cap and ignition lead are undamaged to avoid the risk of electric shock.
The machine operator must ensure that no people or animals come closer than 15 metres while working. When several operators are working in the same area the safety distance should be at least 15 metres.
Carry out an overall inspection of the machine before use. See the maintenance schedule.

GENERAL SAFETY PRECAUTIONS

Personal protective equipment

IMPORTANT!

A grass trimmer can be dangerous if used incorrectly or carelessly, and can cause serious or fatal injury to the operator or others. It is extremely important that you read and understand the contents of this operator's manual.

You must use approved personal protective equipment whenever you use the machine. Personal protective equipment cannot eliminate the risk of injury but it will reduce the degree of injury if an accident does happen. Ask your dealer for help in choosing the right equipment.



WARNING! Listen out for warning signals or shouts when you are wearing hearing protection. Always remove your hearing protection as soon as the engine stops.

HELMET

Wear a protective helmet where there is a risk of falling objects



HEARING PROTECTION

Wear hearing protection that provides adequate noise reduction.



EYE PROTECTION

Always wear approved eye protection. If you use a visor then you must also wear approved protective goggles. Approved protective goggles must comply with the ANSI Z87.1 standard in the USA or EN 166 in EU countries.



GLOVES

Gloves should be worn when necessary, e.g. when fitting cutting attachments.



BOOTS

Wear sturdy, non-slip boots.



CLOTHING

Wear clothes made of a strong fabric and avoid loose clothing that can catch on twigs and branches. Always wear heavy, long pants. Do not wear jewellery, shorts sandals or go barefoot. Secure hair so it is above shoulder level.

FIRST AID KIT

Always have a first aid kit nearby.



Machine's safety equipment

This section describes the machine's safety equipment, its purpose, and how checks and maintenance should be carried out to ensure that it operates correctly. See the "What is what?" section to locate where this equipment is positioned on your machine.

The life span of the machine can be reduced and the risk of accidents can increase if machine maintenance is not carried out correctly and if service and/or repairs are not carried out professionally. If you need further information please contact your nearest service workshop.

IMPORTANT!

All servicing and repair work on the machine requires special training. This is especially true of the machine's safety equipment. If your machine fails any of the checks described below you must contact your service agent. When you buy any of our products we guarantee the availability of professional repairs and service. If the retailer who sells your machine is not a servicing dealer, ask him for the address of your nearest service agent.



WARNING! Never use a machine with faulty safety equipment. The machine's safety equipment must be checked and maintained as described in this section. If your machine fails any of these checks contact your service agent to get it repaired.

GENERAL SAFETY PRECAUTIONS

Starting

See instructions under the heading Start. Start the machine and apply full throttle. Release the throttle and check that the cutting attachment stops and remains at a standstill. If the cutting attachment rotates with the throttle in the idle position then the carburettor idle setting must be checked. See instructions under the heading Maintenance.

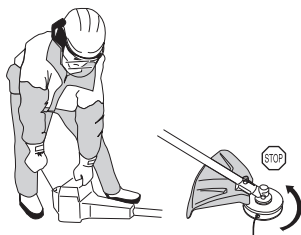

Stop switch

Use the stop switch to switch off the engine.

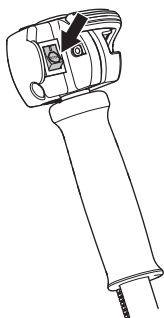

Start the engine and make sure the engine stops when you move the stop switch to the stop setting.

Cutting attachment guard



This guard is intended to prevent loose objects from being thrown towards the operator. The guard also protects the operator from accidental contact with the cutting attachment.

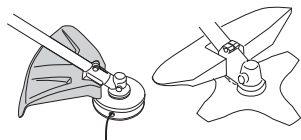

Check that the guard is undamaged and not cracked. Replace the guard if it has been exposed to impact or is cracked.

Always use the recommended guard for the cutting attachment you are using. See chapter on Technical data.



WARNING! Never use a cutting attachment without an approved guard. See the chapter on Technical data. If an incorrect or faulty guard is fitted this can cause serious personal injury.

Vibration damping system



Your machine is equipped with a vibration damping system that is designed to minimize vibration and make operation easier.

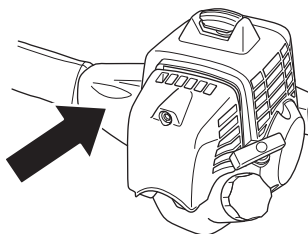

Use of incorrectly wound cord or an incorrect cutting attachment increases the level of vibration. See instructions under the heading Cutting equipment.

The machine's vibration damping system reduces the transfer of vibration between the engine unit/cutting equipment and the machine's handle unit.

Regularly check the vibration damping units for cracks or deformation. Check that the vibration damping element is undamaged and securely attached.



WARNING! Overexposure to vibration can lead to circulatory damage or nerve damage in people who have impaired circulation. Contact your doctor if you experience symptoms of overexposure to vibration. These symptoms include numbness, loss of feeling, tingling, pricking, pain, loss of strength, changes in skin colour or condition. These symptoms normally appear in the fingers, hands or wrists.

Muffler



The muffler is designed to keep noise levels to a minimum and to direct exhaust fumes away from the user. A muffler

GENERAL SAFETY PRECAUTIONS

fitted with a catalytic converter is also designed to reduce harmful exhaust gases.

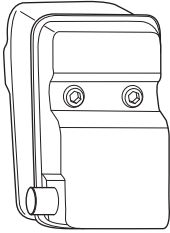

Never use a machine that has a faulty muffer.



Regularly check that the muffer is securely attached to the machine.

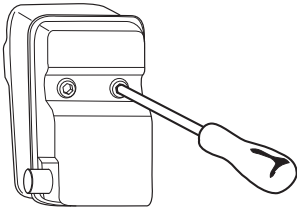

WARNING! Mufflers fitted with catalytic converters and exhaust pipes get very hot during use and remain so for some time after stopping. This also applies when idling. Contact can result in burns to the skin. Remember the risk of fire!



WARNING! The inside of the muffer contain chemicals that may be carcinogenic. Avoid contact with these elements in the event of a damaged muffer.



WARNING! The exhaust fumes from the engine are hot and may contain sparks which can start a fire. Never start the machine indoors or near combustible material!

Locking nut

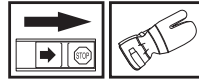

A locking nut is used to secure some types of cutting attachment.

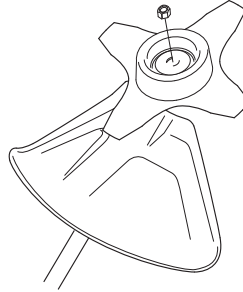

When fitting, tighten the nut in the opposite direction to the direction of rotation of the cutting attachment. To remove it, undo the nut in the same direction as the cutting attachment rotates. (CAUTION! The nut has a left-hand thread.)

When loosening and tightening the saw blade nut, there is a risk of injury from the teeth of the saw blade. You should therefore always ensure that your hand is shielded by the blade guard when doing this. Always use a socket spanner with a shaft that is long enough to allow this. The arrow in the diagram shows the area where you should operate the socket spanner when loosening or tightening the nut.

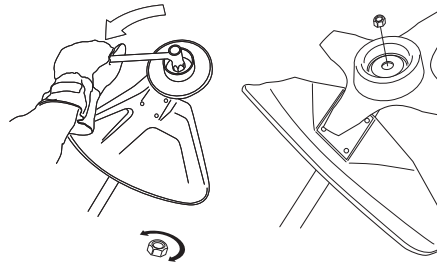

The nylon lining inside the locking nut must not be so worn that you can turn it by hand. The lining should offer a resistance of at least 1.5 Nm. The nut should be replaced after it has been put on approx. 10 times.

GENERAL SAFETY PRECAUTIONS

Cutting equipment

This section describes how to choose and maintain your cutting equipment in order to:

- Reduce the risk of blade thrust.
- Obtain maximum cutting performance.
- Extend the life of cutting equipment.

IMPORTANT!

Only use cutting attachments with the guards we recommend! See the chapter on Technical data.

Refer to the instructions for the cutting attachment to check the correct way to load the cord and the correct cord diameter.

Keep the teeth of the blade correctly sharpened! Follow our recommendations. Also refer to the instructions on the blade packaging.

Maintain the correct blade setting! Follow our instructions and use the recommended file gauge.



WARNING! Always stop the engine before doing any work on the cutting attachment. This continues to rotate even after the throttle has been released. Ensure that the cutting attachment has stopped completely and disconnect the spark plug cap before you start to work on it.



WARNING! Using an incorrect cutting attachment or an incorrectly sharpened blade increases the risk of blade thrust.

Cutting equipment

Saw blades are intended for cutting fibrous types of wood.

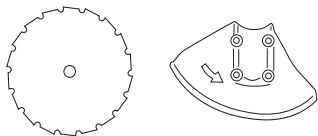

Grass blades and grass knives are intended for cutting coarse grass.

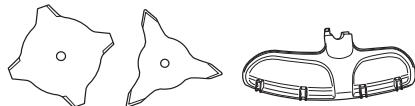

A trimmer head is intended for trimming grass.



General rules



Only use cutting attachments with the guards we recommend! See the chapter on Technical data.



Keep the teeth of the blade correctly sharpened! Follow our instructions and use the recommended file gauge. An incorrectly sharpened or damaged blade increases the risk of accidents.

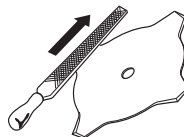

Keep the correct setting on the saw blade! Follow our instructions and use the recommended setting tool. An incorrectly set saw blade increases the risk of jamming and blade thrust, and damage to the saw blade.

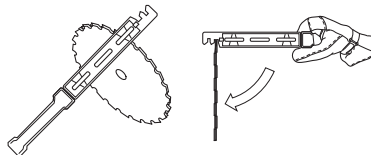

Check the cutting attachment for damage or cracks. A damaged cutting attachment should always be replaced.

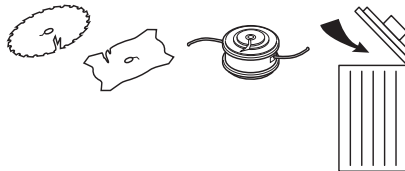

Sharpening grass knives and grass blades



- See the cutting attachment packaging for correct sharpening instructions. Sharpen blades and knives using a single-cut flat file.

GENERAL SAFETY PRECAUTIONS

- Sharpen all edges equally to maintain the balance of the blade.

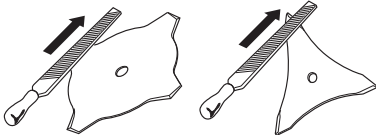

WARNING! Always discard a blade that is bent, twisted, cracked, broken or damaged in any other way. Never attempt to straighten a twisted blade so that it can be reused. Only use original blades of the specified type.

Sharpening the saw blade



- See the cutting attachment packaging for correct sharpening instructions.

A correctly sharpened blade is essential for working efficiently and to avoid unnecessary wear to the blade and brush cutter.



- Make sure that the blade is well supported when you file it. Use a 5.5 mm round file with a file holder.

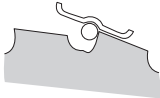

- The filing angle is 15°. File alternate teeth to the right and those in between to the left. If the blade has been heavily pitted by stones it may be necessary to dress the top edges of the teeth with a flat file, in exceptional cases. If so, this should be done before filing with a

round file. The top edges must be filed down by the same amount for all the teeth.

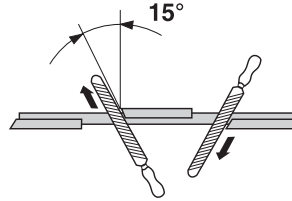

- Adjust the blade setting. This should be 1 mm.

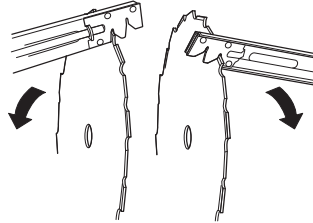

Trimmer head

IMPORTANT!

Always ensure the trimmer cord is wound tightly and evenly around the drum, otherwise the machine will generate harmful vibration.

- Only use the recommended trimmer heads and trimmer cords. These have been tested by the manufacturer to suit a particular engine size. This is especially important when a fully automatic trimmer head is used. Only use the recommended cutting attachment. See the chapter on Technical data.



- Smaller machines generally require small trimmer heads and vice versa. This is because when clearing using a cord the engine must throw out the cord radially from the trimmer head and overcome the resistance of the grass being cleared.
- The length of the cord is also important. A longer cord requires greater engine power than a shorter cord of the same diameter.
- Make sure that the cutter on the trimmer guard is intact. This is used to cut the cord to the correct length.
- To increase the life of the cord it can be soaked in water for a couple of days before use. This will make the cord tougher so that it lasts longer.

ASSEMBLY

Assembling the handlebar and throttle



- Fit the handlebar in the handlebar clamp on the shaft using four screws.

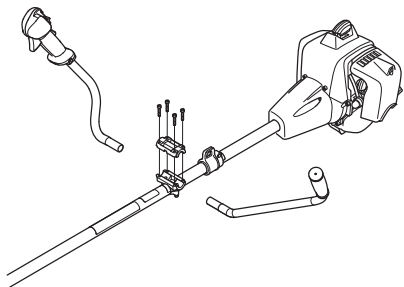

Fitting blades and trimmer heads



WARNING!

When fitting the cutting attachment it is extremely important that the raised section on the drive disc/support flange engages correctly in the centre hole of the cutting attachment. If the cutting attachment is fitted incorrectly it can result in serious and/or fatal personal injury.

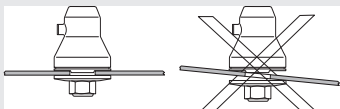

WARNING! Never use a cutting attachment without an approved guard. See the chapter on Technical data. If an incorrect or faulty guard is fitted this can cause serious personal injury.

IMPORTANT! If a saw blade or grass blade are to be used the machine must be equipped with the correct handlebar, blade guard and harness.

Fitting the trimmer guard and trimmer head



- Fit the correct trimmer guard (A) for use with the trimmer head.
- Fit the guard as shown in the diagram. Tighten securely.

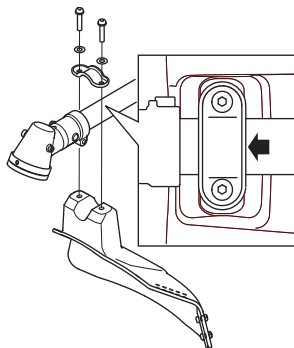

- Position the trimmer guard beside the arrow mark.
- Fit the drive disc (B) and support flange (C) on the output shaft.
- Turn the output shaft until one of the holes in the drive disc aligns with the corresponding hole in the gear housing.
- Insert the locking pin into the hole to lock the shaft.
- Turn the trimmer head counterclockwise when installing.

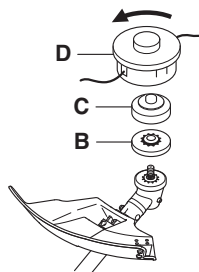

- To dismantle, follow the instructions in the reverse order.

ASSEMBLY

Fitting a blade guard, grass blade and grass cutter



- Fit the guard as shown in the diagram. Tighten securely.

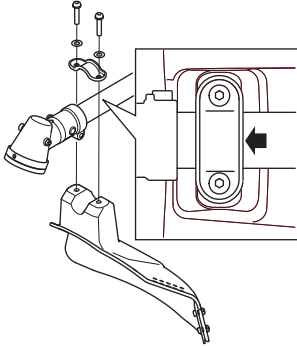

- Position the trimmer guard beside the arrow mark.
- Fit the drive disc (B) on the output shaft.
- Turn the output shaft until one of the holes in the drive disc aligns with the corresponding hole in the gear housing.
- Insert the locking pin (C) in the hole to lock the shaft.
- Place the blade (D), support cup (E) and support flange (F) on the output shaft.
- Fit the nut (G). The nut must be tightened to a torque of 35-50 Nm (3.5-5 kpm). Use the spanner in the tool kit. Hold the shaft of the spanner as close to the blade guard as possible. To tighten the nut, turn the spanner

in the opposite direction to the direction of rotation (Caution! left-hand thread).

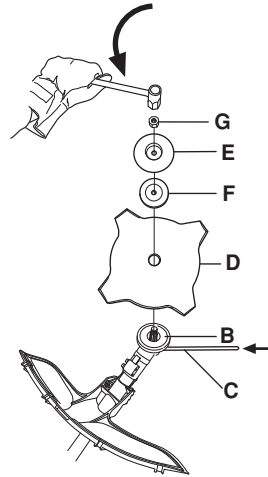

FUEL HANDLING

Fuel safety

Never start the machine:

- 1 If you have spilled fuel on it. Wipe off the spillage and allow remaining fuel to evaporate.
- 2 If you have spilled fuel on yourself or your clothes, change your clothes. Wash any part of your body that has come in contact with fuel. Use soap and water.
- 3 If the machine is leaking fuel. Check regularly for leaks from the fuel cap and fuel lines.

Transport and storage

- Store and transport the machine and fuel so that there is no risk of any leakage or fumes coming into contact with sparks or open flames, for example, from electrical machinery, electric motors, electrical relays/ switches or boilers.
- When storing and transporting fuel always use approved containers intended for this purpose.
- When storing the machine for long periods the fuel tank must be emptied. Contact your local petrol station to find out where to dispose of excess fuel.
- Ensure the machine is cleaned and that a complete service is carried out before long-term storage.
- The transport guard must always be fitted to the cutting attachment when the machine is being transported or in storage.
- Secure the machine during transport.
- In order to prevent unintentional starting of the engine, the spark plug cap must always be removed during long-term storage, if the machine is not under close supervision and when performing all service measures.



WARNING! Take care when handling fuel. Bear in mind the risk of fire, explosion and inhaling fumes.

Fuel

CAUTION! The machine is equipped with a two-stroke engine and must always be run using a mixture of petrol and two-stroke oil. It is important to accurately measure the amount of oil to be mixed to ensure that the correct mixture is obtained. When mixing small amounts of fuel, even small inaccuracies can drastically affect the ratio of the mixture.



WARNING! Fuel and fuel fumes are highly inflammable and can cause serious injury when inhaled or allowed to come in contact with the skin. For this reason observe caution when handling fuel and make sure there is adequate ventilation.

Petrol



CAUTION! Always use a quality petrol/oil mixture at least 90 octane (RON). If your machine is equipped with a catalytic converter (see chapter on Technical data) always use a good quality unleaded petrol/oil mixture. Leaded petrol will destroy the catalytic converter.

Use low-emission petrol, also known as alkylate petrol, if it is available.



- The lowest octane recommended is 90 (RON). If you run the engine on a lower octane grade than 90 so-called knocking can occur. This gives rise to a high engine temperature, which can result in serious engine damage.
- When working at continuous high revs a higher octane rating is recommended.

Two-stroke oil

- For best results and performance use HUSQVARNA two-stroke engine oil, which is specially formulated for our air-cooled two-stroke engines.
- Never use two-stroke oil intended for water-cooled engines, sometimes referred to as outboard oil (rated TCW).
- Never use oil intended for four-stroke engines.
- A poor oil quality and/or too high oil/fuel ratio may jeopardise function and decrease the life time of catalytic converters.
- Mixing ratio
 - 1:50 (2%) with HUSQVARNA two-stroke oil.
 - 1:33 (3%) with oils class JASO FB or ISO EGB formulated for air-cooled, two-stroke engines.

Petrol, litre	Two-stroke oil, litre	
	2% (1:50)	3% (1:33)
5	0,10	0,15
10	0,20	0,30
15	0,30	0,45
20	0,40	0,60

FUEL HANDLING

Mixing

- Always mix the petrol and oil in a clean container intended for fuel.
- Always start by filling half the amount of the petrol to be used. Then add the entire amount of oil. Mix (shake) the fuel mixture. Add the remaining amount of petrol.
- Mix (shake) the fuel mixture thoroughly before filling the machine's fuel tank.

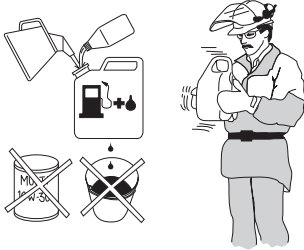

- Do not mix more than one month's supply of fuel at a time.
- If the machine is not used for some time the fuel tank should be emptied and cleaned.

Fueling



WARNING! Taking the following precautions, will lessen the risk of fire:

Do not smoke or place hot objects near fuel.

Always shut off the engine before refuelling.

Always stop the engine and let it cool for a few minutes before refuelling.

When refuelling, open the fuel cap slowly so that any excess pressure is released gently.

Tighten the fuel cap carefully after refuelling.

Always move the machine away from the refuelling area and source before starting.

- Always use a fuel container with an anti-spill valve.
- Clean the area around the fuel cap. Contamination in the tank can cause operating problems.

- Ensure that the fuel is well mixed by shaking the container before filling the tank.

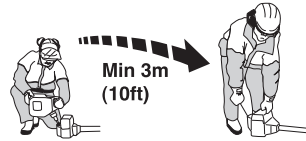

STARTING AND STOPPING

Check before starting



- Check the blade to ensure that no cracks have formed at the bottom of the teeth or by the centre hole. The most common reason why cracks are formed is that sharp corners have been formed at the bottom of the teeth while sharpening or that the blade has been used with dull teeth. Discard a blade if cracks are found.

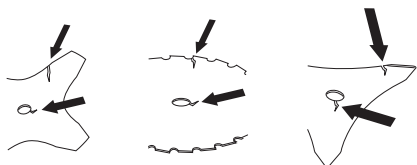

- Check that the support flange is not cracked due to fatigue or due to being tightened too much. Discard the support flange if it is cracked.

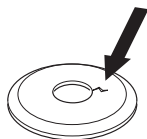

- Ensure the locking nut has not lost its captive force. The nut lock should have a locking force of at least 1.5 Nm. The tightening torque of the locking nut should be 35-50 Nm.



- Check that the blade guard is not damaged or cracked. Replace the blade guard if it is exposed to impact or is cracked.

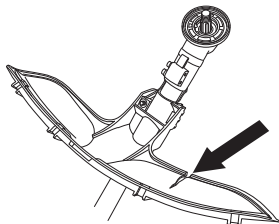

- Check that the trimmer head and trimmer guard are not damaged or cracked. Replace the trimmer head or

trimmer guard if they have been exposed to impact or are cracked.

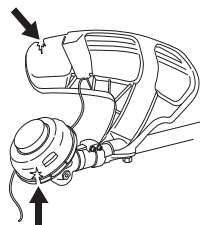

- Never use the machine without a guard nor with a defective guard.
- All covers must be correctly fitted and undamaged before you start the machine.

Starting and stopping



WARNING! The complete clutch cover and shaft must be fitted before the machine is started, otherwise the clutch can come loose and cause personal injury.

Always move the machine away from the refuelling area and source before starting. Place the machine on a flat surface. Ensure the cutting attachment cannot come into contact with any object.

Make sure no unauthorised persons are in the working area. Otherwise there is a risk of serious personal injury. The safety distance is 15 meters.

Starting



Ignition: Set the stop switch to the start position.

Choke: Set the choke control in the choke position.

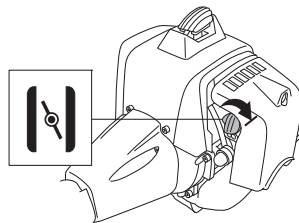

STARTING AND STOPPING

Primer bulb: Press the air purge repeatedly until fuel begins to fill the bulb. The bulb need not be completely filled.

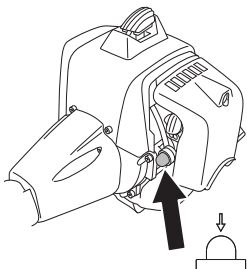

WARNING! When the engine is started with the choke in either the choke or start throttle positions the cutting attachment will start to rotate immediately.

Hold the body of the machine on the ground using your left hand (CAUTION! Not with your foot!). Grip the starter handle, slowly pull out the cord with your right hand until you feel some resistance (the starter pawls grip), now quickly and powerfully pull the cord. **Never twist the starter cord around your hand.**

Repeat pulling the cord until the engine starts. When the engine starts, return choke control to run position and apply full throttle; the throttle will automatically disengage from the start setting.

CAUTION! Do not pull the starter cord all the way out and do not let go of the starter handle when the cord is fully extended. This can damage the machine.



CAUTION! Do not put any part of your body in marked area. Contact can result in burns to the skin, or electrical shock if the spark plug cap has been damaged. Always

use gloves. Do not use a machine with damaged spark plug cap.

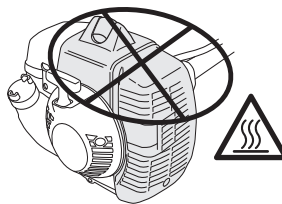

Throttle settings control

Move the throttle to the idle position.

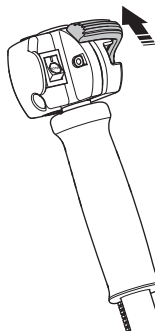

Stopping



Stop the engine by switching off the ignition.

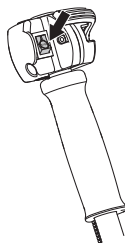

CAUTION! Stop the engine by switching off the ignition.

WORKING TECHNIQUES

General working instructions

IMPORTANT!

This section describes the basic safety precautions for working with brush cutters and trimmers.

If you encounter a situation where you are uncertain how to proceed you should ask an expert. Contact your dealer or your service workshop.

Avoid all usage which you consider to be beyond your capability.

You must understand the difference between forestry clearing, grass clearing and grass trimming before use.

Basic safety rules



- 1 Look around you:
 - To ensure that people, animals or other things cannot affect your control of the machine.
 - To ensure that people, animals, etc., do not come into contact with the cutting attachment or loose objects that are thrown out by the cutting attachment.
 - **CAUTION!** Do not use the machine unless you are able to call for help in the event of an accident.
- 2 Inspect the working area. Remove all loose objects, such as stones, broken glass, nails, steel wire, string, etc. that could be thrown out or become wrapped around the cutting attachment.
- 3 Do not use the machine in bad weather, such as dense fog, heavy rain, strong wind, intense cold, etc. Working in bad weather is tiring and often brings added risks, such as icy ground, unpredictable felling direction, etc.
- 4 Make sure you can move and stand safely. Check the area around you for possible obstacles (roots, rocks, branches, ditches, etc.) in case you have to move suddenly. Take great care when working on sloping ground.



- 5 Take great care when cutting a tree that is in tension. A tree that is in tension may spring back to its normal position before or after being cut. If you position

yourself incorrectly or make the cut in the wrong place the tree may hit you or the machine and cause you to lose control. Both situations can cause serious personal injury.

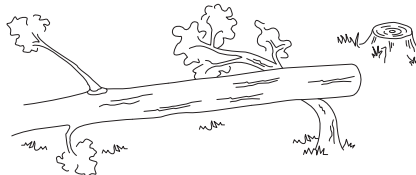

- 6 Keep a good balance and a firm foothold. Do not overreach. Keep proper footing and balance at all times.
- 7 Always hold the machine with both hands. Hold the machine on the right side of your body. Keep all parts of your body away from the hot surfaces. Keep all parts of your body away from the rotating cutting attachment.



- 8 When using a brush cutter it must always be hooked securely to the harness. Otherwise you will be unable to control the brush cutter safely and this can result in injury to yourself or others. Never use a harness with a defective quick release.
- 9 Keep the cutting attachment below waist level.
- 10 Switch off the engine before moving to another area. Fit the transport guard before carrying or transporting the equipment any distance.
- 11 Never put the machine down with the engine running unless you have it in clear sight.

WORKING TECHNIQUES



WARNING! Neither the operator of the machine nor anyone else may attempt to remove the cut material while the engine is running or the cutting equipment is rotating, as this can result in serious injury.

Stop the engine and cutting equipment before you remove material that has wound around the blade shaft as otherwise there is a risk of injury. The bevel gear can get hot during use and may remain so for a while afterwards. You could get burnt if you touch it.



WARNING! Watch out for thrown objects. Always wear approved eye protection. Never lean over the cutting attachment guard. Stones, rubbish, etc. can be thrown up into the eyes causing blindness or serious injury.

Keep unauthorised persons at a distance. Children, animals, onlookers and helpers should be kept outside the safety zone of 15 metres. Stop the machine immediately if anyone approaches. Never swing the machine around without first checking behind you to make sure no-one is within the safety zone.



WARNING! Sometimes branches or grass get caught between the guard and cutting attachment. Always stop the engine before cleaning.

Working methods



WARNING! Machines fitted with saw blades or grass blades can be thrown violently to the side when the blade comes into contact with a fixed object. This is called blade thrust. A blade thrust can be violent enough to cause the machine and/or operator to be propelled in any direction, and possibly lose control of the machine. Blade thrust can occur without warning if the machine snags, stalls or binds. Blade thrust is more likely to occur in areas where it is difficult to see the material being cut.

Avoid cutting with the area of the blade between the 12 o'clock and 3 o'clock positions. Because of the speed of rotation of the blade, blade thrust can occur if you attempt to cut thick stems with this area of the blade.

- Before you start clearing, check the clearing area, the type of terrain, the slope of the ground, whether there are stones, hollows etc.
- Start at whichever end of the area is easiest, and clear an open space from which to work.
- Work systematically to and fro across the area, clearing a width of around 4-5 m on each pass. This exploits the full reach of the machine in both directions and gives the operator a convenient and varied working area to work in.

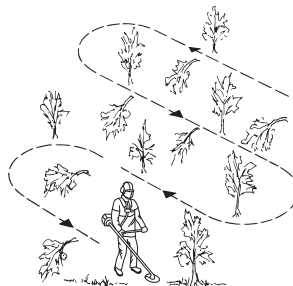

- Clear a strip around 75 m long. Move your fuel can as work progresses.
- On sloping ground you should work along the slope. It is much easier to work along a slope than it is to work up and down it.
- You should plan the strip so that you avoid going over ditches or other obstacles on the ground. You should also orient the strip to take advantage of wind

WORKING TECHNIQUES

conditions, so that cleared stems fall in the cleared area of the stand.

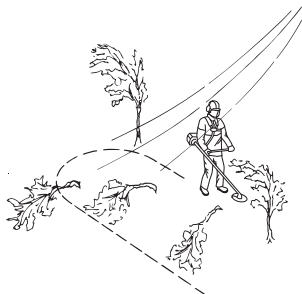

Grass clearing using a grass blade



- Grass blades and grass knives must not be used on woody stems.
- A grass blade is used for all types of tall or coarse grass.
- The grass is cut down with a sideways, swinging movement, where the movement from right-to-left is the clearing stroke and the movement from left-to-right is the return stroke. Let the left-hand side of the blade (between 8 and 12 o'clock) do the cutting.

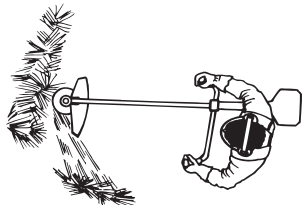

- If the blade is angled to the left when clearing grass, the grass will collect in a line, which makes it easier to collect, e.g. by raking.
- Try to work rhythmically. Stand firmly with your feet apart. Move forward after the return stroke and stand firmly again.
- Let the support cup rest lightly against the ground. It is used to protect the blade from hitting the ground.
- Reduce the risk of material wrapping around the blade by following these instructions:
 - 1 Always work at full throttle.
 - 2 Avoid the previously cut material during the return stroke.
- Stop the engine, unclip the harness and place the machine on the ground before you start to collect the cut material.

Grass trimming with a trimmer head



Trimming

- Hold the trimmer head just above the ground at an angle. It is the end of the cord that does the work. Let the cord work at its own pace. Never press the cord into the area to be cut.



- The cord can easily remove grass and weeds up against walls, fences, trees and borders. However it can also damage sensitive bark on trees and bushes, and damage fence posts.
- Reduce the risk of damaging plants by shortening the cord to 10-12 cm and reducing the engine speed.

Clearing

- The clearing technique removes all unwanted vegetation. Keep the trimmer head just above the ground and tilt it. Let the end of the cord strike the ground around trees, posts, statues and the like. CAUTION! This technique increases the wear on the cord.



- The cord wears quicker and must be fed forward more often when working against stones, brick, concrete, metal fences, etc., than when coming into contact with trees and wooden fences.
- When trimming and clearing, you should use less than full throttle (80%) so that the cord lasts longer and to reduce the wear on the trimmer head.

Cutting

- The trimmer is ideal for cutting grass that is difficult to reach using a normal lawn mower. Keep the cord parallel to the ground when cutting. Avoid pressing the trimmer head against the ground as this can ruin the lawn and damage the tool.

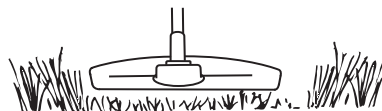

WORKING TECHNIQUES

- Do not allow the trimmer head to constantly come into contact with the ground during normal cutting. Constant contact of this type can cause damage and wear to the trimmer head.

Sweeping

- The fan effect of the rotating cord can be used for quick and easy clearing up. Hold the cord parallel to and above the area to be swept and move the tool side to side.

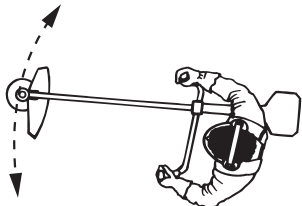

- When cutting and sweeping you should use full throttle to obtain the best results.

MAINTENANCE

Carburettor

Adjusting the idle speed (T)

Check that the air filter is clean. When the idle speed is correct, the cutting attachment should not rotate. If adjustment is required, close (turn clockwise) the idle adjustment screw T, with the engine running, until the cutting attachment starts to rotate. Open (turn anticlockwise) the screw until the cutting attachment stops. The idle speed is correctly set when the engine runs smoothly in all positions, and there is a clear margin to the speed at which the cutting attachment starts to rotate.

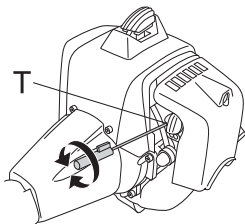

WARNING! If the idle speed cannot be adjusted so that the cutting attachment stops, contact your dealer/service workshop. Do not use the machine until it has been correctly adjusted or repaired.

Air filter

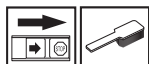

The air filter must be regularly cleaned to remove dust and dirt in order to avoid:

- Carburettor malfunctions.
- Starting problems.
- Loss of engine power.
- Unnecessary wear to engine parts.

- Excessive fuel consumption.

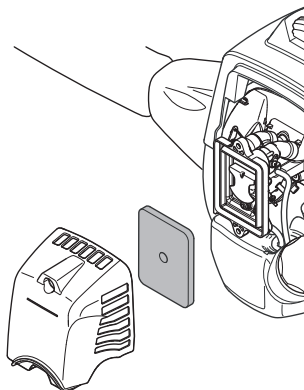

Clean the filter every 25 hours, or more regularly if conditions are exceptionally dusty.

Cleaning the air filter

Remove the air filter cover and take out the filter. Wash it clean in warm, soapy water. Clean also the inside of the filter cover by using air or a brush.

Allow the filter to dry and then oil it in according to the instructions.

Put the filter in a plastic bag and pour the filter oil over it. Knead the plastic bag to distribute the oil. Squeeze the excess oil out of the filter inside the plastic bag and pour off the excess before fitting the filter to the machine.

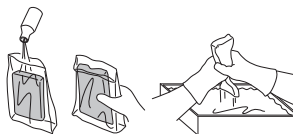

Never use oil intended for four-stroke engines. Never use gasoline, oil or any gasoline mixture!

An air filter that has been in use for a long time cannot be cleaned completely. The filter must therefore be replaced with a new one at regular intervals. **A damaged air filter must always be replaced.**

After cleaning the foam plastic filter needs to be oiled. See instructions under the heading Oiling the foam plastic filter.

MAINTENANCE

Fuel filter

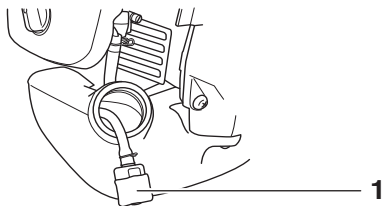

1 Fuel filter

When the engine runs short of fuel supply, check the fuel cap and the fuel filter for blockage.

Bevel gear



The bevel gear is filled with the right quantity of grease at the factory. However, before using the machine you should check that the bevel gear is filled three-quarters full with grease. Use HUSQVARNA special grease.

The grease in the bevel gear does not normally need to be changed except if repairs are carried out.

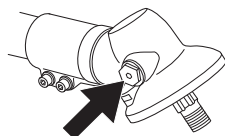

Spark plug



The spark plug condition is influenced by:

- Incorrect carburettor adjustment.
- An incorrect fuel mixture (too much or incorrect type of oil).
- A dirty air filter.

These factors cause deposits on the spark plug electrodes, which may result in operating problems and starting difficulties.

If the machine is low on power, difficult to start or runs poorly at idle speed: always check the spark plug first before taking any further action. If the spark plug is dirty, clean it and check that the electrode gap is 0,9-1,0 mm.

The spark plug should be replaced after about a month in operation or earlier if necessary.

0,9 - 1,0 mm

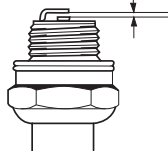

CAUTION! Always use the recommended spark plug type! Use of the wrong spark plug can damage the piston/cylinder. Check that the spark plug is fitted with a suppressor.

MAINTENANCE

Maintenance schedule

The following is a list of the maintenance steps that must be performed on the machine. Most of the items are described in the Maintenance section. The user must only carry out the maintenance and service work described in this Operator's Manual. More extensive work must be carried out by an authorized service workshop.

Maintenance	Daily maintenance	Weekly maintenance	Monthly maintenance
Clean the outside of the machine.	X		
Check that the harness is not damaged.	X		
Make sure the throttle trigger lock and the throttle function correctly from a safety point of view.	X		
Check that the handle and handlebar are undamaged and secured correctly.	X		
Check that the stop switch works correctly.	X		
Check that the cutting attachment does not rotate at idle.	X		
Clean the air filter. Replace if necessary.	X		
Check that the guard is undamaged and not cracked. Replace the guard if it has been exposed to impact or is cracked.	X		
Check that the blade is correctly centred, is sharp, and is not cracked. An off-centre blade will cause vibration that could result in damage to the machine.	X		
Check that the trimmer head is undamaged and not cracked. Replace the trimmer head if necessary.	X		
Check that the locking nut of the cutting equipment is tighten correctly.	X		
Check that the transport guard for the blade is intact and that it can be secured correctly.	X		
Check that nuts and screws are tight.	X		
Check that there are no fuel leaks from the engine, tank or fuel lines.	X		
Check the starter and starter cord.		X	
Clean the outside of the spark plug. Remove it and check the electrode gap. Adjust the gap to 0,6-0,7 mm or replace the spark plug. Check that the spark plug is fitted with a suppressor.		X	
Clean the outside of the carburettor and the space around it.		X	
Check that the bevel gear is filled three-quarters full with lubricant. Fill if necessary using special grease.		X	
Check the fuel filter for contamination and the fuel hose for cracks or other defects. Replace if necessary.			X
Check all cables and connections.			X
Replace the spark plug. Check that the spark plug is fitted with a suppressor.			X

TECHNICAL DATA

Technical data

Technical data **543RS**

Engine

Cylinder displacement, cm ³	40,1
Cylinder bore, mm	40,5
Stroke, mm	31,1
Idle speed, rpm	3000
Recommended max. speed, rpm	12000
Speed of output shaft, rpm	8570
Max. engine output, acc. to ISO 8893, kW/ rpm	1,5/9000

Ignition system

Spark plug	NGK CMR7H-10
Electrode gap, mm	0,9-1,0

Fuel and lubrication system

Fuel tank capacity, litre	0,75
---------------------------	------

Weight

Weight without fuel, cutting attachment and guard, kg	7,2
---	-----

Noise levels

(see note 1)

Equivalent sound pressure level at the operator's ear, measured according to EN ISO 11806 and ISO 22868, dB(A): 95

Vibration levels

(see note 2)

Equivalent vibration levels ($a_{hv,eq}$) at handles, measured according to EN ISO 11806 and ISO 22867, m/s²

Equipped with trimmer head (original), left/right	6,3/4,9
---	---------

Note 1 Reported data for equivalent sound pressure level for the machine has a typical statistical dispersion (standard deviation) of 1 dB (A).

Note 2: Reported data for equivalent vibration level has a typical statistical dispersion (standard deviation) of 1 m/s².

543RS		
Approved accessories	Type	Cutting attachment guard, Art. no.
Grass blade/grass cutter	Grass 255-4 1" (Ø 255 4-teeth)	584 40 43-01
	Multi 255-3 (Ø 255 3 teeth)	584 40 43-01
	Grass 275-4 (Ø 275 4 teeth)	584 40 43-01
Plastic blades	Tricut Ø 300 mm (Separate blades have part number 531 01 77-15)	584 40 43-01
Trimmer head	Superauto II	584 40 43-01
	T35, T35x (Ø 2.4 - 3.0 mm cord)	584 40 43-01
	T45x (Ø 2.7 - 3.3 mm cord)	584 40 43-01
	F35 (Ø 2.0 - 3.5 mm cord)	584 40 43-01
	PT104	584 40 43-01
Support cup	Fixed	-

符号说明

符号

警告！清理锯、割灌机或打草机如果使用不当或疏忽会十分危险，可能导致操作员或周围人严重受伤甚至死亡。阅读并且理解本《操作手册》的内容极其重要。



请认真阅读本操作手册，确保在充分理解各项说明之后再使用机器。

请务必配戴：

- 保护头盔（在有物体掉落风险的情况下）
- 经检验合格的听觉保护设备
- 经检验合格的眼部保护设备



输出轴最大速度 (rpm)



注意抛掷物和弹起物。



机器操作员必须确保作业过程中15米范围内无任何人员或动物。



装有锯片或打草刀片的机器在锯片或刀片接触固定物体会猛地甩向一侧。这称为甩刀。锯片或刀片能切断手臂或腿部。务必让人员和动物距离机器至少15米远。



用于指示手柄位置调节止点的箭头。



务必戴上检验合格的保护手套。



穿上坚固的防滑靴。



阻气门：将风门设在阻风位置。



注油泵

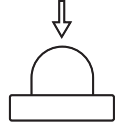

有关机器上的其他符号/标识，请参考适用于特定市场的特殊认证要求。

进行任何检查或者维护之前，请将停止开关扳到 STOP（停止）位置以关闭引擎。

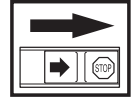

务必戴上检验合格的保护手套。

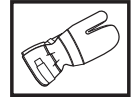

必须经常清洗。

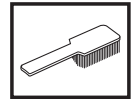

视检。



务必使用检验合格的眼部保护设备。



目录

目录

符号说明	
符号	26
目录	
目录	27
启动前应注意以下事项:	27
引言	
尊敬的客户:	28
构造图示说明	
割灌机构造图示说明	29
一般安全须知	
重要事项	30
个人防护装备	30
机器安全设备	31
切割设备	33
组装	
组装手柄杆和油门	36
安装锯片和打草头	36
燃油处理	
燃油安全须知	38
燃油	38
加燃油	39
启动与停止	
启动前检查	40
启动与停止	40
操作方法	
一般工作须知	42
维护	
化油器	46
空气滤清器	46
燃油滤清器	47
斜齿轮	47
火花塞	47
维护计划	48
技术参数	
技术参数	49



引言

尊敬的客户：

感谢您选购 Husqvarna 产品！Husqvarna 的历史可以追溯到 1689 年，当时瑞典国王查尔斯十一世下令在 HusqvarnaRiver 的河岸上开办一家火枪生产厂。选择这一地点非常合理，这是因为当时利用 HuskvarnaRiver 中的水力来建立水力发电厂。在 300 多年的成长过程中，Husqvarna 工厂生产出了许多不同的产品，从木炉到现代化厨房用品、缝纫机、自行车、摩托车等等。1956 年，第一台电机驱动除草机问世，随后于 1959 年链锯诞生，这就是 Husqvarna 如今所从事的领域。

如今，Husqvarna 已经成为世界上领先的园林产品生产商之一，公司极为重视产品质量。公司的商业理念为：为园林与建筑行业开发、生产与提供电机驱动产品。此外，Husqvarna 的目标是在人体工程学、使用性、安全性及环保方面居于领先地位。这就是我们为这些领域中的产品开发许多不同功能的原因所在。

我们相信，在相当长一段时间之后，您会对我们产品的质量与性能高度满意。购买我们的任意产品，您都将随时获得专业的维修和保养帮助。如果出售本机的零售商不是我们的授权经销商，应咨询离您最近的保养厂的地址。

希望我们的产品让您称心如意并与您长期相伴。请将本操作手册视为重要文档。遵照其中的内容（使用、维修、维护等），机器的使用寿命及转让时的价值都将大大提高。出售本机时，请确保将操作手册转交买家。

非常感谢您使用 Husqvarna 产品。

连续开发产品是 HusqvarnaAB 的政策，因此拥有保留修改产品设计和外观的权利，而无需事先通知。

构造图示说明

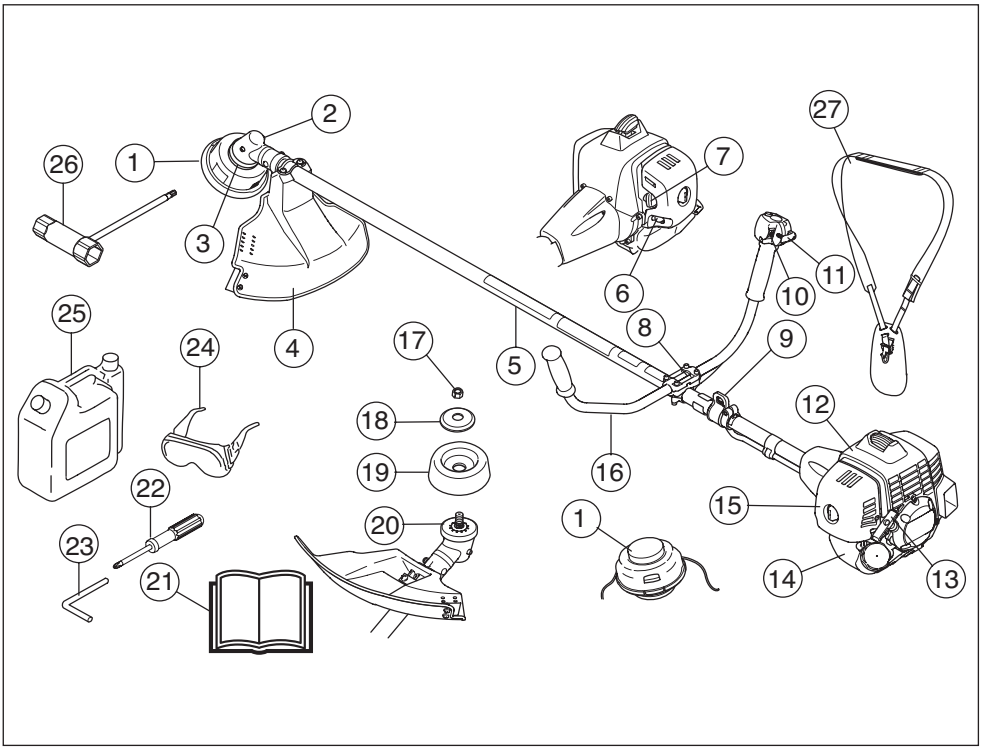

割灌机构造图示说明

- | | |
|---------------|-----------------|
| 1 打草头 | 15 空气滤清器外壳 |
| 2 润滑脂加油口盖、斜齿轮 | 16 手柄杆 |
| 3 斜齿轮 | 17 锁紧螺母 |
| 4 切割锯片防护罩 | 18 支撑凸缘 |
| 5 刀轴 | 19 支撑杯 |
| 6 注油泵 | 20 驱动盘 |
| 7 阻气门开关 | 21 操作手册 |
| 8 手柄杆卡箍 | 22 螺丝起子 |
| 9 吊环 | 23 锁紧销 |
| 10 停止开关 | 24 经检验合格的眼部保护设备 |
| 11 油门扳机 | 25 水箱 |
| 12 气缸罩 | 26 套筒扳手 |
| 13 启动器把手 | 27 背带 |
| 14 燃油箱 | |

一般安全须知

启动前应注意以下事项:

请仔细阅读操作手册。



警告！长期接触噪音会导致永久性听力损伤。因此，请务必佩戴检验合格的听觉保护设备。



警告！任何情况下，未经制造厂的许可，不得修改本机的设计。必须使用原厂零件。未经许可擅自修改，或使用未经认可的零件，可能会对操作员或其他人员造成严重的伤害或死亡。



警告！清理锯、割灌机或打草机如果使用不当或疏忽会十分危险，可能导致操作员或周围人严重受伤甚至死亡。阅读并且理解本《操作手册》的内容极其重要。



警告！本机在操作期间会产生电磁场。电磁场在某些情况下会干扰有源或无源医疗植入体。为了减少严重或致命性伤害风险，我们建议使用医疗植入体的人员在操作本机之前事先咨询其医生及医疗植入体制造商。



警告！如果引擎在空间狭窄或通风不良的区域内运转，会导致相关人员窒息死亡或一氧化碳中毒身亡。



警告！切勿允许儿童使用或靠近机器。由于机器设有加载弹簧的停止开关，慢速在启动器把手上施力即可启动，有时甚至连儿童也有足够大的力气启动机器。这就有可能造成严重的人员伤亡。因此，机器在没有严密监督的情况下要拔掉火花塞帽子。

重要事项

重要事项！

本机仅设计用于修剪草。

我们在“技术参数”章节推荐的切割锯片是您可使用此引擎装置操作的唯一附件。

感到疲劳、曾经饮酒，或曾服用影响视力、判断力或协调能力的药物时，请勿操作本机。

请使用个人防护装备。请参阅“个人防护装备”一节的说明。

绝不能使用曾对原规格进行任何改动的机器。

禁止使用有故障的机器。按照本手册中的说明进行安全检查、维护和保养。部分维护和保养措施必须由受过培训并有相应资质的专家进行。请参阅《维护》篇中的说明。

启动前必须先安装好所有的护盖、防护罩和手柄。确保火花塞线帽和点火器导线未受损，以免出现电击风险。

在作业过程中，机器操作员必须确保15米范围内无任何人员或动物。当多名操作员在同一场所工作时，之间应保持至少15米的安全距离。

使用前应对机器进行全面检查。请参阅维护时间表。

个人防护装备

重要事项！

打草机如果使用不当或疏忽会十分危险，可能导致操作员或周围人严重受伤甚至死亡。阅读并且理解本《操作手册》的内容极其重要。

使用本机时，一定要使用经过批准的个人防护装备。个人防护装备不能避免受伤，但当意外发生时，可降低伤害程度。选择防护装备时，请向经销商查询。



警告！戴有听觉保护设备时，请留意警告信号或呼喊声。一旦引擎停机，便取下听觉保护设备。

安全头盔

保护头盔（在有物体掉落风险的情况下）



听觉保护设备

佩戴听觉保护设备，尽量降低噪音。



一般安全须知

眼部防护装备

始终佩戴经检验合格的眼部保护设备。如果使用面罩，必须同时配戴经检验合格的护目镜。在美国，经检验合格的护目镜必须符合 ANSI Z87.1 标准；在欧盟国家/地区，必须符合 EN166。



手套

必要时应戴上手套，比如安装切割锯片时。



靴子

穿上坚固的防滑靴。



防护服

穿上用高强度纤维制成的衣物，避免穿着可能钩住小树枝和分支的衣物。务必穿上布料结实的长裤。不要佩戴首饰，不要穿短裤、凉鞋或者赤脚。将头发固定在肩部以上。

急救箱

附近应备有急救箱。



机器安全设备

本节将介绍机器的安全装备及其用途，并介绍如何进行检查和维护以确保机器的正常运转。请参阅《构造图示说明》部分，可找到此种安全设备的正确位置。

如果机器维护不当或由非专业人士进行保养和/或维修，机器的使用寿命会缩短，发生意外的风险会增加。欲知更多详情，请与最近的保养厂联络。

重要事项！

本机的保养和维修必须经过专门培训。对于本机的安全设备来说尤其如此。如果在检修过程中出现下述的故障，应与保养厂联络。如果您购买我们的产品，我们承诺提供专业的修理和保养。如果出售本机的零售商不是保养商，应向他咨询离您最近的保养厂的地址。



警告！不得使用安全设备存在故障的机器。机器的安全设备必须按照本节说明进行检查和维护。如果您的机器未通过这些检查中的任何一项，请联系您的保养厂对其进行维修。

启动

请参阅“启动”一节的说明。启动机器，全开油门。松开油门，检查切割锯片是否停止并保持不动。如果油门处于怠速位置而切割锯片仍然旋转，则要检查化油器的怠速设定。请参阅《维护》篇的说明。

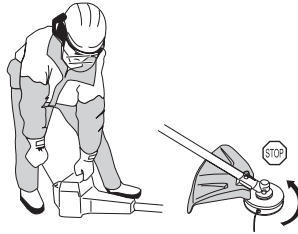

停止开关

使用停止开关关闭引擎。

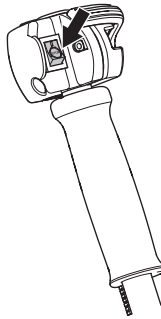

启动引擎，确保引擎在停止开关移到停止位置时停下来。

一般安全须知

切割锯片防护罩



此防护罩用来防止松散物体飞溅伤害到操作员。防护罩还可以防止操作员意外接触切割锯片。

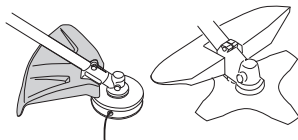

检查并确保防护罩没有损坏或裂痕。如果防护罩受到碰撞或有裂痕，请予以更换。

务必为您使用的切割锯片采用推荐的防护罩。请参阅“技术参数”章节。



警告！严禁在未安装经检验合格的安全罩的情况下操作切割锯片。请参阅“技术参数”章节。安装不恰当规格或破损的安全罩会导致严重的人身伤害。

减振系统



本机配备有减振系统，用于尽量减少振动，并使操作更简单。

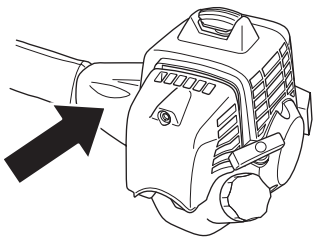

使用缠绕不当的拉绳或错误的切割锯片会增加振级。请参阅“切割设备”一节的说明。

本机的减振系统能降低引擎装置/切割设备以及机器把手之间的振动传递。

定期检查减振装置是否出现裂纹或变形。检查确保减震垫无损坏且安装牢固。



警告！ 血液循环不佳的人受到过度振动时，可能会导致循环系统或神经伤害。如果您因过度振动而引起以下症状，请自行就医。这些症状包括：麻木、失去知觉、麻刺、刺痛、疼痛、虚弱、肤色或皮肤状况发生变化。这些症状通常出现在手指、双手或手腕上。

消音器



消音器设计用于最大程度地降低噪音并将引擎的废气导离操作人员。装有催化转换器的消音器还具有减少有害废气的作用。

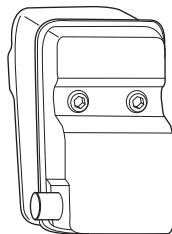

切勿使用消音器出现故障的机器。



一般安全须知

定期检查消音器是否牢固安装在机器上。

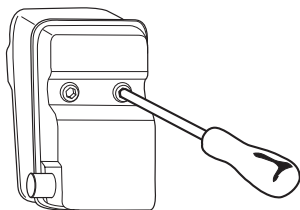

警告！装有催化转换器的消音器和排气管在使用过程中会变得非常热，并且在停止后仍保持一段时间。怠速时同样如此。接触会灼伤皮肤。注意火灾危险！



警告！消音器内含可致癌的化学物质。消音器出现故障时，务必避免接触这些物质。



警告！引擎的废气很热，并可能带有火花，从而引发火灾。切勿在室内或易燃材料附近操作本机！

锁紧螺母

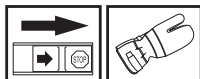

锁紧螺母用于固定某些类型的切割锯片。

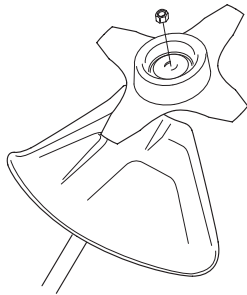

进行安装时，按照与切割锯片旋转方向相反的方向拧紧螺母。拆卸时，按照与切割锯片旋转方向相同的方向松开螺母。（小心！螺母为左旋螺纹。）

松开和拧紧锯片螺母时，锯片齿可能会导致伤害。因此在进行此操作时，应始终确保通过锯片防护罩保护手部。务必使用柄部长度足以进行此操作的套筒扳手。图中箭头显示了在松开或拧紧螺母时套筒扳手的操作区域。

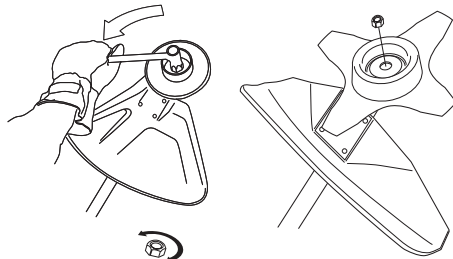

锁紧螺母内的尼龙衬垫不得磨损到您可以用手转动螺母的程度。衬垫应提供至少 1.5Nm 的阻力。当螺母的安装次数达到 10 次左右后，应更换该螺母。

切割设备

本节介绍选择与维修您切割设备的方法，从而：

- 降低甩刀风险。
- 获得最大锯切性能。
- 延长切割设备的使用寿命。

重要事项！

仅使用我们推荐的带防护罩的切割锯片！请参阅“技术参数”章节。

请参阅切割锯片的说明，以了解有关正确装载拉绳以及适当拉绳直径的信息。

确保正确打磨锯片齿！请按照我们的建议操作。另请参阅锯片包装上的说明。

请保持正确的锯片设置！请按照我们的说明使用推荐的扁锉规。



警告！在对切割锯片执行任何操作之前，务必先停止运行发动机。即使释放了油门的情况下也会继续转动。开始对锯片进行操作之前，确保切割锯片完全停止，并断开火花塞帽。



警告！使用错误的切割锯片或打磨不当的锯片会增加甩刀风险。

一般安全须知

切割设备

锯片适合用于切割纤维质木材。

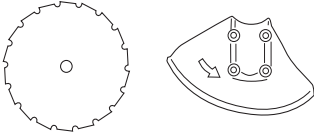

打草刀片和割草刀适合用于切割杂草。

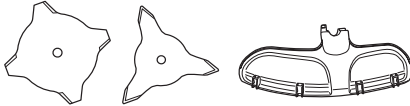

打草头用于修剪草。

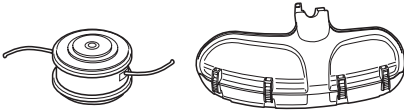

一般规则



仅使用我们推荐的带防护罩的切割锯片！请参阅“技术参数”章节。



确保正确打磨锯片齿！请按照我们的说明使用推荐的扁锉规。打磨不当或受损的锯片会增加发生意外的风险。

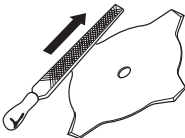

请保持锯片的设置正确！请按照我们的说明并使用推荐的设置工具。设置错误的切割锯片会增加卡住和甩刀风险，并会对锯片造成损坏。

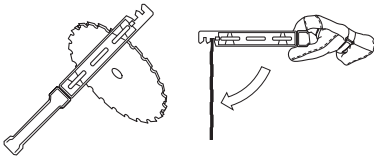

检查切割锯片是否损坏或有裂痕。务必更换损坏的切割锯片。

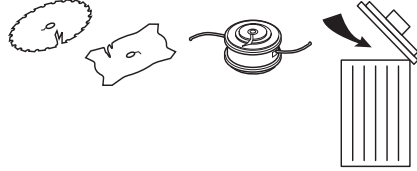

打磨割草刀和打草刀片



- 请参阅切割锯片包装以了解正确的打磨说明。使用单纹扁锉打磨锯片和刀片。
- 均匀地打磨所有刀刃以保持锯片的均衡。

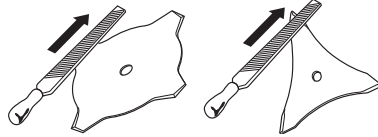

警告！务必弃置弯曲、扭曲、开裂、断裂或受到其他任何损坏的锯片。切勿为了重复使用而试图拉直扭曲的锯片。仅使用指定类型的原厂锯片。

打磨锯片



- 请参阅切割锯片包装以了解正确的打磨说明。

一般安全须知

正确打磨的锯片对高效作业和避免不必要的锯片及割灌机磨损至关重要。



- 锉削锯片时，请确保锯片得到良好支撑。使用带锉刀夹的 5.5 mm 圆锉。

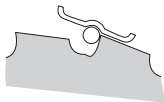

- 锉削倾角为 15° 。向右锉削交叉锯齿，向左锉削其间的锯齿。在特殊情况下，如果锯片上有石块造成的严重凹痕，则可能需要使用扁锉处理锯齿的顶部边缘。如果出现这种情况，应先完成上述操作，然后再使用圆锉锉削。必须对所有锯齿的顶部边缘进行等量锉削。

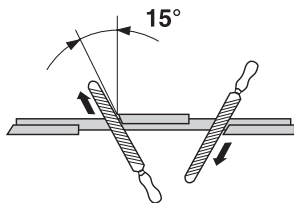

- 调整锯片设置。应为 1 mm。

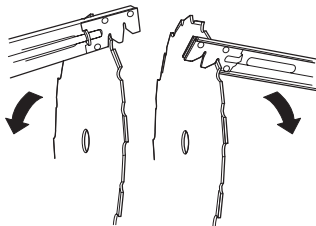

打草头

重要事项！

务必确保打草机拉绳均匀地紧紧缠绕在卷筒上，否则机器将会产生不良振动。

- 仅使用推荐的打草头和打草机拉绳。这些部件均经过制造商测试，适合在特定引擎尺寸条件下操作。这一点在使用全自动打草头时尤为重要。仅使用推荐的切割锯片。请参阅“技术参数”章节。



- 小型机器通常需要小型打草头，反之亦然。这是因为在使用拉绳进行清理时，引擎必须从打草头中径向抛出拉绳并克服所清理的草的阻力。
- 拉绳的长度也很重要。如果拉绳的直径相同，长拉绳比短拉绳所需的引擎动力更大。
- 请确保打草机防护罩上的切割齿完好无损。切割齿用于将拉绳切成正确的长度。
- 为了延长拉绳的使用寿命，可在使用前将拉绳浸泡在水中数天。这将使拉绳更坚韧，从而使用寿命更长。

组装

组装手柄杆和油门



- 四颗螺钉将手柄杆夹钳中的手柄杆安装在轴上。

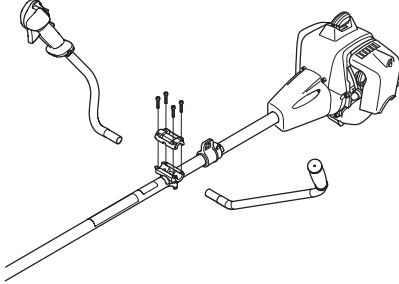

安装刀片和打草头



警告！

安装切割锯片时，要将驱动盘/支撑凸缘上的凸起部分与切割锯片的中心孔正确接合，这一点极其重要。如果切割锯片安装不当，会导致严重的和/或致命的人身伤害。

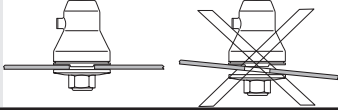

警告！严禁在未安装经检验合格的安全罩的情况下操作切割锯片。请参阅“技术参数”章节。安装不恰当规格或破损的安全罩会导致严重的人身伤害。

重要事项！使用锯片或打草刀片时，机器必须配备适当的把手、锯片防护罩和背带。

安装打草机防护罩和打草头



- 安装适用于打草头的正确打草机防护罩 (A)。
- 如图所示安装防护罩。拧紧。

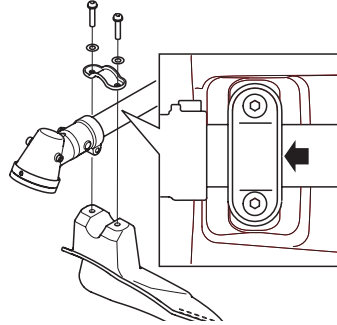

- 将打草机防护罩定位在箭头标志旁。
- 将驱动盘 (B) 和支撑凸缘 (C) 安装在输出轴上。
- 转动输出轴，直至驱动盘的一个孔与齿轮箱中的相应孔对准。
- 将锁紧销插入孔中以将轴锁定。
- 安装时逆时针转动打草头。
- 拆卸时，请按照与说明相反的顺序进行操作。

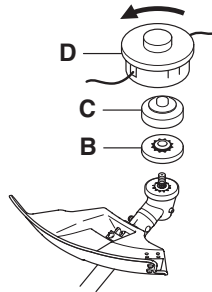

组装

安装打草机防护罩和打草头



- 如图所示安装防护罩。牢固拧紧。

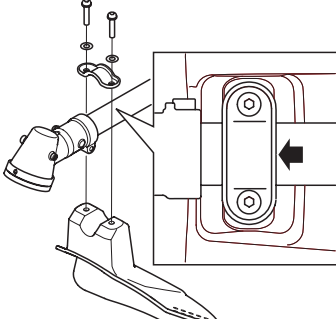

- 将切割锯片防护罩放在箭头标记旁。
- 在输出轴上安装驱动盘 (B)。
- 转动输出轴，直到驱动盘中的一个孔与齿轮箱中的相应孔对齐。
- 将锁定销 (C) 插入孔中以锁定刀轴。
- 将锯片 (D)、支撑杯 (E) 和支撑凸缘 (F) 安装到输出轴上。
- 安装螺母 (G)。必须将螺母紧固至 35-50 Nm (3.5-5 kpm) 的扭矩。使用工具箱中的套筒扳手。握住套筒扳手的轴，尽可能靠近锯片防护罩。要紧固

螺母，请按照与旋转方向相反的方向转动套筒扳手（小心！是左旋螺纹）。

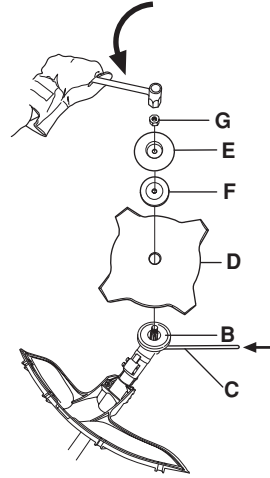

燃油处理

燃油安全须知

在下列情况下，切勿启动机器：

- 1 如果将燃油溅在机器上。先将溅出的燃油擦掉，然后让剩余的燃油蒸发掉。
- 2 如果燃油溅在自己身上或衣服上，须先换掉衣服。清洗接触到燃油的身体部位。使用肥皂和水进行清洗。
- 3 发生燃油泄漏情况。经常检查油箱盖和油管是否发生泄漏。

运输及存放

- 小心储存与运输机器及燃油，以免出现漏油或油气接触火花或明火的风险，比如来自电动机械、电机、继电器/电源开关或锅炉的火花或明火。
- 存放和运输燃油时，务必使用经过批准的专用容器。
- 长时间存放本机时，必须清空燃油箱。请咨询当地加油站如何处理剩余的燃油。
- 在长时间存放之前，确保清洁机器并且进行全面保养。
- 运输或存放机器时，务必安装切割锯片的运输防护罩。
- 运输期间将机器固定好。
- 为防止意外启动引擎，长期存放期间，机器没有严密监督的情况下，以及进行各种维修工作时，一定要取下火花塞帽。



警告！处理燃油时请小心。谨记失火、爆炸及误吸油气的危险。

燃油

小心！本机配有一个二冲程引擎，必须始终使用汽油与二冲程机油混合的燃油运行。注意准确测定要混合的油量，以确保正确混合。混合少量燃油时，即使小误差也会严重影响混合比。



警告！燃油和油气都是高度易燃物，一旦吸入或与皮肤接触，会造成严重的人身伤害。为此需要小心处理燃油，并确保空气流通。

汽油



小心！务必使用优质汽油/机油混合物（辛烷值 (RON) 至少为 90）。如果您的机器装有催化转换器（请参阅“技术参数”章节），请务必使用优质的无铅汽油/机油混合物。含铅汽油会损坏催化转换器。

如果可以的话，请使用低排放汽油，也叫烷基化汽油。



- 最低建议辛烷值是 90 (RON)。如果您使用的辛烷标号低于 90，会导致出现爆震现象。这会导致引擎过热，令引擎严重受损。
- 连续高转速作业时，建议提高辛烷值。

二冲程机油

- 为获得最佳的效果和性能，最好使用 HUSQVARNA 为风冷式二冲程引擎专门开发的二冲程机油。
- 千万不可使用水冷式引擎专用的二冲程机油，即所谓的舷外机油 (TCW 级)。
- 千万不可使用四冲程引擎专用的机油。
- 机油质量差和/或机油/燃油比过高会影响功能和缩短催化转换器的使用寿命。
- 混合比
和 HUSQVARNA 二冲程机油的混合比为 1:50 (2%)。
和油品等级 JASO FB 或 ISO EGB 配制的风冷式二冲程机油的混合比为 1:33 (3%)。

汽油，公升	二冲程机油，公升	
	2% (1:50)	3% (1:33)
5	0.10	0.15
10	0.20	0.30
15	0.30	0.45
20	0.40	0.60

燃油处理

混合

- 请在干净的燃油专用容器内混合汽油与机油。
- 务必首先加入一半汽油。然后加入全部的机油。混合（摇匀）混合液。最后再加入另一半汽油。
- 加入机器的燃油箱之前，务必充分混合（摇匀）燃油混合液。



- 一次混合的油量不要超过一个月的用量。
- 如果机器一段时间不使用，应倒光油箱内的油，并清理干净。

加燃油



警告！采取下列注意事项可以减少火患的发生：

不要吸烟或者把热烫的物体放在燃油旁边。

加油前先关掉引擎。

加油前务必关闭引擎，并让它冷却几分钟。

加油时，请慢慢打开油箱盖，以便缓慢释放过高的压力。

加油之后小心拧紧燃油箱盖。

务必将机器移离加油区和加油站之后才可启动。

- 必须使用带防溢漏阀的油罐。
- 将油箱盖四周清理干净。油箱上的污物会导致运行故障。

- 先将油罐摇匀，充分混合燃油后，再加入油箱。

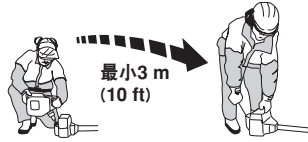

启动与停止

启动前检查



- 检查锯片以确保锯齿的底部或中心孔旁没有形成裂纹。裂纹形成的最常见原因是：在打磨时齿的底部形成了锐角或使用的锯片齿不锋利。如果发现锯片有裂痕，应予以弃置。

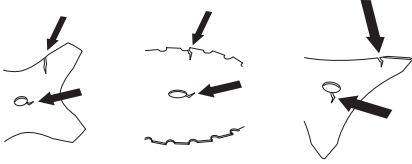

- 检查并确保支撑凸缘没有由于疲劳或过度拧紧而出现裂痕。如果支撑凸缘出现裂痕，应予以弃置。

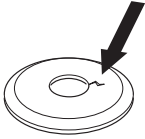

- 确保锁紧螺母没有失去锁紧力。螺母锁紧应至少有 1.5Nm 的锁紧力。锁紧螺母的紧固扭矩应为 35-50Nm。



- 检查锯片防护罩是否损坏或有裂痕。如果锯片防护罩受到碰撞或有裂痕，请予以更换。

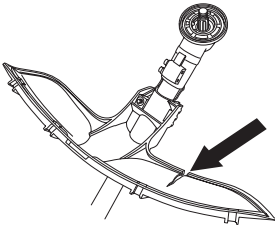

- 检查并确保打草头和打草机防护罩没有损坏或裂痕。如果打草头或打草机防护罩受到碰撞或有裂痕，请予以更换。

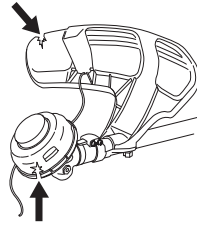

- 切勿使用没有防护罩或防护罩有缺陷的机器。
- 启动机器前，必须正确安装好所有的盖，并且不得有损坏。

启动与停止



警告！ 机器启动之前一定要安装好离合器罩和轴，否则离合器会松动，会造成人身伤害。

务必将机器移离加油区和加油站之后才可启动。将机器停放在平整表面上。确保切割锯片不会与任何物体接触。

确定没有非工作人员在现场。否则会造成严重的人身伤害。安全距离为15米。

启动



点火装置： 将停止开关设置到开始位置。

阻气门： 将风门设在阻风位置。

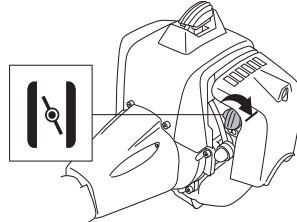

启动与停止

启动注油器：反复挤压注油泵直至燃油开始注入球囊。不必将球囊装满。

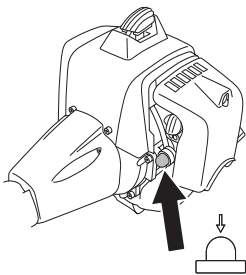

警告！如果引擎启动时阻气门位于阻气位置或启动油门位置，切割锯片将会立即开始转动。

用左手将机器按在地上（小心！不要用脚！）用右手抓住启动器把手，慢慢地向外拉启动绳，直到感觉到有阻力（止轮具抓紧），然后快速用力地拉。千万不可将启动器拉绳绕在手上。

拉动启动器把手，直到引擎启动。引擎启动后，使阻气门返回运行位置，全开油门；油门将会自动脱离启动设置。

小心！不要将启动器的拉绳拉到底，也不要完全拉出的位置放开启动器把手。这样做会损坏机器。



小心！不要让身体的任何部分进入标记区。如果火花塞帽已经损坏，接触会烧伤皮肤或发生电击。请务必戴上手套。不要使用火花塞帽破损的机器。

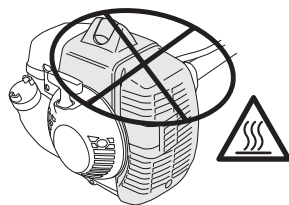

油门设置控制

将油门移至怠速位置。

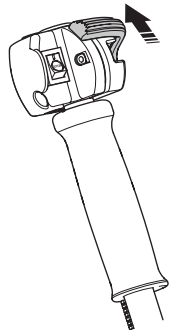

停止



关闭点火开关，停止引擎。

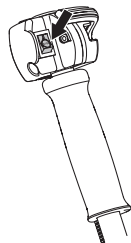

小心！关闭点火开关，停止引擎。

操作方法

一般工作须知

重要事项！

本节介绍使用割灌机和打草机作业时的基本安全事项。当您遇到任何情况，不知如何继续时，请咨询专家。与您的经销商或保养厂联系。避免任何超出您能力范围的使用。在使用前，您必须了解林业清理、草清理和草修剪的区别。

基本安全守则



1 环顾四周：

- 确定没有人、动物或其他物品会影响到您操控动力切割机。
 - 确保人员、动物等不会接触切割锯片或切割锯片抛出的松散物体。
 - 小心！如果发生事故时无法求救，请勿使用本机。
- ### 2 检查作业区。
- 移除所有可能被抛出或缠绕切割锯片的松散物体，如石块、碎玻璃、钉子、钢丝、线绳等。
- ### 3 避免在不良的天气情况下使用本机。例如：浓雾、暴雨、强风或是严寒等。在天气不佳的情况下工作，容易令人感到疲倦，更可能造成危险的情况，例如湿滑的地面和不可预测伐木方向等。
- ### 4 确保您可以安全地移动与站立。检查您的周围区域是否存在障碍物（树根、岩石、树枝、沟渠等），以免您突然移动。在倾斜地面上工作时，要特别小心。



- ### 5 切割张紧的树木时应格外当心。在切割前后，张紧树木有可能重新弹回其正常位置。如果您处于不正确位

置或在错误位置切割，那么树木很有可能会将您或机器击中，使您失去控制。这两种情况均会造成严重的人身伤害。



- ### 6 请保持平衡并找到牢固的立足处。请勿距离过远。请始终维持适当的位置和平衡。
- ### 7 务必用双手握住机器。将机器靠在身体右侧。使您的身体各部位远离高温表面。使您的身体各部位远离旋转的切割锯片。



- ### 8 使用割灌机时，务必将其牢固地挂在背带上。否则将无法安全控制割灌机并会导致您或他人受伤。切勿使用快速脱解功能发生故障的背带。
- ### 9 将切割锯片保持在腰部以下。
- ### 10 关闭引擎后再移动到其它区域。无论距离多远，在搬运或运输设备之前都应安装运输防护罩。
- ### 11 切勿在引擎运转的情况下放下机器，除非是放在您可以清楚看到的位置。

操作方法



警告！在引擎运行或切割设备旋转时，机器操作员或任何人员均不得尝试移除切割材料，因为这会导致重伤。

移除缠绕住刀轴的材料前，应先停止引擎和切割设备，否则会导致伤害。斜齿轮在使用过程中会变热，并且在一段时间后仍是如此。不要触摸斜齿轮，否则会被烫伤。



警告！注意抛掷物。始终佩戴经检验合格的眼部保护设备。切勿倚靠在切割锯片防护罩上。石头、垃圾等会抛入眼中，导致失明或严重伤害。

未经授权的人员不得靠近。应确保儿童、动物、旁观者和帮忙者位于15米安全区以外。如有人靠近，立即停止机器。转动机器之前务必先查看身后，确保安全区内无人。



警告！有时树枝或草会被绞入防护罩和切割锯片中。在清洁之前务必停止引擎运行。

作业方法



警告！装有锯片或打草刀片的机器在锯片或刀片接触固定物体会猛地甩向一侧。这称为甩刀。甩刀的反冲力很大，能将机器和/或操作员推向任何方向，并有可能失去对机器的控制。如果机器被绊住、停止或受阻，则会在没有任何警告的情况下发生甩刀。甩刀更有可能发生在难以看到被切割材料的区域。

避免将锯片置于12点钟和3点钟位置之间的区域进行切割。由于锯片快速旋转，如果您试图将锯片置于该区域切割厚茎，可能会发生甩刀。

- 开始清理前，请先检查清理区、地形、地面坡度、是否有石块、洼地等。
- 从区域的一端开始最为简单，然后从作业区域中清理出一个开阔空间。
- 在区域中按照规划来回地作业，每趟清理4-5 m左右的宽度。这充分利用了机器在两个方向上的全部伸展距离，并为操作员提供了一个便利灵活的作业区域。

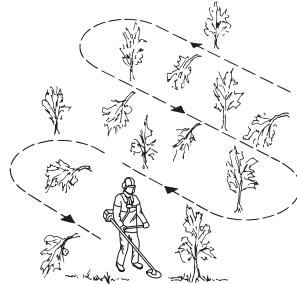

- 清理一个长约75 m的条状地带。随着作业的进行移动燃油罐。
- 在斜坡上时应顺着斜坡作业。顺着斜坡作业要比上下斜坡作业简单得多。

操作方法

- 应规划该条状地带，以避免跨过沟渠或地面上的其他障碍物。还应确定条状地带的方向，以便利用风力条件，使清理的树干倒落在树木的清理区域中。

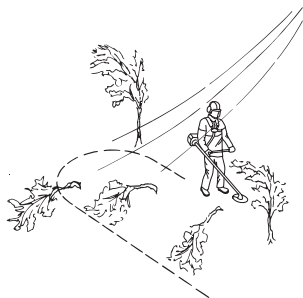

使用打草刀片清理草



- 打草刀片和割草刀不得用于切割木质茎。
- 打草刀片可用于所有类型的高草或杂草。
- 通过侧向摆动方式进行割草，其中从右向左移动是清理行程，从左向右移动是回程。使用锯片的左侧（8点钟到12点钟位置之间）进行切割。

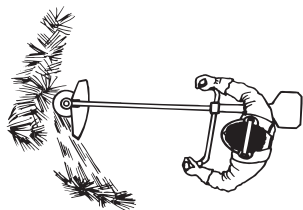

- 如果在清理草时锯片偏向左侧，草将排成一条直线，这样更容易收集，例如通过搂草的方式收集。
- 尝试有节奏地工作。双脚分开站稳。回程后向前移动，然后再次站稳。
- 让支撑杯轻轻地靠在地上。支撑杯用于防止锯片撞击地面。
- 按照以下说明操作可减少材料缠绕锯片的风险：
 - 务必在全开油门状态下执行切割。
 - 避免在回程中切割之前切割的材料。
- 停止引擎，解开背带，将机器放在地上，然后开始收集切割材料。

用打草头修剪草



修剪

- 握住打草头，使其与地面呈一定角度且恰好离地。这时用拉绳末端进行工作。让拉绳按照自己的节奏工作。切勿将拉绳压入待切割区域。



- 拉绳可以轻松移除墙壁、栅栏、树木和狭长绿化带上的草和杂草。但也会损坏树木及灌木的敏感树皮和损坏栅栏柱。
- 将拉绳缩短至 10-12 cm 并降低引擎转速可降低植物受损的风险。

清理

- 清理方法可清除所有不需要的植被。使打草头恰好离地并将其倾斜。使用拉绳的末端扫过树木、柱子、雕像和类似物体周围的地面。小心！此方法会加大拉绳的磨损。

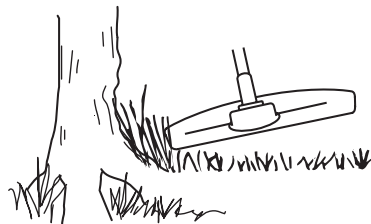

- 在石块、砖头、混凝土、金属栅栏等物体上作业时，拉绳会比在接触树木和木栅栏时更快地磨损，因此必须更频繁地向前送绳。
- 应使用小于全开油门的状态（80%）进行修剪和清理，这样拉绳能更持久，并能减少打草头的磨损。

切割

- 打草机非常适于切割使用普通草坪机难以触及的草。切割时保持拉绳与地面平行。避免将打草头压在地面上，否则会毁坏草坪并损坏工具。

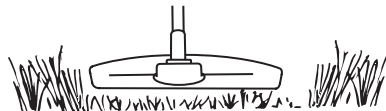

操作方法

- 在正常切割过程中，不要让打草头持续接触地面。否则会导致打草头损坏和磨损。

清扫

- 旋转拉绳的风扇效应可用于快速轻松地进行清理。使拉绳位于待清扫区域的上方并保持平行，然后将工具从一侧移到另一侧。

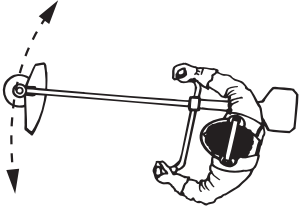

- 切割和清扫时，应使用全开油门状态以获得最佳结果。

维护

化油器

调节怠速(T)

检查并确定空气滤清器洁净。怠速正确时，切割锯片不应旋转。如果需要调节，应在引擎运转时关闭（顺时针转动）怠速调节螺丝T，直到切割锯片开始旋转。打开（逆时针转动）螺丝，直到切割锯片停止。当引擎在各个位置均运转顺畅时，表示怠速设置正确，并且怠速与切割锯片开始旋转时的转速有明显差异。

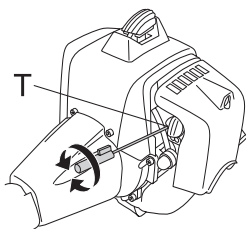

警告！如果无法调整怠速转速以至工作装置停止转动，请联络代理商/维修店。在还未正确调整或修理前，请勿使用机器。

空气滤清器



必须定期清洁空气滤清器，以清除泥土和灰尘，避免发生下列情况：

- 化油器故障。
- 启动问题。
- 引擎功率损耗。
- 引擎零件发生不必要磨损。

- 过度耗油。

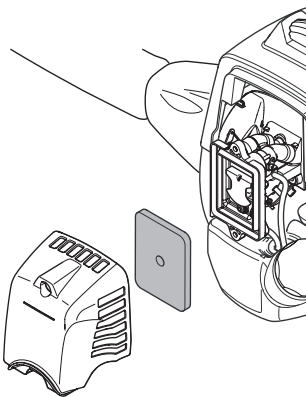

每25小时清洁一次滤清器，或者如果在灰尘异常多的环境下，则要增加清洁次数。

清洁空气滤清器

打开空气滤清器外壳，取出滤清器。在温暖的肥皂水中将滤清器清洗干净。还应使用压缩空气或刷子清洁滤清器罩的内侧。

按照说明将滤清器晾干，然后涂油。

将滤清器放在塑胶袋中并倒上滤清器油。揉捏塑胶袋使油散开。挤出塑胶袋内滤清器多余的油，倒出多余的油，然后将滤清器安装到机器上。

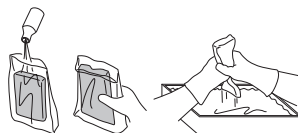

千万不可使用四冲程引擎专用的机油。千万不可使用汽油、机油或者任何汽油混合物！

打开空气滤清器外壳，取出滤清器。用压缩空气吹净。滤清器经过长期使用之后，无法彻底清洁。因此，所有的空气滤清器都应定期更换新的。损坏的空气滤清器一定要换新。

清洁后，需对泡棉塑胶滤清器上油。请参阅“对泡棉塑胶滤清器上油”一节的说明。

维护

燃油滤清器

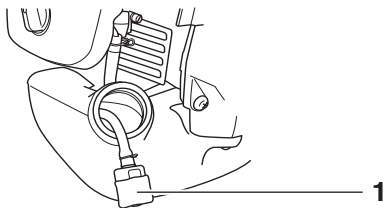

1 燃油滤清器

当引擎的燃油供应不足时，检查油箱盖和燃油滤清器是否堵塞。

斜齿轮



斜齿轮在出厂时已加注了正确量的润滑脂。但在使用机器前，应检查斜齿轮中的润滑脂是否已加注到四分之三满的位置。使用 Husqvarna 专用润滑脂。

斜齿轮中的润滑脂通常不需要更换，但维修情况除外。

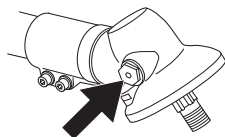

火花塞



火花塞的状况会受下列的因素影响：

- 化油器调节不正确。
- 燃油混合不正确（机油太多或种类不对）。
- 空气滤清器变脏。

这些因素会导致异物堆积在火花塞电极上，从而造成操作问题及启动困难。

如果机器动力不足、不易启动或是怠速运转情况差，首先检查火花塞，然后再采取其他措施。如果火花塞很脏，清洁并检查跳火间距是否有 0.9-1.0 mm。每使用大约一个月需要更换火花塞一次，或在必要时提前更换火花塞。

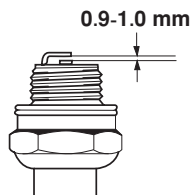

小心！务必使用推荐的火花塞类型！不适合的火花塞会损坏活塞/气缸。检查并确保火花塞安装有抑制器。

维护

维护计划

以下是必须对本机进行的维修事项的列表。大多数的维护项目已在“维护”一节中进行说明。用户只能进行本《操作手册》中所述的保养和维修工作。其他的作业必须由授权的保养厂进行。

维护	日常维护	每周维护	每月维护
清洁机器的外部。	X		
检查并确保背带没有破损。	X		
从安全角度出发，确保油门扳机锁和油门功能正常。	X		
检查并确保手柄和手柄杆没有破损并已正确固定。	X		
检查并确保停止开关能否正常操作。	X		
检查并确保切割锯片在怠速状态下不转动。	X		
清洁空气滤清器。必要时换新。	X		
检查并确保防护罩没有损坏或裂痕。如果防护罩受到碰撞或有裂痕，请予以更换。	X		
检查并确保锯片锋利、已正确居中且没有裂痕。锯片未居中将会引起振动，可能导致机器损坏。	X		
检查并确保打草头没有损坏或裂痕。必要时更换打草头。	X		
检查并确保切割设备的锁紧螺母已正确拧紧。	X		
检查并确保锯片的运输防护罩完好无损并且可以正确固定。	X		
检查螺母和螺丝是否上紧。	X		
检查引擎、油箱与燃油管是否漏油。	X		
检查启动器及启动器绳索。		X	
清洁火花塞外部。拔下火花塞，然后检查跳火间距。将跳火间距调至 0.6-0.7 mm 或更换火花塞。检查并确定火花塞安装有抑制器。		X	
清洁化油器外部以及其周围区域。		X	
检查斜齿轮中的润滑剂是否已加注到四分之三满的位置。必要时使用专用润滑脂进行加注。		X	
检查燃油滤清器上是否有污物，油管是否有裂痕或其它破损现象。必要时换新。			X
检查所有的电缆及接头。			X
更换火花塞。检查并确定火花塞安装有抑制器。			X

技术参数

技术参数

技术参数	543RS
引擎	
气缸排量 (cm ³)	40.1
缸径 (mm)	40.5
冲程 (mm)	31.1
空转速度 (rpm)	3000
建议的最大转速 (rpm)	12000
输出轴的转速 (rpm)	8570
最大引擎输出 (kW/rpm), 按照 ISO8893	1.5/9000
点火系统	
火花塞	NGK CMR7H-10
跳火间距 (mm)	0.9-1.0
燃油和润滑系统	
燃油箱容量 (L)	0.75
重量	
不包括燃油、切割锯片和保护装置在内的重量, kg	7.2
噪音级	
(参阅注释1)	
操作员耳旁的等效声压级根据ENISO11806和ISO22868测量得出, 单位为 dB(A):	95
振动程度	
(参阅注释 1)	
手柄的等效振级 ($a_{hv,eq}$) 根据 ENISO11806 和 ISO22867 测量得出, 单位为 m/s ²	6.3/4.9

注释 1: 本机的等效声压级的报告数据中具有一个 1dB(A) 的典型统计离差 (标准偏差)。

注释 2: 等效振级的报告数据中具有一个 1 m/s² 的典型统计离差 (标准偏差)。

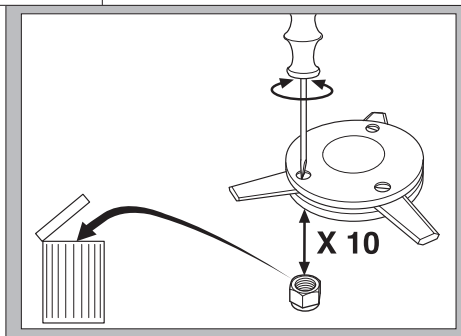
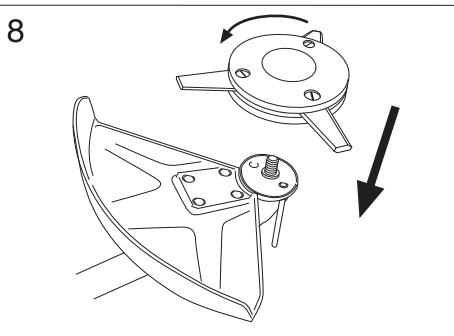
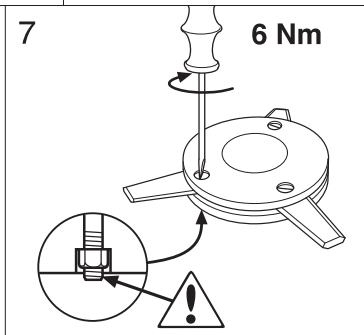
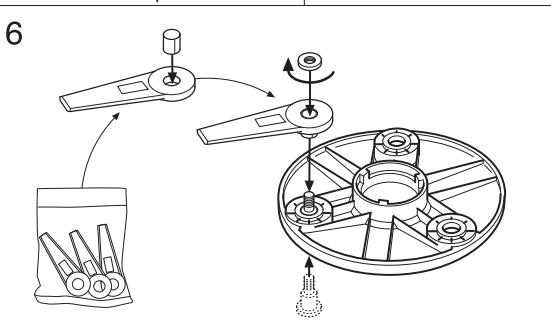
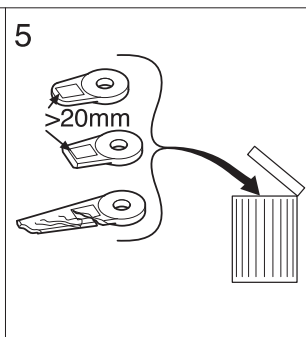
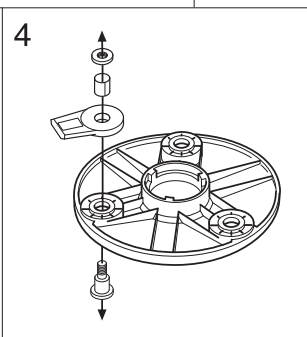
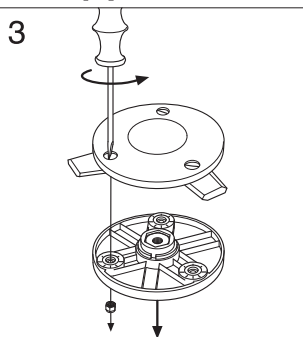
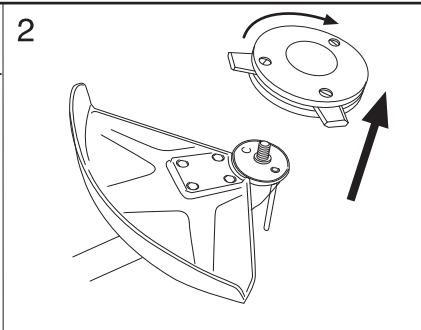
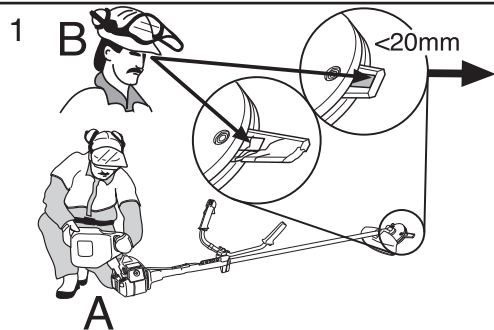

543RS		
经批准使用的附件	类型	切割锯片防护罩, 零件号
打草刀片/割草机	Grass 255-41* (Ø 2554齿)	584 40 43-01
	Multi 255-3 (Ø 2553齿)	584 40 43-01
	Grass 275-4 (Ø 2754齿)	584 40 43-01
塑料锯片	Tricut Ø 300 mm (单独锯片的零件号5310177-15)	584 40 43-01
打草头	Superauto II	584 40 43-01
	T35、T35x (Ø 2.4-3.0 mm 拉绳)	584 40 43-01
	T45x (Ø 2.7-3.3 mm 拉绳)	584 40 43-01
	F35 (Ø 2.0-3.5 mm 拉绳)	584 40 43-01
	PT104	584 40 43-01
支撑杯	固定	-

Tri Cut

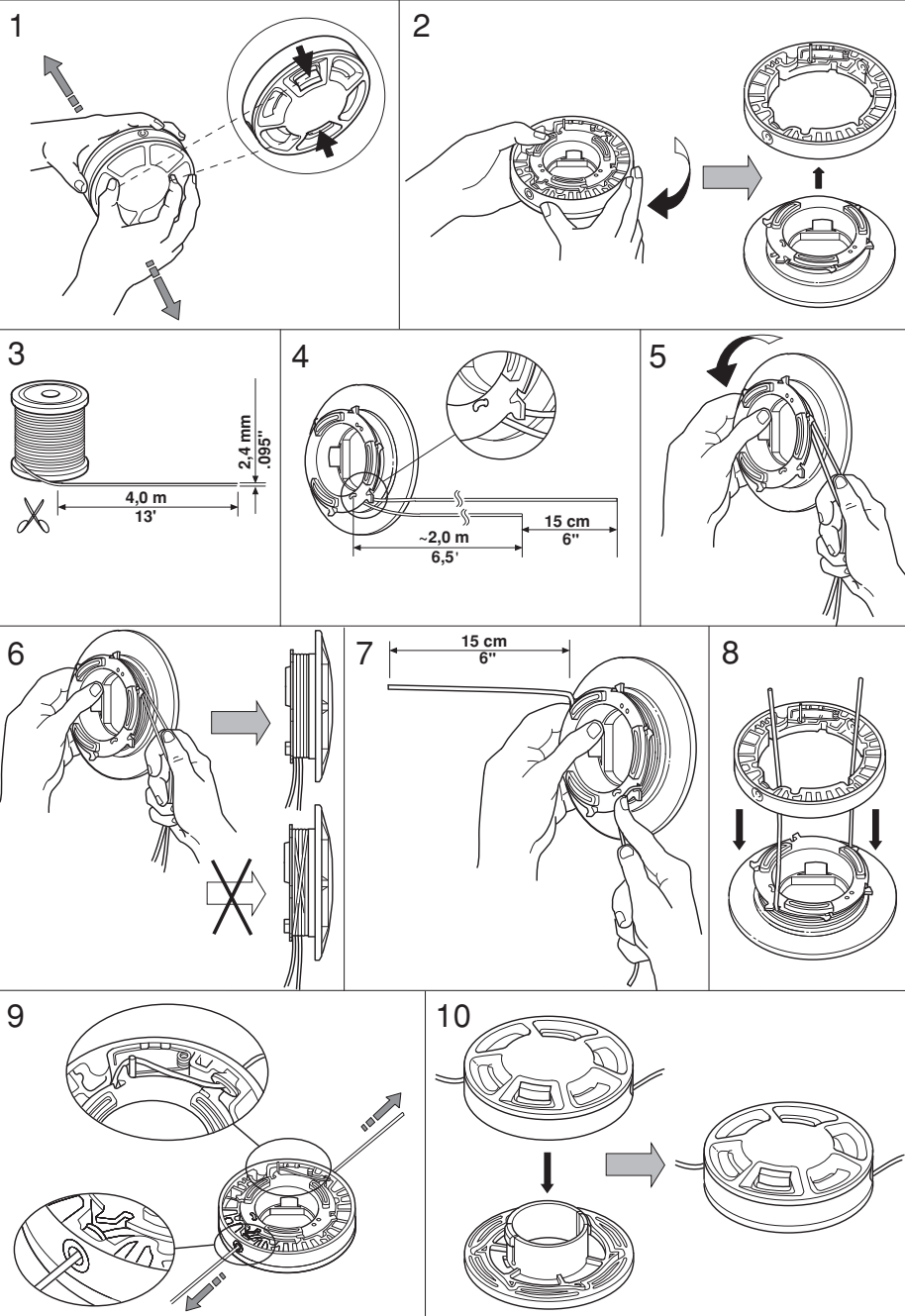

Super Auto II Super Auto II 1"

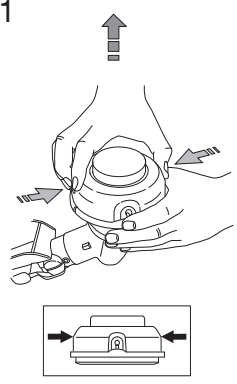

T25   

1 

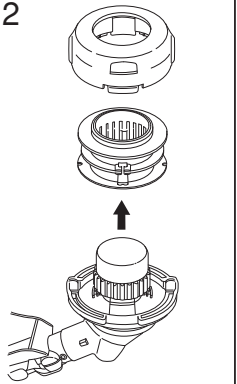
2 

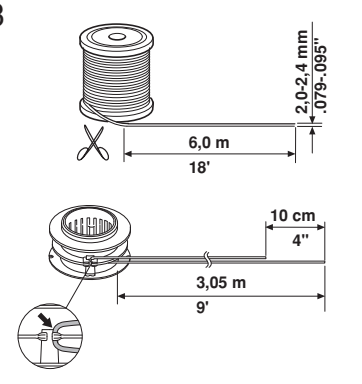
3 

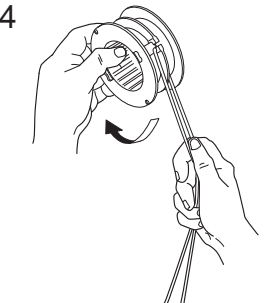
4 

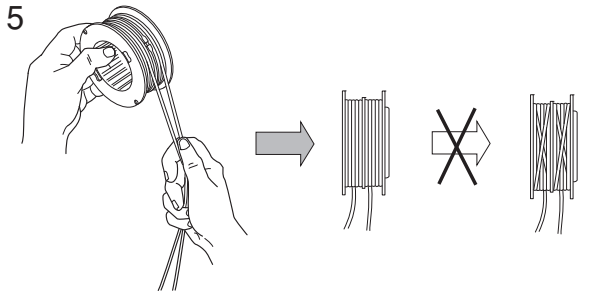
5 

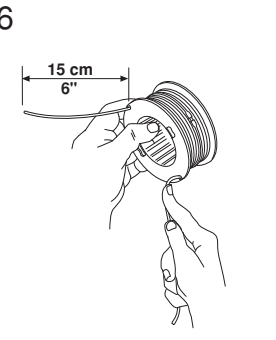
6 

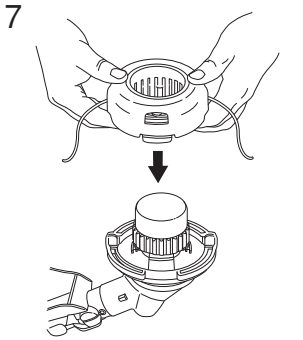

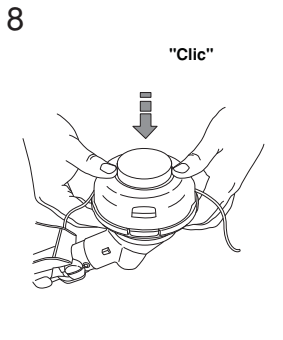
7 

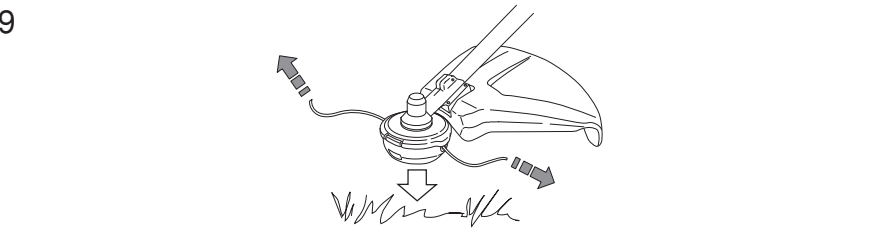
8 

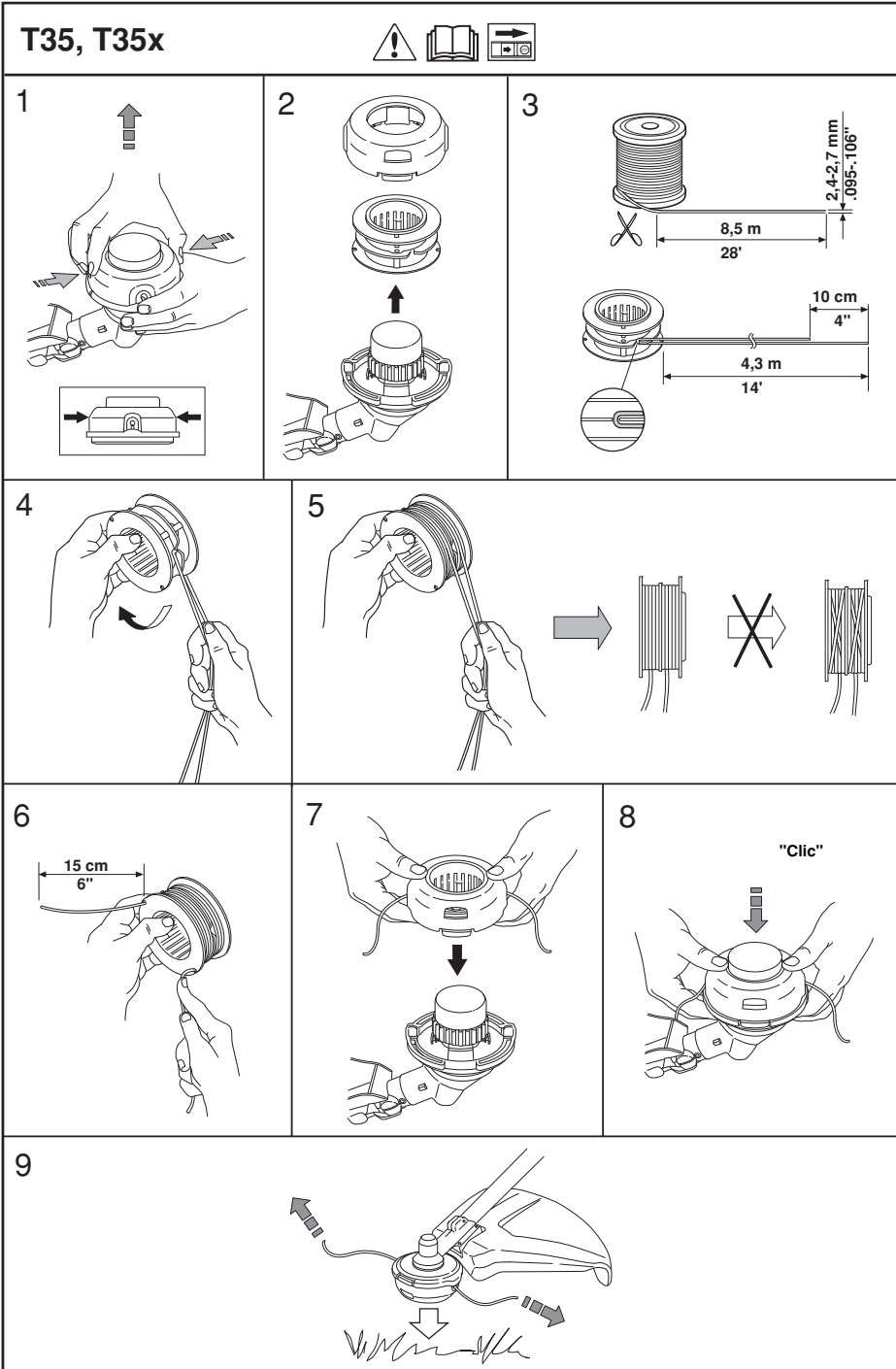
9 



T45, T45x

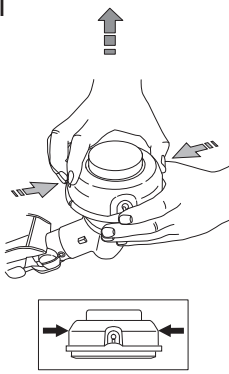

1 

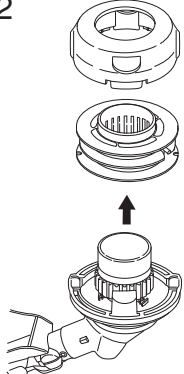
2 

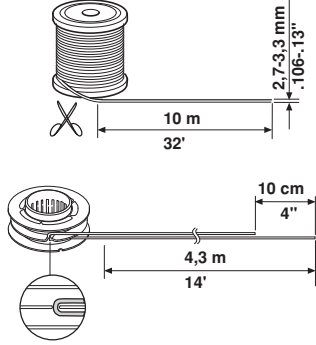
3 

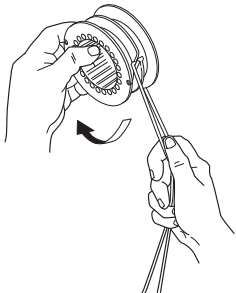
4 

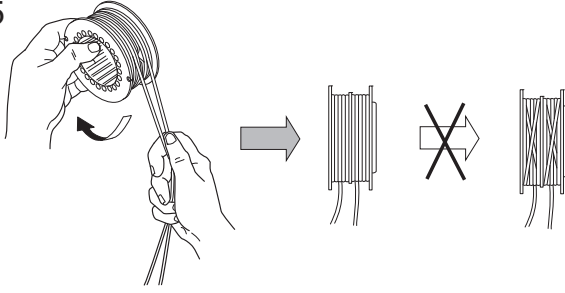
5 

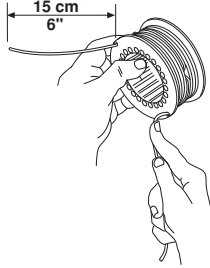
6 

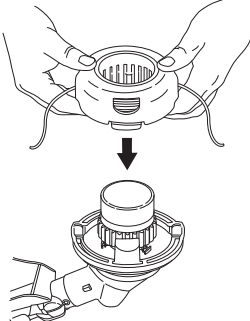
7 

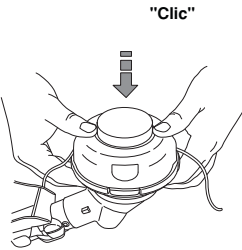
8 

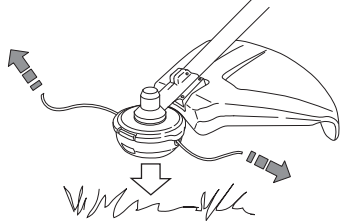
9 

PT104

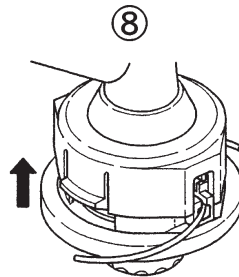
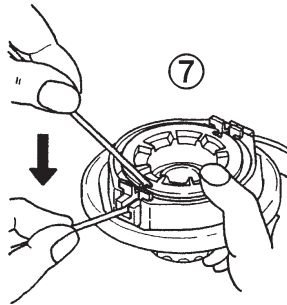
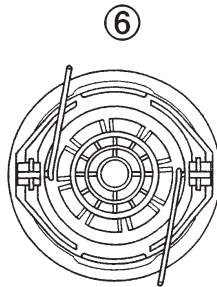
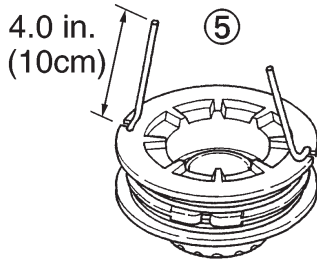
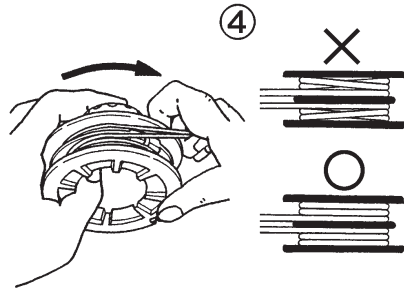
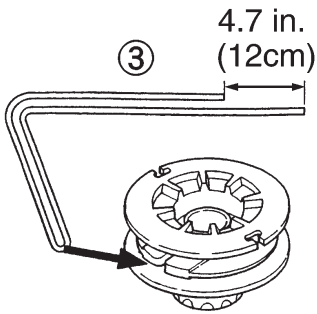
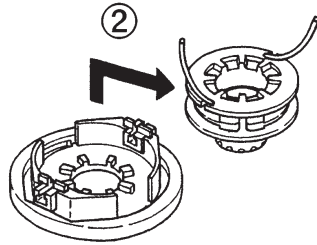
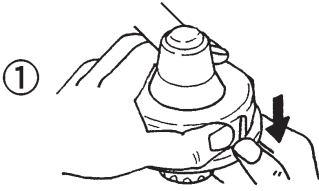





www.husqvarna.com

Original instructions

原始说明书

1158111-38



2016-01-11