

Contour Cordless 20V Li Art. 9679244-xx

Remark: “xx” stands for customer and country variants. The basic product number is before the hyphen.

EN Operator’s manual
Battery Lawn Trimmer

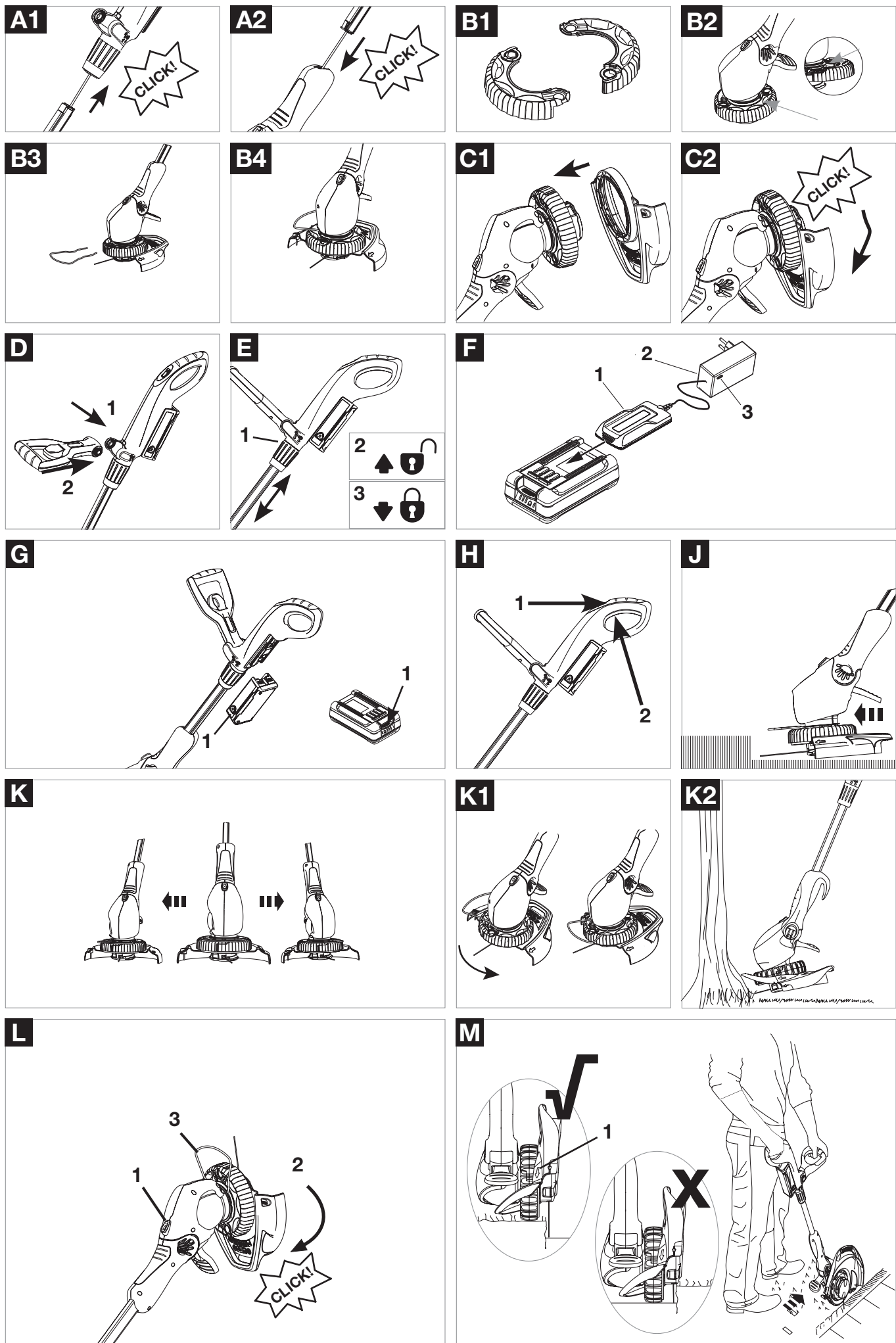

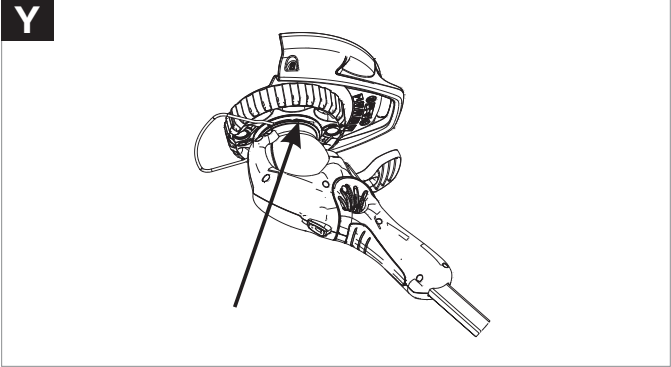
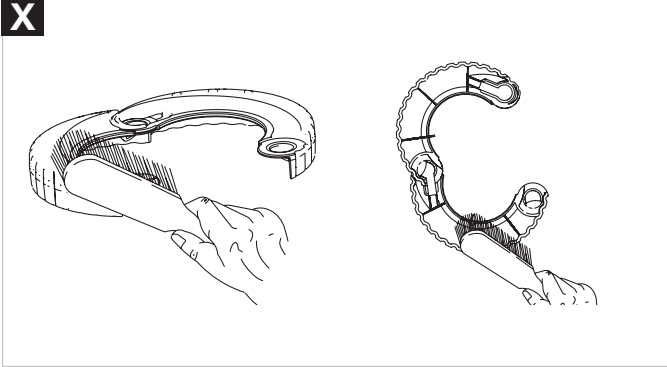
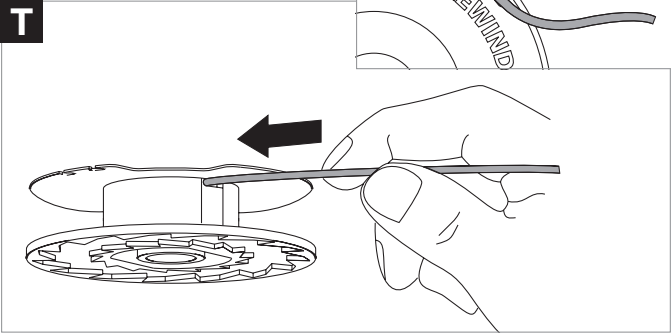
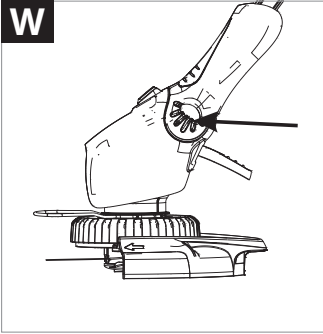
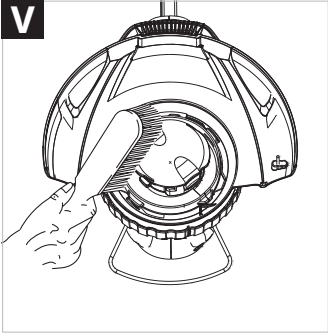
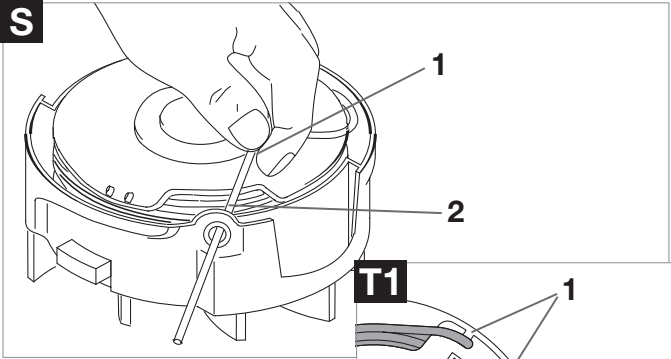
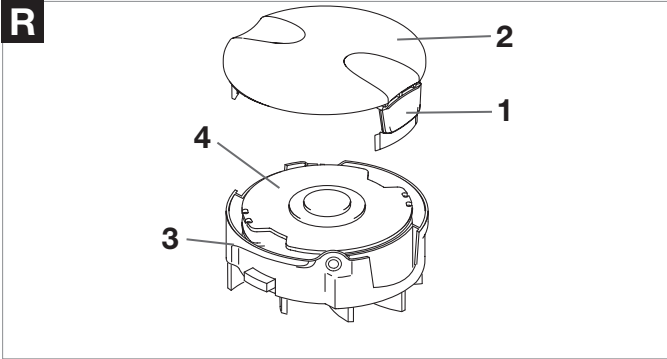
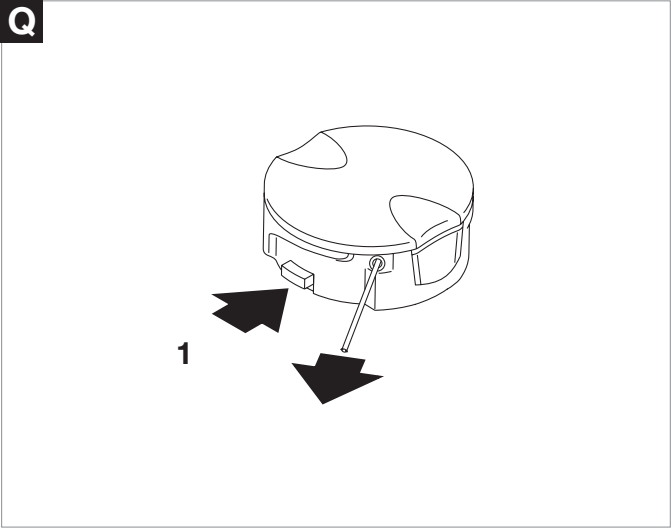
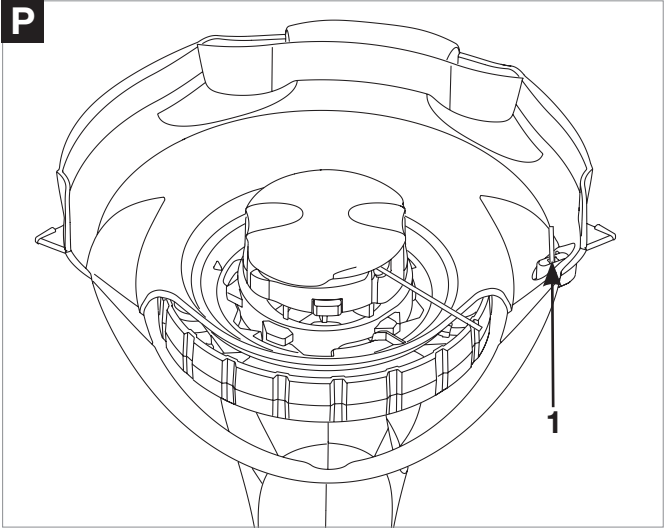
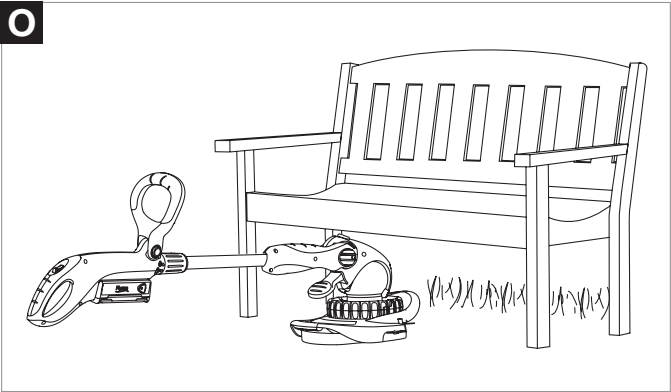
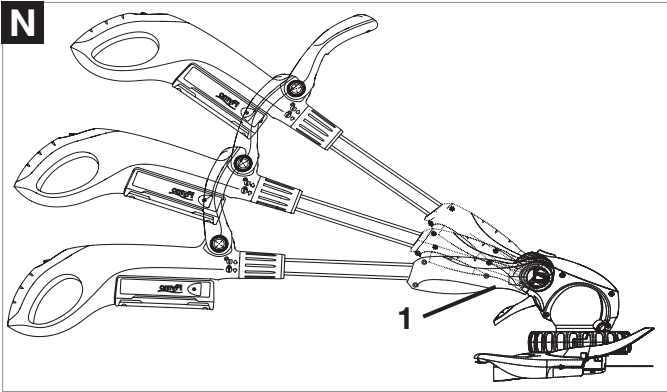

Carton Contents

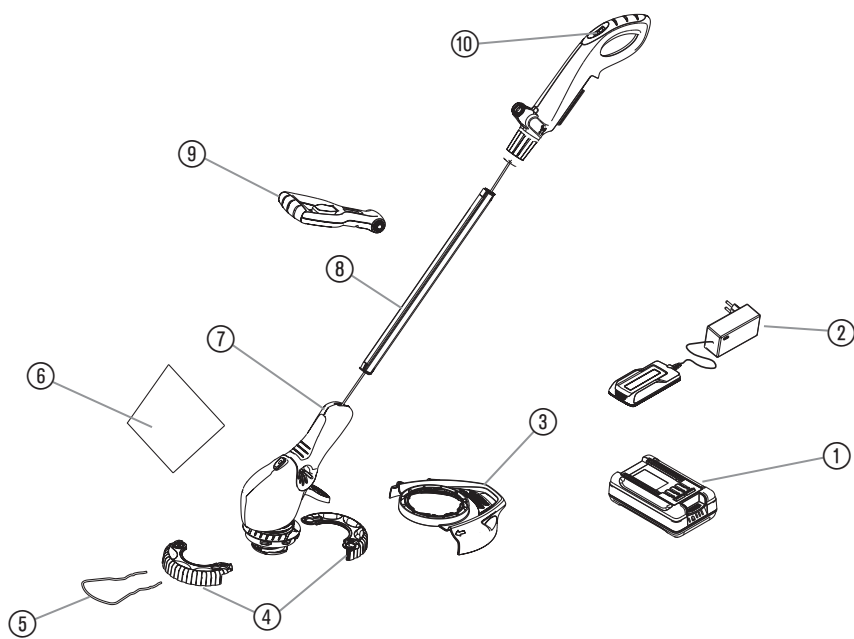

- 1. Battery Pack
- 2. Battery Charger
- 3. Guard
- 4. Wheel
- 5. Plant Guard
- 6. Operator's manual
- 7. Lower Shaft
- 8. Upper Shaft
- 9. Steady Handle
- 10. Safety Lock-off Switch

EN Battery Lawn Trimmer

1. SAFETY

2. ASSEMBLY

3. OPERATION

4. MAINTENANCE

5. STORAGE

6. TROUBLESHOOTING

7. TECHNICAL DATA

8. ACCESSORIES

9. SERVICE/WARRANTY

4

5

5

6

6

7

7

7

7

Original instructions.

 This product may be used under supervision, or if instruction regarding the safe use of the product has been provided and the resulting dangers have been understood, by children aged 8 and above, as well as by persons with physical, sensory or mental disabilities or a lack of experience and knowledge. Children must not be allowed to play with the product. Cleaning and user maintenance must not be performed by children without supervision. The use of this product by young people under the age of 16 is not recommended.

Intended use:

The **FLYMO Trimmer** is intended to trim and to cut lawn and areas of grass in private domestic gardens and allotments.
The product is not intended for long term use.



DANGER! Risk of injury!

→ Do not use the product to cut hedges, to chop up material or to make compost.

1. SAFETY

Important! Read the operator's manual carefully before use and keep for future reference.

Symbols on the product:



Read operator's manual.



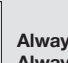

Keep bystanders away.





Always wear approved hearing protection.
Always wear approved eye protection.

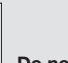

Remove the Battery before cleaning or maintenance.



Do not expose to rain.



DANGER! Risk of injury to other people!
Keep other people out of the area where you are working.



For the charger:
Remove plug from the mains immediately if the cable is damaged or cut.

General safety warnings

Electrical safety



DANGER! Electric shock!

Risk of injury due to electric shock.

→ The product must be supplied through a residual current device (RCD) having a rated residual operating current not exceeding 30 mA.

Do not overreach and keep the balance at all times. Always be sure of the footing on slopes. Walk, never run.

Do not touch moving hazardous parts before the machine is disconnected from the mains and the moving hazardous parts have come to a complete stop.
Always wear substantial footwear and long trousers while operating the machine.

Safe operating practices

1 Training

- a) Read the instructions carefully. Be familiar with the controls and the correct use of the machine.

b) Never allow children or people unfamiliar with these instructions to use the machine. Local regulations can restrict the age of the operator.

c) Keep in mind that the operator or user is responsible for accidents or hazards occurring to other people or their property.

2 Preparation

- a) Before use check the supply and extension cord for signs of damage or aging. If the cord becomes damaged during use, disconnect the cord from the supply immediately. **DO NOT TOUCH THE CORD BEFORE DISCONNECTING THE SUPPLY.** Do not use the machine if the cord is damaged or worn.

b) Before use, always visually inspect the machine for damaged, missing or misplaced guards or shields.

c) Never operate the machine while people, especially children, or pets are nearby.

3 Operation

- a) Keep supply and extension cords away from cutting means.

b) Wear eye protection and stout shoes at all times while operating the machine.

c) Avoid using the machine in bad weather conditions especially when there is a risk of lightning.

d) Use the machine only in daylight or good artificial light.

e) Never operate the machine with damaged guards or shields or without guards or shields in place.

f) Switch on the motor only when the hands and feet are away from the cutting means.

g) Always disconnect the machine from the power supply (i.e. remove the plug from the mains, remove the disabling device or removable battery)

1) whenever the machine is left unattended;

2) before clearing a blockage;

3) before checking, cleaning or working on the machine;

4) after striking a foreign object;

5) whenever the machine starts vibrating abnormally.

h) Take care against injury to feet and hands from the cutting means.

i) Always ensure that the ventilation openings are kept clear of debris.

4 Maintenance and storage

- a) Disconnect the machine from the power supply (i.e. remove the plug from the mains, remove the disabling device or removable battery) before carrying out maintenance or cleaning work.

b) Use only the manufacturer's recommended replacement parts and accessories.

c) Inspect and maintain the machine regularly. Have the machine repaired only by an authorized repairer.

d) When not in use, store the machine out of the reach of children.

Additional safety warnings



Battery safety

The battery to be charged must be placed on a nonflammable, heat resistant and non-conductive surface while charging.
The battery must not be charged unattended.
The supply terminals are not to be short-circuited.
Keep corrosive, flammable and easily combustible objects clear of the battery charger and the battery.
Do not cover the battery charger and the battery while charging.
Disconnect the battery charger immediately in the event of smoke formation or fire.
Only use FLYMO batteries for the FLYMO battery product. FLYMO cannot accept any liability for the batteries of other manufacturers. If they are of minor quality, they could cause a fire or explosion hazard!
Do not use the FLYMO charger to charge external rechargeable batteries, as FLYMO cannot guarantee compatibility and could therefore present a risk of fire or explosion.
Do not charge non-rechargeable batteries.

 **DANGER! Risk of explosion!**
Protect batteries from heat and fire. Do not leave on radiators or expose to strong sunshine for long periods.
Do not operate in explosive atmospheres, such as in the presence of flammable liquids, gases, or dust. Batteries may create sparks which could ignite the dust or fumes.
Check your battery before each use. Visually check the battery before each use. A non-functioning battery must be disposed of correctly. Do not send by post. For further details, please contact your local disposal companies.
For risks of injury do not use the battery as a power source for other products.

Only use the battery for the FLYMO product intended.

Only charge and use the battery in ambient temperatures of between 0 °C and 40 °C. Allow battery to cool down after long periods of use.

Check the charging cable regularly for signs of damage or ageing (brittleness). Only use it in perfect condition.

Do not stow or transport the battery above 45 °C or in direct sunlight. Ideally, the battery should be stored below 25 °C so that self-discharge is low.

Do not expose the battery to rain, water (immersion) or wet conditions.

Keep battery in order (clean) especially air vents.

If usage of the battery is not planned for a certain time (winter period) reload the battery to avoid a deep discharge.

Do not store the battery in a product to prevent self-discharge, misuse and accidents.

Do not store the battery in places where static electricity is present.

Electrical safety



DANGER! Cardiac arrest!

This product makes an electromagnetic field while it operates. This field may under some conditions interfere with active or passive medical implants. To decrease the risk of conditions that can possibly injure or kill, we recommend persons with medical implants to speak with their physician and the medical implant manufacturer before you operate the product.

Only use the battery product between –10 °C and 40 °C.

Thoroughly inspect the area where the product is to be used and remove all wires and other foreign objects.

In case of an unintended start (e.g. due to a welded switch) disconnect the battery immediately from device and let the product be repaired by the FLYMO service.

Disconnect the product from the mains and disconnect the battery if the product starts to vibrate abnormally. Check immediately. Excessive vibration can cause injury.

Do not use the product near water.

Do not operate next to swimming pools or garden ponds.

Protect the electrical contacts of the battery from moisture.

Personal safety



DANGER! Risk of suffocation!

Small parts can be easily swallowed. There is also a risk that the poly-bag can suffocate toddlers. Keep toddlers away when you assemble the product.

The battery contacts can be hot after use. Be careful of the hot contacts when removing the battery.

Know how to stop the product quickly in an emergency.

Avoid contact with the oil of the blade, allergic reaction is possible.

Only work in the daylight or when visibility is good.

Check your product before each use. Always visually inspect your trimmer before each use. Check that the ventilation slots are not obstructed in any way.

If the product gets hot whilst in operation, allow it to cool down before storage.

Warning! When wearing hearing protection, and due to the noise produced by the product, the operator may not notice persons approaching.

Always wear suitable clothing, protective gloves, and stout shoes.

Always ensure that you have a secure foothold whilst working.

2. ASSEMBLY



DANGER! Risk of injury!

Cut injury when the product starts accidentally.

→ Wait for the trimmer line to stop and remove the battery before you assemble the product.

To assemble the switch handle to the tube [Fig. A1]:

→ Ensure that the internal cable is not twisted.

1. Insert the tube into the switch handle.
2. Push until it clicks into position.

• ENSURE THAT THE TUBE IS FULLY LOCATED BY ATTEMPTING TO REMOVE IT.

To assemble the trimmer head to the tube [Fig. A2]:

→ Ensure that the internal cable is not twisted.

1. Insert the tube into the trimmer head.
2. Push until it clicks into position.

• ENSURE THAT THE TUBE IS FULLY LOCATED BY ATTEMPTING TO REMOVE IT.

To assemble the wheel [Fig. B1/B2]:

1. Attach the wheel to the trimmer making sure that it is located into the BOTTOM groove on the trimmer head as illustrated in **Fig. B1**.
2. Clip the wheel together on each side making sure it is secure (**B2**).
3. The wheel should turn freely.

To assemble the plant guard [Fig. B3/B4]:

→ Open the plant guard as illustrated in **Fig. B3** and place into the TOP groove on the trimmer head. Rotate the plant guard clockwise until it CLICKS into its parked position (**B4**).

To assemble the safety guard [Fig. C1/C2]:

1. Locate the safety guard over the cutting head. Ensure the nylon line is fed through the hole in the safety guard as illustrated in **Fig. C1**.
2. Push into location and turn safety guard in the direction illustrated in **Fig. C2**, until a click is heard and the safety guard is securely locked in position.

→ ENSURE THE SAFETY GUARD IS SECURELY IN PLACE BY ATTEMPTING TO TWIST GUARD.

To assemble the steady handle [Fig. D]:

1. Pull the steady handle release lever towards the handle grip.
2. Depress the two buttons on the side of the steady handle.
3. Locate the buttons into the main handle and release the lever.
4. Adjust the steady handle to the most comfortable operating position by pulling the release lever and moving the handle.

To adjust the height [Fig. E]:

1. Turn height adjuster (**E1**) in the direction indicated to un-lock (**E2**).
2. Adjust the length of the tube to the most comfortable operating position.
3. Turn height adjuster in the opposite direction to lock (**E3**).

→ ENSURE THAT THE TUBE IS FULLY SECURED.

3. OPERATION



DANGER! Risk of injury!

Cut injury when the product starts accidentally.

→ Wait for the trimmer line to stop and remove the battery before you adjust or transport the product.

To charge the battery:



CAUTION!

→ **Note the mains voltage!** The voltage of the power source must match the voltage specified on the rating plate of the charger.

1. If over a period of time the battery pack quickly runs down after a full 2.5 – 3 hour charging period, a replacement battery pack is needed.
 2. There will be some charge present in the battery pack but to ensure maximum running time, charge your battery pack for 2.5 – 3 hours before first use.
 3. To prevent permanent battery pack damage, never store in a discharged condition.
 4. Contact your local approved service centre/dealer/distributor for a replacement battery pack and for safe disposal of your old battery pack.
 5. **Battery** 20 Volt DC, 2.5 AmpHour, Li-ion, (Model B16-2025).
- **IMPORTANT! DISPOSE OF YOUR OLD BATTERY PACK SAFELY DO NOT CUT OPEN, BURN OR INCINERATE.**
- **For further information on Battery Pack replacement contact your local dealer.**

Initial charging procedure [Fig. F]:

1. Use the charger indoors only.
2. Ensure the charger is not exposed to moisture. Keep the charger and the battery pack dry at all times. Keep the charger well ventilated during charging.
3. Attach the charger connector (**F1**) to the battery pack.
4. Plug the charger (**F2**) into a suitable household electrical wall socket and switch on.

5. The red indicator lamp (**F3**) glows continuously during charging.
6. Full charge will be achieved in 3 hours after which the indicator lamp on the charger (**F3**) will turn to green. During charging the charger becomes warm. This is normal and means the charger is operating correctly.

To re-charge the battery pack:

1. Re-charge the battery pack as soon as the cutting power of your trimmer begins to die and slow down.
2. Avoid running the battery pack into "deep" discharge, i.e. avoid flattening the battery pack completely.
3. Follow the procedure outlined in the *Initial charging procedure*.
4. Charging the battery pack according to these instructions should ensure maximum battery life.

To assemble the battery pack [Fig. G]:

1. Attach the Battery Pack as illustrated in **Fig. G**, ensuring that it clicks into position and is located firmly.
2. To remove, press the button (**G1**) on the end of the Battery Pack and slide off.

How to use the lawn trimmer:



DANGER! Risk of injury!

Risk of injury if the product does not stop when you release the start levers.

→ Do not bypass the safety devices or switches. For example do not attach the switch lever to the handle.



WARNING!

→ The use of eye protection is recommended.
Do not lean over the trimmer whilst trimming or edging, objects may be thrown by the cutting line.
Do not allow cutting head to rest on the ground.
Do not overload your trimmer.
Overloading can be avoided by making sure the motor speed does not drop unduly.

→ BEFORE USE: Make sure that the line is fed out.

→ Make sure motor is up to full speed before trimming or edging.

The product is provided with a two-handed safety device (switch lever with safety lock-off) to prevent the product from being turned on by accident.

How to trim [Fig. H/J/K]:

1. To start, squeeze the safety lock-off (**H1**) and then the switch lever (**H2**).
2. Cut with nylon line at an angle using the tip (**J**).
3. Swing trimmer in and out of the cutting area taking small cuts (**K**).
4. Line is fed out automatically every time the trimmer head stops rotating and returns to operating speed.
→ Extra line can be fed out manually as described in *Manual line feed*
5. To stop your trimmer release the switch lever.
The cutting head will stop in approximately one second.

Using the plant and tree guard [Fig. K1/K2]:

The plant and tree guard allows the trimming of grass close to plants and trees without damaging them with the cutting line.

1. Rotate the guard into it's forward position as illustrated in **Fig. K1**.
2. Use the trimmer around trees (**K2**) and near plants.

How to edge [Fig. B4/H/L/M]:

1. Ensure the plant guard is in the PARK position (**B4**).
2. To convert to edging mode, press button (**L1**) and twist head (**L2**).
An audible "click" will confirm that the head is locked.
3. Hold as illustrated in **Fig. H**.
4. To start, squeeze the safety lock-off (**H1**) and then the switch lever (**H2**).
5. Rest edger on wheel for extra stability and line up the edge of the lawn.
Edge in direction indicated in **Fig. M**.
6. To stop your trimmer release the switch lever.
7. To return to trimming mode, press button and twist head back the opposite way. An audible CLICK will confirm that the head is locked.

→ When edging, ensure that the edging wheel is always resting on the grass (and not on the path/driveway).

Using the Shrubbing position [Fig. N/O]:

→ By pressing the lever (**N1**) with your foot, the handle can be lowered into three different positions to enable the use of the product under shrubs and low obstacles (**O**).

Auto line feed system [Fig. P]:

1. When initially switching on the trimmer, a small length of line is fed out.
2. A 'clattering' noise will be heard when the nylon line hits the line cutter (**P1**). **DO NOT BE ALARMED this is quite normal.** After approximately 5 seconds the line will be cut to the correct length and the noise will reduce as the motor reaches full speed.

→ Make sure motor is up to full speed before trimming or edging.

3. If the noise of the nylon line being cut cannot be heard, more line will need to be fed out.
4. To feed more line, it is first necessary to allow the motor to stop completely, then re-start, allowing the motor to reach full speed.
5. Repeat step 4. until you hear the line hitting against the cutter.
(Do not repeat this procedure more than 6 times.)
6. If problems are experienced with the automatic line feed refer to 6. TROUBLESHOOTING.

To manually feed the nylon line [Fig. Q]:

1. If required line can be fed out manually.
2. To operate, press and release manual line feed button (**Q1**), whilst gently pulling on the line until it reaches the line cutter.
3. If the line extends past the line cutter, too much line has been fed out.
4. If too much line is fed out, remove the spool cap and click spool anti-clockwise until the line is at the desired length.

Cutting head [Fig. R/S/T]:

To remove spool cap:

1. Press and hold in the two cap release latches (**R1**).
2. Pull cap away from the spoolholder (**R3**).

To refit the spool cap:

1. Keep all areas of the cap (**R2**) and spoolholder (**R3**) clean. Failure to do so may prevent the cap being securely located in the spoolholder.
2. Replace the cap, **pressing firmly DOWN** towards the spoolholder to ensure cap is fully located.
3. Check that the cap is correctly fitted by trying to remove it without depressing the two latches.

To replace nylon line:

For your convenience it is recommended you buy spool (**R4**) and line complete. Nylon line only is also available. Both are available from your local dealer.

To fit spool and line complete:

1. Remove old spool (**R4**).
2. Place new spool into spoolholder (**R3**) with cut out area of the spool (**S1**) in line with eyelet as shown in **Fig. S2**.
3. Release line from cleat (**T1**) and feed line through eyelet (**S**).

→ Ensure spool (**R4**) is fully located by gently rotating it during fitment, whilst keeping the spoolholder (**R3**) steady.

4. Refit the cap (**R2**).

To fit nylon line only:

→ Remember!

Your product is designed to use only nylon line with a maximum diameter of 1.5 mm. Use only genuine Flymo nylon line.

1. Take approximately 10 metres of line. Insert 15 mm of line into the hole in the spool (**T**) and wind line in the direction of the arrows on the top of the spool. Leave approximately 100 mm of line unwound and place into cleat as illustrated in **Fig. T1**.
2. Care should be taken to ensure that the line is neatly coiled on the spool. Failure to do so will impair the efficiency of the automatic line feed.
3. Then fit spool as described in *To fit spool and line complete*, section above.

Always return the product to its normal operating position before switching on.

4. MAINTENANCE



DANGER! Risk of injury!

Cut injury when the product starts accidentally.

- Wait for the trimmer line to stop and remove the battery before you maintain the product.
- Cutting head continues to rotate after the trimmer has been switched off. Keep fingers and hands clear of the line cutter on leading edge of guard.

To clean the lawn trimmer [Fig. V/W/X/Y]:



DANGER! Risk of injury!

Risk of injury and risk of damage to the product.

- Do not clean the product with water or with a water jet (in particular high-pressure water jet).
- Do not clean with chemicals including petrol or solvents. Some can destroy critical plastic parts.

The airflow slots must always be clean.

After you have finished using your trimmer follow the procedure below:

- Using a soft brush, clean around the inside of the safety guard, the cutting head (V) and the motor housing air vents (W).
- Remove the wheel by pressing one of the buttons. Clean the wheel (X) and groove (Y) on the trimmer head with a soft brush.
- Attach wheel as described in 2. ASSEMBLY To assemble the wheel.
- Inspect the trimmer carefully, especially the parts of the cutting head.
- If your trimmer is damaged in any way contact your local Husqvarna service centre.

→ Never use a damaged trimmer.

To clean the battery and the battery charger:

Make sure that the surface and the contacts of the battery and the battery charger always are clean and dry before you connect the battery charger.

Do not use running water.

- **Battery charger:** Clean the contacts and the plastic parts with a soft and dry cloth.
- **Battery:** Occasionally clean the ventilation slots and the terminals on the battery using a soft brush that is clean and dry.

5. STORAGE

To put into storage:

The product must be stored away from children.

- Remove the battery.
- Fully charge the battery pack for 2.5 – 3 hours before winter storage. Re-charge the battery pack every 3 to 4 months for a full 2.5 – 3 hour charging period to top up the battery charge during winter storage. Avoid extended storage without re-charge.
- Clean the trimmer, the battery and the battery charger (see 4. MAINTENANCE).
- Allow the product to cool for at least 30 minutes before storing.
- Store the trimmer, the battery and the battery charger in a dry, enclosed and frost-free place.

Disposal:

(in accordance with RL2012/19/EC/S.I. 2013 No. 3113)



The product must not be disposed of to normal household waste. It must be disposed of in line with local environmental regulations.

IMPORTANT!

- Dispose of the product through or via your municipal recycling collection centre.

Disposal of the battery:



The battery contains lithium-ion cells that should not be disposed of with normal household waste at the end of its life.

Li-ion

IMPORTANT!

- Dispose of the batteries through or via your municipal recycling collection centre.

- Discharge the lithium-ion cells completely (contact the FLYMO Service).
- Protect the contacts on the lithium-ion cells against short circuits.
- Dispose of the lithium-ion cells properly.

6. TROUBLESHOOTING



DANGER! Risk of injury!

Cut injury when the product starts accidentally.

- Wait for the trimmer line to stop and remove the battery before you troubleshoot the product.

Problem	Possible Cause	Remedy
Line not feeding or Line to short or Trimmer vibrates	Automatic line feed not working.	→ Manually feed out line see 3. OPERATION To manually feed the nylon line.
	Line fed out and visible. Line has been removed from cleat.	→ Remove cap and spool, free line and re-fit spool and cap, see 3. OPERATION Cutting head.
	Manual line feed not working.	→ The line may be jammed on the spool. Rewind line to remove crossed loops. Check that line is in correct section of spool.
Continuous clattering noise	Motor has not reached full speed before use.	→ Allow the motor to reach full speed before use.
	Too much line has been fed out.	→ See 3. OPERATION To manually feed the nylon line.
	The line cutter is missing from the safety guard.	→ Contact your local approved Service Centre or Husqvarna Customer Service.
Line snaps continuously	The trimmer has not been used correctly.	→ Only use tip of nylon line to trim, see 3. OPERATION How to trim and How to edge.
	The line is jamming on the spool.	→ Rewind the line on the spool, if symptoms still persist, change spool and line.
Wheel stops turning	→ Clean wheel and groove on trimmer head (see 4. MAINTENANCE).	



NOTE: For any other malfunctions please contact the FLYMO service department. Repairs must only be done by FLYMO service departments or specialist dealers approved by FLYMO.

7. TECHNICAL DATA

Battery Lawn Trimmer	Unit	Value
Contour Cordless 20V Li		
Cutting width	cm	25
Speed of rotation of cutting device	rpm	9,000
Cutting filament diameter	mm	1.5
Trimmer line supply	m	10
Trimmer line feed		automatically / manually
Weight (without Battery)	kg	2.5
Sound pressure level L_{pA} ¹⁾	dB (A)	73.4
Uncertainty k_{pA}		3.0
Sound power level L_{WA} ²⁾ : measured / guaranteed	dB (A)	88 / 92
Uncertainty k_{WA}		4.0
Hand / arm vibration a_{vhw} ¹⁾	m/s ²	1.607
Uncertainty k_{vhw}		1.5

Measuring process complying with: ¹⁾ EN 50636-2-91 ²⁾ RL 2000/14/EC / S.I. 2001 No.1701



NOTE: The stated vibration emission value has been measured according to a standardized test procedure and can be used for comparison of one electric power tool with another. It can also be used for preliminary evaluation of exposure. The vibration emission value can vary during actual use of the electric power tool.

Battery	Unit	Value Li-ion 20V (Model B16-2025)
Battery voltage	V (DC)	20
Battery capacity	Ah	2.5
Battery charging time	h	2.5 – 3.0
Idling time (with full battery) (approx.)	min.	up to 33
Battery Charger	Unit	Value
Mains voltage	V (AC)	100 – 240
Mains frequency	Hz	50 – 60
Battery charging voltage	V (DC)	20
Max. battery charging current	A	1.0

8. ACCESSORIES

FLYMO Spool and Line

Reference no.: FLY047
Part no.: 510747890

9. SERVICE/WARRANTY

Service:

Please contact the address on the back page.

Warranty statement:

In the event of a warranty claim, no charge is levied to you for the services provided.

Husqvarna UK Ltd. grants a warranty for all original FLYMO new products for two years from the date of original purchase from the retailer, provided that the devices have been for private use only. This manufacturer's warranty does not apply to products acquired second hand. This warranty includes all significant defects of the product that can be proved to be material or manufacturing faults. This warranty is fulfilled by supplying a fully functional replacement product or by repairing the faulty product sent to us free of charge; we reserve the right to choose between these options. This service is subject to the following provisions:

- The product has been used for its intended purpose as per the recommendations in the operating instructions.
- Neither the purchaser nor a third party has attempted to open or repair the product.
- Only Original FLYMO replacement parts and wear parts have been used for operation.
- Presentation of the receipt.

Normal wear and tear of parts and components (such as blades, blade fixing parts, turbines, light bulbs, V-belts/toothed belts, impellers, air filters, spark plugs), visual changes, wear parts and consumables are excluded from the warranty.

This manufacturer's warranty is limited to replacement and repair of products in accordance with the abovementioned conditions. The manufacturer's warranty does not constitute an entitlement to lodge other claims against us as a manufacturer, such as for damages. This manufacturer's warranty does **not**, of course, affect statutory and contractual warranty claims against the dealer/retailer.

The manufacturer's warranty is governed by the law of the Federal Republic of Germany.

In case of a warranty claim, please return the faulty product, together with a copy of the receipt and a description of the fault, with postage paid to the service address.

Consumables:



Nylon line, Spool and Line are consumables and not included in the warranty.

EN *Product liability*

In accordance with the German Product Liability Act, we hereby expressly declare that we accept no liability for damage incurred from our products where said products have not been properly repaired by a FLYMO-approved service partner or where original FLYMO parts or parts authorised by FLYMO were not used.

EC DECLARATION OF CONFORMITY

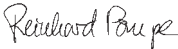
The undersigned hereby certifies as the authorized representative of the manufacturer, Husqvarna AB, 561 82 Huskvarna, Sweden, that, when leaving our factory, the unit(s) indicated below is/are in accordance with the harmonised EU guidelines, EU standards of safety and product specific standards. This certificate becomes void if the unit(s) is/are modified without our approval.

Description of the product:	Lawn Trimmer Contour Cordless	
Product type:	20V Li	
Article-Number:	9679244-xx	
CE-Directives:	2006/42/EC 2014/30/EU 2011/65/EU 2000/14/EC Charger: 2014/35/EU	
Harmonised EN:	EN ISO 12100 EN 60335-1 EN 50636-2-91 Charger: EN 60335-2-29	
Deposited Documentation:	GARDENA Technical Documentation, M. Jäger, 89079 Ulm	
Conformity Assessment according to:	According to 2000/14/EG: Art. 14 Annex VI	
Noise level: measured / guaranteed	88 dB(A) / 92 dB(A)	
Ulm, 07.09.2021 Authorised representative:	 Reinhard Pompe Vice President Products	 Wolfgang Engelhardt Vice President Supply Chain

UKCA DECLARATION OF CONFORMITY (ONLY FOR UK)

The manufacturer: Husqvarna AB SE 561 82 Huskvarna, Sweden hereby certifies, when leaving our factory, the unit(s) indicated below is/are in accordance with the UK Regulations, designated standards of safety and product specific designated standards. This certificate becomes void if the units are modified without our approval.

Description of the Product:	Lawn Trimmer Contour Cordless
Product type:	20V Li
Article Number:	9679244-xx
UK regulations:	S.I. 2008/1597 S.I. 2016/1091 S.I. 2012/3032 S.I. 2001/1701 Charger: S.I. 2016/1101
Designated Standards:	EN ISO 12100 EN 60335-1 EN 50636-2-91 Charger: EN 60335-2-29
Authorised Representative:	Husqvarna UK Limited
Deposited Documentation:	Preston Road, Aycliffe, County Durham UK DL5 6 UP
Noise level: measured / guaranteed	88 dB(A) / 92 dB(A)
Conformity Assessment according to:	According to S.I. 2001/1701 Art. 11 Schedule 9
Aycliffe, 07.09.2021 Authorised Representative:	 John Thompson Director

Serviceaddress and Importer to

Great Britain

Husqvarna UK Ltd
Preston Road
Aycliffe Industrial Park
Newton Aycliffe
County Durham
DL5 6UP
Phone: +44 (0) 344 8444558
customer.services@husqvarna.co.uk



42020-85.960.01/0921
Husqvarna AB
S-561 82 Huskvarna
Sweden

Our policy of continuous improvement means that the specification of products may be altered from time to time without prior notice.

Copyright © 2021 Flymo S.A. All rights reserved.

Flymo® and other product and feature names are registered or unregistered trademarks of Flymo S.A.