

597902801 54 CCC BOLT ON BAFFLE KIT INSTRUCTIONS



Please read the operator's manual carefully and ensure you understand the instructions. The instructions will enable you to assemble and maintain your tractor properly. Always observe the "SAFETY RULES".

KIT CONTENTS:

KEY NO.	PART NO.	DESCRIPTION	QTY.
1	597902602	Standon 54 CCC RH Front, Bolt-In Baffle	1
2	595901501	5/16-18 X 1 Carriage Bolt	2
3	594944401	5/16-18 Nyloc Flange Nut	2
4	597903001	Baffle Service Kit Instruction Sheet	1

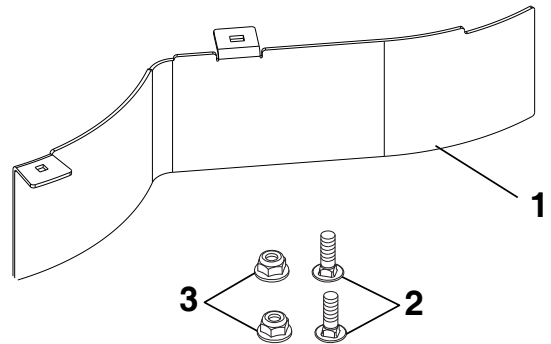

1. Bolt in baffles using the two nuts and two bolts and torque nuts to 15-20 ft-lbs.
2. Spin blades by hand to ensure blades do not contact baffles.

NOTE: Blades should be approximately 1/2" from baffles.

