

Classic 3500/4 Art. 1757

<b>DE</b>	<b>Betriebsanleitung</b> Haus- & Gartenautomat
<b>EN</b>	<b>Operator's manual</b> Automatic Home & Garden Pump
<b>FR</b>	<b>Mode d'emploi</b> Automate pour la maison et le jardin
<b>NL</b>	<b>Gebruiksaanwijzing</b> Elektronische hydrofoorpomp
<b>SV</b>	<b>Bruksanvisning</b> Pumpautomat för hem och trädgård
<b>DA</b>	<b>Brugsanvisning</b> Hus- & haveautomat
<b>FI</b>	<b>Käyttöohje</b> Paine- ja puutarhapumppu
<b>NO</b>	<b>Bruksanvisning</b> Hus- og hageautomat
<b>IT</b>	<b>Istruzioni per l'uso</b> Pompa automatica per uso domestico e giardino
<b>ES</b>	<b>Instrucciones de empleo</b> Estación de bombeo para casa y jardín
<b>PT</b>	<b>Manual de instruções</b> Bomba de pressão para casa e jardim
<b>PL</b>	<b>Instrukcja obsługi</b> Hydrofor elektroniczny
<b>HU</b>	<b>Használati utasítás</b> Háztartási- és kerti automata szivattyú
<b>CS</b>	<b>Návod k obsluze</b> Domácí a zahradní automat
<b>SK</b>	<b>Návod na obsluhu</b> Domáci a záhradný automat

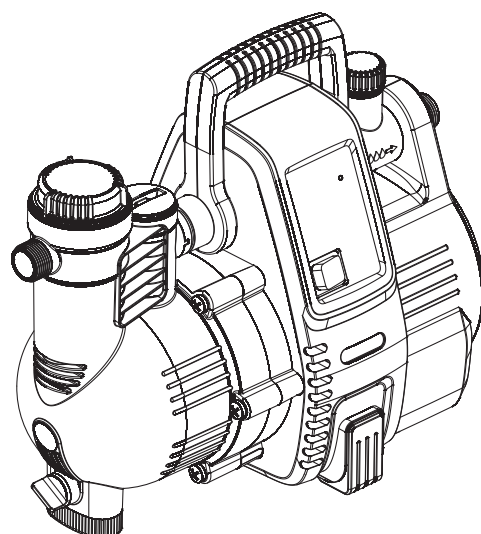

Comfort 4000/5 Art. 1758

<b>EL</b>	<b>Οδηγίες χρήσης</b> Πιεστική αντλία νερού οικιακής χρήσης & κήπου
<b>RU</b>	<b>Инструкция по эксплуатации</b> Автоматический напорный насос
<b>SL</b>	<b>Navodilo za uporabo</b> Hišni in vrtni avtomat
<b>HR</b>	<b>Upute za uporabu</b> Kućni & vrtni automat
<b>SR/BS</b>	<b>Uputstvo za rad</b> Kućni i baštenski hidropak
<b>UK</b>	<b>Інструкція з експлуатації</b> Автоматична станція побутового й садового водопостачання
<b>RO</b>	<b>Instrucțiuni de utilizare</b> Pompa automată pentru casă & grădină
<b>TR</b>	<b>Kullanma Kılavuzu</b> Ev ve bahçe otomati
<b>BG</b>	<b>Инструкция за експлоатация</b> Автоматична помпа за дома и градината
<b>SQ</b>	<b>Manual përdorimi</b> Pompë automatike për shtëpi & kopsht
<b>ET</b>	<b>Kasutusjuhend</b> Automaatne majapidamis- ja aiapump
<b>LT</b>	<b>Ekspluatavimo instrukcija</b> Buitinis ir sodo siurblys
<b>LV</b>	<b>Lietošanas instrukcija</b> Ūdens apgādes automāts mājai un dārzam

<p><b>DE Produkthaftung</b> Wir weisen ausdrücklich darauf hin, dass wir in Übereinstimmung mit dem Produkthaftungsgesetz nicht für Schäden haften, die durch unsere Produkte entstehen, wenn diese unsachgemäß und nicht durch einen von uns autorisierten Servicepartner repariert wurden oder wenn keine Original GARDENA Teile oder von uns zugelassene Teile verwendet wurden.</p>
<p><b>EN Product liability</b> In accordance with the German Product Liability Act, we hereby expressly declare that we accept no liability for damage incurred from our products where said products have not been properly repaired by a GARDENA-approved service partner or where original GARDENA parts or parts authorised by GARDENA were not used.</p>
<p><b>FR Responsabilité</b> Conformément à la loi relative à la responsabilité du fait des produits défectueux, nous déclarons expressément par la présente que nous déclinons toute responsabilité pour les dommages résultant de nos produits, si lesdits produits n'ont pas été correctement réparés par un partenaire d'entretien agréé GARDENA ou si des pièces d'origine GARDENA ou des pièces agréées GARDENA n'ont pas été utilisées.</p>
<p><b>NL Productaansprakelijkheid</b> Conform de Duitse wet inzake productaansprakelijkheid verklaren wij hierbij uitdrukkelijk dat wij geen aansprakelijkheid aanvaarden voor schade ontstaan uit onze producten waarbij deze producten niet zijn gerepareerd door een GARDENA-erkende servicepartner of waarbij geen originele GARDENA-onderdelen of onderdelen die door GARDENA zijn goedgekeurd zijn gebruikt.</p>
<p><b>SV Produktansvar</b> I enlighet med tyska produktansvarslagar förklarar vi härmed uttryckligen att vi inte åtar oss något ansvar för skador som orsakas av våra produkter där produkterna inte har genomgått korrekt reparation från en GARDENA-godkänd servicepartner eller där originaldelar från GARDENA eller delar godkända av GARDENA inte använts.</p>
<p><b>DA Produktansvar</b> I overensstemmelse med den tyske produktansvarslov erklærer vi hermed udtrykkeligt, at vi ikke påtager os noget ansvar for skader på vores produkter, hvis de pågældende produkter ikke er blevet repareret korrekt af en GARDENA-godkendt servicepartner, eller hvor der ikke er brugt originale GARDENA-reservedele eller godkendte reservedele fra GARDENA.</p>
<p><b>FI Tuotevastuu</b> Saksan tuotevastuulain mukaisesti emme ole vastuussa laitteiden vaurioista, jos korjauksia ei ole tehnyt GARDENA:n hyväksymä huoltoliike tai jos niiden synnä on muiden kuin alkuperäisten GARDENA-varaosien tai GARDENA:n hyväksymien varaosien käyttö.</p>
<p><b>IT Responsabilità del prodotto</b> In conformità con la Legge tedesca sulla responsabilità del prodotto, con la presente dichiariamo espressamente che decliniamo qualsiasi responsabilità per danni causati dai nostri prodotti qualora non siano stati correttamente riparati presso un partner di assistenza approvato GARDENA o laddove non siano stati utilizzati ricambi originali o autorizzati GARDENA.</p>
<p><b>ES Responsabilidad sobre el producto</b> De acuerdo con la Ley de responsabilidad sobre productos alemana, por la presente declaramos expresamente que no aceptamos ningún tipo de responsabilidad por los daños ocasionados por nuestros productos si dichos productos no han sido reparados por un socio de mantenimiento aprobado por GARDENA o si no se han utilizado piezas originales GARDENA o piezas autorizadas por GARDENA.</p>
<p><b>PT Responsabilidade pelo produto</b> De acordo com a lei alemã de responsabilidade pelo produto, declaramos que não nos responsabilizamos por danos causados pelos nossos produtos, caso os tais produtos não tenham sido devidamente reparados por um parceiro de assistência GARDENA aprovado ou se não tiverem sido utilizadas peças GARDENA originais ou peças autorizadas pela GARDENA.</p>
<p><b>PL Odpowiedzialność za produkt</b> Zgodnie z niemiecką ustawą o odpowiedzialności za produkt, niniejszym wyraźnie oświadczamy, że nie ponosimy żadnej odpowiedzialności za szkody poniesione na skutek użytkowania naszych produktów, w przypadku gdy naprawa tych produktów nie była odpowiednio przeprowadzana przez zatwierdzonego przez firmę GARDENA partnera serwisowego lub nie stosowano oryginalnych części GARDENA albo części autoryzowanych przez tę firmę.</p>
<p><b>HU Termékszavatosság</b> A németországi termékszavatossági törvénnyel összhangban ezennel nyomatékosan kijelentjük, hogy nem vállalunk felelősséget a termékeinkben keletkezett olyan károkért, amelyek valamely GARDENA által jóváhagyott szervizpartner által nem megfelelően végzett javításból adódtak, vagy amely során nem eredeti GARDENA alkatrészeket vagy a GARDENA által jóváhagyott alkatrészeket használtak fel.</p>
<p><b>CS Odpovědnost za výrobek</b> V souladu s německým zákonem o odpovědnosti za výrobek tímto výslovně prohlašujeme, že nepřijímáme žádnou odpovědnost za poškození vzniklá na našich výrobcích, kdy zmíněné výrobky nebyly řádně opraveny schváleným servisním partnerem GARDENA nebo kdy nebyly použity originální náhradní díly GARDENA nebo náhradní díly autorizované společností GARDENA.</p>
<p><b>SK Zodpovednosť za produkt</b> V súlade s nemeckými právnymi predpismi upravujúcimi zodpovednosť za výrobok týmto výslovné prehlasujeme, že nenesieme žiadnu zodpovednosť za škody spôsobené našimi výrobkami, v prípade ktorých neboli náležité opravy vykonané servisným partnerom schváleným spoločnosťou GARDENA alebo neboli použité diely spoločnosti GARDENA alebo diely schválené spoločnosťou GARDENA.</p>
<p><b>EL Ευθύνη προϊόντος</b> Σύμφωνα με τον γερμανικό νόμο περί Ευθύνης για τα Προϊόντα, με το παρόν δηλώνουμε ρητώς ότι δεν αποδεχόμαστε καμία ευθύνη για τυχόν ζημιές που προκύπτουν από τα προϊόντα μας εάν αυτά δεν έχουν επισκευαστεί σωστά από κάποιον συγκεκριμένο συνεργάτη επισκευών της GARDENA ή εάν δεν έχουν χρησιμοποιηθεί αυθεντικά εξαρτήματα GARDENA ή εξαρτήματα συγκεκριμένα από την GARDENA.</p>
<p><b>SL Odgovornost proizvajalca</b> V skladu z nemškimi zakoni o odgovornosti za izdelke, izrecno izjavljajo, da ne sprejemamo nobene odgovornosti za škodo, ki jo povzročijo naši izdelki, če teh niso ustrezno popravili GARDENINI odobreni servisni partnerji ali pri tem niso bili uporabljeni originalni GARDENINI nadomestni deli ali GARDENINIMI homologiranimi nadomestnimi deli.</p>
<p><b>HR Pouzdanost proizvoda</b> Sukladno njemačkom zakonu o pouzdanosti proizvoda, ovime izričito izjavljujemo kako ne prihvaćamo nikakvu odgovornost za oštećenja na našim proizvodima nastala uslijed neispravnog popravka od strane servisnog partnera kojeg odobrava GARDENA ili uslijed nekorištenja originalnih GARDENA dijelova ili dijelova koje odobrava GARDENA.</p>
<p><b>RO Răspunderea pentru produs</b> În conformitate cu Legea germană privind răspunderea pentru produs, declarăm în mod expres prin prezentul document că nu acceptăm nicio răspundere pentru defecțiunile suferite de produsele noastre atunci când acestea nu au fost reparate în mod corect de un atelier de service partener, aprobat de GARDENA, sau când nu au fost utilizate piese GARDENA originale sau piese autorizate de GARDENA.</p>
<p><b>BG Отговорност за вреди, причинени от стоки</b> Съгласно германския Закон за отговорността за вреди, причинени от стоки, с настоящото изрично декларираме, че не носим отговорност за щети, причинени от нашите продукти, ако те не са били правилно ремонтирани от одобрен от GARDENA сервиз или ако не са използвани оригинални части на GARDENA или части, одобрени от GARDENA.</p>
<p><b>ET Tootevastutus</b> Vastavalt Saksamaa tootevastutusseadusele deklareerime käesolevaga selgesõnaliselt, et me ei kanna mingisugust vastutust meie toodetest tingitud kahjude eest, kui need tooted ei ole korrektselt parandatud GARDENA heakskiidetud hoolduspartneri poolt või kui parandamisel ei ole kasutatud GARDENA originaalosi või GARDENA volitatud osi.</p>
<p><b>LT Gaminio patikimumas</b> Mes aiškiai pareiškiame, kad, atsižvelgiant į Vokietijos gaminių patikimumo įstatymą, nepriisiame atsakomybės dėl bet kokios žalos, patirtos dėl mūsų gaminių, jeigu jie buvo netinkamai taisomi arba jų dalys buvo pakeistos neoriginaliomis GARDENA dalimis ar nepatvirtintomis dalimis, arba jeigu remonto darbai buvo atliekami ne GARDENA techninės priežiūros centro specialistų.</p>
<p><b>LV Atbildība par produkcijas kvalitāti</b> Saskaņā ar Vācijas likumu par atbildību par produkcijas kvalitāti ar šo mēs paziņojam, ka neuzņemamies atbildību par bojājumiem, kas radušies, lietojot mūsu izstrādājumus, kuru remontu nav veicis uzņēmuma GARDENA apstiprināts apkopes partneris vai kuru remontam netika izmantotas oriģinālās GARDENA detaļas vai detaļas, kuru lietošanu apstiprinājis uzņēmums GARDENA.</p>

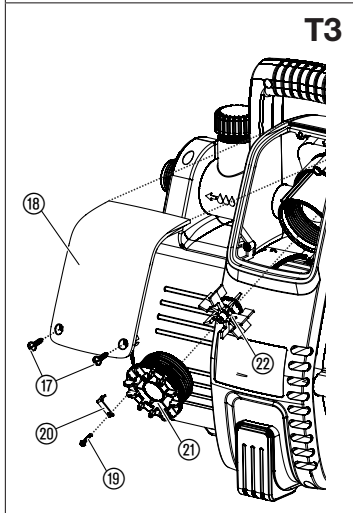
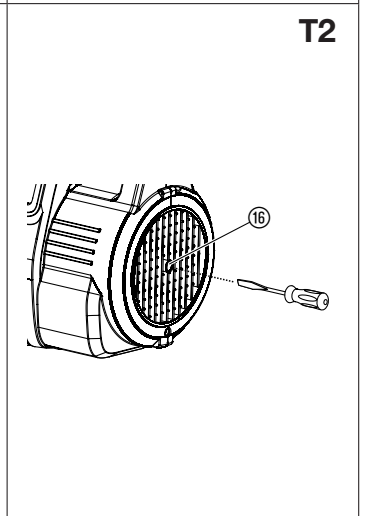
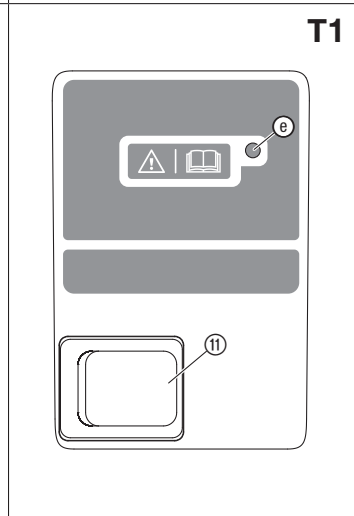
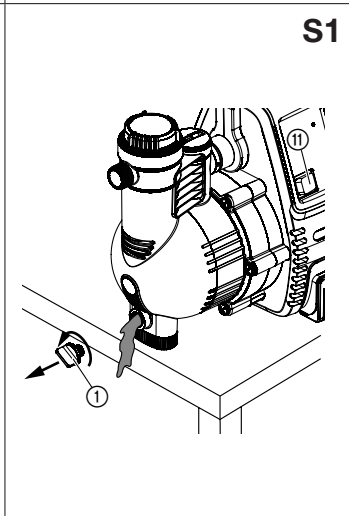
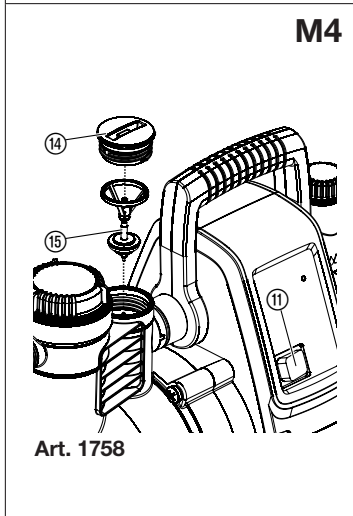
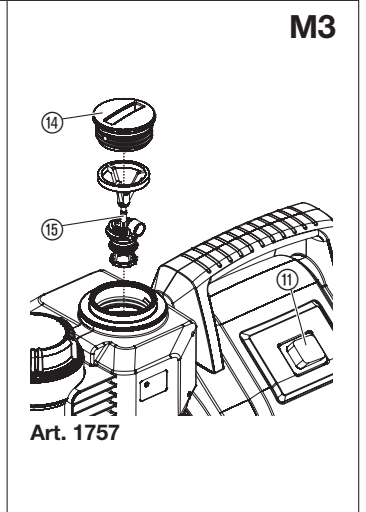
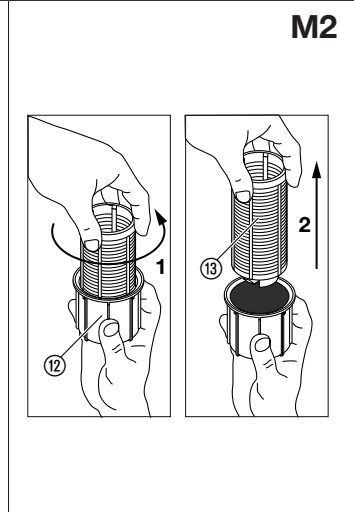
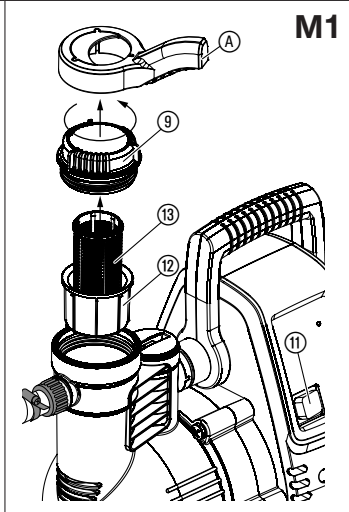
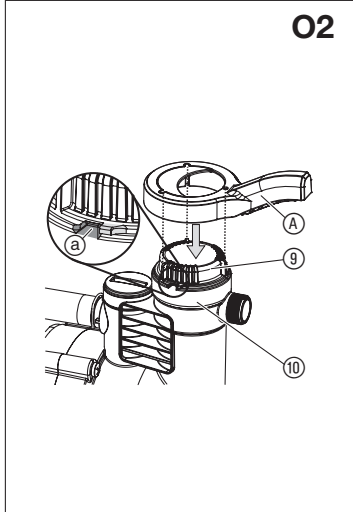
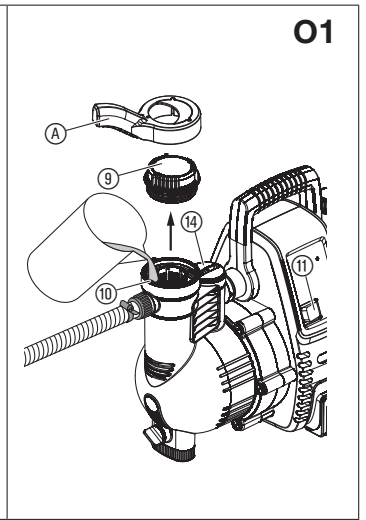
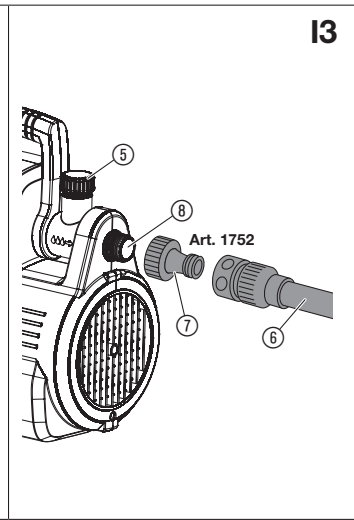
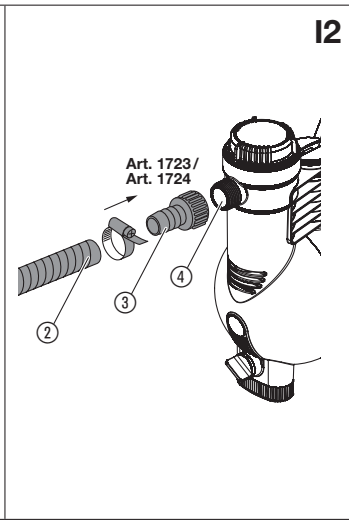
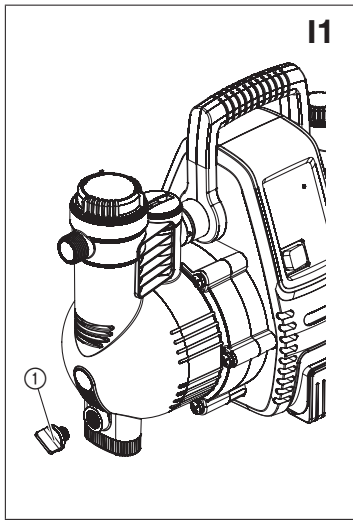

EN

1. SAFETY . . . . . 8  
 2. INSTALLATION . . . . . 9  
 3. OPERATION . . . . . 10  
 4. MAINTENANCE . . . . . 10  
 5. STORAGE . . . . . 10  
 6. TROUBLESHOOTING . . . . . 11  
 7. TECHNICAL DATA . . . . . 12  
 8. ACCESSORIES . . . . . 12  
 9. SERVICE/WARRANTY . . . . . 12

**Translation of the original instructions.**



This product may be used under supervision, or if instruction regarding the safe use of the product has been provided and the resulting dangers have been understood, by children aged 8 and above, as well as by persons with physical, sensory or mental disabilities or a lack of experience and knowledge. Children must not be allowed to play with the product. Cleaning and user maintenance must not be performed by children without supervision. The use of this product by young people under the age of 16 is not recommended.

**Intended use:**

The **GARDENA Automatic Home & Garden Pump** is intended for private use in the home and hobby garden and is not intended to be used for operating irrigation equipment and systems in public gardens. It can be used for pumping rainwater, tap water and chlorinated water.

The product is not intended for continuous operation (e.g. industrial applications, continuous circulating operation).

**DANGER! Corrosive, easily combustible, aggressive or explosive liquids (such as gasoline, petroleum or nitrothinner), saltwater and food intended for consumption must not be pumped.**

**Pressure amplification:**

If you use the pump for pressure amplification, the maximum permissible internal pressure must not exceed 6 bar (on the pressure side). With this in mind, the pump pressure must be added to the pressure to be amplified.

- Example: pressure at the tap = 2.0 bar.  
 Maximum pressure of the Automatic Home & Garden Pump Classic 3500/4 = 4.0 bar.  
 Total pressure = 6.0 bar.

**1. SAFETY**

**IMPORTANT!**  
 Read the operator's manual carefully before use and keep for future reference.

*Symbols on the product:*



Read operator's manual.

*General safety warnings*

*Electrical safety*



**DANGER! Electric shock!**  
 Risk of injury due to electric current.

→ The product must be supplied through a residual current device (RCD) having a rated residual operating current not exceeding 30 mA.



**DANGER! Electric shock!**  
 Risk of injury due to electric current.

→ Disconnect the product from the mains before you maintain or replace parts. Thereby the disconnected socket must be in the visual range.

### Safe operating practices

The water temperature should not exceed 35 °C.

The pump must not be used when people are in the water.

Leaking lubricants can contaminate the pumped liquid.

### Circuit breakers

Dry-running protection: If no water is pumped (undercurrent) the pump switches off automatically.

Anti-lock protection: If the motor blocks (overcurrent), the pump switches off automatically.

### Additional safety warnings

#### Electrical safety



**DANGER! Cardiac arrest!**

This product makes an electromagnetic field while it operates. This field may under some conditions interfere with active or passive medical implants. To decrease the risk of conditions that can possibly injure or kill, we recommend persons with medical implants to speak with their physician and the medical implant manufacturer before you operate the product.



**DANGER! Electric shock!**

The product must not be operated if there are people in the swimming pool or garden pond.

→ Make sure that the electrical plug and socket connections are fitted in an area which cannot be flooded.

→ Protect the power plug from moisture.

#### Connecting cable



**DANGER! Electric shock!**

With a cut off mains plug, moisture can get into electrical parts via the mains cable and cause a short circuit.

→ Do not cut the mains plug off (e. g. to feed through a wall).

If the supply cord is damaged, it must be replaced by the manufacturer, its service agent or similarly qualified persons in order to avoid a hazard.

According to DIN VDE (German Electrical Engineers' Association) 0620, mains power cables and extension cables must not have a smaller cross-section than the rubber-sheathed cables of the designation H07RN-F.

The cable length must be at least 10 m.

Data indicated on the type plate must match technical data of the mains supply.

Disconnect the product from the mains when it is not in use.

Protect plug and power cable from heat, oil and sharp edges.

Do not use the power cable to carry or to unplug the pump.

As an additional safety device an approved safety switch can be used.

→ Please ask your electrician for his advice.

Only use extension cables with earth connectors for operating this pump.

A damaged pump must not be used.

Before operating the pump look and see if there is any damage to the pump (especially to the power cable and plug).

→ In case of damage, please have the pump checked by our GARDENA Service Centre.

#### Personal safety



**DANGER! Risk of suffocation!**

Small parts can be easily swallowed. There is also a risk that the poly-bag can suffocate toddlers. Keep toddlers away when you assemble the product.



**DANGER! Risk of injury due to hot water!**

If the electronic control is defective or if the water supply on the intake side of the pump fails, any water remaining in the pump may heat up, generating a risk of injuries caused by hot water on leakage.

→ Disconnect the pump from the mains, let the water cool (approx. 10 – 15 min.) and secure the water supply on the intake side before putting into operation again.

Do not use the product while you are tired or under the influence of drugs, alcohol or medication. A moment of inattention while you operate the product may result in serious personal injury.

When connecting the pump to the water supply system, the country-specific sanitary regulations must be observed to prevent water not of drinking water quality being drawn back in.

When water flows through the pump it is no drinking water anymore.

When using the product, cover hair and do not wear scarves and other loose items of clothing.

Make sure that no children or unauthorised persons are within reach of the pump and the pumped medium without supervision.

In order to avoid dry-running of the pump, take care that the end of the suction hose is always submerged into the water.

→ Before each operation, fill the pump with liquid to be pumped (approx. 2 to 3 l).

The pump must be located on solid, even ground, protected from flooding. Take care that the pump cannot fall into water.

Very fine sand can pass through the integrated filter (mesh size 0.45 mm) and cause accelerated wear in the hydraulic parts.

→ For sandy water, you should additionally use the **GARDENA Pump Preliminary Filter, art. 1730** (mesh size 0.1 mm).

The temperature of the pumped liquid must be between 2 °C to 35 °C.

Only store the product in temperatures between 2 °C to 70 °C.

## 2. INSTALLATION



**DANGER! Electric shock!**

**Risk of injury due to electric current.**

→ Disconnect the product from the mains before you install the product.

#### Installation location [Fig. 11]:

The pump must be installed in a location with sufficient ventilation in the area of the ventilation slots. It must be at a distance of at least 5 cm from the walls. No dirt contamination (e.g. sand or soil) may be sucked in through the ventilation slots.

Set up the pump so that it is prevented from slipping and that an appropriately large collecting vessel for draining the pump or the system can be placed under the drain screw ①.

Install the pump at a safe distance (min. 2 m) from the pumping medium.

If possible, install the pump higher than the surface of the water to be pumped. If this is not possible, install a vacuum-resistant shut-off device between the pump and the suction hose to allow the integrated filter to be cleaned.

If the system is permanently installed, appropriate shut-off devices must be installed on the input and output sides. Important for maintenance and cleaning work on the pump or for shutdown, for example.

#### Connections:



**CAUTION!**

The GARDENA connection pieces on the intake and delivery sides may only be tightened by hand. Check whether the seal ring is present and undamaged before screwing the suction hose onto the suction inlet. When using metal connections, damage could occur on the connection thread due to inappropriate assembly. Therefore, screw on the connection fittings with the utmost care. Use sealing tape only for sealing metallic connection fittings.

#### Suction side:

Do not use modular water hose components on the suction side!

A vacuum-tight suction hose must be used e.g.:

- GARDENA Suction Hose Art. 1411/1418
- GARDENA Bore Hole Suction Hose Art. 1729
- GARDENA Suction Hose sold by the metre with GARDENA Hose Clamp Art. 7192/7191.

If very fine dirt is present, we recommend the use of a **GARDENA Pump preliminary filter Art. 1730/1731** in addition to the integrated filter.

To reduce the pump repriming time, we recommend to use a suction hose with backflow preventer, which prevents the suction hose emptying automatically when the Automatic Home & Garden Pump is switched off.

#### Important for fixed installation:

For greater suction heads, use a suction hose with a small diameter (3/4").

#### Pressure side:

A pressure-resistant hose must be used on the pressure side, e.g.:

- GARDENA Garden Hose (3/4") Art. 18113 with GARDENA Connection Set Art. 1752.

#### Important for fixed installation:

If the product is permanently installed in an enclosed space, only flexible hoses (e.g. reinforced hoses) may be used for connecting the service water supply, rather than rigid piping. Flexible hoses will reduce the noise

level and prevent damage caused by pressure surges. Install fixed pipes at an upward gradient on the first 2 m only. To avoid damage to the thread, ensure careful and accurate installation when using metal connections.

#### To connect the suction hose [Fig. I2]:

1. Screw the suction hose fitting ③ onto the suction inlet ④ and tighten it by hand.
2. Slide the suction hose ② onto the suction hose fitting ③ and secure it e.g. with a **GARDENA Hose Clamp Art. 7192/7191**.
3. For suction head exceeding 4 m secure the suction hose (e.g. by fastening it to a wooden post).  
*The pump and the suction hose are relieved from the weight of the water.*

#### To connect the pressure hose [Fig. I3]:

The pressure hose can be connected either to the delivery side 33.3 mm (G1)-thread of the 120° swivelling connection ⑤ and/or of the horizontal connection ⑧.

1. Screw the tap connector ⑦ onto the pressure outlet ⑤/⑧ and tighten it by hand.
2. Connect the pressure hose with hose connector ⑥ onto the tap connector ⑦.

## 3. OPERATION



**DANGER! Electric shock!**

**Risk of injury due to electric current.**

→ **Disconnect the product from the mains before you fill the pump.**

#### To start the Automatic Home & Garden Pump [Fig. O1/O2]:

**NOTE: The specified maximum self-priming level (see 7. TECHNICAL DATA) is reached only when the pump is full and the pressure hose is held up high directly upstream of the pressure output during the first self-priming phase. This ensures that the pumped medium cannot leak from the pressure hose. When using a full suction hose with a check valve, it is not necessary to hold up the pressure hose.**

1. Unscrew the lid ⑨ of the filter chamber with the spanner ① provided.
2. Slowly fill in the liquid to be pumped via the filler connection ⑩ up to the overflow (approx. 2 to 3 l) until the water level no longer drops under the suction side inlet or the water flows out at the horizontal connector.
3. **With fixed installation:** Unscrew the cover ⑭ and fill with liquid until it flows towards the horizontal connector.
4. Empty any water remaining in the delivery hose so that the air can escape during filling and priming.
5. Open any shut-off devices in the delivery line (watering accessories, tap, etc.) so that air can escape before the priming procedure begins.
6. **With fixed installation:** If the delivery line cannot be emptied due to fixed installation, unscrew the cover ⑭. Considerable amounts of liquid may escape. Please keep a sufficiently large receptacle at hand for collection.
7. Tighten the lid ⑨ of the filter chamber up to the stopper ③.
8. **Without fixed installation:** Lift up the delivery hose just behind the pressure outlet.
9. Plug the power plug of the connecting cable into a mains socket.
10. Push the on/off switch ⑪ to position **I**.  
*The on/off switch lights up and the pump starts.*

**The suction process can take up to 6 min. If no water is pumped afterwards, the pump will shut down automatically and display Error 2 (see 6. TROUBLESHOOTING).**

11. Close shut-off devices in the delivery pipeline again when the pump begins to deliver water continuously.

**The pump turns off automatically approx. 10 seconds after closing the shut-off device.**

**The pump is ready for operation (Standby).**

#### Electronic control:

The pump features an electronic controller.

If the pressure level falls below the start-up pressure, the pump is started automatically.

As soon as the water supply is no longer required, the pump is switched off automatically.

#### Low quantity programme and leakage warning:

##### Leakage warning:

In the event of a leakage or a dripping tap, the pressure constantly falls below the turn-on pressure and the pump switches itself on and off continuously.

If the pump is constantly switched on and off, the pump switches off automatically to prevent unwanted water leakage (error 4 "Leakage warning" is displayed).

##### Low quantity programme:

To prevent the pump from switching off earlier when used with low quantity of water (e.g. washing machines or drip irrigation), the leakage warning is only activated after 60 minutes.

**Switching the pump on and off cyclically during the small quantity program has no effect on the service life of the pump.**

##### Use of washing machines:

Upon completion of the low quantity water supply cycle in washing machines, the 60-minute operating interval of the low quantity programme is automatically reset to normal operation of the pump and allows a trouble-free use of the washing machine for > 60 minutes.

##### For continuous drip irrigation:

If the low quantity programme is to be used for more than 60 minutes, the irrigation must be disrupted for at least 5 minutes before the end of the 60 minute period. The low quantity programme can then be used for a further 60 minutes.

## 4. MAINTENANCE



**DANGER! Electric shock!**

**Risk of injury due to electric current.**

→ **Disconnect the product from the mains before you maintain the product.**

#### To clean the filter [Fig. M1/M2]:

1. If applicable, close all the shutoff devices on the intake side.
2. Loosen the lid ⑨ of the filter chamber with the spanner ① provided.
3. Remove the filter unit ⑫/⑬ vertically upwards.
4. Hold the cup ⑭ firmly, turn the filter ⑮ counterclockwise **1** and remove the filter **2** (bayonet fitting).
5. Clean the cup ⑭ under running water and clean the filter ⑮ e.g. with a soft brush.
6. Assemble the filter again in reverse order.
7. Start the pump (see 3. OPERATION).

#### To clean the check valve [Fig. M3/M4]:



**CAUTION!**

**The pump must not be operated without the check valve.**

1. If applicable, close all the shut-off devices on the intake side.
2. Open all tapping points so that the pressure escapes on the pressure side. Now close the tapping points again so that the connected pipes do not drain via the pump.
3. Loosen the cover ⑭ of the check valve with a suitable tool.
4. Remove the check valve ⑯ and clean it under running water.
5. Assemble the check valve ⑯ again in reverse order.
6. Start the pump (see 3. OPERATION).

## 5. STORAGE

#### To put into storage [Fig. S1]:

The product must be stored away from children.

1. Push the on/off switch ⑪ to position **0**.
2. Disconnect the pump from the mains.
3. Open the consumer on the pressure side.
4. Remove the connected hoses on the pressure and suction side.
5. Unscrew drain bolt ①.

6. Tilt the pump to the suction and pressure side until water is no longer discharged from either side.
7. Store the pump in a dry, enclosed and frost-free place.

**Disposal:**

(in accordance with RL2012/19/EC)

The product must not be disposed of to normal household waste. It must be disposed of in line with local environmental regulations.

**IMPORTANT!**

→ Dispose of the product through or via your municipal recycling collection centre.

## 6. TROUBLESHOOTING

**DANGER! Electric shock!**

**Risk of injury due to electric current.**

→ **Disconnect the product from the mains before you troubleshoot the product.**

**To troubleshoot with the error diagnosis system [Fig. T1]:**

The pump is equipped with an error diagnosis system which indicates various error states via the error LED (Ⓢ).

1. **Disconnect the pump from the mains.**
2. Make the respective remedies from the table below.
3. Start the pump again.

*The error display has been cleared and the pump is ready for operation again.*

Problem	Possible Cause	Remedy
<b>Error-LED flashes 1 time (with a 2 second break)</b>	<b>The pump does not pump water for 30 seconds during the initial operation.</b>	
<b>Pump does not suck water</b>	Pump was not sufficiently filled with liquid to be pumped.	→ Fill the pump and make sure that water does not drain out on the pressure side during the suctioning process (see 3. OPERATION).
	Air cannot escape on the pressure side, because the pressure side outlets are closed.	→ Open the pressure side outlets (see 3. OPERATION).
<b>Pump does not start</b>	The pump housing has heated up and the thermal circuit breaker has been activated.	<ol style="list-style-type: none"> <li>1. Open possible shut-off device in the pressure line (release pressure).</li> <li>2. Ensure sufficient ventilation and let the pump cool down for 20 min.</li> </ol>
	The impeller is blocked.	<ol style="list-style-type: none"> <li>1. Loosen the impeller (see "To loosen the impeller").</li> <li>2. Let the pump cool down for 20 min.</li> </ol>
<b>Only for Art. 1758: Flow sensor signal is faulty</b>	The flow sensor is dirty.	→ Clean the flow sensor (see "To clean the flow sensor").
<b>Error-LED flashes 2 times (with a 2 second break)</b>	<b>The pump does not pump water for 6 minutes during the initial operation.</b>	
<b>Pump does not suck water</b>	Problem on the suction side.	<ul style="list-style-type: none"> <li>→ Immerse the suction hose end under water.</li> <li>→ Eliminate any leak on the suction side.</li> <li>→ Clean the check valve on the suction line and check the installation direction.</li> <li>→ Clean the suction filter on the suction hose end.</li> <li>→ Clean the filter lid seal and turn the lid until the stopper (see 4. MAINTENANCE).</li> <li>→ Clean the filter in the pump.</li> </ul>
	Suction hose deformed or bent.	→ Use a new suction hose.
<b>Pump does not start</b>	The thermal circuit breaker has been activated (motor overheated).	→ Let the pump cool down for 20 min.

Problem	Possible Cause	Remedy
<b>Error-LED flashes 3 times (with a 2 second break)</b>	<b>The pump does not pump water for 30 seconds during the current operation.</b>	
<b>Water supply disrupted on the suction side</b>	Problem on the suction side.	<ul style="list-style-type: none"> <li>→ Immerse the suction hose end under water.</li> <li>→ Eliminate any leak on the suction side.</li> <li>→ Clean the check valve on the suction line and check the installation direction.</li> <li>→ Clean the suction filter on the suction hose end.</li> <li>→ Clean the filter lid seal and turn the lid until the stopper (see 4. MAINTENANCE).</li> <li>→ Clean the filter in the pump.</li> </ul>
	Suction hose deformed or bent.	→ Use a new suction hose.
<b>Pump does not start</b>	The thermal circuit breaker has been activated (motor overheated).	→ Let the pump cool down for 20 min.
<b>Only for Art. 1758: Flow sensor signal is faulty</b>	The flow sensor is dirty.	→ Clean the flow sensor (see "To clean the flow sensor").
<b>Error-LED flashes 4 times (with a 2 second break)</b>	<b>The pump switches off during on-going operation after 60 minutes.</b>	
<b>Leakage warning is activated</b>	Leak on pressure side (e.g. dripping tap).	→ Eliminate any leak on the pressure side.
	The maximum duration of the leakage warning (low quantity program 60 min. or 2 min.) has been exceeded.	<ul style="list-style-type: none"> <li>→ When using the low quantity programme, shorten the watering duration or interrupt for 5 minutes.</li> <li>→ Increase the water consumption.</li> </ul>
	The check valve is blocked.	→ Clean the check valve (see "To clean the check valve").
<b>Only for Art. 1758: Flow sensor signal is faulty</b>	The flow sensor is dirty.	→ Clean the flow sensor (see "To clean the flow sensor").
<b>Error-LED is off</b>	<b>Pump does not start or stops suddenly during operation</b>	
	Mains plug is disconnected.	→ Connect the mains plug.
	Power failure.	→ Check the fuse and the cables.
	RCD has triggered (residual current).	→ Disconnect the pump and contact the GARDENA Service.
	Electrical interruption.	→ Disconnect the pump and contact the GARDENA Service.

**To loosen the impeller [Fig. T2]:**

If the impeller is stuck due to dirt, the **Error LED flashes 1 time (with a 2 second break)**.

1. Turn the motor shaft (Ⓢ) with a screw driver.  
*This will loosen the blocked impeller.*
2. Start the pump (see 3. OPERATION).

**Only for Art. 1758: To clean the flow sensor [Fig. T3]:**

If the flow sensor is stuck due to dirt, the **Error LED flashes (with a 2 second break)**.

1. Loosen both screws (Ⓣ).
2. Remove the cover (Ⓢ).
3. Loosen the screw (Ⓤ) and remove the clip (Ⓥ).
4. Loosen the cap (Ⓦ) counterclockwise (e.g. with a screwdriver).
5. Remove and clean the impeller (Ⓧ).
6. Clean the housing of the flow sensor.
7. Assemble the impeller (Ⓧ) again in reverse order.
8. First insert the cover (Ⓢ) at the top and then tighten both screws (Ⓣ) at the bottom.
9. Start the pump (see 3. OPERATION).



**NOTE: For any other malfunctions please contact the GARDENA service department. Repairs must only be done by GARDENA service departments or specialist dealers approved by GARDENA.**

## 7. TECHNICAL DATA

<i>Automatic Home &amp; Garden Pump</i>	Unit	Value (Art. 1757)	Value (Art. 1758)
Mains voltage	V (AC)	230	230
Mains frequency	Hz	50	50
Rated Power / Standby consumption	W	800 / 1.5	1100 / 1.5
Connection cable	m	1.5 (H07RN-F)	1.5 (H07RN-F)
Max. delivery capacity	l/h	3500	4000
Max. pressure	bar	4.0	4.5
Max. delivery head	m	40	45
Max. suction height	m	7	8
Cut-in pressure	bar	1.9 ± 0.2	1.9 ± 0.2
Permitted internal pressure (delivery side)	bar	6	6
Weight	kg	8.1	12.5
Sound power level $L_{WA}^{(1)}$ : measured/guaranteed Uncertainty $k_{WA}^{(1)}$	dB (A)	77 / 81 4	82 / 83 1

Measuring process complying with: <sup>1)</sup> RL 2000/14/EC

## 8. ACCESSORIES

<b>GARDENA Suction Hoses</b>	Kink and vacuum-resistant, sold by the metre with 19 mm (3/4"), 25 mm (1") or 32 mm (5/4") diameter without fittings or in fixed lengths complete with fittings, suction filter and backflow preventer.	
<b>GARDENA Suction Hose Fittings</b>	For vacuum-resistant connection of the pump to the suction hose sold by the metre.	<b>Art. 1723/1724</b>
<b>GARDENA Suction Filter with Backflow Preventer</b>	To equip suction hoses with Backflow Preventer sold by the metre.	<b>Art. 1726/1727</b>
<b>GARDENA Bore Hole Suction Hose</b>	For vacuum-resistant connection of the pump to boreholes or pipe networks. Length 0.5 m. With 33.3 mm (G1) female thread at both ends.	<b>Art. 1729</b>
<b>GARDENA Pump Preliminary Filter</b>	Recommended for pumping sandy water.	<b>Art. 1730/1731</b>
<b>GARDENA Pump Connection Set</b>	Connection Set for 1/2" Pressure Hoses.	<b>Art. 1750</b>
<b>GARDENA Pump Connection Set</b>	Connection Set for 3/4" Pressure Hoses.	<b>Art. 1752</b>

## 9. SERVICE/WARRANTY

### Service:

Please contact the address on the back page.

### Warranty statement:

In the event of a warranty claim, no charge is levied to you for the services provided.

GARDENA Manufacturing GmbH grants a warranty for all original GARDENA new products for two years from the date of original purchase from the retailer, provided that the devices have been for private use only. This manufacturer's warranty does not apply to products acquired second hand. This warranty includes all significant defects of the product that can be proved to be material or manufacturing faults. This warranty is fulfilled by supplying a fully functional replacement product or by repairing the faulty product sent to us free of charge; we reserve the right to choose between these options. This service is subject to the following provisions:

- The product has been used for its intended purpose as per the recommendations in the operating instructions.
- Neither the purchaser nor a third party has attempted to open or repair the product.
- Only Original GARDENA replacement parts and wear parts have been used for operation.
- Presentation of the receipt.

Normal wear and tear of parts and components (such as blades, blade fixing parts, turbines, light bulbs, V-belts/toothed belts, impellers, air filters, spark plugs), visual changes, wear parts and consumables are excluded from the warranty.

This manufacturer's warranty is limited to replacement and repair of products in accordance with the abovementioned conditions. The manufactur-

er's warranty does not constitute an entitlement to lodge other claims against us as a manufacturer, such as for damages. This manufacturer's warranty does **not**, of course, affect statutory and contractual warranty claims against the dealer/retailer.

The manufacturer's warranty is governed by the law of the Federal Republic of Germany.

In case of a warranty claim, please return the faulty product, together with a copy of the receipt and a description of the fault, with postage paid to the service address.

### Consumables:

The impeller, filter and jet nozzle are consumables and are not included in the warranty.



**Pumpen-Kennlinien**  
**Performance characteristics**  
**Courbes de performance**  
**Prestatiegrafiek**  
**Kapacitetskurva**  
**Ydelses karakteristika**  
**Pumpun ominaiskäyrä**  
**Pumpekarakteristikk**  
**Curva di rendimento**  
**Curva característica de la bomba**  
**Características de performance**  
**Charakterystyka pompy**  
**Szivattyú-jelleggörbe**  
**Charakteristika čerpadla**  
**Charakteristiky čerpadla**  
**Χαρακτηριστικό διάγραμμα**  
**Кривая производительности насоса**  
**Karakteristika črpalke**  
**Obilježja pumpe**  
**Karakteristika pumpe**  
**Крива характеристики насоса**  
**Caracteristică pompă**  
**Pompa karakter eğrisi**  
**Помпена характеристика**  
**Fuqia e pompës**  
**Pumba karakteristik**  
**Siurblio charakteristinė kreivė**  
**Sūkņa raksturlīkne**

**Classic 3500/4E**

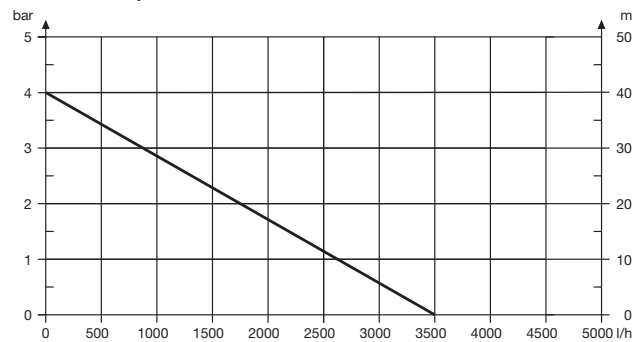

**Comfort 4000/5E**

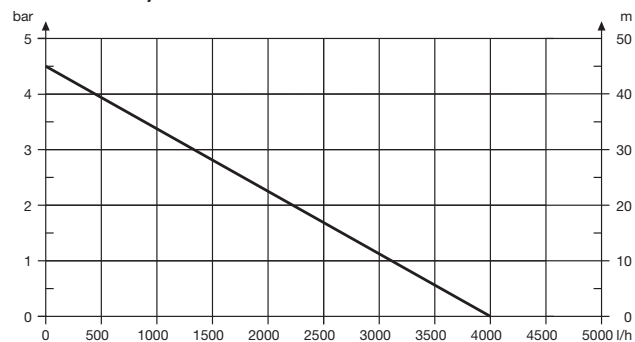



**Deutschland / Germany**

GARDENA  
Manufacturing GmbH  
Central Service  
Hans-Lorenser-Straße 40  
D-89079 Ulm  
Produktfragen:  
(+49) 731 490-123  
Reparaturen:  
(+49) 731 490-290  
service@gardena.com

**Albania**

COBALT Sh.p.k.  
Rr. Siri Kodra  
1000 Tirana

**Argentina**

Husqvarna Argentina S.A.  
Av.del Libertador 5954 –  
Piso 11 – Torre B  
(C1428ARP) Buenos Aires  
Phone: (+54) 11 5194 5000  
info.gardena@  
ar.husqvarna.com

**Armenia**

Garden Land Ltd.  
61 Tigran Mets  
0005 Yerevan

**Australia**

Husqvarna Australia Pty. Ltd.  
Locked Bag 5  
Central Coast BC  
NSW 2252  
Phone: (+61) (0) 2 4352 7400  
customer.service@  
husqvarna.com.au

**Austria / Österreich**

Husqvarna Austria GmbH  
Industriezeile 36  
4010 Linz  
Tel.: (+43) 732 77 01 01-485  
service.gardena@  
husqvarnagroup.com

**Azerbaijan**

Firm Progress  
a. Aliyev Str. 26A  
1052 Baku

**Belgium**

Husqvarna België nv/sa  
Gardena Division  
Rue Egide Van Ophem 111  
1180 Uccle / Ukkel  
Tel.: (+32) 2 720 92 12  
info@gardena.be

**Bosnia / Herzegovina**

SILK TRADE d.o.o.  
Industrijska zona Bukva bb  
74260 Tešanj

**Brazil**

Husqvarna do Brasil Ltda  
Av. Francisco Matarazzo,  
1400 – 19º andar  
São Paulo – SP  
CEP: 05001-903  
Tel: 0800-112252  
marketing.br.husqvarna@  
husqvarna.com.br

**Bulgaria**

AGROLAND България АД  
бул. 8 Декември, №13  
Офис 5  
1700 Студентски град  
София  
Тел.: (+359) 24 66 69 10  
info@agroland.eu

**Canada / USA**

GARDENA Canada Ltd.  
100 Summerlea Road  
Brampton, Ontario L6T 4X3  
Phone: (+1) 905 792 93 30  
info@gardenacanada.com

**Chile**

Maquinarias Agroforestales  
Ltda. (Maga Ltda.)  
Santiago, Chile  
Avda. Chesterton  
# 8355 comuna Las Condes  
Phone: (+56) 2 202 4417  
Dalton@maga.cl  
Zipcode: 7560330

**China**

Husqvarna (Shanghai)  
Management Co., Ltd.  
富世华 (上海) 管理有限公司  
3F, Benq Square B,  
No207, Song Hong Rd.,  
Chang Ning District,  
Shanghai, PRC. 200335  
上海市长宁区淞虹路207号明  
基广场B座3楼, 邮编: 200335

**Colombia**

Husqvarna Colombia S.A.  
Calle 18 No. 68 D-31, zona  
Industrial de Montevideo  
Bogotá, Cundinamarca  
Tel. 571 2922700 ext. 105  
jairo.salazar@  
husqvarna.com.co

**Costa Rica**

Compania Exim  
Euroberoamericana S.A.  
Los Colegios, Moravia,  
200 metros al Sur del Colegio  
Saint Francis – San José  
Phone: (+506) 297 68 83  
exim\_euro@racsa.co.cr

**Croatia**

Husqvarna Austria GmbH  
Industriezeile 36  
4010 Linz  
Tel.: (+43) 732 77 01 01-485  
service.gardena@  
husqvarnagroup.com

**Cyprus**

Med Marketing  
17 Digeni Akrita Ave  
P.O. Box 27017  
1641 Nicosia

**Czech Republic**

Husqvarna Česko s.r.o.  
Türkova 2319/5b  
149 00 Praha 4 – Chodov  
Bezplatná infolinka:  
800 100 425  
servis@cz.husqvarna.com

**Denmark**

GARDENA DANMARK  
Lejrvej 19, st.  
3500 Værløse  
Tlf.: (+45) 70 26 47 70  
husqvarna@husqvarna.dk  
www.gardena.com/dk

**Dominican Republic**

BOSQUESA, S.R.L  
Carretera Santiago Licey  
Km. 5 ½  
Esquina Copal II.  
Santiago  
Dominican Republic  
Phone: (+809) 736-0333  
joserbosquesa@claro.net.do

**Ecuador**

Husqvarna Ecuador S.A.  
Arupos E1-181 y 10 de  
Agosto Quito, Pichincha  
Tel. (+593) 22800739  
francisco.jacome@  
husqvarna.com.ec

**Estonia**

Husqvarna Eesti OÜ  
Valdeku 132  
EE-11216 Tallinn  
info@gardena.ee

**Finland**

Oy Husqvarna Ab  
Gardena Division  
Lautatarhankatu 8 B/PL 3  
00581 HELSINKI  
www.gardena.fi

**France**

Husqvarna France  
9/11 Allée des pierres mayettes  
92635 Gennevilliers Cedex  
France  
http://www.gardena.com/fr  
N° AZUR: 0 810 00 78 23  
(Prix d'un appel local)

**Georgia**

Transporter LLC  
8/57 Beliashvili street  
0159 Tbilisi, Georgia  
Phone: (+995) 322 14 71 71

**Great Britain**

Husqvarna UK Ltd  
Preston Road  
Aycliffe Industrial Park  
Newton Aycliffe  
County Durham  
DL5 6UP  
info.gardena@  
husqvarna.co.uk

**Greece**

П. ΠΑΠΑΔΟΠΟΥΛΟΣ ΑΕΒΕ  
Λεωφ. Αθηνών 92  
Αθήνα  
T.K.104 42  
Ελλάδα  
Τηλ. (+30) 210 51 93 100  
info@papadopoulos.com.gr

**Hungary**

Husqvarna Magyarország Kft.  
Ezred u. 1-3  
1044 Budapest  
Telefon: (+36) 1 251-4161  
vevoszolgalat.husqvarna@  
husqvarna.hu

**Iceland**

Ó. Johnson & Kaaber  
Tunguhalsi 1  
110 Reykjavik  
ooj@ojk.is

**Ireland**

Husqvarna UK Ltd  
Preston Road  
Aycliffe Industrial Park  
Newton Aycliffe  
County Durham  
DL5 6UP  
info.gardena@  
husqvarna.co.uk

**Italy**

Husqvarna Italia S.p.A.  
Via Santa Vecchia 15  
23868 VALMADRERA (LC)  
Phone: (+39) 0341.203.111  
assistenza.italia@  
it.husqvarna.com

**Japan**

KAKUICHI Co. Ltd.  
Sumitomo Realty &  
Development Kojimachi  
BLDG., 8F  
5-1 Nibannco  
Chiyoda-ku  
Tokyo 102-0084  
Phone: (+81) 33 264 4721  
m-ishihara@kaku-ichi.co.jp

**Kazakhstan**

LAMED Ltd.  
155/1, Tazhibayevoi Str.  
050060 Almaty  
IP Schmidt  
Abayavenue 3B  
110 005 Kostanay

**Korea**

Kyung Jin Trading CO.,LTD.  
107-4, SunDuk Bld.,  
YangJae-dong,  
Seocho-gu,  
Seoul, (zipcode: 137-891)  
Phone: (+82) (0)2 574-6300

**Kyrgyzstan**

Alye Maki  
av. Moladaya Guardir J 3  
720014  
Bishkek

**Latvia**

Husqvarna Latvija SIA  
Ulbrokas 19A  
LV-1021 Rīga  
info@gardena.lv

**Lithuania**

UAB Husqvarna Lietuva  
Ateities pl. 77C  
LT-52104 Kaunas  
info@gardena.lt

**Luxembourg**

Magasins Jules Neuberger  
39, rue Jacques Stas  
Luxembourg-Gasperich 2549  
Case Postale No. 12  
Luxembourg 2010  
Phone: (+352) 40 14 01  
api@neuberger.lu

**Mexico**

AFOSA  
Av. Lopez Mateos Sur # 5019  
Col. La Calma 45070  
Zapopan, Jalisco  
Mexico  
Phone: (+52) 33 3818-3434  
icornejo@afosa.com.mx

**Moldova**

Convel S.R.L.  
290A Muncesti Str.  
2002 Chisinau

**Netherlands**

Husqvarna Nederland B.V.  
GARDENA Division  
Postbus 50131  
1305 AC ALMERE  
Phone: (+31) 36 521 00 10  
info@gardena.nl

**Neth. Antilles**

Jonka Enterprises N.V.  
Sta. Rosa Weg 196  
P.O. Box 8200  
Curaçao  
Phone: (+599) 9 767 66 55  
pgm@jonka.com

**New Zealand**

Husqvarna New Zealand Ltd.  
PO Box 76-437  
Manukau City 2241  
Phone: (+64) (0) 9 9202410  
support.nz@husqvarna.co.nz

**Norway**

Husqvarna Norge AS  
Gardena Division  
Trøskenveien 36  
1708 Sarpsborg  
info@gardena.no

**Peru**

Husqvarna Perú S.A.  
Jr. Ramón Cárcamo 710  
Lima 1  
Tel: (+51) 1 3320400 ext. 416  
juan.remuzgo@  
husqvarna.com

**Poland**

Husqvarna  
Poland Spółka z o.o.  
ul. Wysockiego 15 b  
03-371 Warszawa  
Phone: (+48) 22 330 96 00  
gardena@husqvarna.com.pl

**Portugal**

Husqvarna Portugal, SA  
Lagoa - Albarraque  
2635 - 595 Rio de Mouro  
Tel.: (+351) 21 922 85 30  
Fax: (+351) 21 922 85 36  
info@gardena.pt

**Romania**

Madex International Srl  
Soseaua Odaii 117-123,  
RO 013603 București, S1  
Phone: (+40) 21 352.76.03  
madex@ines.ro

**Russia / Россия**

ООО „Хускварна“  
141400, Московская обл.,  
г. Химки,  
улица Ленинградская,  
владение 39, стр.6  
Бизнес Центр  
„Химки Бизнес Парк“,  
помещение ОВ02\_04  
http://www.gardena.ru

**Serbia**

Domel d.o.o.  
Autoput za Novi Sad bb  
11 273 Belgrade  
Phone: (+381) 1 18 48 88 12  
miroslav.jejina@domel.rs

**Singapore**

Hy-Ray PRIVATE LIMITED  
40 Jalan Pemimpin  
#02-08 Tat Ann Building  
Singapore 577185  
Phone: (+65) 6253 2277  
shiyiing@hyray.com.sg

**Slovak Republic**

Husqvarna Česko s.r.o.  
Türkova 2319/5b  
149 00 Praha 4 – Chodov  
Bezplatná infolinka:  
800 154 044  
servis@sk.husqvarna.com

**Slovenia**

Husqvarna Austria GmbH  
Industriezeile 36  
4010 Linz  
Tel.: (+43) 732 77 01 01-485  
service.gardena@  
husqvarnagroup.com

**South Africa**

Husqvarna  
South Africa (Pty) Ltd  
Postnet Suite 250  
Private Bag X6,  
Cascades, 3202  
South Africa  
Phone: (+27) 33 846 9700  
info@gardena.co.za

**Spain**

Husqvarna España S.A.  
Calle de Rivas nº 10  
28052 Madrid  
Phone: (+34) 91 708 05 00  
atencioncliente@gardena.es

**Suriname**

Agrofrix n.v.  
Verlengde Hogestraat #22  
Phone: (+597) 472426  
agrofrix@sr.net  
Pobox : 2006  
Paramaribo  
Suriname – South America

**Sweden**

Husqvarna AB  
Gardena Division  
S-561 82 Husqvarna  
Gardenaorder@husqvarna.se

**Switzerland / Schweiz**

Husqvarna Schweiz AG  
Consumer Products  
Industriestrasse 10  
5506 Mägenwil  
Phone: (+41) (0) 62 887 37 90  
info@gardena.ch

**Turkey**

Dost Bahçe Diş Ticaret  
Müessesilik A.Ş  
Yunus Mah. Adil Sok. No:3  
İc Kapi No: 1 Kartal  
34873 İstanbul  
Phone: (+90) 216 38 93 939  
info@dostbahce.com.tr

**Ukraine / Україна**

ТОВ «Хускварна Україна»  
вул. Васильківська, 34,  
офіс 204-г  
03022, м. Київ  
Тел. (+38) 044 498 39 02  
info@gardena.ua

**Uruguay**

FELI SA  
Entre Rios 1083 CP 11800  
Montevideo – Uruguay  
Tel: (+598) 22 03 18 44  
info@felisa.com.uy

**Venezuela**

Corporación Casa y Jardín C.A.  
Av. Caroní, Edif. Trezmen, PB.  
Colas de Bello Monte.  
1050 Caracas.  
Tlf: (+58) 212 992 33 22  
info@casayjardin.net.ve

1757-20.960.08/1019  
© GARDENA  
Manufacturing GmbH  
D-89070 Ulm  
http://www.gardena.com