

2000/2 Clear 18V P4A
Art. 14600

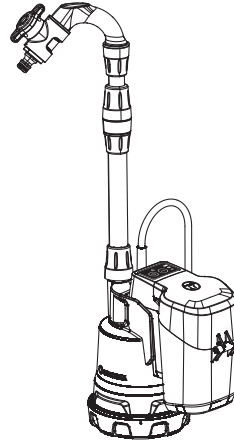

2000/2 18V P4A
Art. 14602

EN **Operator's Manual**

Battery Submersible Pump/Battery Rain Water Tank Pump

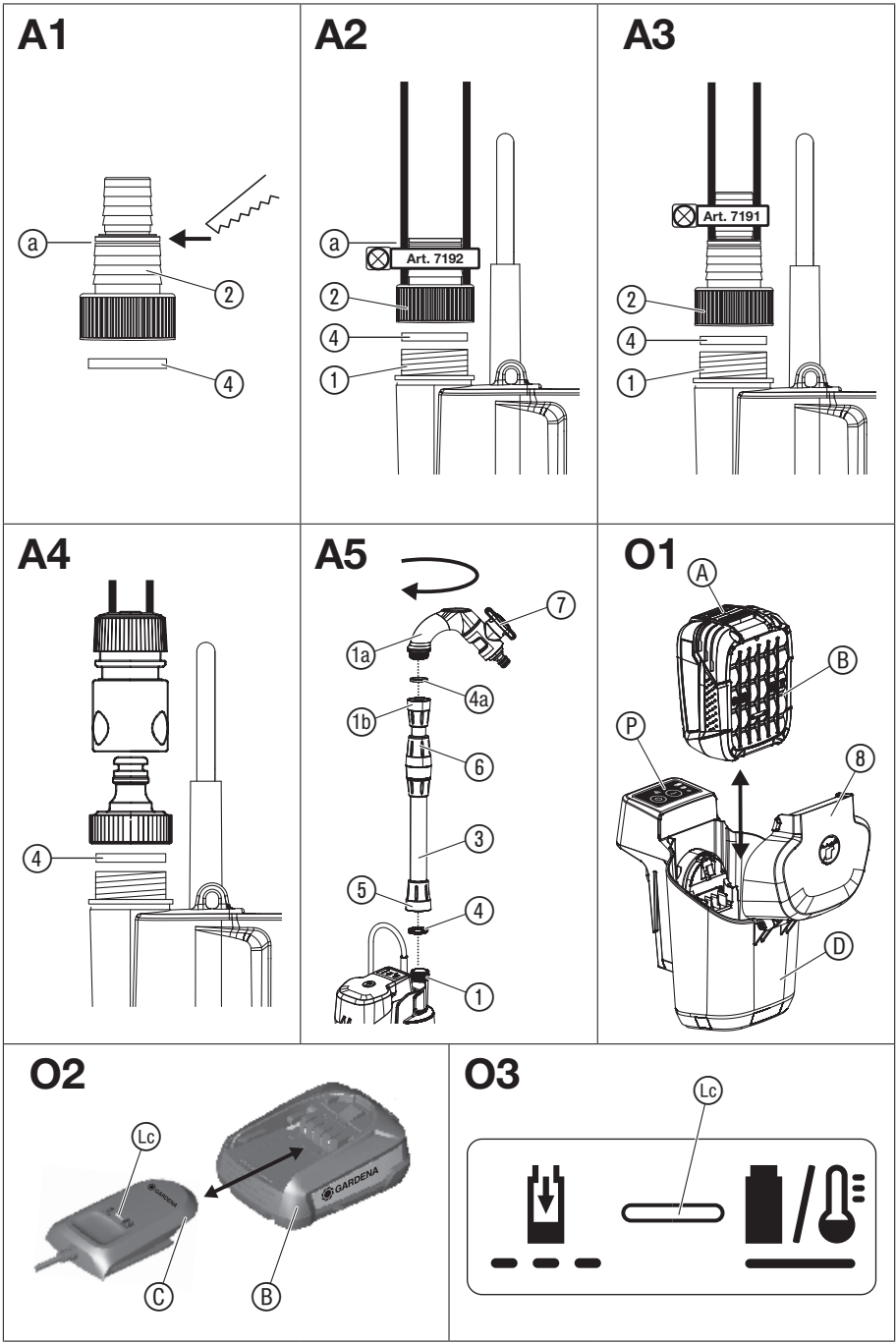

A1

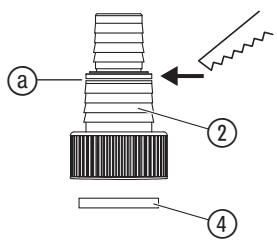

A2

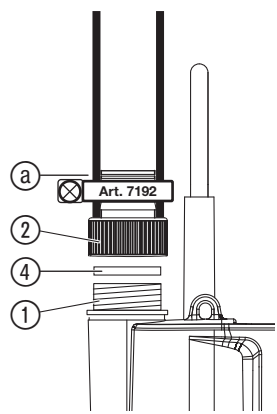

A3

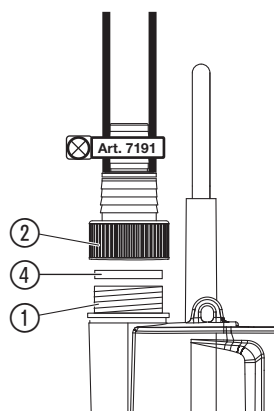

A4

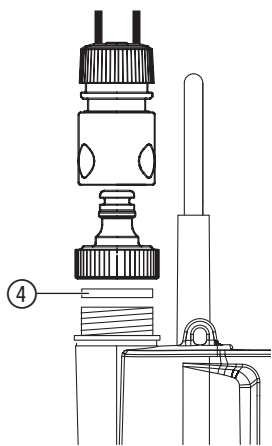

A5

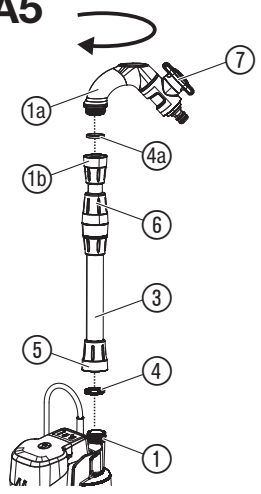

O1

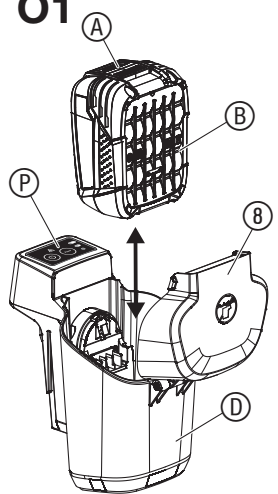

O2

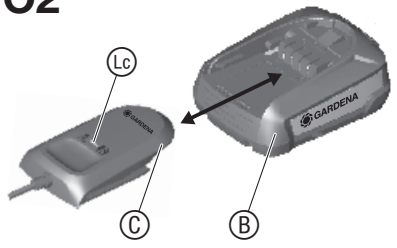

O3

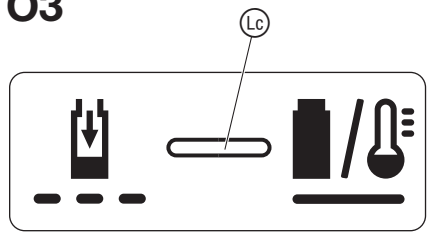

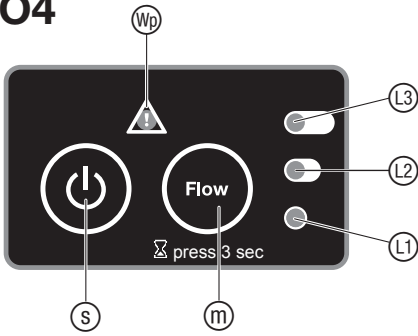
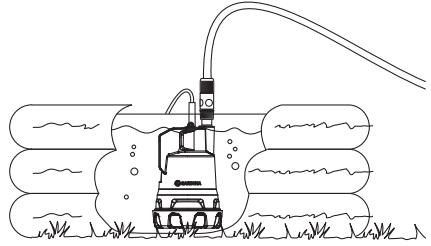
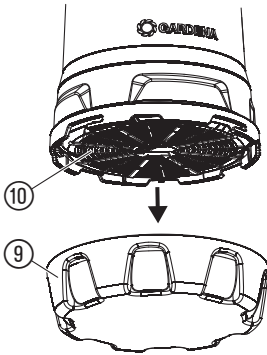
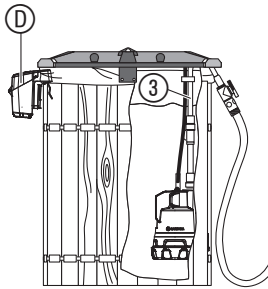
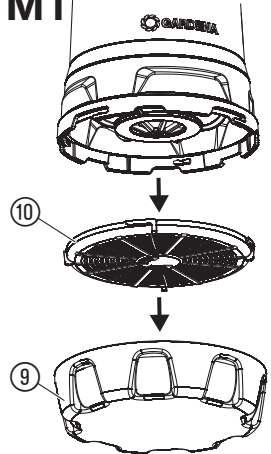
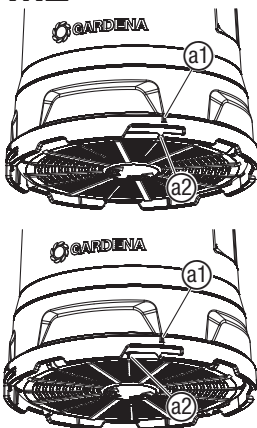
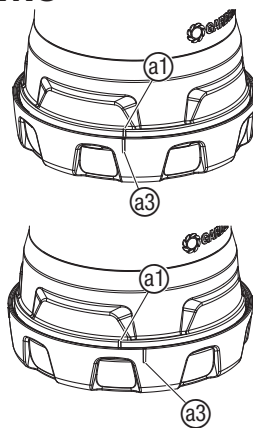
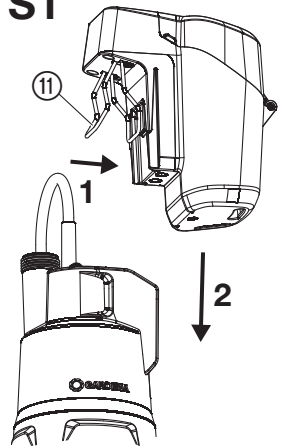
04**05****06****07****M1****M2****M3****S1**

GARDENA Battery Submersible Pump

2000/2 Clear 18V P4A/Battery Rain Water Tank Pump 2000/2 18V P4A

1. SAFETY	4
2. ASSEMBLY	6
3. OPERATION	7
4. MAINTENANCE	9
5. STORAGE	9
6. TROUBLESHOOTING	10
7. TECHNICAL DATA	11
8. ACCESSORIES	11
9. SERVICE/WARRANTY	12

Original instructions.



This product may be used under supervision, or if instruction regarding the safe use of the product has been provided and the resulting dangers have been understood, by children aged 8 and above, as well as by persons with physical, sensory or mental disabilities or a lack of experience and knowledge. Children must not be allowed to play with the product. Cleaning and user maintenance

must not be performed by children without supervision. The use of this product by young people under the age of 16 is not recommended.

Intended use:

The **GARDENA Battery Pump** is intended for removing water from containers such as paddling pools, from rain barrels such as the GARDENA Rain Collector or for irrigation with a shower or a small Irrigation System.

The pump is completely submersible (watertight encapsulation) and is submerged in the water (to a max. depth of see 7. TECHNICAL DATA).

The battery unit (battery and battery holder) must not be immersed.

The product is not intended for continuous operation.



DANGER!

The pump should not be used for the delivery of salt water, muddy water, corrosive, easily inflammable or explosive liquids (e.g. petrol, paraffin, thinners), oil, heating oil or foodstuffs.

1. SAFETY

IMPORTANT!

Read the operator's manual carefully before use and keep for future reference.

Symbols on the product:



Read operator's manual.



Do not immerse the battery unit in water.



Remove the battery before cleaning or maintenance.



For the charger:
Remove plug from the mains immediately if the cable is damaged or cut.

General safety warnings

Electrical safety for the charger



DANGER! Electric shock!
Risk of injury due to electric shock.

→ The product must be supplied through a residual current device (RCD) having a rated residual operating current not exceeding 30 mA.

Safe operating practices

The water temperature should not exceed 35 °C.

The pump must not be used when people are in the water.

Pollution of the liquid could occur due to leakage of lubricants.

Circuit breakers

Dry-running protection: If no water is pumped (under-current) the pump switches off automatically.

If the pump does not deliver water after several suction attempts, there is probably air in the hose.

→ Start the pump once briefly in water without a hose.

Anti-lock protection: If the motor is blocked (overcurrent), the pump switches off automatically.

→ Contact the GARDENA Service.

Automatic venting: This pump is equipped with a vent valve which eliminates any air pockets in the pump. Depending on the function, a small amount of water can escape above the type plate.

Additional safety warnings

Battery safety



Read all the safety and general instructions.

Failure to observe the safety and general instructions may result in electric shock, fire and/or serious injury.

Store these instructions in a safe place. Only use the charger if you can fully evaluate all functions and carry them out without restrictions, or if you have received corresponding instructions.

→ **Supervise children during use, cleaning and maintenance.** This will ensure that children do not play with the charger.

→ **Charge only lithium-ion batteries of the POWER FOR ALL system type PBA 18V with a capacity of 1.5 Ah or more (5 battery cells or more). The battery voltage must match the battery charging voltage of the charger. Do not charge any non-rechargeable batteries.** Otherwise there is a risk of fire and explosion.

→  **Do not expose the charger to rain or wet conditions.** Water entering a power tool will increase the risk of electric shock.

→ **Keep the charger clean.** Dirt poses a risk of electric shock.

→ **Always check the charger, cable and plug before use. Stop using the charger if you discover any damage. Do not open the charger yourself, and have it repaired only by a qualified specialist using only original replacement parts.** Damaged chargers, cables and plugs increase the risk of electric shock.

→ **Do not operate the charger on an easily ignited surface (e.g. paper, textiles, etc.) or in a flammable environment.** There is a risk of fire due to the charger heating up during operation.

→ In order to avoid safety hazards, if the power supply cord needs to be replaced, this must be done by GARDENA or by a customer service centre that is authorised to repair GARDENA power tools.

→ **Do not operate the product while it is charging.**

Products sold in GB only: Your product is fitted with an BS 1363/A approved electric plug with internal fuse (ASTA approved to BS 1362). If the plug is not suitable for your socket outlets, it should be cut off and an appropriate plug fitted in its place by an authorised customer service agent. The replacement plug should have the same fuse rating as the original plug. The severed plug must be disposed of to avoid a possible shock hazard and should never be inserted into a mains socket elsewhere.

→ **These safety warnings apply only for lithium-ion batteries of the POWER FOR ALL system PBA 18V.**

→ **Only use the battery with products of the POWER FOR ALL system manufacturers.**

This is the only way in which you can protect the battery against dangerous overload.

→ **Recharge only with the charger specified by the manufacturer.** A charger that is suitable for one type of battery pack may create a risk of fire when used with another battery pack.

→ **The battery is supplied partially charged.** To ensure full battery capacity, fully charge the battery in the charger before using your power tool for the first time.

→ **Keep battery packs out of the reach of children.**

→ **Do not open the battery.** There is a risk of short-circuiting.

→ **In case of damage and improper use of the battery, vapours may be emitted. The battery can set alight or explode.**

Ensure the area is well ventilated and seek medical attention should you experience any adverse effects. The vapours may irritate the respiratory system.

→ **If used incorrectly or if the battery is damaged, flammable liquid may be ejected from the battery. Contact with this liquid should be avoided. If contact accidentally occurs, rinse off with water. If the liquid comes into contact with your eyes, seek additional medical attention.**

Liquid ejected from the battery may cause irritation or burns.



→ **If the battery is damaged liquid can be ejected and cover nearby surfaces. Check affected parts.** Clean these parts or change them if necessary.

→ **Do not short-circuit the battery pack. When the battery pack is not in use, keep it away from other metal objects, like paper clips, coins, keys, nails, screws or other small metal objects, that can make a connection from one terminal to another.** Shorting the battery terminals together may cause burns or a fire.

→ **The battery can be damaged by pointed objects such as nails or screwdrivers or by force applied externally.**

An internal short circuit may occur, causing the battery to burn, smoke, explode or overheat.

→ **Never service damaged battery packs.** Service of battery packs should only be performed by the manufacturer or authorized service providers.

→  **Protect the battery against heat, e.g. against continuous intense sunlight, fire, dirt, water and moisture.**  There is a risk of explosion and short-circuiting.

→ **Only operate and store the battery at an ambient temperature between -20 °C and +50 °C.** Do not leave the battery in your car in the summer, for example. At temperatures of <0 °C some devices may experience a loss of power.

→ **Only charge the battery at an ambient temperature which is between 0 °C and +45 °C.** Charging outside of this temperature range can increase the risk of damage to the battery and pose a fire hazard.

Electrical safety**DANGER! Cardiac arrest!**

This product makes an electromagnetic field while it operates. This field may under some conditions interfere with active or passive medical implants. To decrease the risk of conditions that can possibly injure or kill, we recommend persons with medical implants to speak with their physician and the medical implant manufacturer before you operate the product.

Please regularly check the connecting line.

Before using, always subject the pump to a visual inspection.

A pump which is damaged should not be used. In the event of damage, have the pump checked by GARDENA Service.

Protect the battery contacts from moisture.

Personal safety**DANGER! Risk of suffocation!**

Small parts can be easily swallowed. There is also a risk that the polybag can suffocate toddlers. Keep toddlers away when you assemble the product.

Submerge the pump in the water with a rope at the eyelet. Pull the pump up as well.

Type 14602: Alternatively, the pump can be submerged or pulled up via the telescopic pipe.

Observe the minimum water level in accordance with the Technical Data given for the pump.

Allow the pump to run no longer than 10 minutes against a closed pressure side (e.g. closed regulating valve).

Do not use the product while you are tired or under the influence of drugs, alcohol or medication. A moment of inattention while you operate the product may result in serious personal injury.

Do not open the pump further than delivery status (only exception: the filter and the foot).

If dirty water has been pumped, the foot and the filter can only be loosened with great force and the vent valve can become stuck.

→ If necessary, loosen the vent valve with compressed air or a wire.

2. ASSEMBLY

**DANGER! Risk of injury!**

Injury when the product starts accidentally.

→ Remove the battery before you assemble the product.

To connect the hose (Art. 14600):

The hose can be connected to the pump connection ① via the connection nipple ② [19 mm (3/4")/25 mm (1")] or via the GARDENA Connection System [13 mm (1/2")/15 mm (5/8")/19 mm (3/4")].

To connect the hose via the connection nipple [Fig. A1/A2/A3]:

When using a 25 mm (1") hose, the pump has the maximum delivery capacity.

25 mm (1") and 19 mm (3/4") hoses connected with a connection nipple ② must be fastened, for example with a **GARDENA Hose Clamp Art. 7192/7191**.

Hose diameter	25 mm (1")	19 mm (3/4")
GARDENA Hose Clamp [Fig. A1]	Art. 7192 [Fig. A2]	Art. 7191 [Fig. A3]
Hose connection	Detach nipple at ②	Do not detach nipple

1. Screw the connection nipple ② with the washer ④ onto the pump. (With 25 mm (1") hoses, first detach the connection nipple ② at ②.)
2. Slide the hose onto the connection nipple ② and secure it e.g. with a **GARDENA Hose Clamp Art. 7192/7191**.

To connect the hose via the GARDENA Connection System [Fig. A4]:

19 mm (3/4")/15 mm (5/8") and 13 mm (1/2") hoses can be connected via the GARDENA Connection System.

Hose diameter	Pump connection	
13 mm (1/2")	GARDENA Pump Connection Set	Art. 1750
15 mm (5/8")	GARDENA Pump Connection Set	Art. 1750
19 mm (3/4")	GARDENA Pump Connection Set	Art. 1752

→ Connect the hose via the relevant GARDENA Connection.

To connect the telescopic pipe (Art. 14602) [Fig. A5]:

We recommend the use of a **GARDENA Hose Connector** for connecting a garden hose:

- Art. 18215 for 13 mm (1/2") and 15 mm (5/8") or
- Art. 18216 for 19 mm (3/4"). With the use of 19-mm-(3/4")-hose line, the pumping quantity is the greatest.

The telescopic pipe can be adjusted between 57 – 77 cm. The telescopic pipe can be extended several times by 21 cm with the **GARDENA Extension Pipe Art. 1420**.

1. Screw the telescopic pipe ③ onto the pump connector ①. Make sure that the washer ④ lies in the connecting thread ⑤ of the telescopic pipe ③.
2. Loosen the threaded collar ⑥ of the telescopic pipe ③.

- Adjust the telescopic pipe ③ to the desired height.
- Tighten the threaded collar ⑥ again.

The telescopic pipe ③ is fitted with a **GARDENA Shut-Off Valve ⑦**. The shut-off valve ⑦ can also be used for fine adjustment of the pump performance.

3. OPERATION



DANGER! Risk of injury!

Injury when the product starts accidentally.

- **Remove the battery before you adjust or transport the product.**

To charge the battery [Fig. O1/O2/O3]:



CAUTION!

- **Note the mains voltage!** The voltage of the power source must match the voltage specified on the rating plate of the charger.

Thanks to the intelligent charging process, the charge condition of the battery is automatically detected and then charged up with the optimal charge current depending on battery temperature and voltage.

In this way, the battery is treated with care and remains permanently fully charged when it is stored in the charger.

- Open the cover ⑧.
- Push the locking button ④ and remove the battery ⑥ from the battery container ⑤.
- Connect the battery charger ③ into a mains socket.
- Slide the battery charger ③ onto the battery ⑥.

When the battery charge indicator ⑬ at the charger flashes green the battery is being charged.

When the battery charge indicator ⑬ at the charger illuminates permanently green the battery is completely charged (Charging time, see 7. TECHNICAL DATA).

- Examine the charge status regularly while you charge.
- When the battery ⑥ is completely charged, you can disconnect the battery ⑥ from the charger ③.

Meaning of the Indication Elements:

Indication on the charger [Fig. O3]:

Flashing of the Battery Charge Indicator ⑬

The charging procedure is indicated by **flashing** of the battery charge indicator ⑬.

Note: The charging procedure is only possible when the battery is not inserted, within the allowable charging temperature range, see 7. TECHNICAL DATA.



Continuous Lighting of the Battery Charge Indicator ⑬

Continuous lighting of the battery charge indicator ⑬ indicates that the battery is fully charged **or** that the temperature of the battery is not within the allowable charging temperature range and can therefore not be charged.

When the battery is not inserted, **continuous lighting** of the battery charge indicator ⑬ indicates that the mains plug is inserted in the socket outlet and that the battery charger is ready for operation.



Battery charge status indication on the product [Fig. O1/O4]:

After starting the product, the battery charge status indication [①, ② and ③] is displayed.

Battery charge status	Battery charge status indication
67 – 100 % charged	①, ② and ③ illuminate green
34 – 66 % charged	① and ② illuminate green
11 – 33 % charged	① illuminates green
0 – 10 % charged	① flashes green

If the LED ① flashes green, the battery must be charged.

If the error LED ④ is illuminated or flashing, see 6. TROUBLESHOOTING.

Control panel [Fig. O4]:

On/Off button ⑤:

- Push the On/Off button ⑤ on the control panel.
The pump starts with the previously selected power level.

After the pump is switched on, the **battery charge status indication** (①, ②, ③) is displayed with **green LEDs**.

④ Power levels (Flow button)/Timer Function:

The pump has 3 power levels, which can be called up one after the other with the **Flow button**. To do this, the Flow button must be pressed briefly (approx. 0.5 sec.).

According to the power level the **LEDs** (①, ②, ③) **flash blue** for 5 seconds.

If the flow button is pressed for 3 seconds, the timer function is activated.

Power levels:

Mode 1 [① illuminates blue]:

Pumping capacity: max. 1100 l/h – max. 0.4 bar

Battery life: approx. 70 minutes (with 2.5 Ah battery).
Ideal for dewatering with short hoses, suction of foils, filling watering cans or irrigation of sensitive plants.

Mode 2 [① and ② illuminate blue]:

Pumping capacity: max. 1700 l/h – max. 1.3 bar

Battery life: approx. 35 minutes (with 2.5 Ah battery).
Ideal for dewatering with longer hoses, irrigation with watering spray.

Mode 3 [①, ② and ③ illuminate blue]:

Pumping capacity: max. 2000 l/h – max. 2.0 bar

Battery life: approx. 18 minutes (with 2.5 Ah battery).

Ideal for drainage with height differences or long hoses, irrigation with shower or sprinkler, cleaning or feeding a garden shower.

1. Push the **Flow button** (Ⓜ) on the control panel.
The current power level is displayed for 5 seconds.
2. Push the **Flow button** (Ⓜ) on the control panel repeatedly until the desired power level is displayed.

Depending on environmental conditions (e.g. direct sunlight), the pump can activate the overheating protection. A short cooling phase may then be necessary before restarting.

Timer-Function:

With the timer function the pump can be switched off automatically after 5, 10 or 15 minutes.

Displays when selecting the timer time:

Ⓜ flashes green and blue alternately Timer to 5 minutes

Ⓜ and Ⓝ flashes green and blue alternately Timer to 10 minutes

Ⓜ, Ⓝ and Ⓞ flashes green and blue alternately Timer to 15 minutes

1. Push and hold the **Flow button** (Ⓜ) for 3 seconds.
LED Ⓜ flashes green and blue alternately.
2. Push the **Flow button** (Ⓜ) on the control panel repeatedly until the desired timer time is displayed.
If no button is pressed for 5 seconds, the timer function will start. The pump runs according to the selected timer time and then switches off automatically.

Displays after starting the timer function:

Timer-Time 15 min.	Timer-Time 10 min.	Timer-Time 5 min.	Timer display in blue LEDs
Approx. 15 – 10 min.	Approx. 10 – 7 min.	Approx. 5 – 3 min.	Ⓜ, Ⓝ and Ⓞ go out sequentially
Approx. 10 – 5 min.	Approx. 7 – 3 min.	Approx. 3 – 1 min.	Ⓜ and Ⓝ go out sequentially
Approx. 5 – 0 min.	Approx. 3 – 0 min.	Approx. 1 – 0 min.	Ⓜ goes out

For the last 5 seconds the blue LED Ⓜ flashes rapidly. After starting the timer function, first the timer time is displayed 5 times in blue LEDs and then 1 time the battery charge status in green LEDs for one second.

Notes:

The timer function can be cancelled at any time by pressing the **On/Off button**.

If the battery runs out during the timer function, the pump switches off early.

Applications:



CAUTION! Destruction of the battery!

The battery unit is destroyed when they are immersed in water.

→ Do not immerse the battery unit in the water.

Observe the minimum water level (see 7. TECHNICAL DATA).

Use in flat containers [Fig. O5]:

Art. 14600: The pump is equipped with a hose connector which allows high flow rates.

Art. 14602: If the rain water tank pump is placed in flat containers, e.g. to empty a paddling pool, the telescopic pipe can be removed and replaced with the 33.3-mm (G1) **GARDENA Tap Connector Art. 18202.**

1. Place the battery unit (Ⓜ) in a place protected from water.
2. Place the pump in the container.
3. Start the pump.

Flat suction [Fig. O6]:

In normal operation (with foot Ⓞ), a residual water level of approx. 25 mm is achieved. With flat suction (without foot Ⓞ) a residual water level of approx. 5 mm is achieved.

1. Turn the foot Ⓞ anti-clockwise and remove the foot Ⓞ (bayonet lock).
2. Make sure that the filter (Ⓜ) is inserted correctly.
3. For reassembling the suction foot, see 4. MAINTENANCE.

The pump must not be operated without the filter (Ⓜ).

To pump water from container [Fig. O7]:

For Art. 14602: The length of the telescopic pipe (Ⓞ) should be adjusted in such a manner that the pump does not touch the bottom of the container; this way, dirt in the container is kept away from the pump.

The pump should hang approx. 10 cm above the bottom of the container to prevent excessive contamination.

1. Open the bracket on the battery container (Ⓜ).
2. Hang the battery unit (Ⓜ) **on the outside**, on the side of the container or place it in a suitable, flood-proof place.
3. **For Art. 14600:** Hang the pump into the container using a rope (do not hang it with the cable).

For Art. 14602: Hang the pump with the telescopic tube (Ⓞ) into the container.

4. Start the pump.

To start the pump [Fig. O1/O4]:

To start:

1. Open the cover (Ⓞ).
2. Put the battery (Ⓜ) into the battery holder (Ⓜ) until it audibly engages.
3. Close the cover (Ⓞ) until it engages noticeably.
Make sure that the cover (Ⓞ) of the battery container is properly closed.
4. Push the **On/Off button** (Ⓜ) on the control panel (Ⓜ).
The Pump starts and the battery charge status indication is displayed.

NOTES:

Depending on the length of the hose and the type of installation, it may take some time for the pump to deliver the water.

If the pump does not deliver water after several suction attempts, there is probably air in the hose.

→ Start the pump once briefly in water without a hose.

To stop:

1. Push the **On/Off button** (S) on the control panel (P).
The Pump stops.
2. Push the locking button (A) and remove the battery (B) from the battery container (U).

4. MAINTENANCE



DANGER! Risk of injury!

Injury when the product starts accidentally.

→ Remove the battery before you maintain the product.

To clean the pump:



DANGER! Risk of injury!

Risk of injury and risk of damage to the product.

- Do not clean the product with a water jet (in particular high-pressure water jet).
- Do not clean with chemicals including petrol or solvents. Some can destroy critical plastic parts.

→ Clean the pump with a damp cloth.

To clean the filter [Fig. M1/M2/M3]:

In order to ensure continuous trouble-free operation, the filter (10) should be cleaned at regular intervals.

After pumping dirty water, the filter (10) must be cleaned immediately.

1. Turn the foot (9) anti-clockwise and remove the foot (9) (bayonet lock).
2. Turn the filter (10) anti-clockwise and remove the filter (10) (bayonet lock).
3. Clean the filter (10) and the foot (9) under running water.
4. Push the filter (10) into the pump so that the lines (a1)/(a2) are opposite.
5. Turn the filter (10) anti-clockwise (bayonet lock).
6. Push the foot (9) onto the pump so that the lines (a1)/(a2) are opposite.
7. Turn the foot clockwise (bayonet lock).

The pump must not be operated without the filter (10).

To clean the battery and the battery charger:

Make sure that the surface and the contacts of the battery and the battery charger always are clean and dry before you connect the battery charger.

Do not use running water.

- **Battery charger:** Clean the contacts and the plastic parts with a soft and dry cloth.
- **Battery:** Occasionally clean the ventilation slots and the terminals on the battery using a soft brush that is clean and dry.

5. STORAGE

To put into storage [Fig. S1]:

The product must be stored away from children.

1. Remove the battery.
2. Charge the battery.
3. Turn the pump upside down to allow residual water to flow out.
4. Clean the pump, the battery holder, the battery and the battery charger (see 4. MAINTENANCE).
5. To save storage space, fold in the bracket and slide the battery holder (11) from above onto the intended holder on the pump.
6. Store the pump, the battery and the battery charger in a dry, enclosed and frost-free place.

Disposal:

(in accordance with RL2012/19/EC)



The product must not be disposed of to normal household waste. It must be disposed of in line with local environmental regulations.

IMPORTANT!

→ Dispose of the product through or via your municipal recycling collection centre.

Disposal of the battery:



The GARDENA battery contains lithium-ion cells that should not be disposed of with normal household waste at the end of its life.

IMPORTANT!

→ Dispose of the batteries through or via your municipal recycling collection centre.

1. Discharge the lithium-ion cells completely (contact the GARDENA Service).
2. Protect the contacts on the lithium-ion cells against short circuits.
3. Dispose of the lithium-ion cells properly.





6. TROUBLESHOOTING





DANGER! Risk of injury!

Injury when the product starts accidentally.

→ Remove the battery before you troubleshoot the product.

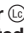
Problem	Possible Cause	Remedy
Pump is running, but doesn't deliver	Air cannot escape, because the pressure line is closed. (Possible kink in the pressure hose.)	→ Open the pressure line (e.g. shut-off valve, delivery units).
	Air in suction foot.	→ Wait for about max. 60 seconds until the pump has vented; if necessary, switch off/on several times if necessary. If this does not help briefly start the pump in the water once without the hose.
	Foot/Filter is clogged.	→ Clean the foot/filter.
	Water level below minimum water level when put into operation.	→ Submerge the pump deeper.
Pump is running but the delivery drops suddenly	Foot/Filter is clogged.	→ Clean the foot/filter.
Pump does not start or stops. LED  is flashing green [Fig. O4]	Battery is empty.	→ Charge the battery.
Pump does not start or stops. Error-LED  is illuminated red [Fig. O4]	Battery temperature is outside the permissible temperature range.	→ Wait until the battery temperature is between 0 °C – +45 °C again.
	Dry-running protection has tripped.	→ Submerge the pump deeper.
	Overtemperature of the control panel.	→ Let the control panel cool down (e.g. remove it from the sun).
	Air is in the hose.	→ Start the pump once briefly in water without a hose.
	Water has entered the battery.	→ Allow the battery to dry in a protected place.
	There are drops of water or moisture between the battery contacts in the battery container.	→ Remove the water drops/moisture with a dry cloth.
	Motor is blocked.	→ Contact the GARDENA Service.
Pump does not start or stops. Error-LED  is flashing red [Fig. O4]	Product is defective.	→ Contact the GARDENA Service.
Pump does not start or stops. Error-LED  is not illuminated [Fig. O4]	Battery is not put completely into the battery holder.	→ Put the battery completely into the battery holder until it audibly engages.
	Battery is defective.	→ Replace the battery.
	Product is defective.	→ Contact the GARDENA Service.
Charging is not possible. Battery charge indicator  is continuously illuminated [Fig. O3]	The battery is not connected (correctly).	→ Connect the battery to charger correctly.
	Battery contacts are dirty.	→ Clean the battery contacts (e.g. by connecting and disconnecting the battery several times. Replace the battery if necessary.

Problem	Possible Cause	Remedy
Charging is not possible. Battery charge indicator  is continuously illuminated [Fig. O3]	Battery temperature is outside the permissible charging temperature range.	→ Wait until the battery temperature is between 0 °C – +45 °C again.
	Battery is defective.	→ Replace the battery.
Battery charge indicator  is not illuminated [Fig. O3]	Mains plug of the charger is not (correctly) plugged in.	→ Insert the mains plug into the mains socket (completely).
	Socket outlet, mains cable or charger is defective.	→ Check the mains voltage. Let the charger be checked if necessary by an authorised specialist dealer or the GARDENA Service.



NOTE: For any other malfunctions please contact the GARDENA service department. Repairs must only be done by GARDENA service departments or specialist dealers approved by GARDENA.

7. TECHNICAL DATA

Battery Pump	Unit	Value (Art. 14600)	Value (Art. 14602)
Max. delivery capacity	l/h	2000	2000
Max. pressure	bar	2.0	2.0
Max. delivery head	m	20	20
Max. submersion depth	m	1.8	1.8
Max. media temperature	°C	35	35
Min. water depth for operation with foot/ without foot (approx.)	mm	50 / 25	50 / 25
Residual water level with foot/ without foot (approx.)	mm	25 / 5	25 / 5
Weight (without Battery)	kg	1.8	2.2

8. ACCESSORIES

GARDENA System Battery PBA 18V/36 P4A PBA 18V/45 P4A PBA 18V/72 P4A	Battery for additional duration or for replacement.	Art. 14902 Art. 14903 Art. 14905
GARDENA Battery Charger AL 1810 CV P4A		Art. 14900-28 (UK) Art. 14900-52 (AU/NZ)
GARDENA Battery Quick Charger AL 1830 CV P4A	Charger for fast charging the POWER FOR ALL System Batteries PBA 18V..W-..	Art. 14901-28 (UK) Art. 14901-52 (AU/NZ)
GARDENA Extension Pipe	To extend the telescopic tube.	Art. 1420

9. SERVICE/WARRANTY

Service:

Please contact the address on the back page.

Warranty statement:

In the event of a warranty claim, no charge is levied to you for the services provided.

GARDENA Manufacturing GmbH grants a warranty for all original GARDENA new products for two years from the date of original purchase from the retailer, provided that the devices have been for private use only. This manufacturer's warranty does not apply to products acquired second hand. This warranty includes all significant defects of the product that can be proved to be material or manufacturing faults. This warranty is fulfilled by supplying a fully functional replacement product or by repairing the faulty product sent to us free of charge; we reserve the right to choose between these options. This service is subject to the following provisions:

- The product has been used for its intended purpose as per the recommendations in the operating instructions.
- Neither the purchaser nor a third party has attempted to open or repair the product.
- Only Original GARDENA replacement parts and wear parts have been used for operation.

- Presentation of the receipt.

Normal wear and tear of parts and components (such as blades, blade fixing parts, turbines, light bulbs, V-belts/toothed belts, impellers, air filters, spark plugs), visual changes, wear parts and consumables are excluded from the warranty.

This manufacturer's warranty is limited to replacement and repair of products in accordance with the abovementioned conditions. The manufacturer's warranty does not constitute an entitlement to lodge other claims against us as a manufacturer, such as for damages. This manufacturer's warranty does **not**, of course, affect statutory and contractual warranty claims against the dealer/retailer.

The manufacturer's warranty is governed by the law of the Federal Republic of Germany.

In case of a warranty claim, please return the faulty product, together with a copy of the receipt and a description of the fault, with postage paid to the service address.

Consumables:

The impeller and filter are consumables and are not included in the warranty.

Performance characteristics

Courbes de performance

**Curva caratteristica
de la bomba**

**Características de
performance**

펌프 특성곡선

泵抽特征线

ポンプ性能特性

עקומת אפיון של המשאבה

2000/2 Clear 18V P4A

Art. 14600

2000/2 18V P4A

Art. 14602

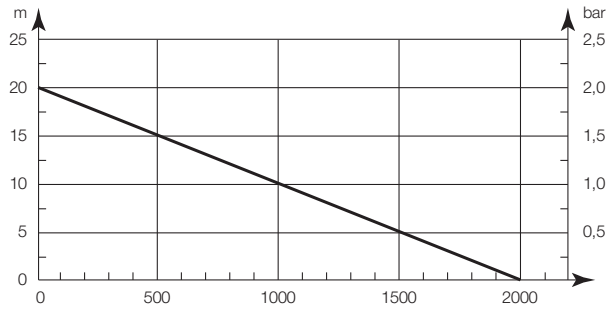

Deutschland / Germany

GARDENA
 Manufacturing GmbH
 Central Service
 Hans-Lorenser-Straße 40
 D-89079 Ulm
 Produktfragen:
 (+49) 731 490-123
 Reparaturen:
 (+49) 731 490-290
 service@gardena.com
 http://www.gardena.com

Albania

KRAFT SHPK
 Autostrada Tirane-Durres
 Km 7
 1051 Tirane

Argentina

ROBERTO C. RUMBO S.R.L.
 Predio Norlog
 Lote 7
 Benavidez, ZC:1621
 Buenos Aires
 ventas@rumbosrl.com.ar

Australia

Husqvarna Australia Pty. Ltd.
 Locked Bag 5
 Central Coast BC
 NSW 2252
 Phone: (+61) (0) 2 4352 7400
 customer.service@
 husqvarna.com.au

Austria / Österreich

Husqvarna Austria GmbH
 Industriezeile 36
 4010 Linz
 Tel.: (+43) 732 77 01 01-485
 service.gardena@
 husqvagnaroup.com

Azerbaijan

Firm Progress
 a. Aliyev Str. 26A
 1052 Baku

Belarus

Private Enterprise
 "Master Garden"
 Minsk
 Sharangovich str., 7a
 Phone: (+375) 17 257-00-33
 Mob. (+375) 29 676-16-09
 mg@mastergarden.by

Belgium

Husqvarna Belgium nv
 Gardena Division
 Leuvensesteenweg 542
 Planet II E
 1930 Zaventem
 België

Bosnia / Herzegovina

SILK TRADE D.o.o.
 Industrijska zona Bukva bb
 74260 Tešanj

Brazil

Husqvarna do Brasil Ltda
 Av. Francisco Matarazzo, 1400 - 19º andar
 São Paulo - SP
 CEP: 05001-903
 Tel: 0800-112252
 marketing.br.husqvarna@
 husqvarna.com.br

Bulgaria

AGROLAND България АД
 бул. 8 Декември, №13
 Офис 5
 1700 Студентски град
 София
 Тел.: (+359) 24 666 610
 info@agroland.eu

Canada / USA

GARDENA Canada Ltd.
 100 Summerlea Road
 Brampton, Ontario L6T 4X3
 Phone: (+1) 905 792 9330
 info@gardena.ca

Chile

REPRESENTACIONES
JCE S.A.
 Av. Del Valle Norte 857,
 Piso 4
 Santiago RM
 Phone: (+56) 2 24142560
 contacto@jce.cl

China

Husqvarna (Shanghai)
 Management Co., Ltd.
 富世华 (上海) 管理有限公司
 3F, Beng Square B,
 No207, Song Hong Rd.,
 Chang Ning District,
 Shanghai
 PRC. 200335
 上海市长宁区淞虹路207号明
 基广场B座3楼. 邮编: 200335

Colombia

Husqvarna Colombia S.A.
 Calle 18 No. 68 D-31, zona
 Industrial de Montevideo
 Bogotá, Cundinamarca
 Tel. 571 2922700 ext. 105
 jairo.salazar@
 husqvarna.com.co

Costa Rica

Compania Exim
 Euroberoamericana S.A.,
 Los Colegios, Moravia,
 200 metros al Sur del Colegio
 Saint Francis - San Jose
 Phone: (+506) 297 68 83
 exim_euro@racsa.co.cr

Croatia

Husqvarna Austria GmbH
 Industriezeile 36
 4010 Linz
 Tel.: (+43) 732 77 01 01-485
 service.gardena@
 husqvagnaroup.com

Cyprus

Med Marketing
 17 Digeni Akritia Ave
 P.O. Box 27017
 1641 Nicosia

Czech Republic

Husqvarna Česko s.r.o.
 Tůrkova 2319/5b
 149 00 Praha 4 - Chodov
 Bezpłatná infolinia:
 800 120 425
 servis@cz.husqvarna.com

Denmark

GARDENA DANMARK
 Lejrvæj 19, st.
 3500 Værløse
 Tlf.: (+45) 70264770
 husqvarna@husqvarna.dk
 www.gardena.com/dk

Dominican Republic

BOSQUESA, S.R.L
 Carretera Santiago Lacey
 Km. 5 ½
 Esquina Copal II,
 Santiago
 Dominican Republic
 Phone: (+809) 736-0333
 josebosquesa@claro.net.do

Ecuador

Husqvarna Ecuador S.A.
 Arupos E1-181 y 10 de
 Agosto Quito, Pichincha
 Tel. (+593) 22800739
 francisco.jacome@
 husqvarna.com.ec

Estonia

Husqvarna Eesti OÜ
 Valdeku 132
 EE-11216 Tallinn
 info@gardena.ee

Finland

Oy Husqvarna Ab
 Gardena Division
 Lautatankhanku 8 / P L 3
 00581 HELSINKI
 www.gardena.fi

France

Husqvarna France
 9 11 Allée des pierres mayettes
 92635 Gennevilliers Cedex
 France
 http://www.gardena.com/fr
 N° AZUR: 0 810 00 78 23
 (Prix d'un appel local)

Georgia

Transporter LLC
 113b Bellashvili street
 0159 Tbilisi, Georgia

Great Britain

Husqvarna UK Ltd
 Preston Road
 Aycliffe Industrial Park
 Newton Aycliffe
 County Durham
 DL5 6UP
 info.gardena@
 husqvarna.co.uk

Greece

Π. ΠΑΠΑΔΟΠΟΥΛΟΣ ΑΕΒΕ
 Λεωφ. Αθηνών 92
 Αθήνα
 Τ.Κ.104 42
 ΕΛΛΑΔΑ
 Τηλ. (+30) 210 5193 100
 info@papadopoulos.com.gr

Hungary

Husqvarna Magyarorszag Kft.
 Ezred u. 1-3
 1044 Budapest
 Telefon: (+36) 1 251-4161
 vevozszolgalt.husqvarna@
 husqvarna.hu

Iceland

BYKO ehf.
 Bildshófa 20
 110 Reykjavik

Ireland

Husqvarna UK Ltd
 Preston Road
 Aycliffe Industrial Park
 Newton Aycliffe
 County Durham
 DL5 6UP
 info.gardena@
 husqvarna.co.uk

Italy

Husqvarna Italia Spa
 Centro Direzionale Pianum
 Via del Lavoro 2, Scala B
 22036 ERBA (CO)
 Tel. (+39) 031.4147700
 assistenza.italia@
 it.husqvarna.com

Japan

Husqvarna
 Zenoah Co. Ltd. Japan
 1-9 Minamidai, Kawagoe
 350-1165 Saitama
 Japan
 gardena-jp@
 husqvarnagroup.com

Kazakhstan

LAMED Ltd.
 155/11, Tazhibayevol Str.
 050060 Almaty
 IP Schmidt
 Abayavenue 3B
 110 005 Kostanay

Korea

Kyung Jin Trading CO., LTD.
 107-4, SunDuk Bid.,
 YangJae-dong,
 Seocho-gu,
 Seoul, (zipcode: 137-891)
 Phone: (+82) (0)2 574-6300

Latvia

Husqvarna Latvija SIA
 Ulbrokas 19A
 LV-1021 Riga
 info@gardena.lv

Lithuania

UAB Husqvarna Lietuva
 Ateities pl. 77C
 LT-52104 Kaunas
 info@gardena.lt

Luxembourg

Magasins Jules Neuberg
 39, rue Jacques Stas
 Luxembourg-Gasperich 2549
 Case Postale No. 12
 Luxembourg 2010
 Phone: (+352) 40 14 01
 api@neuberg.lu

Mexico

AFOSA
 Av. Lopez Mateos Sur # 5019
 Col. La Calma 45070
 Zapopan, Jalisco
 Mexico
 Phone: (+52) 33 3818-3434
 cornejo@afosa.com.mx

Moldova

Convel S.R.L.
 290A Muncesti Str.
 2002 Chisinau

Netherlands

Husqvarna Nederland B.V.
 GARDENA Division
 Postbus 50131
 1305 AC ALMERE
 Phone: (+31) 36 521 00 10
 info@gardena.nl

Neth. Antilles

Jonka Enterprises N.V.
 Sta. Rosa Weg 196
 P.O. Box 8200
 Curaçao
 Phone: (+599) 9 767 66 55
 pgm@jonka.com

New Zealand

Husqvarna New Zealand Ltd.
 PO Box 76-437
 Manukau City 2241
 Phone: (+64) (0) 9 9202410
 support.nz@husqvarna.co.nz

Norway

Husqvarna Norge AS
 Gardena Division
 Traskemeitlen 36
 1708 Sarpsborg
 info@gardena.no

Peru

Husqvarna Perú S.A.
 Jr. Ramón Cárcamo 710
 Lima 1
 Tel.: (+51) 1 3320 400 ext. 416
 juan.remujo@
 husqvarna.com

Poland

Husqvarna
 Poland Spółka z o.o.
 ul. Wysockiego 15 b
 03-371 Warszawa
 Phone: (+48) 22 330 96 00
 gardena@husqvarna.com.pl

Portugal

Husqvarna Portugal, SA
 Lagoa - Albarraque
 2635 - 595 Rio de Mour
 Tel.: (+351) 21 922 85 30
 Fax : (+351) 21 922 85 36
 info@gardena.pt

Romania

Madex International Srl
 Soseava Odaii 117 - 123,
 RO 013603 București, S 1
 Phone: (+40) 21 352 76 03
 madex@ines.ro

Russia / Россия

ООО „Мускварна“
 141400, Московская обл.,
 г. Химки,
 улица Ленинградская,
 владение 39, стр.6
 Бизнес Центр
 „Химки Бизнес Парк“,
 помещение ОВ02_04
 http://www.gardena.ru

Serbia

Domel d.o.o.
 Autoput za Novi Sad bb
 11273 Belgrade
 Phone: (+381) 118 48 88 12
 miroslav.jejina@domel.rs

Singapore

Hy-Ray PRIVATE LIMITED
 40 Jalan Pemimpin
 # 02-08 Tat Ann Building
 Singapore 577185
 Phone: (+65) 6253 2277
 shiyang@hyray.com.sg

Slovak Republic

Husqvarna Cesko s.r.o.
 Tůrkova 2319/5b
 149 00 Praha 4 – Chodov
 Bezpłatná infolinia: 800 154 044
 servis@sk.husqvarna.com

Slovenia

Husqvarna Austria GmbH
 Industriezeile 36
 4010 Linz
 Tel.: (+43) 732 77 01 01-485
 service.gardena@
 husqvagnaroup.com

South Africa

Husqvarna South Africa (Pty) Ltd
 Postnet Suite 250
 Private Bag 36,
 Cascades, 3202, South Africa
 Phone: (+27) 33 846 9700
 info@gardena.co.za

Spain

Husqvarna España S.A.
 Calle de Rivas nº 10
 28052 Madrid
 Phone: (+34) 91 708 05 00
 atencioncliente@gardena.es

Suriname

Deto Handelmaatschappij N.V.
 Kernkampweg 72-74
 P.O.Box: 12782
 Paramaribo – Suriname
 South America
 Phone: (+597) 438050
 www.deto.sr

Sweden

Husqvarna AB /
GARDENA Sverige
 Drottninggatan 2
 561 82 Huskvarna Sverige
Switzerland / Schweiz
Husqvarna Schweiz AG
 Consumer Products
 Industriestrasse 10
 5506 Mägwil
 Phone: (+41) (0) 62 887 37 90
 info@gardena.ch

Turkey

Dost Bahçe Diş Ticaret
 Müessesilik A.Ş
 Yunus Mah. Adil Sok. No:3
 İc Kapi No: 1 Kartal
 34873 İstanbul
 Phone: (+90) 216 38 93 939
 info@dstbahce.com.tr

Ukraine / Україна

ТОВ „Мускварна Україна“
 вул. Васильківська, 34,
 офіс 204-
 03022, м. Київ
 Тел. (+38) 0 800 504 804
 info@gardena.ua

Uruguay

FELI SA
 Entré Ríos 1083 CP 11800
 Montevideo – Uruguay
 Tel: (+598) 22 03 18 44
 info@felisa.com.uy

Venezuela

Corporacion Casa y Jardín C.A.
 Av. Caroni, Edif. Trezmen, PB.
 Colinas de Bello Monte,
 1050 Caracas.
 Tlf: (+58) 212 992 33 22
 info@casayjardin.net.ve

14600-56.996.01/0621

© GARDENA Manufacturing GmbH
 D-89079 Ulm
 http://www.gardena.com