

Power Vac 2700 Art. 9705151-xx

Remark: "xx" stands for customer and country variants.
The basic product number is before the hyphen.

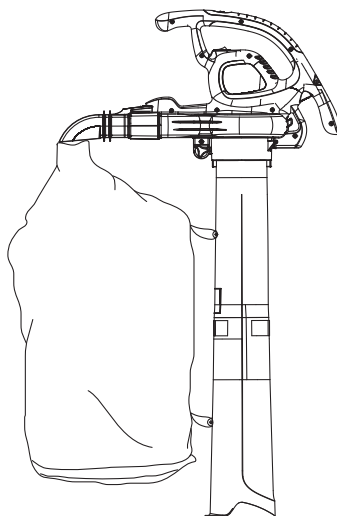

EN Operator's manual
Electric Blower/Vacuum

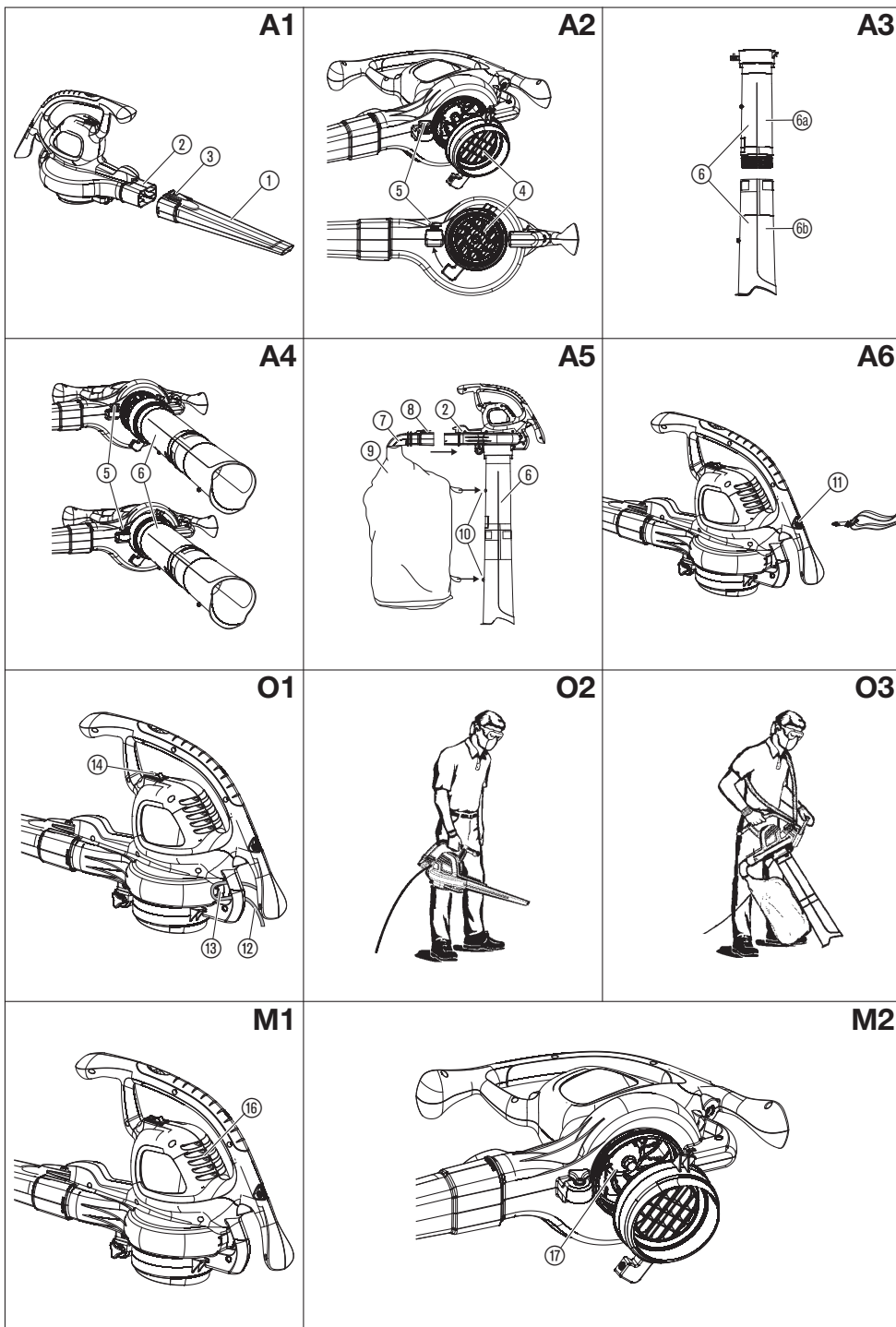

FLYMO Blower/Vacuum Power Vac 2700

1. SAFETY	3
2. ASSEMBLY	5
3. OPERATION	6
4. MAINTENANCE	6
5. STORAGE	7
6. TROUBLESHOOTING	7
7. TECHNICAL DATA	8
8. SERVICE/WARRANTY	8

Original instructions.



This product may be used under supervision, or if instruction regarding the safe use of the product has been provided and the resulting dangers have been understood, by children aged 8 and above, as well as by persons with physical, sensory or mental disabilities or a lack of experience and knowledge. Children must not be allowed to play with the product. Cleaning and user maintenance must not be performed by children

without supervision. The use of this product by young people under the age of 16 is not recommended.

Intended use as blower:

The FLYMO Blower/Vacuum is suitable when used as a blower for sweeping debris or grass clippings from driveways, sidewalks, patios, etc. and for blowing grass clippings, straw, or leaves into piles, or removing debris from corners, around joints, or between bricks.

Intended use as vacuum:

The FLYMO Blower/Vacuum is suitable when used as a vacuum for picking up dry material such as leaves, grass, small twigs, and bits of paper.



DANGER! Risk of injury!

→ If not used properly this product can be dangerous. The warnings and safety instructions must be followed to ensure reasonable safety and efficiency in using this product. The operator is responsible for following the warnings and instructions in this manual and on the product. Never use the product unless the guards provided by the manufacturer are in the correct position.

1. SAFETY

Symbols on the product:



Read operator's manual.



SWITCH OFF:

Remove plug from mains before cleaning or maintenance.



Do not expose to rain.



The use of eye and ear protection is recommended. Keep in mind, that you probably won't hear bystanders, which enter the working area.



Keep bystanders away.



Disconnect the mains plug if the cord becomes damaged or entangled.

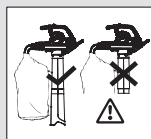

Use only with fully installed suction tube and covered collection bag in suction mode.



Wait until the rotor blades have stopped moving after switching off.



Do not use when wearing open hair, loose jewellery or loose-fitting clothes.

General safety warnings

Electrical safety



WARNING! Electric shock!

Risk of injury due to electric shock.

→ **The product must be supplied through a residual current device (RCD) having a rated residual operating current not exceeding 30 mA.**

Cables:

If the supply cord is damaged, it must be replaced by the manufacturer, its service agent or similarly qualified persons in order to avoid a hazard.

Extension cables are available from your local approved service centre. Only use extension cables specifically designed for outdoor use.

Use only 1.00 mm² size cable up to 40 metres length maximum.

Minimum rating: 1.00 mm² size cable.

1 General

This annex presents safe operating practices for **hand-held mains-operated electrical garden vacuums, and garden blower/vacuums** with or without **shredding means and garden blowers**.

These practices are not all inclusive. The substance of these requirements should be provided with each machine as appropriate and tailored to the specific type of machine. It should also include information concerning noise and vibration levels and any necessary warnings, together with the following:

IMPORTANT
READ CAREFULLY BEFORE USE.
KEEP FOR FUTURE REFERENCE.

2 Safe operating practices for hand-held mains-operated electrical garden vacuums, and garden blower/vacuums with or without shredding means and garden blowers.

2.1 Training

- Read the instructions carefully. Be familiar with the controls and the correct use of the machine.
- Never allow children or people unfamiliar with these instructions to use the machine.

Local regulations can restrict the age of the operator.

- Keep in mind, that the operator or user is responsible for accidents or hazards occurring to other people or their property.

2.2 Preparation

- Obtain ear protection and safety glasses. Wear them at all times while operating the machine.
- While operating the machine always wear substantial footwear and long trousers. Do not operate the machine when barefoot or wearing open sandals. Avoid wearing clothing that is loose fitting or that has hanging cords or ties.
- Do not wear loose clothing or jewellery that can be drawn into the air inlet. Keep long hair away from the air inlets.
- Operate the machine in a recommended position and only on a firm, level surface.

- Do not operate the machine on a paved or gravel surface where ejected material could cause injury.
- Before using, always visually inspect to see, that the shredding means, shredding means bolts and other fasteners are secure, the housing is undamaged and that guards and screens are in place. Replace worn or damaged components in sets to preserve balance. Replace damaged or unreadable labels.
- Before use, check the supply and extension cord for signs of damage or aging. If the cord becomes damaged during use, disconnect the cord from the supply immediately. **DO NOT TOUCH THE CORD BEFORE DISCONNECTING THE SUPPLY.** Do not use the machine if the cord is damaged or worn.
- Never operate the machine while people, especially children, or pets are nearby.

2.3 Operation

- Before starting the machine, make certain that the feeding chamber is empty.
- Keep your face and body away from the feed intake opening.
- Do not allow hands or any other part of the body or clothing inside the feeding chamber, discharge chute, or near any moving part.
- Keep proper balance and footing at all times. Do not overreach. Never stand at a higher level than the base of the machine when feeding material into it.
- Always stand clear of the discharge zone when operating this machine.
- When feeding material into the machine be extremely careful that pieces of metal, rocks, bottles, cans or other foreign objects are not included.
- If the cutting mechanism strikes any foreign objects or if the machine should start making any unusual noise or vibration, immediately shut off the power source and allow the machine to stop. Disconnect the machine from the supply and take the following steps before restarting and operating the machine:
 - inspect for damage;
 - replace or repair any damaged parts;
 - check for and tighten any loose parts.
- Do not allow processed material to build up in the discharge zone; this may prevent proper discharge and can result in kickback of material through the intake opening.
- If the machine becomes clogged, shut-off the power source and disconnect the machine from supply before cleaning **debris**.
- Never operate the machine with defective **guards** or shields, or without safety devices, for example **debris collector** in place.
- Keep the power source clean of debris and other accumulations to prevent damage to the power source or possible fire.
- Do not transport this machine while the power source is running.
- Stop the machine, and remove plug from the socket. Make sure that all moving parts have come to a complete stop
 - whenever you leave the machine,

- before clearing blockages or unclogging chute,
 - before checking, cleaning or working on the machine.
- n) Do not tilt the machine while the power source is running.

2.4 Maintenance and storage

- a) When the machine is stopped for servicing, inspection, or storage, or to change an accessory, shut off the power source, disconnect the machine from the supply and make sure that all moving parts are come to a complete stop. Allow the machine to cool before making any inspections, adjustments, etc. Maintain the machine with care and keep it clean.
- b) Store the machine in a dry place out of the reach of children.
- c) Always allow the machine to cool before storing.
- d) When servicing the **shredding means** be aware that, even though the power source is switched off due to the interlock feature of the **guard**, the **shredding means** can still be moved.
- e) Replace worn or damaged parts for safety. Use only genuine replacement parts and accessories.

- f) Never attempt to override the interlocked feature of the **guard**.

2.5 Additional safety instructions for units with bagging attachments

Switch-off the machine before attaching or removing the bag.

2.6 Recommendation

The machine should be supplied via a residual current device (RCD) with a tripping current of not more than 30 mA.

Additional safety warnings

Danger! Small parts could be swallowed during assembly and there is a risk of suffocation from the polybag. Keep infants away during assembly.

Warning! This machine produces an electromagnetic field during operation. This field may under some circumstances interfere with active or passive medical implants. To reduce the risk of serious or fatal injury, we recommend persons with medical implants to consult their physician and the medical implant manufacturer before operating this machine.

2. ASSEMBLY



WARNING! Risk of physical injury!

Cut injury when the impeller turns or the product starts accidentally.

→ **Wait for the impeller to stop, disconnect the product from the mains and use gloves before you do assembly.**

To assemble for blower use:

To fit the blower tube [Fig. A1]:

NOTE: A safety switch will prevent the product from starting if the blower tube ① is not installed correctly.

1. Align the grooves on the blower tube ① with the grooves on the blower outlet ②.
2. Push the blower tube ① onto the blower outlet ② until it snaps into place.
The blower tube is secured to the blower outlet with the tube release button ③.

To remove the blower tube ①, push the tube release button ③ and pull out the blower tube ① at the same time.

To fit the intake cover [Fig. A2]:

NOTE: A safety switch will prevent the product from starting if the intake cover ④ is not latched closed.

1. Put the intake cover ④ on the lower opening of the garden blower and turn the intake cover ④ clockwise up to the stop (bayonet fastening).
2. Tighten the fastening screw ⑤.

To remove the intake cover ④, loosen the fastening screw ⑤, turn the intake cover ④ anti-clockwise and remove it.

To assemble for vacuum use:

To fit the vacuum tube [Fig. A3/A4]:

WARNING! Do not use the vacuum ⑥ unless the lower tube ⑥a is fitted to the upper tube ⑥b.

1. Align the seams of the lower tube ⑥a and upper tube ⑥b.
2. Push the tubes ⑥a/⑥b together until they are fully engaged.

NOTE: A safety switch will prevent the product from starting if the vacuum tube ⑥ is not installed correctly.

3. Put the vacuum tube ⑥ on the lower opening of the garden vacuum and turn the vacuum tube ⑥ clockwise up to the stop (bayonet fastening).
4. Tighten the fastening screw ⑤.

To remove the vacuum tube ⑥, loosen the fastening screw ⑤, turn the vacuum tube ⑥ anti-clockwise and remove it.

To attach the collection bag [Fig. A5]:

NOTE: A safety switch will prevent the product from starting if the elbow tube ⑦ is not installed correctly.

1. Align the grooves on the elbow tube ⑦ with the grooves on the blower outlet ②.
2. Push the elbow tube ⑦ onto the blower outlet ② until it snaps into place.
The collection bag is secured to the blower outlet with the tube release button ⑧.
3. Clip the collection bag ⑨ into both loops ⑩ on the vacuum tube ⑥.

To remove the collection bag ⑨, push the tube release button ⑧ and pull out the elbow tube ⑦ at the same time.

To attach the shoulder strap [Fig. A6]:

For extra support when you use the product as a vacuum, a shoulder strap is included with your product. Attach the strap to the product before operation.

→ Snap the hook onto the retainer ⑪.

3. OPERATION



WARNING! Risk of physical injury!

Cut injury when the impeller turns or the product starts accidentally.

→ **Wait for the impeller to stop, disconnect the product from the mains and use gloves before you connect or transport the product.**

To connect the product [Fig. O1]:



DANGER! Risk of electric shock!

To avoid damage to the mains cable ⑫ it must be inserted into the cable lock ⑬.

→ **Before you operate the product insert the mains cable ⑫ into the cable lock ⑬.**

1. Loop the mains cable ⑫, insert the loop into the cable lock ⑬ and pull tight.
2. Connect the mains cable ⑫ into a 230 V mains socket.

To start the product [Fig. O1]:

To start:

→ Push the start switch ⑭ to the **ON**-position.

To stop:

→ Push the start switch ⑭ to the **OFF**-position.

Work positions:

Blow mode [Fig. O2]:

Use your product as a blower for sweeping debris or grass clippings from driveways, sidewalks, patios, etc. Also, for blowing grass clippings, straw, or leaves into piles, or removing debris from corners, around joints, or between bricks.

Direct air flow by directing the blower tube down or to one side.

Always work away from solid objects such as walks, large stones, vehicles, and fences.

Clean corners by starting in corners and moving outward.

This will help prevent an accumulation of debris which could fly into your face. Be careful when working near plants. The force of the air could damage tender plants.

Vacuum mode [Fig. O3]:

Use your product as a vacuum to pick up dry material such as leaves, grass, small twigs, and bits of paper.

For best results during vacuum use, operate your unit at high speed.

Move slowly back and forth over the material as you vacuum. Avoid forcing the unit into a pile of debris as this can clog the unit.

Keep the vacuum tube about an inch above the ground for best results.

WARNING: If the product becomes clogged, stop the unit and unplug the extension cord. Wait until the impeller has completely stopped turning, then remove the vacuum tubes. Carefully reach into the vacuum opening and clear out the clogged debris.

This will reduce possible personal injury from the impeller.

4. MAINTENANCE



WARNING! Risk of physical injury!

Cut injury when the impeller turns or the product starts accidentally.

→ **Wait for the impeller to stop, disconnect the product from the mains and use gloves before you do maintenance.**

To clean the product [Fig. M1/M2]:



DANGER! Electric shock!

Risk of injury and risk of damage to the product.

→ **Do not clean the product with water or with a water jet (in particular high-pressure water jet).**

The airflow slots must always be clean.

1. Remove the tubes and the collection bag.

2. Clean the airflow slots (16) and the air intake/outtake area (17) with a soft brush (do not use a screwdriver). Remove all debris from the impeller.

3. Clean the blower head with a damp cloth.

4. Clean the tubes. Remove all debris from the tubes.

5. Turn the collection bag inside out and clean it with water.

5. STORAGE

- To put into storage:**
- The product must be stowed away from children.**
1. Disconnect the mains cable.

2. Clean the product.

3. Stow the product in a dry area where it has protection from frost (Do not stow a dirty collection bag).

Disposal:
(in accordance with RL2012/19/EC/S.I. 2013 No. 3113)



The product must not be disposed of to normal household waste. It must be disposed of in line with local environmental regulations.

IMPORTANT!

→ Dispose of the product through or via your municipal recycling collection centre.

6. TROUBLESHOOTING



WARNING! Risk of physical injury!

Cut injury when the impeller turns or the product starts accidentally.

→ Wait for the impeller to stop, disconnect the product from the mains and use gloves before you do maintenance.

Problem	Possible Causes	Remedy
Product does not start	Blower tube, elbow tube or vacuum tube is not assembled correctly.	→ Assemble the tubes correctly (see 2. ASSEMBLY).
	Collection bag is full.	→ Empty the collection bag.
	Extension cable is disconnected.	→ Connect the extension cable.
	Mechanical failure.	→ Contact your authorized service dealer.
Product vibrates abnormally	Debris in air intake area.	→ Clean the product. Remove any debris.
	Mechanical failure.	→ Contact your authorized service dealer.



For any other malfunctions please contact the Husqvarna UK Ltd. Customer Service.

Repairs must only be done by Husqvarna UK Ltd. service departments or specialist dealers approved by FLYMO.

7. TECHNICAL DATA

<i>Electric Blower/Vacuum</i>	Unit	Value (Power Vac 2700)
Motor power consumption	W	2700
Mains voltage	V	230
Mains frequency	Hz	50
Max. vacuum flow	l/s	170
Mulch ratio		14:1
Max. blow speed	km/h	310
Capacity of collection bag	l	40
Weight	kg	4.8
Sound pressure level $L_{pa}^{1)}$ Uncertainty k_{pa}	dB(A)	87.4 3.0
Sound power level $L_{WA}^{2)}$ measured / guaranteed Uncertainty k_{WA}	dB(A)	100 / 101 1.0
Hand/arm vibration $a_{vhw}^{1)}$ Uncertainty k_a	m/s ²	3.25 1.5

Measuring process complying with: ¹⁾ EN 50636-2-100 ²⁾ RL 2000/14/EC / S.I. 2001 No.1701

8. Service/Warranty

Service:

Please contact the address on the back page.

Warranty statement:

In the event of a warranty claim, no charge is levied to you for the services provided.

Husqvarna UK Ltd. grants a warranty for all original FLYMO new products for two years from the date of original purchase from the retailer, provided that the devices have been for private use only. This manufacturer's warranty does not apply to products acquired second hand. This warranty includes all significant defects of the product that can be proved to be material or manufacturing faults. This warranty is fulfilled by supplying a fully functional replacement product or by repairing the faulty product sent to us free of charge; we reserve the right to choose between these options. This service is subject to the following provisions:

- The product has been used for its intended purpose as per the recommendations in the operating instructions.
- Neither the purchaser nor a third party has attempted to open or repair the product.
- Only Original FLYMO replacement parts and wear parts have been used for operation.

- Presentation of the receipt.

Normal wear and tear of parts and components (such as blades, blade fixing parts, turbines, light bulbs, V-belts/ toothed belts, impellers, air filters, spark plugs), visual changes, wear parts and consumables are excluded from the warranty.

This manufacturer's warranty is limited to replacement and repair of products in accordance with the abovementioned conditions. The manufacturer's warranty does not constitute an entitlement to lodge other claims against us as a manufacturer, such as for damages. This manufacturer's warranty does **not**, of course, affect statutory and contractual warranty claims against the dealer/retailer.

The manufacturer's warranty is governed by the law of the Federal Republic of Germany.

In case of a warranty claim, please return the faulty product, together with a copy of the receipt and a description of the fault, with postage paid to the service address.

Consumables:

The blower tube and the vacuum tubes are consumables and are not included in the guarantee.

Product liability



In accordance with the German Product Liability Act, we hereby expressly declare that we accept no liability for damage incurred from our products where said products

have not been properly repaired by a FLYMO-approved service partner or where original FLYMO parts or parts authorised by FLYMO were not used.

EC Declaration of Conformity

The undersigned hereby certifies as the authorised representative of the manufacturer, Husqvarna AB, 561 82 Huskvarna, Sweden, that, when leaving our factory, the unit(s) indicated below is/ are in accordance

with the harmonised EU guidelines, EU standards of safety and product specific standards. This certificate becomes void if the unit(s) is/ are modified without our approval.

Description of the product:	Electric Blower/Vac
Product type:	Power Vac 2700
Article-Number:	Art. 9705151-xx
CE-Directives:	2006/42/EC 2014/30/EU 2011/65/EU 2000/14/EC
Harmonised EN:	EN ISO 12100 EN 60335-1 EN 50636-2-100
Deposited Documentation:	GARDENA Technical Documentation, M. Jäger, 89079 Ulm
Conformity Assessment according to:	2000/14/EC Procedure: art. 14 Annex V
Noise level: measured / guaranteed	100 dB(A) / 101 dB(A)
Ulm, 17.08.2021 Authorised representative:	<div> Reinhard Pompe Vice President Products</div> <div> Wolfgang Engelhardt Vice President Supply Chain</div>

UKCA Declaration of Conformity (only for UK)

The manufacturer: Husqvarna AB SE 561 82 Huskvarna, Sweden hereby certifies, when leaving our factory, the unit(s) indicated below is/are in accordance with the UK Regulations, designated standards of safety and

product specific designated standards. This certificate becomes void if the units are modified without our approval.

Description of the product:	Blower PowerVac 2700
Product type:	PV2700
Article number:	9705151-xx
UK regulations:	S.I. 2008/1597 S.I. 2012/3032 S.I. 2016/1091 S.I. 2001/1701
Designated standards:	EN ISO 12100 EN 60335-1 EN 50636-2-100
Authorised Representative:	Husqvarna UK Limited
Deposited Documentation:	Preston Road, Aycliffe, County Durham UK DL5 6UP
Noise level: measured / guaranteed	100 dB(A) / 101 dB(A)
Conformity Assessment according to:	According to S.I. 2001/1701 Art. 11 Schedule 8

Aycliffe, 17.08.2021
Authorised Representative:

John Thompson
Director

Service Address and Importer to

Great Britain

Husqvarna UK Ltd
Preston Road
Aycliffe Industrial Park
Newton Aycliffe
County Durham
DL5 6UP
Phone: +44 (0) 344 8444558
customer.services@husqvarna.co.uk

51270-85.960.01/0921
Husqvarna AB
S-561 82 Huskvarna
Sweden

Our policy of continuous improvement means that the specification of products may be altered from time to time without prior notice.

Copyright © 2021 Flymo S.A. All rights reserved.

Flymo® and other product and feature names are registered or unregistered trademarks of Flymo S.A.

