

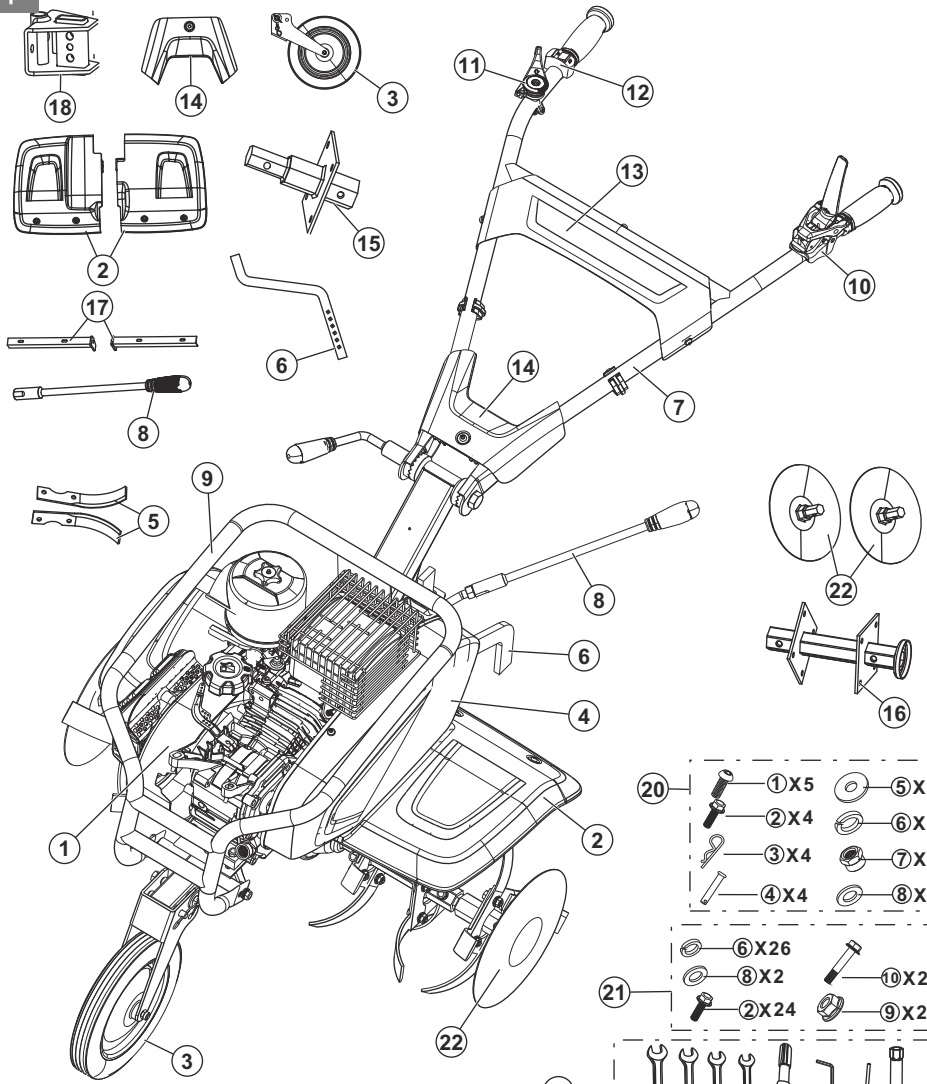

# Husqvarna®



TF 230, TF 338P



- 20 — ① X 5      ⑤ X 9
- ② X 4      ⑥ X 4
- ③ X 4      ⑦ X 4
- ④ X 4      ⑧ X 4

- 21 — ⑥ X 26      ⑩ X 2
- ⑧ X 2      ⑨ X 26
- ② X 24

- 19 — [Wrenches and tools]

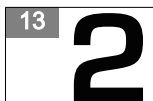
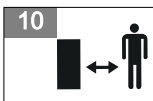
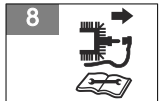
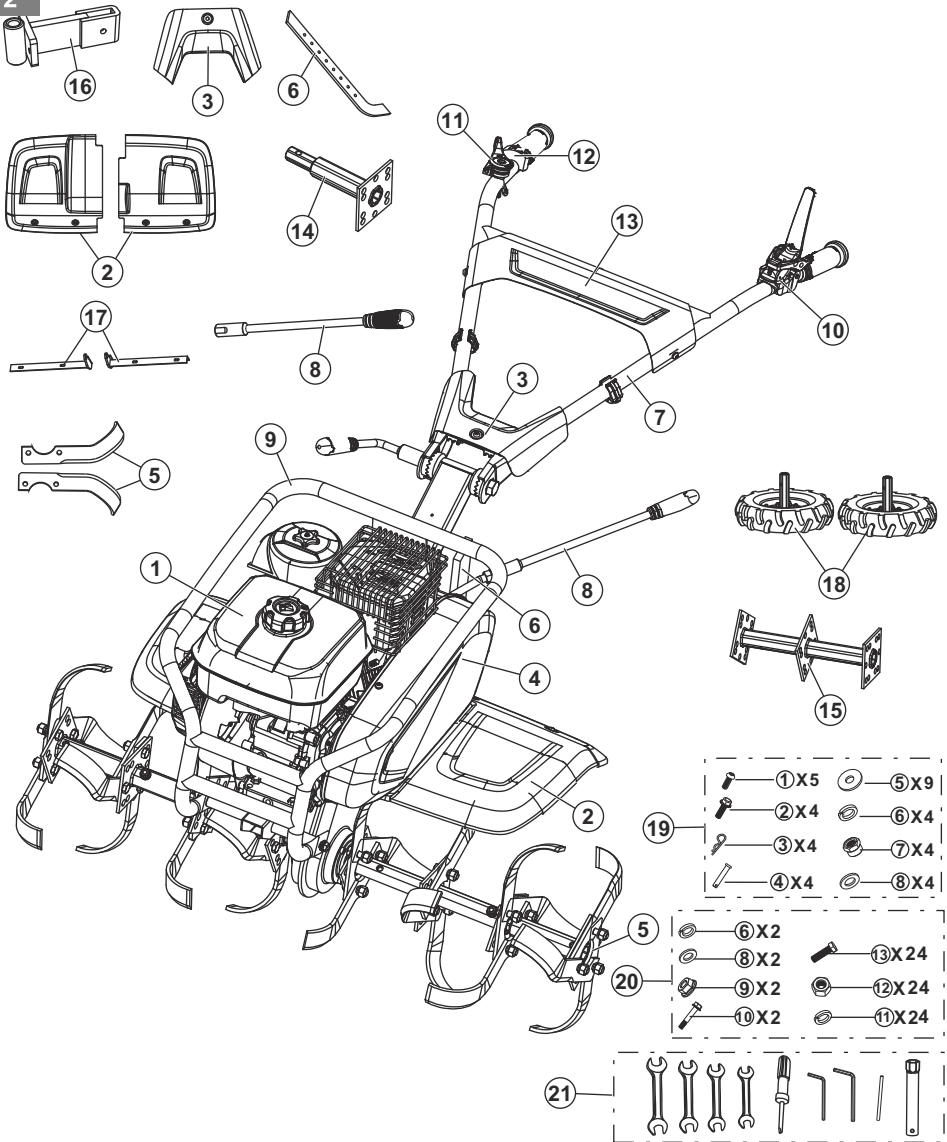

15

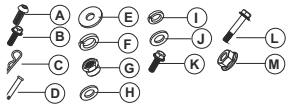

16

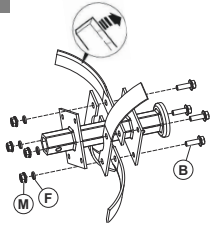

17

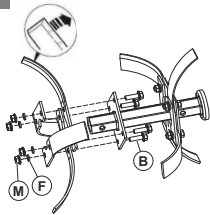

18

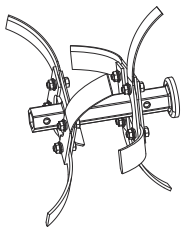

19

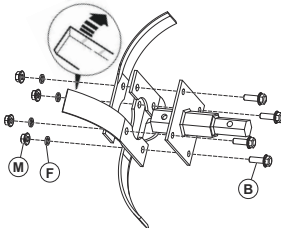

20

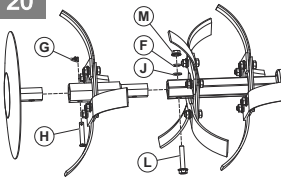

21

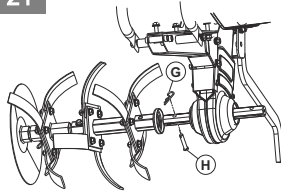

22

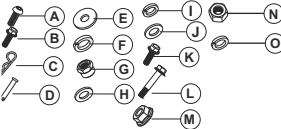

23

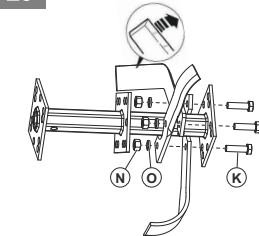

24

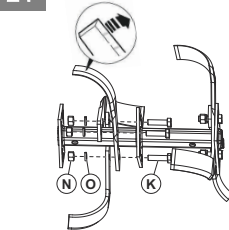

25

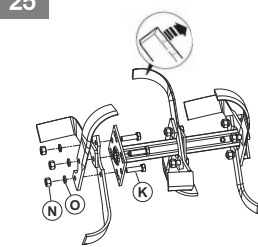

26

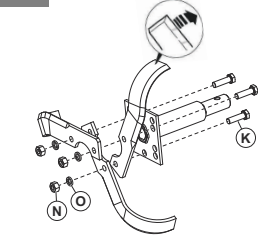

27

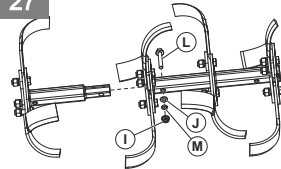

28

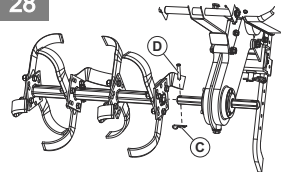

29

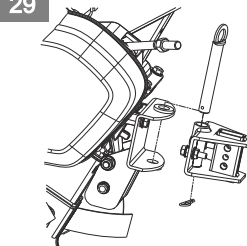

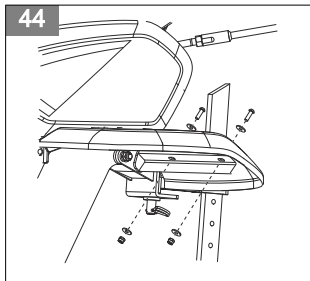
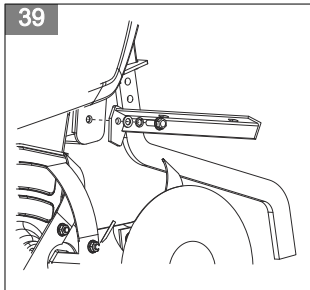
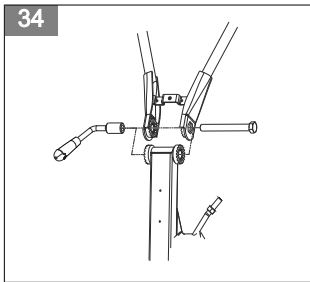
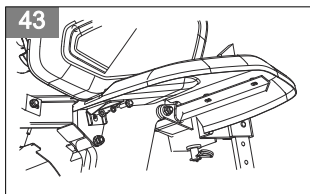
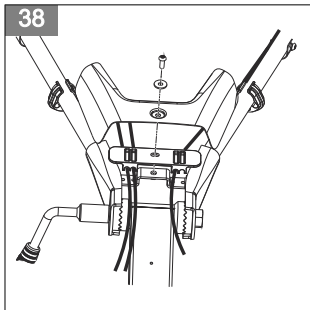
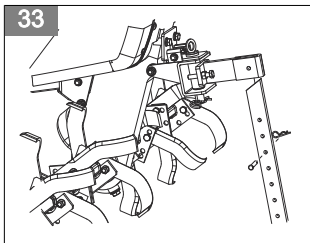
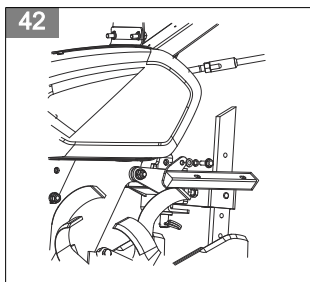
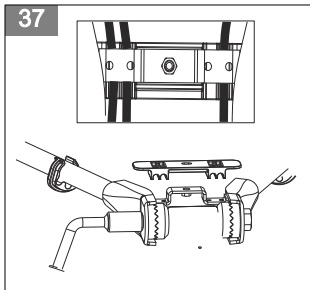
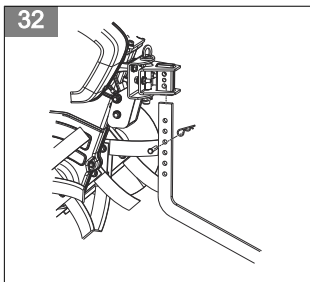
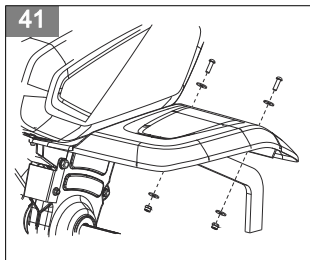
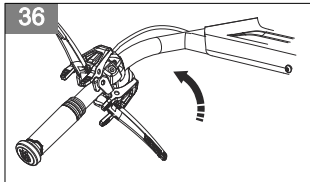
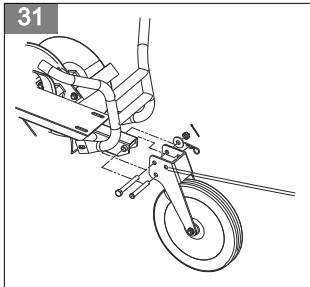
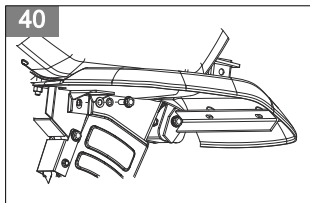
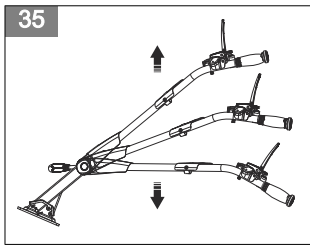
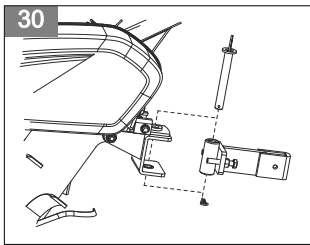

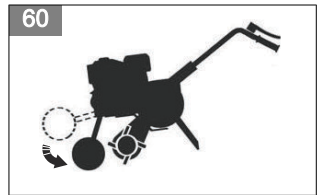
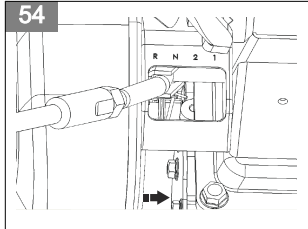
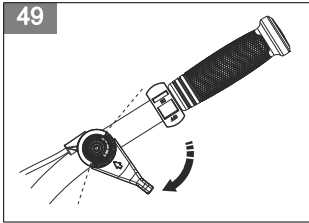
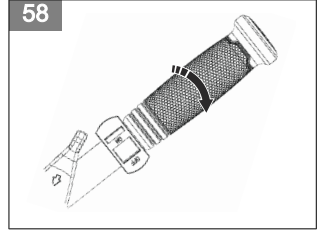
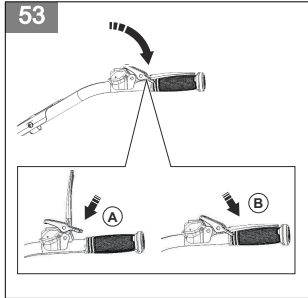
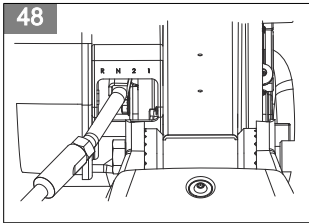
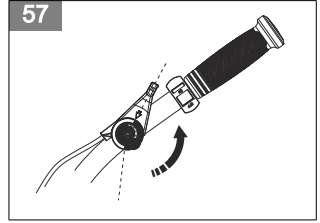
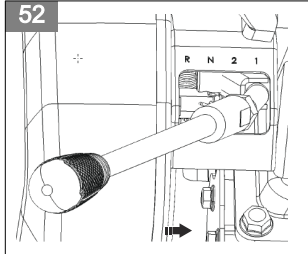
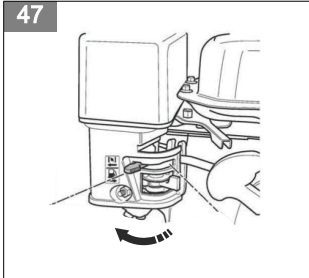
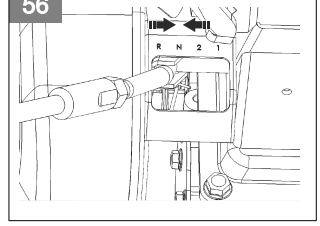
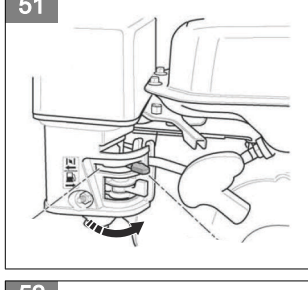
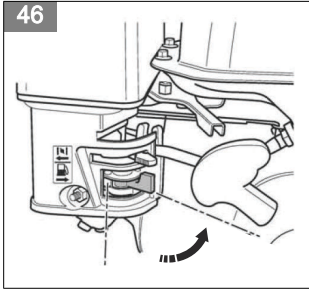
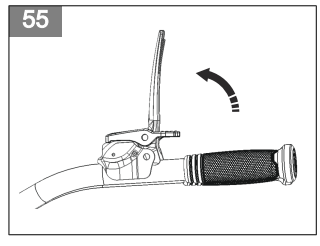
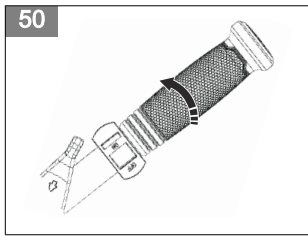
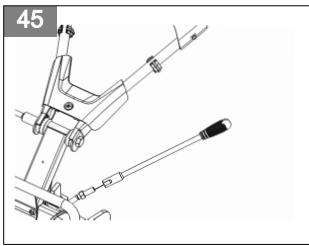

61



63

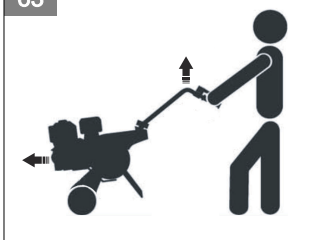

62

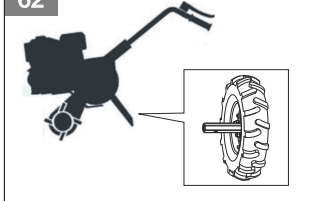

64

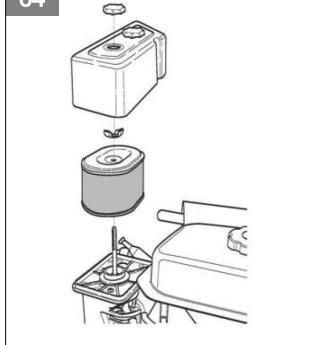

---

# Contents

---

|                   |    |                                 |    |
|-------------------|----|---------------------------------|----|
| Introduction..... | 8  | Maintenance.....                | 13 |
| Safety.....       | 9  | Transportation and storage..... | 14 |
| Assembly.....     | 11 | Technical data.....             | 14 |
| Operation.....    | 11 |                                 |    |

---

## Introduction

---

### Product overview (TF 230)

(Fig. 1)

1. Engine
2. Tine blade cover
3. Support wheel
4. Belt cover
5. Tine blades
6. Drag bar
7. Handle
8. Gear lever
9. Bumper
10. Clutch control
11. ON/OFF switch
12. Throttle control
13. Top cover
14. Cable cover
15. Tine blade holder (secondary)
16. Tine blade holder (primary)
17. Tine cover bracket
18. Connector joint
19. Tool bag
20. Hardware bag
21. Hardware bag (for tine blades only)
22. Blade protection

### Product overview (TF 338P)

(Fig. 2)

1. Engine
2. Tine blade cover
3. Cable cover
4. Belt cover
5. Tine blades
6. Drag bar
7. Handle
8. Gear lever
9. Bumper
10. Clutch control
11. Throttle control
12. ON/OFF switch
13. Top cover
14. Tine blade holder (secondary)
15. Tine blade holder (primary)
16. Connector joint
17. Tine cover bracket
18. Wheel kit
19. Hardware bag
20. Hardware bag (for tine blades only)
21. Tool bag

serious injury or death to the operator or others.

(Fig. 4) Read the operator's manual carefully and make sure that you understand the instructions before use.

(Fig. 5) Use approved hearing protection and approved eye protection.

(Fig. 6) Fast.

(Fig. 7) Slow.

(Fig. 8) Stop the engine and remove the ignition cable before repairs or maintenance.

(Fig. 9) Warning: Rotating parts. Keep hands and feet clear.

(Fig. 10) Keep your distance!

(Fig. 11) Neutral gear.

(Fig. 12) Reverse gear.

(Fig. 13) Fast forward.

### Symbols on the product

(Fig. 3) **WARNING:** Be careful and use the product correctly. This product can cause



(Fig. 14) Slow forward.

**Note:** Other symbols/decals on the product refer to certification requirements for other commercial areas.

## Type plate

| Husqvarna                                     |  | Prod. year |
|---|--|------------|
| Product                                       |  |            |
| Serial No.                                    |  |            |
| Article No.                                   |  |            |
| Model   |  |            |
| Working width                                 |  |            |
| Working depth                                 |  |            |
| Gear shifting                                 |  |            |
| Engine displacement                           |  |            |
| Engine oil quality                            |  |            |
| Engine oil capacity                           |  |            |
| Gearbox oil quality                           |  |            |
| Gearbox oil capacity                          |  |            |
| Power   |  |            |
| Net weight                                    |  |            |
| Fuel (octane/octanol)                         |  |            |
| Husqvarna AB<br>SE-561 82 Huskvarna<br>SWEDEN |  |            |

## Safety

### Safety definitions

Warnings, cautions and notes are used to point out specially important parts of the manual.



**WARNING:** Used if there is a risk of injury or death for the operator or bystanders if the instructions in the manual are not obeyed.



**CAUTION:** Used if there is a risk of damage to the product, other materials or the adjacent area if the instructions in the manual are not obeyed.

**Note:** Used to give more information that is necessary in a given situation.

### General safety instructions



**WARNING:** Read and understand the warning instructions that follow before you use the product.

- Read all the instructions in this operator's manual and on the product before operation. Make sure that you understand and obey the instructions.
- If you have problems or questions about the product, please speak to your Husqvarna dealer for more information.
- The operator is responsible for any unsafe situations or risks that people and property are exposed to.

- This product produces an electromagnetic field during operation. This field may under some circumstances interfere with active or passive medical implants. To reduce the risk of serious or fatal injury, we recommend persons with medical implants to consult their physician and the medical implant manufacturer before operating this product.
- We reserve the right to change specifications and designs without prior notice so as to implement improvements. Note that no legal claims are valid on the basis of information in this manual. Use only genuine parts for repairs. The warranty is not valid if non genuine parts are used.

### Safety instructions for operation



**WARNING:** Read and understand the warning instructions that follow before you use the product.

- Only use the product for which it is intended for, such as cultivation and weeding. Do not use the product for other tasks. This can be dangerous or cause damage.
- Learn how to use the product and its functions safely and learn to how to stop quickly. Also learn the safety decals.
- Never operate the product before the working area is clear and you have a firm foothold. Look out for obstacles with unexpected movement. Take great care when you operate in slopes.
- Only allow the product to be used by adults who are familiar with its use.

- Never allow children or other persons not trained in the use of the product to use or do servicing. Local laws may regulate the age of the user.
- Keep unauthorized persons at a distance. Children, animals, onlookers and helpers should be kept outside the safety zone of 20 m. Stop the product immediately if anyone approaches.
- Never use the product if you are tired, if you have consumed alcohol, if you are taking other drugs or medication that can affect your vision, judgement or coordination.
- Pay particular attention on hard ground.
- The product has the tendency to be much less stable on cultivated ground.
- Never use the product when you are barefoot. Always wear protective shoes or protective boots, preferably with steel toes. Never wear loose-fitting clothing, jewelry or similar that can get caught in moving parts. Use hearing protection to minimize the risk of hearing impairment.
- Never use the product itself to transport people.
- Compliance with and strict adherence to the conditions of operation, servicing and repair as specified by the manufacturer also constitute essential elements of the intended use.
- Stop the engine when the product is not in use.
- Walk with the product, do not run.
- Pay close attention when pulling the product towards you or reversing the direction of rotation.
- Keep a safe distance from the rotating blades, set by the length of the steering column. Keep your hands and feet away from the rotating blades.
- The engine and the exhaust system become very hot during operation. Risk of burn injuries if touched.
- Only use the product in daylight or in other well-lit conditions.
- Do not use the product on ground that slopes more than 20 °.
- Operate across slopes, not up or down.
- Under no circumstances should you modify the original design of the product without approval from the manufacturer. Always use original spare parts. Not approved modifications and/or accessories may lead to serious injury or death to the user or others. The warranty is not valid if non genuine parts are used.
- Stop the engine immediately if the following occurs: Excessive vibration and / or noise, mechanical jam preventing engine from turning, difficulties to engage or disengage the clutch, a collision with a foreign object or deterioration of the engine stop cable.
- If the engine halt cable is severed, use the starter control to stop the engine. Allow the product to cool down. Disconnect the spark plug cap from the spark plug. Check that the product is not damaged. If the product is damaged, speak to an approved service workshop for repair.

- Always exercise care and use your common sense. Avoid all situations which you consider to be beyond your capability. If you still feel uncertain about operating procedures after reading these instructions, you should consult an expert before continuing. Contact an authorised service workshop.
- Do not modify safety equipment. Check regularly to be sure it works properly.
- Inappropriate assembly of this product could cause severe injuries. Ensure that you follow all the instructions carefully.

## Fuel safety



**WARNING:** Read and understand the warning instructions that follow before you use the product.

- Petrol is highly inflammable. Exercise care and refuel outdoors. Fire, open flame and smoking are prohibited.
- Bear in mind the risk of fire, explosion and inhaling fumes. If you spill fuel on yourself or your clothes, change your clothes.
- The engine emits carbon monoxide, which is a colourless, poisonous gas. Do not use the machine in enclosed spaces.

## Safety instructions for maintenance



**WARNING:** Read and understand the warning instructions that follow before you use the product.

- Always stop the engine before repair, cleaning, maintenance work or when changing the tools on the product. Never make adjustments with the product running.
- Regular maintenance is essential for safety and to maintain the levels of performance.
- Wear heavy-duty gloves when changing the tools on the product.
- Replace the rotating blade in complete sets to keep them balanced. Always use original spare parts.
- Check that nuts and screws are tight.
- Never use a product that has a faulty muffler. Contact an authorized service workshop.
- For your own safety, do not alter the characteristics of the product. Do not change the engine speed settings and do not run the engine at excess speed.
- Always use original spare parts.
- When the service life of this product has been served and it is no longer used it should be returned to the dealer or to an applicable station for recycling.
- Make sure to not cut the cables/wires or scratch the machine when cutting the edges of the case.

---

# Assembly

---

## Introduction



**WARNING:** Read and understand the safety chapter before you assemble the product.

### To assemble the tine blades (TF 230)

- Refer to the illustration for an overview of the bolts, screws, nuts and washers that is necessary to assemble the tine blades. (Fig. 15)
- Obey the instructions in the illustrations below.

**Note:** The illustrations only show the assembly of the tine blades on the right side. The same instructions are applicable on the left side. Make sure that the sharp edges point in the same direction on the right and left tine blades.

(Fig. 16) (Fig. 17) (Fig. 18) (Fig. 19) (Fig. 20) (Fig. 21)

### To assemble the tine blades (TF 338P)

- Refer to the illustration for an overview of the bolts, screws, nuts and washers that is necessary to assemble the tine blades. (Fig. 22)
- Obey the instructions in the illustrations below.

**Note:** The illustrations only show the assembly of the tine blades on the right side. The same instructions are applicable on the left side. Make sure that the sharp edges point in the same direction on the right and left tine blades.

(Fig. 23) (Fig. 24) (Fig. 25) (Fig. 26) (Fig. 27) (Fig. 28)

### To assemble the product

1. Install the connection joint.

- a) For TF 230: (Fig. 29)
  - b) For TF 338P: (Fig. 30)
2. For TF 230, install the support wheel. (Fig. 31)
  3. Install the drag bar.
    - a) For TF 230: (Fig. 32)
    - b) For TF 338P: (Fig. 33)
  4. Install the handlebar. (Fig. 34)
  5. Adjust the height of the handle and tighten the knobs. (Fig. 35)
  6. Turn the clutch control to the correct side. Attach the bolt. (Fig. 36)
  7. Install the cable cover.
    - a) Install the cables correctly.
    - b) Install the rubber holder. (Fig. 37)
    - c) Install the cable cover and tighten the screw. (Fig. 38)
  8. Install the tine cover (TF 230).



**CAUTION:** Install the 4 bolts and nuts before your tighten them fully.

- a) (Fig. 39)
  - b) (Fig. 40)
  - c) (Fig. 41)
9. Install the tine cover (TF 338P):
    - a) (Fig. 42)
    - b) (Fig. 43)
    - c) (Fig. 44)
  10. Install the gear lever. (Fig. 45)
  11. After assembly, tighten all bolts and nuts again.



**CAUTION:** Do not disassemble the product. Speak to an approved servicing dealer for that task.

---

# Operation

---

## Introduction



**WARNING:** Read and understand the safety chapter before you use the product.

### To do before you operate the product

- Do an inspection of the work area. Remove all loose objects that can eject from the product and cause serious injury to the operator or others. Such items include stones, glass or steel wire.
- Do a check of the engine oil level and fill engine oil if it is necessary.
- Do a check of the oil level of the gearbox and fill oil if it is necessary.

- Do a check of the fuel level and fill fuel if it is necessary.
- Do an overhaul of the product.
  - a) Replace worn or damaged parts.
  - b) Do a check for fuel leaks.
  - c) Make sure that all guards and covers are installed correctly.
  - d) Do a check of all nuts and screws.
  - e) Make sure that the electrical wires are not damaged.
- For TF 338P: Apply oil to the air filter.

## To fill fuel



**CAUTION:** Do not use gasoline with an octane number less than 90 RON (87 AKI). This can cause damage to the product.

1. Stop the engine and let the product become cool.
2. Put the product in an area with good airflow.
3. Fill the fuel tank.



**CAUTION:** Make sure that there is not too much fuel in the fuel tank. The fuel expands when it becomes hot.

4. Tighten the fuel tank cap carefully to prevent the risk of fire.
5. Clean the product and the area around the product from fuel spillage.
6. Move the product 3 m/10 ft or more away from the refueling area and the fuel source before you start the engine.

## To start the product

1. Open the fuel valve. (Fig. 46)
2. Open the choke with the choke control. (Fig. 47)
3. Put the gear lever in the neutral gear position. (Fig. 48)
4. Apply full throttle with the throttle control. (Fig. 49)
5. Set the ON/OFF switch to ON. (Fig. 50)
6. Pull the starter rope handle.



**WARNING:** Make sure that no person or animal is in the safety zone of 20 m when the product starts.

7. When the product starts, set the choke control to the choke position. (Fig. 51)

## To operate the product forward

1. Use the gear lever to select drive speed. Position 1 is slow speed and position 2 is fast speed. (Fig. 52)

2. Push down the throttle lock on the handle.
3. Push the clutch lever (A) in the direction of the handle to make the tine blades rotate. (Fig. 53)
4. Release the clutch lever (B) to make the tine blades stop.

## To operate the product rearward



**WARNING:** Before you move the product rearward, you must release the clutch lever to prevent injury.

1. Make sure that no obstacles are behind the product.
2. Release the clutch lever.
3. Decrease the engine speed.
4. Put the gear lever in the reverse gear position. (Fig. 54)
5. Push down the throttle lock on the handle.
6. Push the clutch lever (A) in the direction of the handle to make the tine blades rotate. (Fig. 53)
7. Release the clutch lever (B) to make the tine blades stop.

## To stop the product

1. Release the clutch lever. (Fig. 55)
2. Put the gear lever in the N position. (Fig. 56)
3. Set the throttle control to the MIN. position. (Fig. 57)
4. Set the ON/OFF switch to OFF. (Fig. 58)
5. Close the fuel valve. (Fig. 59)

## To move the product with the support wheels (TF 230)

1. Stop the engine. Refer to *To stop the product on page 12*.
2. Fold the support wheels down. (Fig. 60)
3. Set the handlebars in the low position.
4. Lift the tine blades from the ground with the handlebars. (Fig. 61)

## To move the product with the wheel kit

1. Stop the engine. Refer to *To stop the product on page 12*.
2. Replace the tine blades for the wheels. (Fig. 62)
3. Lift the drag bar from the ground with the handlebar. (Fig. 63)

# Maintenance

## Introduction



**WARNING:** Read and understand the safety chapter before you do maintenance on the product.

## Maintenance schedule

\* Clean at a more regular interval if the product is used in conditions with much dust.

\*\* Maintenance is only necessary if operation problems occur. Speak to an approved servicing dealer.

| Maintenance  | Daily maintenance before operation | Maintenance interval in hours |                           |                            |                               |
|--|------------------------------------|-------------------------------|---------------------------|----------------------------|-------------------------------|
|  |                                    | 20 hours or each month        | 50 hours or each 3 months | 100 hours or each 6 months | 300 hours or 1 time each year |
| Clean the product.   | X                                  |                               |                           |                            |                               |
| Make sure that all nuts and screws are tight and are not damaged.        | X                                  |                               |                           |                            |                               |
| Clean the air filter. Replace it if it is necessary.                     | X                                  |                               | X*                        |                            | X**                           |
| Do a check of the engine oil level.                                      | X                                  |                               |                           |                            |                               |
| Do a check of the oil level of the gearbox. Fill oil if it is necessary. | X                                  |                               |                           |                            |                               |
| Make sure that there is no leakage of fuel, engine oil and lubrication.  | X                                  |                               |                           |                            |                               |
| Do a check of the fuel level. Fill fuel if it is necessary.              | X                                  |                               |                           |                            |                               |
| If there is too much vibration in the product, do a check of the cause.  | X                                  |                               |                           |                            |                               |
| Replace the oil and lubrication of the engine and the gearbox.           |                                    | X                             |                           | X                          |                               |
| Clean the fuel filter and the area around the fuel filter.               |                                    |                               |                           | X                          | X**                           |
| Clean the spark plug and the spark plug cap.                             |                                    |                               |                           | X                          |                               |
| Replace the spark plug.  |                                    |                               |                           |                            | X                             |
| Do a check and adjust the play of the engine valves.                     |                                    |                               |                           |                            | X**                           |
| Clean the combustion chamber.  |                                    |                               |                           |                            | X**                           |
| Do a check of the fuel circuit.  |                                    |                               |                           |                            | X**                           |

## To clean the foam air filter



**CAUTION:** Do not use compressed air to clean the foam air filter as this can cause damage.

1. Remove the foam air filter. (Fig. 64)
2. Examine the foam air filter. Clean the foam air filter with warm soap water.



**CAUTION:** Replace a foam air filter that is damaged or cannot be fully cleaned.



**CAUTION:** Make sure that the foam air filter is dry before you install it.

## Transportation and storage

- For transportation shorter distances, refer to *To move the product with the support wheels (TF 230) on page 12* and *To move the product with the wheel kit on page 12*.
- Let the product become cool before you put it in storage.
- Always use approved containers for storage and transportation of fuel.
- Keep the product in a dry and frost-free area.
- Make sure that there are no leaks or fumes from the product. Sparks or open flames, for example from electrical devices or boilers, can start a fire.
- Put a cover on the product and safely attach the product during transportation to prevent damage and accidents. Use an approved vehicle for transportation of the product.
- Do not lift the product.
- Be careful when you move the product on or off a vehicle for transportation. Use an approved ramp.

## Technical data

|  | <b>TF 230</b>   | <b>TF 338P</b>    |
|--|-----------------|-------------------|
| Working width, mm                                    | 750             | 950               |
| Working depth, mm                                    | 150-300         | 150-300           |
| Engine   | WM168FB/P-2     | WM170FB/P-2       |
| Fuel   | Petrol          | Petrol            |
| Fuel tank capacity, l                                | 3.6             | 4.8               |
| Oil tank capacity, l                                 | 0.6             | 0.6               |
| Cylinder displacement, cm <sup>3</sup>               | 196             | 212               |
| Power kW/hp @ rpm                                    | 3.45/4.7 @ 3100 | 3.75 / 5.1 @ 3400 |
| Gears  | R, N, 2, 1      | R, N, 2, 1        |
| Oil capacity gearbox, l                              | 0.95            | 1.1               |
| Gross weight, kg                                     | 86.5            | 106               |
| Net weight, kg                                       | 66.5            | 73                |
| Package dimensions, mm                               | 845x480x780     | 860x490x860       |
| Sound power level, guaranteed L <sub>WA</sub> dB (A) | 95              | 96                |





[www.husqvarna.com](http://www.husqvarna.com)

Original instructions



1142200-39



2023-05-09